

**BILL OF MATERIAL  
NE RETAINING WALL**

Bar	No.	Size	Length	Shape
$h_{10}(E)$	44	#5	34'-0"	—
$h_{11}(E)$	84	#5	36'-6"	—
$n_{10}(E)$	210	#6	9'-0"	—
$n_{11}(E)$	210	#5	7'-2"	—
$t_{10}(E)$	208	#7	6'-8"	—
$t_{11}(E)$	210	#6	5'-8"	—
$v_{10}(E)$	210	#6	8'-0"	—
$v_{11}(E)$	207	#6	8'-2"	—
$v_{12}(E)$	3	#6	7'-11"	—
$w_{10}(E)$	90	#5	36'-0"	—
$w_{11}(E)$	7	#5	6'-11"	—
$w_{12}(E)$	7	#5	9'-8"	—
Structure Excavation		Cu. Yd.	307	
Concrete Structures		Cu. Yd.	190.0	
Protective Coat		Sq. Yd.	91	
Reinforcement Bars, Epoxy Coated		Pound	22,400	
Geocomposite Wall Drain		Sq. Yd.	90	
Porous Granular Embankment, Special		Cu. Yd.	120	

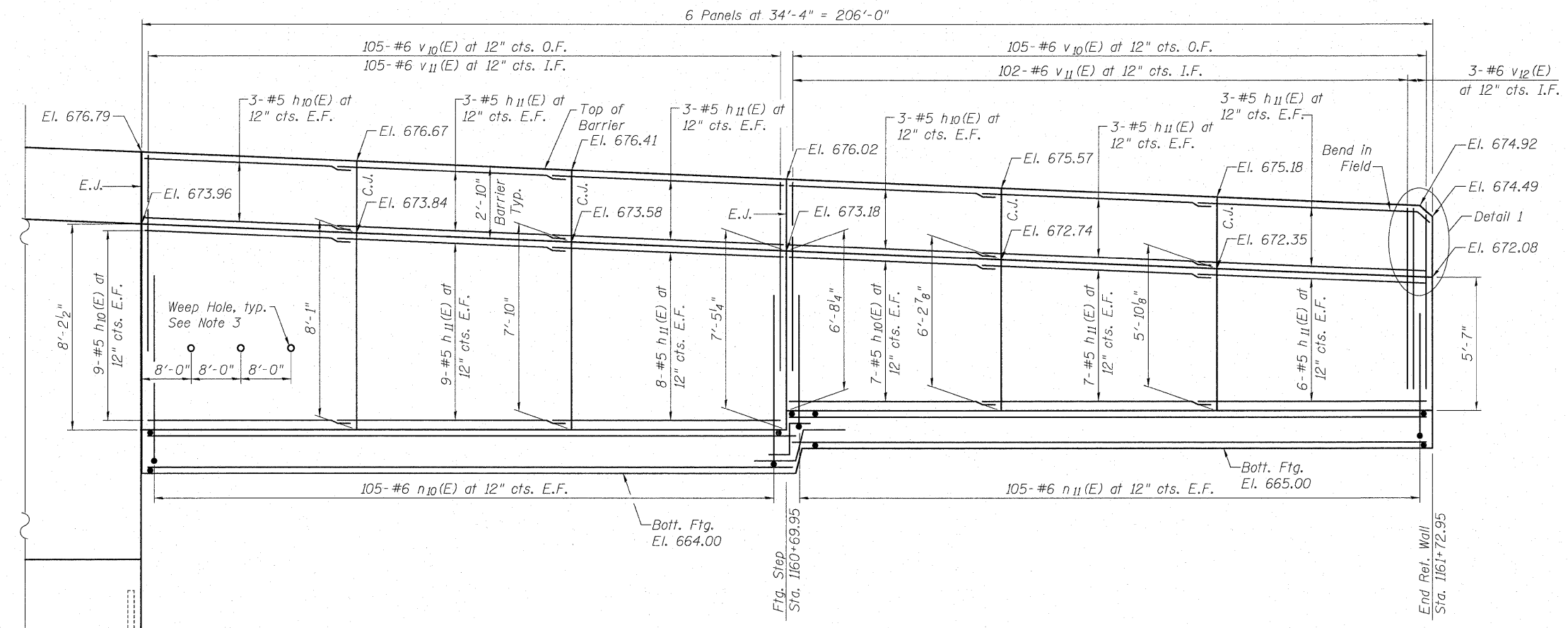

**NORTHEAST RETAINING WALL REFLECTED ELEVATION**

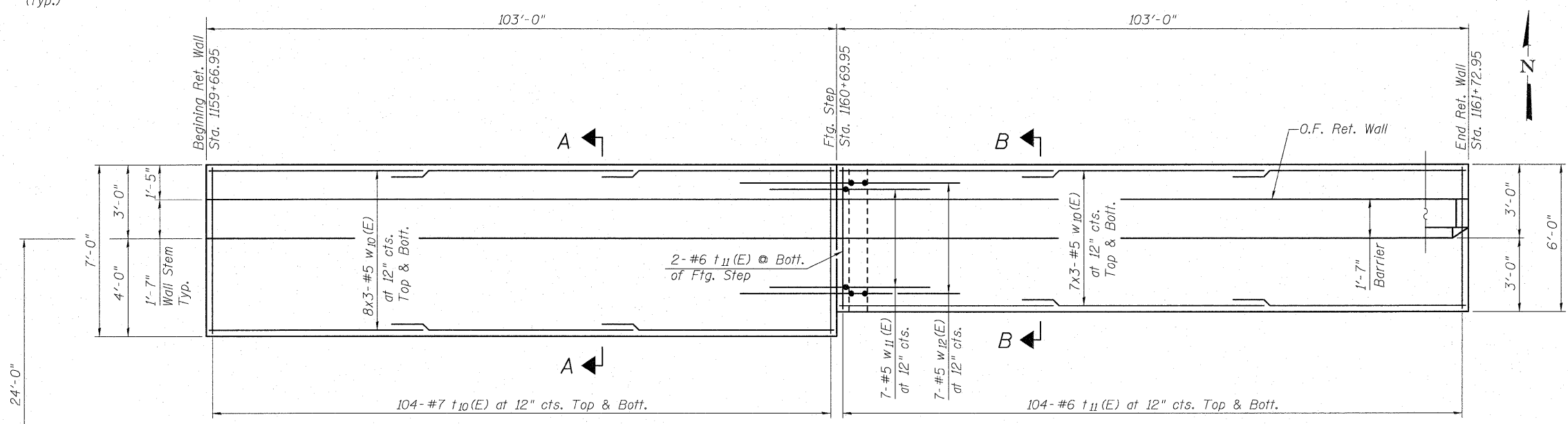

**NORTHEAST RETAINING WALL PLAN**

**NOTES:**

- E.J. = Expansion Joint  
C.J. = Construction Joint  
For Joint Details, see Sheet S-14 of S-15.
- For Section A-A & B-B see Sheet S-14 of S-15.
- Place Weep Hole so that bottom of hole is 1'-0" above Finished Grade El. at the O.F. Ret. Wall. Place in Wall Panel adjacent to Wingwall only.
- For Footing Step Detail, see Sheet S-14 of S-15.
- Bars indicated thus 8x3-#5 etc. indicates 8 lines of bars with 3 lengths per line.
- Minimum lap lengths.  
#4 = 2'-0"  
#5 = 2'-6"  
#6 = 3'-0"
- For Detail 1 see sheet S-12 of S-15.



USER NAME =	DESIGNED - JXH	REVISED -
PLOT SCALE =	CHECKED - JW	REVISED -
PLOT DATE =	DRAWN - JLS	REVISED -
	CHECKED - JXH/JW	REVISED -

STATE OF ILLINOIS  
DEPARTMENT OF TRANSPORTATION

**NE RETAINING WALL - PLAN AND ELEVATIONS**  
**STATION 1158 + 68.95 TO STATION 1161 + 72.95**

F.A.U. RTE.	SECTION	COUNTY	TOTAL SHEETS	SHEET NO.
1238	C-BR	LAKE	61	41
CONTRACT NO. 60J67				
DATE: 1-28-2011		ILLINOIS FED. AID PROJECT		

SHEET NO. S-13 OF S-15 SHEETS