

RAMP 30 M.P.H. STA 457+13
 RAMP 30 M.P.H. SB-53-WP-72-(R)
 SB-53-WP-72-(P)

ILLINOIS 68 DUNDÉE RD EXIT ONLY
 ILLINOIS 68 DUNDÉE RD EXIT ONLY

SPEED LIMIT 55
 SPEED LIMIT 55
 STA 456+99
 NB-53-LP-40-(R)
 NB-53-LP-40-(P)

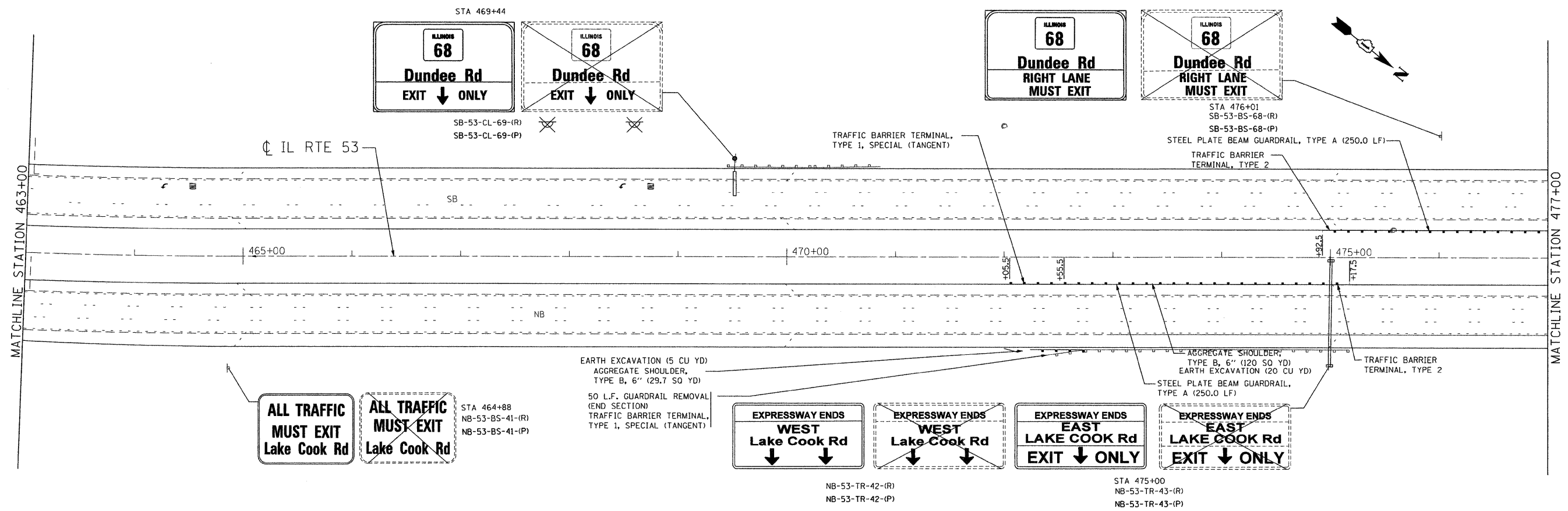

ILLINOIS 68 DUNDÉE RD EXIT ONLY
 ILLINOIS 68 DUNDÉE RD EXIT ONLY

ILLINOIS 68 DUNDÉE RD RIGHT LANE MUST EXIT
 ILLINOIS 68 DUNDÉE RD RIGHT LANE MUST EXIT

ALL TRAFFIC MUST EXIT Lake Cook Rd
 ALL TRAFFIC MUST EXIT Lake Cook Rd

EXPRESSWAY ENDS WEST LAKE COOK RD
 EXPRESSWAY ENDS WEST LAKE COOK RD
 EXPRESSWAY ENDS EAST LAKE COOK RD EXIT ONLY
 EXPRESSWAY ENDS EAST LAKE COOK RD EXIT ONLY

EARTH EXCAVATION (5 CU YD)
 AGGREGATE SHOULDER, TYPE B, 6" (29.7 SQ YD)
 50 L.F. GUARDRAIL REMOVAL (END SECTION)
 TRAFFIC BARRIER TERMINAL, TYPE 1, SPECIAL (TANGENT)

AGGREGATE SHOULDER, TYPE B, 6" (120 SQ YD)
 EARTH EXCAVATION (20 CU YD)
 STEEL PLATE BEAM GUARDRAIL, TYPE A (250.0 LF)

200 22ND Street, Suite 216, Lombard, IL 60148
 630.785.9119 voice, 630.839.2566 fax
 www.mps-il.com
MILLENNIA PROFESSIONAL SERVICES

DESIGNED - CJD	REVISED -
DRAWN - CJD	REVISED -
CHECKED - TVN	REVISED -
DATE - 1/3/2011	REVISED -

STATE OF ILLINOIS
DEPARTMENT OF TRANSPORTATION

ILLINOIS ROUTE 53
RAND ROAD TO LAKE COOK ROAD
SIGNING & ROADWAY PLANS
 SCALE: 1"=50' SHEET NO. OF SHEETS STA. 450+00 TO STA. 477+00

F.A.P. RTE. 2592	SECTION 2010-003 I	COUNTY COOK	TOTAL SHEETS 43	SHEET NO. 12
FED. ROAD DIST. NO. 1 ILLINOIS FED. AID PROJECT				
CONTRACT NO. 60K21				

PLN-05

FILE NAME : PA\2009\ME090806_Ver-Vor-Phit\CADD\W019_IL53\Shets\0160K21-sht-pln-05.dgn
 PLOT SCALE = 50.00000 / IN.
 USER NAME = Millennium Professional Services

PA\2009\ME090806_Ver-Vor-Phit\CADD\W019_IL53\Shets\0160K21-sht-pln-05.dgn