

MATCH LINE SEE DRAWING RL-3
PATH STA 164+23

MATCH LINE SEE DRAWING RL-5
PATH STA 167+50

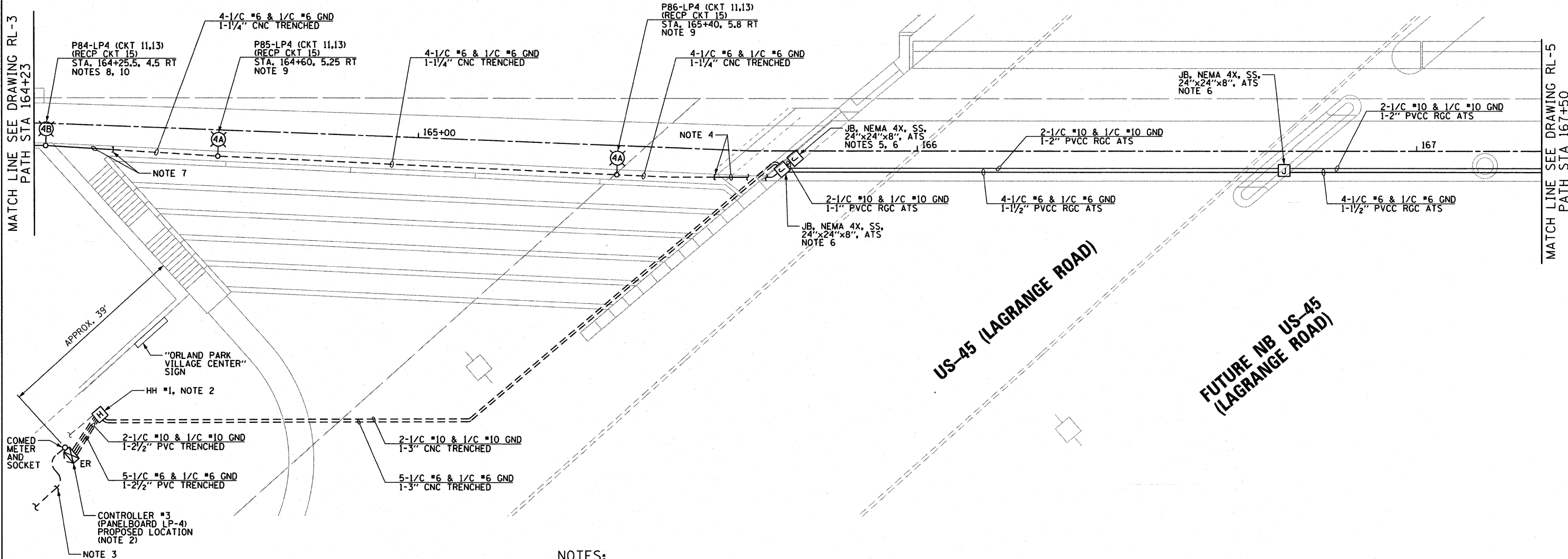

NOTES:

1. SEE DRAWING GE-1 FOR ELECTRICAL SYMBOL LIST, ABBREVIATIONS, AND GENERAL NOTES.
2. CONTRACTOR SHALL CONSTRUCT NEW CONTROLLER #3 FOUNDATION AND RELOCATE CONTROLLER #3 AND COMED METER TO NEW FOUNDATION LOCATION. CONTRACTOR MUST LOCATE CONTROLLER FOUNDATION TO AVOID EXISTING CONDUITS AND WIRING. CONTRACTOR SHALL RECONNECT EXISTING LOADS TO RELOCATED CONTROLLER. ROUTE (4) 2 1/2\" PVC CONDUITS FROM NEW CONTROLLER LOCATION TO HH #1. PULL EXISTING LOAD WIRES IN (1) 2 1/2\" PVC CONDUIT TO NEW CONTROLLER LOCATION AND TERMINATE WIRES. CONTRACTOR SHALL CUT DOWN ANY PLANT GROWTH AROUND AND BLOCKING CLEAR ACCESS TO NEW CONTROLLER LOCATION. ALL WORK SHALL BE INCLUDED IN "RELOCATE EXISTING LIGHTING CONTROLLER" PAY ITEM. SEPARATE PAYMENT WILL NOT BE MADE.
3. FURNISH AND INSTALL NEW 2\" RGC CONDUIT TO NEW CONTROLLER LOCATION. REINSTALL COMED SERVICE WIRES FROM UTILITY PAD MOUNTED TRANSFORMER IDENTIFIED ON DRAWING EL-2. CONTRACTOR SHALL HAVE COMED RECONNECT CABLES TO EXISTING SERVICE TRANSFORMER. THIS WORK SHALL BE INCLUDED IN THE "RELOCATE ELECTRIC SERVICE" PAY ITEM. THE UTILITY COMPANY CHARGES WILL BE PAID UNDER "ELECTRIC UTILITY SERVICE CONNECTION" PAY ITEM. SEPARATE PAYMENT WILL NOT BE MADE.
4. CONDUIT FROM JUNCTION BOX THROUGH ABUTMENT SHALL BE 1 1/2\" PVCC RGC WITHIN A 2\" CONDUIT SLEEVE CAST INTO ABUTMENT. TRANSITION TO 1/4\" CNC UNDERGROUND BEYOND LIMITS OF APPROACH SLAB.
5. JUNCTION BOX CONTAINS 30A FUSES FOR UNDERPASS LIGHTING CONDUCTORS. SEE DRAWING RL-6 FOR PEDESTRIAN BRIDGE AND METRA BRIDGE UNDERPASS LIGHTING PLAN AND TYPICAL UNDERPASS LIGHTING UNIT WIRING DIAGRAM. THIS WORK SHALL BE INCLUDED IN THE "JUNCTION BOX, STAINLESS STEEL, ATTACHED TO STRUCTURE, 24\"x24\"x8\" " PAY ITEM. SEPARATE PAYMENT WILL NOT BE MADE.
6. CONTRACTOR SHALL USE LIQUID-TIGHT FLEXIBLE METAL CONDUIT, 3'-0\" LENGTH MAXIMUM, TO CONNECT CONDUITS ATTACHED TO STRUCTURE TO JUNCTION BOX. SEE DRAWING ED-5 FOR CONDUIT INSTALLATION DETAILS. THE COST OF FLEXIBLE METAL CONDUITS SHALL BE INCLUDED IN THE COST OF "JUNCTION BOX, STAINLESS STEEL, ATTACHED TO STRUCTURE, 24\"x24\"x8\" " PAY ITEM. SEPARATE PAYMENT WILL NOT BE MADE.
7. CONTRACTOR SHALL PROVIDE 1 1/2\" PVC CONDUIT IN TRENCH UNDERNEATH CONCRETE STAIRCASE LANDING. TRANSITION FROM 1 1/2\" PVC EMBEDDED IN WALL TO 1/4\" CNC UNDERGROUND ONE FOOT PAST PROPOSED LANDING.
8. SEE STRUCTURAL DRAWINGS FOR TYPICAL DETAILS AT LIGHTING UNIT LOCATIONS.
9. SEE DRAWING ED-1 FOR LIGHTING STANDARD TYPE 4A INSTALLATION DETAILS.
10. SEE DRAWING ED-2 FOR LIGHTING STANDARD TYPE 4B INSTALLATION DETAILS.

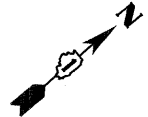
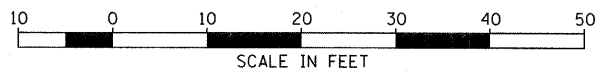

McDonough Associates Inc.
 Engineers / Architects
 130 East Randolph Street Chicago, Illinois 60601

FILE NAME = D160K64-SHT-RL-4.dgn	USER NAME = jletour	DESIGNED - JLW	REVISED -	STATE OF ILLINOIS DEPARTMENT OF TRANSPORTATION	MULTI-USE PATH PROPOSED LIGHTING PLAN	F.A.P. RTE. 330	SECTION 73 R-B	COUNTY COOK	TOTAL SHEETS 136	SHEET NO. 45	
PLOT SCALE = 1/8\"	CHECKED - KMY	REVISED -	SCALE: 1\" = 10'			SHEET NO. 4 OF 5 SHEETS	STA. 164+23 TO STA. 167+50	RL-4		CONTRACT NO. 60K64	
PLOT DATE = 1/27/2011	DATE - 12/17/10	REVISED -				ILLINOIS FED. AID PROJECT					