

STATE OF ILLINOIS  
DEPARTMENT OF TRANSPORTATION

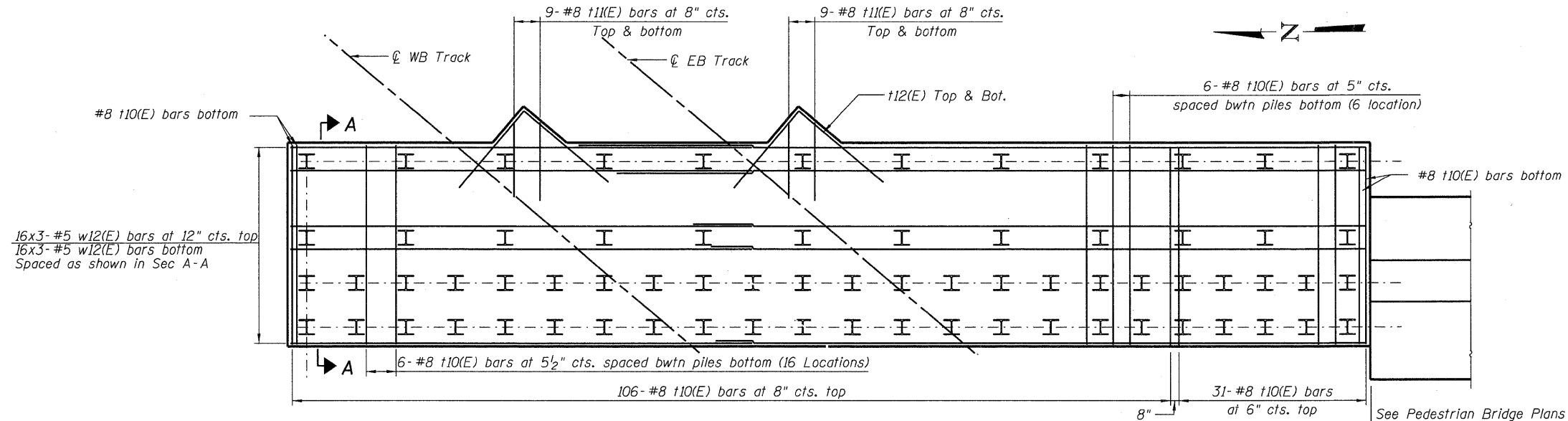

**FOOTING PLAN**  
(Showing Reinforcement)

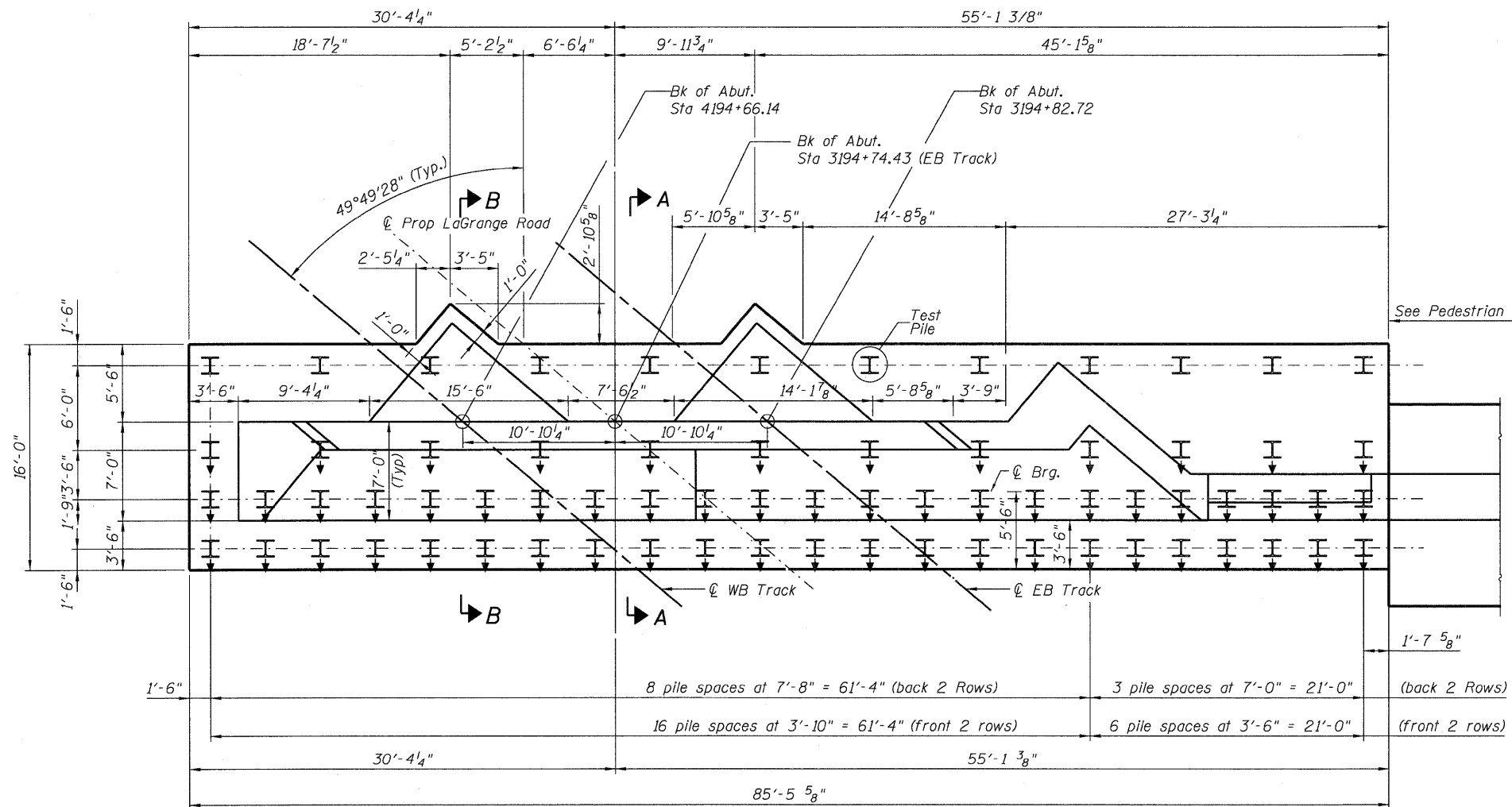

**FOOTING PLAN**  
(Showing Dimensions)

Notes:  
For Sections A-A, & B-B and C-C see Sheet 19.

**PILE DATA**

Type: Steel HP14x117  
Nominal Required Bearing = 929 kips  
Factored Resistance Available = 310 kips  
Est. Length: 71 feet (vertical)  
No. Production Piles: 69  
No. Test Piles: 1

— Straight (no batter)  
— Battered Pile

**EAST ABUTMENT FOOTING PLAN**  
**STRUCTURE NO. 016-6201**

DESIGNED	JCE
CHECKED	JCA
DRAWN	JCE
CHECKED	JCA

SHEET NO. 18 25 SHEETS	F.A.P RTE.	SECTION	COUNTY	TOTAL SHEETS	SHEET NO.
	330	73 R-B	COOK	136	70
DATE: 12/17/10		ILLINOIS FED. AID PROJECT			
CONTRACT NO. 60K64					