

P. A. I. NO.	SECTION	COUNTY	TOTAL SHEETS	SHEET NO.
55	2010-070-RS	*	56	35
STA.	TO STA.			
FED. ROAD DIST. NO.	ILLINOIS	FED. AID PROJECT		
* COOK / DUPAGE				

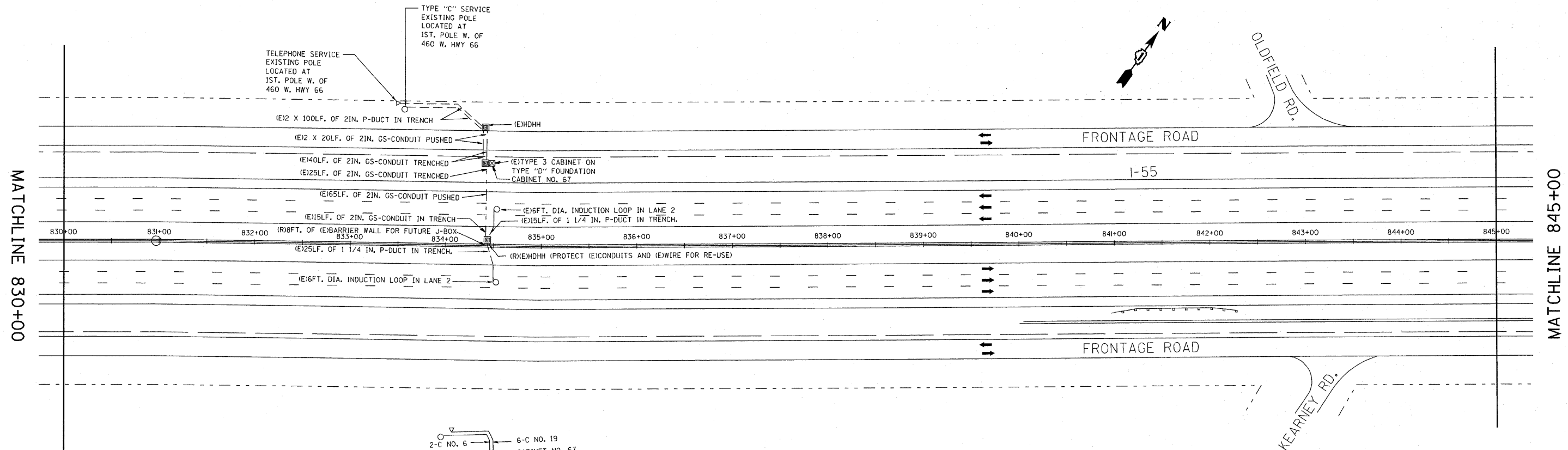

MATCHLINE 830+00

MATCHLINE 845+00

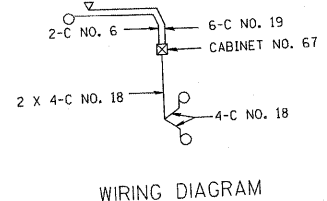

WIRING DIAGRAM

SYMBOL	LEGEND
○	INDUCTION LOOP
○	ROUND INDUCTION LOOP
⊠	TSC CABINET
⊖	TELEPHONE SERVICE
⊖	SERVICE INSTALLATION
⊠	JUNCTION BOX
■	HEAVY DUTY HAND HOLE
---	POLYETHYLENE DUCT
---	GALVANIZED STEEL CONDUIT
(E)	EXISTING
(P)	PUSHED
(I)	INSTALL
(R)	REMOVE
(T)	TRENCHED

EXISTING/REMOVAL

ILLINOIS DEPARTMENT OF TRANSPORTATION
TRAFFIC SYSTEMS CENTER
1-55 STEVENSON

1/2 MILE EAST OF LEMONT ROAD

REVISIONS	
NAME	DATE
J.G.	12-94
J.G.	05-08-95
T.C.	05-31-95
J.G.	10-29-2010

SCALE: VERT. 50:1
HORIZ. 50:1
DATE 6-13-94

DRAWN BY G.M.
CHECKED BY J.G.

TRAFFIC SYSTEMS CENTER

RD-C: E:\01\15\152010_RF\STEVE.DGN
RF-STEVE.DGN

VI=830