

QUANTITY  
 4 (100) LINE = 64.1 ft. (19.7 m)  
 21.1 sq. ft. (1.97 sq. m)

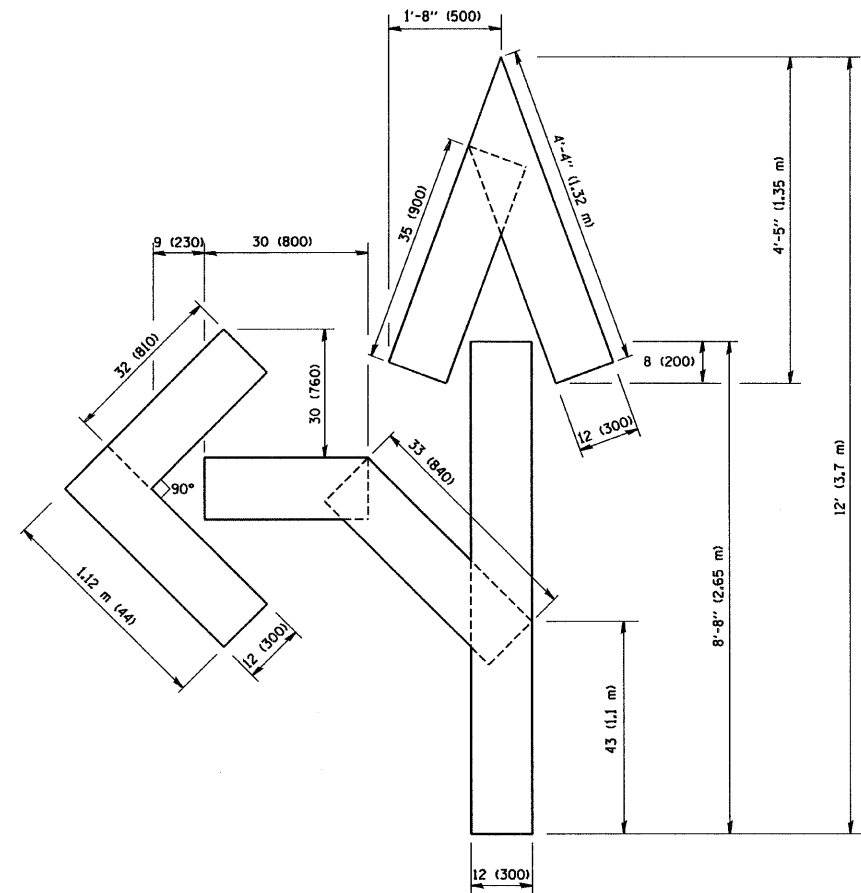

QUANTITY  
 4 (100) LINE = 82.5 ft. (25.3 m)  
 27.5 sq. ft. (2.53 sq. m)

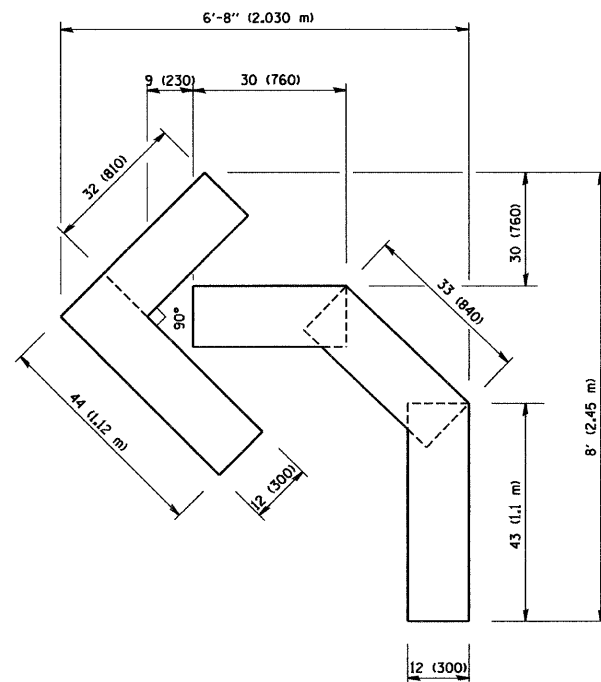

QUANTITY  
 4 (100) LINE = 45.5 ft. (13.9 m)  
 15.2 sq. ft. (1.39 sq. m)

All dimensions are in inches (millimeters) unless otherwise shown.

FILE NAME = W:\diststd\22x34\1c16.dgn 1-24-2011	USER NAME = gaglionabt	DESIGNED -	REVISED - T. RAMMACHER 06-05-96	<b>STATE OF ILLINOIS</b> <b>DEPARTMENT OF TRANSPORTATION</b>	<b>PAVEMENT MARKING LETTERS AND SYMBOLS</b> <b>FOR TRAFFIC STAGING</b>			F.A.P. RTE.	SECTION	COUNTY	TOTAL SHEETS	SHEET NO.
	PLOT SCALE = 50.0000 "/ IN.	DRAWN -	REVISED - T. RAMMACHER 11-04-97		303	2010-116-I	LAKE	23	21a			
	PLOT DATE = 1/4/2008	CHECKED -	REVISED - T. RAMMACHER 03-02-98		SCALE: NONE    SHEET NO. 1 OF 1 SHEETS    STA.    TO STA.			<b>TC-16</b>		CONTRACT NO. 60M50		
	DATE - 09-18-94	REVISIONS - E. GOMEZ 08-28-00				FED. ROAD DIST. NO. 1 ILLINOIS FED. AID PROJECT						