

CONTRACT 60M65 - WESTBOUND MIDLAND AVENUE TO GRUNDY COUNTY LINE
 CONTRACT 60M63 - EASTBOUND GRUNDY COUNTY LINE TO MIDLAND AVENUE

CONTRACT 60M66 - WESTBOUND US ROUTE 6 TO MIDLAND AVENUE
 CONTRACT 60M64 - EASTBOUND MIDLAND AVENUE TO US ROUTE 6

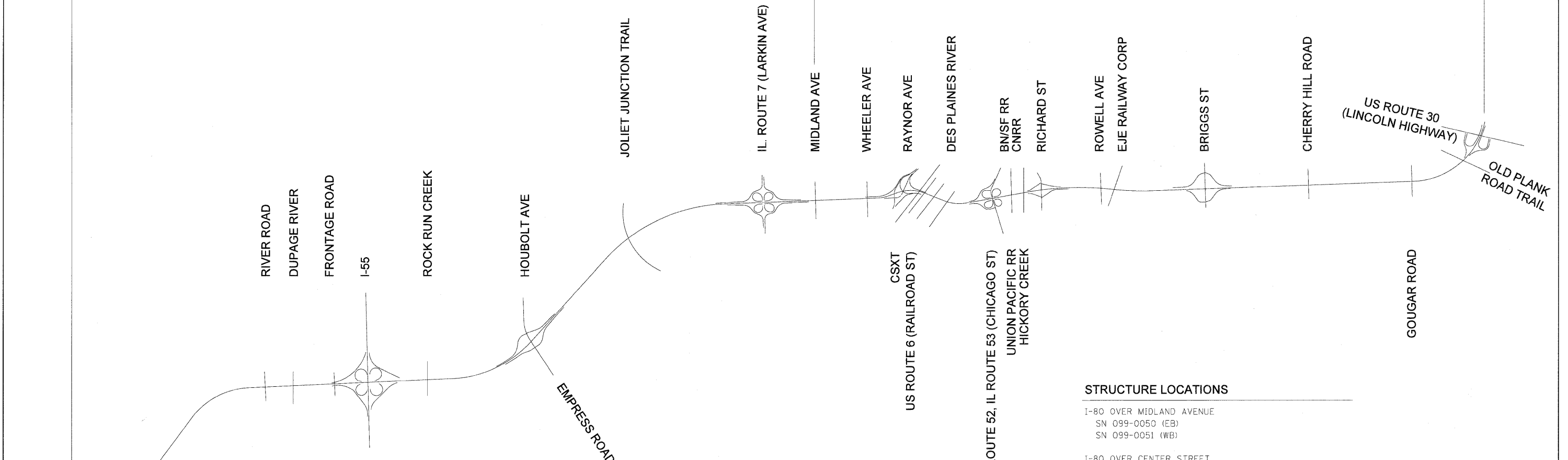

STRUCTURE LOCATIONS

- I-80 OVER DUPAGE RIVER
SN 099-0040 (EB)
SN 099-0041 (WB)
- I-55 SB TO I-80 WB RAMP
SN 099-0308
- I-80 OVER FRONTAGE ROAD
SN 099-0042 (EB)
SN 099-0043 (WB)
- I-80 OVER I-55
SN 099-0044 (EB)
SN 099-0045 (WB)
- I-80 OVER ROCK RUN CREEK
SN 099-0046 (EB)
SN 099-0047 (WB)
- I-80 OVER HOUBOLT ROAD
SN 099-0301 (EB)
SN 099-0302 (WB)
- I-80 OVER JOLIET JUNCTION TRAIL
SN 099-0048 (EB)
SN 099-0049 (WB)

STRUCTURE LOCATIONS

- I-80 OVER MIDLAND AVENUE
SN 099-0050 (EB)
SN 099-0051 (WB)
- I-80 OVER CENTER STREET
SN 099-0052 (EB)
SN 099-0053 (WB)
- I-80 OVER CENTER STREET RAMP
SN 099-0054 (WB)
SN 099-0055 (EB)
- I-80 OVER DES PLAINES RIVER / US-6 (RAILROAD ST)
SN 099-0056 (EB)
SN 099-0057 (WB)
- I-80 OVER IL53 / US-52 / CHICAGO ST
SN 099-0058 (WB)
SN 099-0059 (EB)
- I-80 OVER BNSF RR / GARDNER STREET
SN 099-0060 (EB)
SN 099-0061 (WB)
- I-80 OVER HICKORY CREEK
SN 099-0062 (EB)
SN 099-0063 (WB)
- I-80 OVER RICHARDS STREET
SN 099-0064 (WB)
SN 099-0065 (WB)
- I-80 OVER ROWELL AVE / EJ&E RR
SN 099-0066 (EB)
SN 099-0067 (WB)

SHEPLEY ROAD
 RIDGE ROAD
 GRUNDY COUNTY LINE

| | |
|------------------|-----------|
| DESIGNED - | REVISIONS |
| DRAWN - RR | REVISIONS |
| CHECKED - | REVISIONS |
| DATE - 1/20/2011 | REVISIONS |



STATE OF ILLINOIS
DEPARTMENT OF TRANSPORTATION

SCHEMATIC DIAGRAM

SCALE: 1"=50' SHEET NO. 1 OF 1 SHEETS STA. N/A TO STA. N/A

| F.A.I. RTE. | SECTION | COUNTY | TOTAL SHEETS | SHEET NO. |
|---------------------|---------------|---------------------------|--------------|-----------|
| 80 | 99(4&4-1)RS-3 | WILL | 203 | 14 |
| FED. ROAD DIST. NO. | | ILLINOIS FED. AID PROJECT | | |

FILE NAME = c:\oad\lib\pk\rose\pkgr\eat.lakes\dms34565\DI60M66-sht-schematic.dgn