

Existing Structure: S.N. 099-0053 carrying I-80 Westbound over Center Street Ramp was originally constructed in 1964 as FAI Route 80, Section 99-3HB-1. The structure consists of a three-span continuous wide flange beam and reinforced concrete deck superstructure supported by concrete stub abutments and multi column piers. The skew is 24°36'0" forward left. The parapets and joints were replaced in 1982, and the deck and joints were repaired in 1992, 1998 and 2001.

Stage construction shall be utilized to maintain traffic during construction.

No salvage.

INDEX OF SHEETS

1. General Plan, Notes & Total Bill of Material
2. Construction Staging
3. Deck and Joint Repair Details
4. Abutment and Pier Repair Details
5. Protective Shield, Special
6. Temporary Concrete Barrier for Stage Construction.

TOTAL BILL OF MATERIAL

ITEM	UNIT	SUPER	SUB	TOTAL
Polymerized Hot-Mix Asphalt Surface Course, Stone Matrix Asphalt, N80	Ton	65	-	65
Protective Shield, Special	Sq. Yd.	245	-	245
Hot-Mix Asphalt Surface Removal (Deck)	Sq. Yd.	577	-	577
Structural Repair of Concrete (Equal to or Less Than 5')	Sq. Ft.	-	173	173
Deck Slab Repair (Full Depth, Type II)	Sq. Yd.	30	-	30
Deck Slab Repair (Partial)	Sq. Yd.	88	-	88
Silicone Joint Sealer, 2"	Foot	92	-	92
Polymer Concrete	Cu. Ft.	16	-	16

SCOPE OF WORK

1. Install Protective Shield, Special.
2. Remove existing Hot-Mix Asphalt overlay.
3. Deck slab repair (full and partial depth).
4. Remove existing neoprene joints and replace with silicone joint sealer.
5. Perform concrete repairs at abutments and piers.
6. Install new Hot-Mix Asphalt overlay.

DESIGN SPECIFICATIONS

2002 AASHTO Standard Specifications for Highway Bridges, 17th Edition

DESIGN STRESSES

$f'_c = 3,500 \text{ psi}$

GENERAL NOTES

1. Reinforcement bars shall conform to the requirements of ASTM A 706 Grade 60. See Special Provisions.
2. Protective Shield, Special shall be installed in Span 2 as shown on the plans and shall be installed prior to start of deck slab repair work. See Special Provision for installation requirements of protective shield adjacent to existing underpass luminaires.
3. Plan dimensions and details relative to existing plans are subject to nominal construction variations. The Contractor shall field verify existing dimensions and details affecting new construction and make necessary approved adjustments prior to construction or ordering of materials. Such variations shall not be cause for additional compensation for a change in scope of the work, however, the Contractor will be paid for the quantity actually furnished at the unit price bid for the work.
4. Areas of proposed deck repairs are estimated. Actual type, location and dimension of deck repairs are to be determined by the Engineer during construction.
5. See Roadway Plans for Ramp AA maintenance of traffic details.

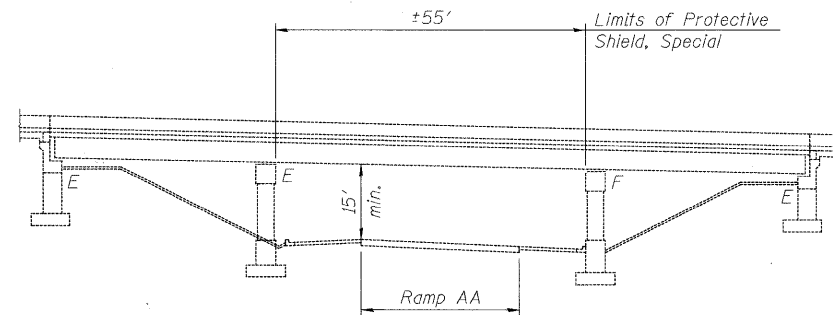

ELEVATION

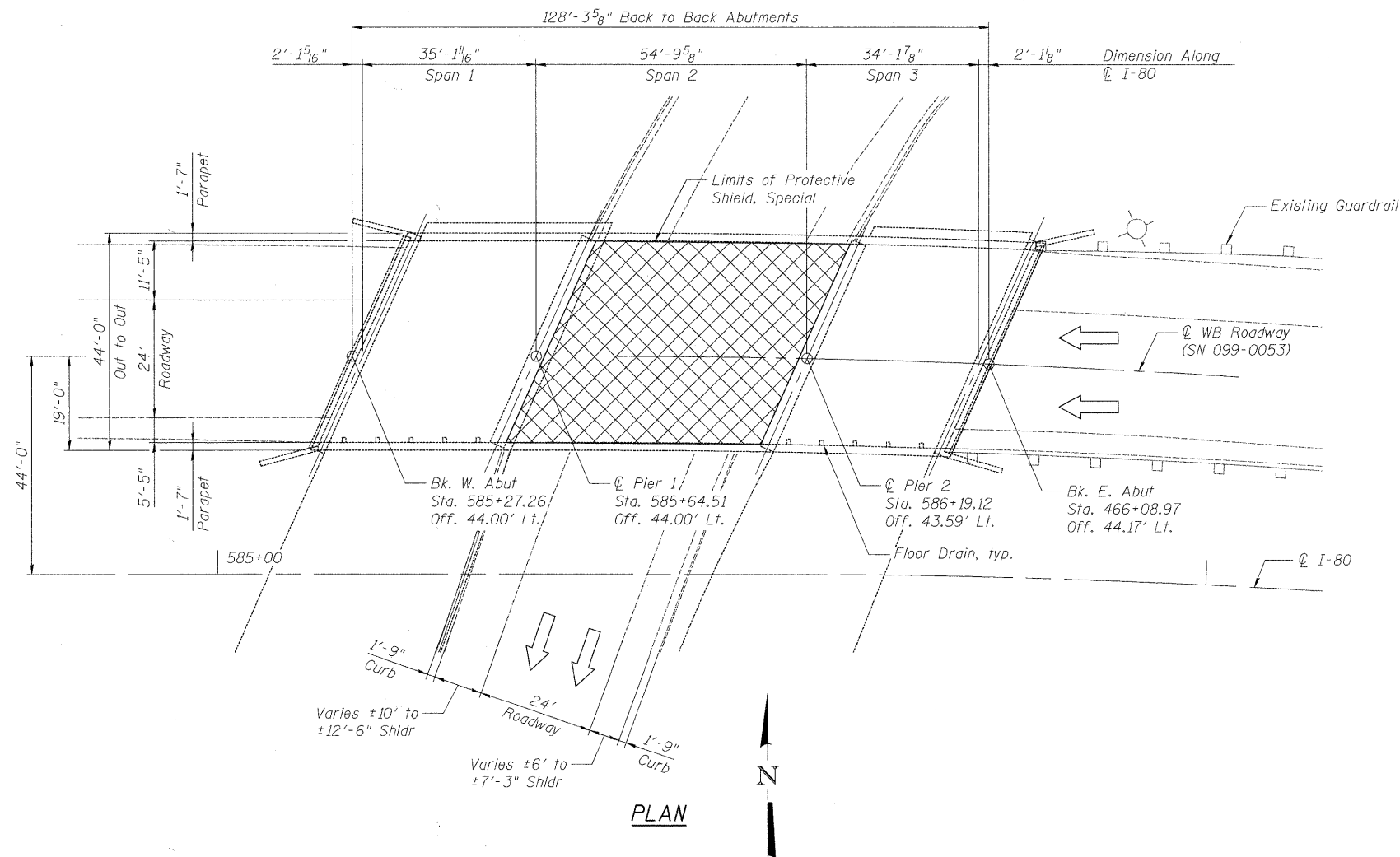

PLAN

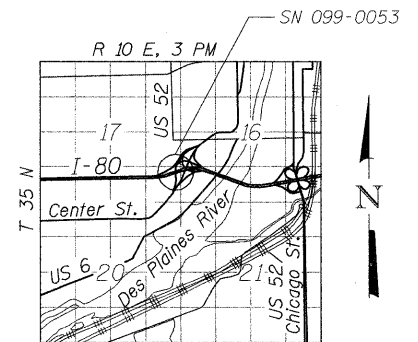

LOCATION SKETCH



SIGNED: *Brian L. Umbright*
 DATE: Jan. 19, 2011
 EXPIRES: November 30, 2012

DESIGNED - DF	REVIS		STATE OF ILLINOIS DEPARTMENT OF TRANSPORTATION			GENERAL PLAN, NOTES & TOTAL BILL OF MATERIAL WESTBOUND FAI-80 OVER CENTER STREET RAMP AA STRUCTURE NO. 099-0053			F.A.I. RTE.	SECTION	COUNTY	TOTAL SHEETS	SHEET NO.
USER NAME = Inueller	DRAWN - LAM								80	99148.4-1RS-3	WILL	203	99
PLOT SCALE = NTS	CHECKED - BLU								CONTRACT NO. 60M66				
PLOT DATE = 1/19/2011 2:08:49 PM	DATE - 1/20/2011								FED. ROAD DIST. NO. ILLINOIS FED. AID PROJECT				

SN056B05_CADD\CADD Sheets\0990053-60M66-001-GPE.dgn