

**STAGE I CONSTRUCTION & TRAFFIC**  
(Looking East)

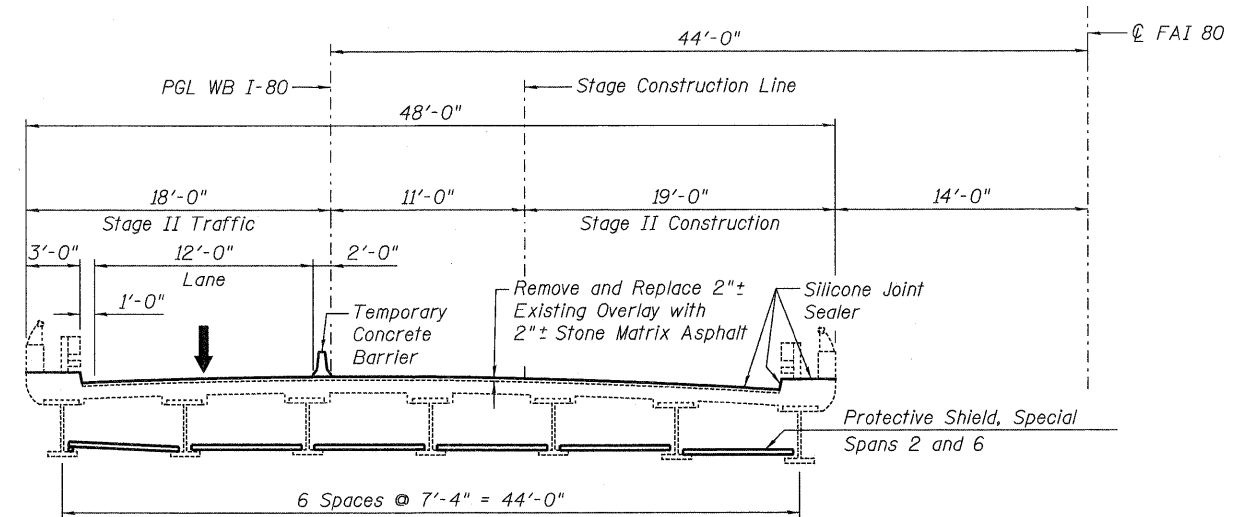

**STAGE II CONSTRUCTION & TRAFFIC**  
(Looking East)

**BILL OF MATERIAL**

ITEM	UNIT	TOTAL
Polymerized Hot-Mix Asphalt Surface Course, Stone Matrix Asphalt, N80	Ton	246
Hot-Mix Asphalt Surface Removal (Deck)	Sq. Yd.	2,185

**NOTES:**

- For Temporary Concrete Barrier details, see Standard 704001. Cost included in Roadway Plans. For anchoring to bridge deck, see Sheet S-14 of 14.
- Placement of protective shield shall not interfere with the operation and maintenance of the electrical conduit.