

PIER 1 - WEST ELEVATION
Looking East

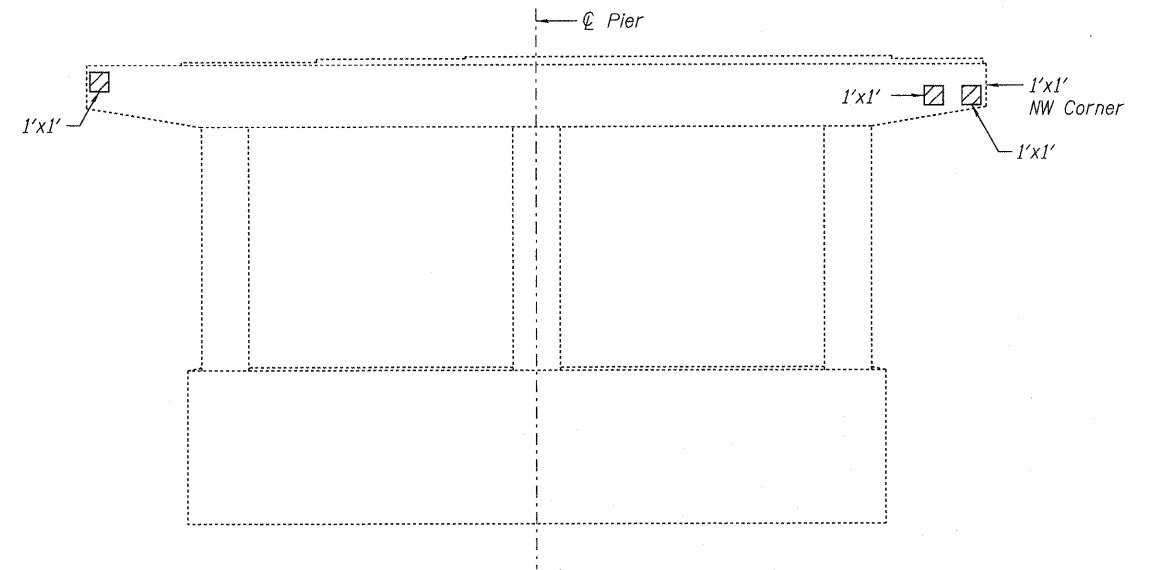

PIER 1 - EAST ELEVATION
Looking West

BILL OF MATERIAL

ITEM	UNIT	TOTAL
Structural Repair Of Concrete (Depth Equal To Or Less Than 5 Inches)	Sq.Ft.	15

LEGEND:

 Spalled or unsound concrete

NOTES:

1. Areas of proposed pier repairs are estimated. Actual type, location and dimensions of pier repairs are to be determined by the Engineer during construction.

DESIGNED - PCA	REVISED -
USER NAME = lsupencheck	DRAWN - LK
PLLOT SCALE = 1:1	CHECKED - MEA
PLLOT DATE = 19-JAN-2011	DATE - 1/21/2011
	REVISED -



STATE OF ILLINOIS
DEPARTMENT OF TRANSPORTATION

PIER 1 REPAIRS
WESTBOUND FAI-80 OVER RAILROAD/GARDNER STREET
STRUCTURE NO. 099-0061

SHEET NO. S-8 OF 14 SHEETS

F.A.I. RTE.	SECTION	COUNTY	TOTAL SHEETS	SHEET NO.
80	99 (4&4-1) RS-3	WILL	203	159
CONTRACT NO. 60M66			FED. ROAD DIST. NO. 1 ILLINOIS FED. AID PROJECT	