

DATE	
BY	
DESIGNED	
DRAWN	
CHECKED	
DATE	
BY	
DESIGNED	
DRAWN	
CHECKED	
DATE	
BY	
DESIGNED	
DRAWN	
CHECKED	

DATE	
BY	
DESIGNED	
DRAWN	
CHECKED	
DATE	
BY	
DESIGNED	
DRAWN	
CHECKED	
DATE	
BY	
DESIGNED	
DRAWN	
CHECKED	

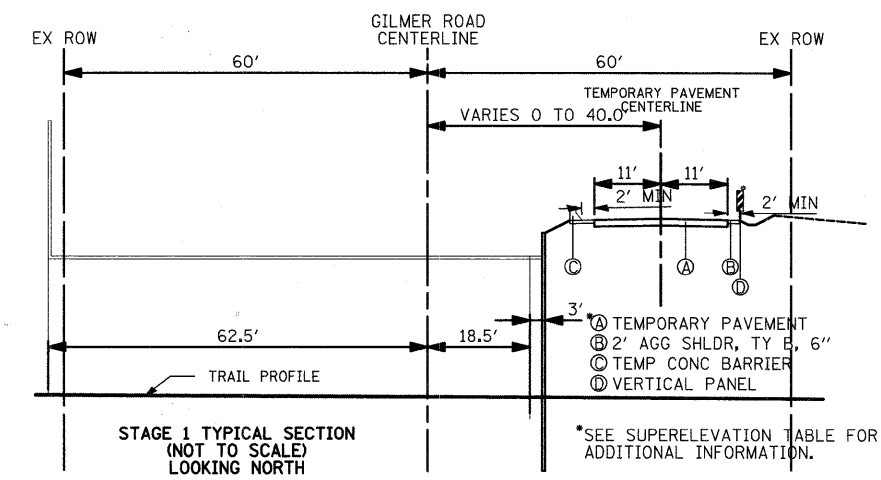
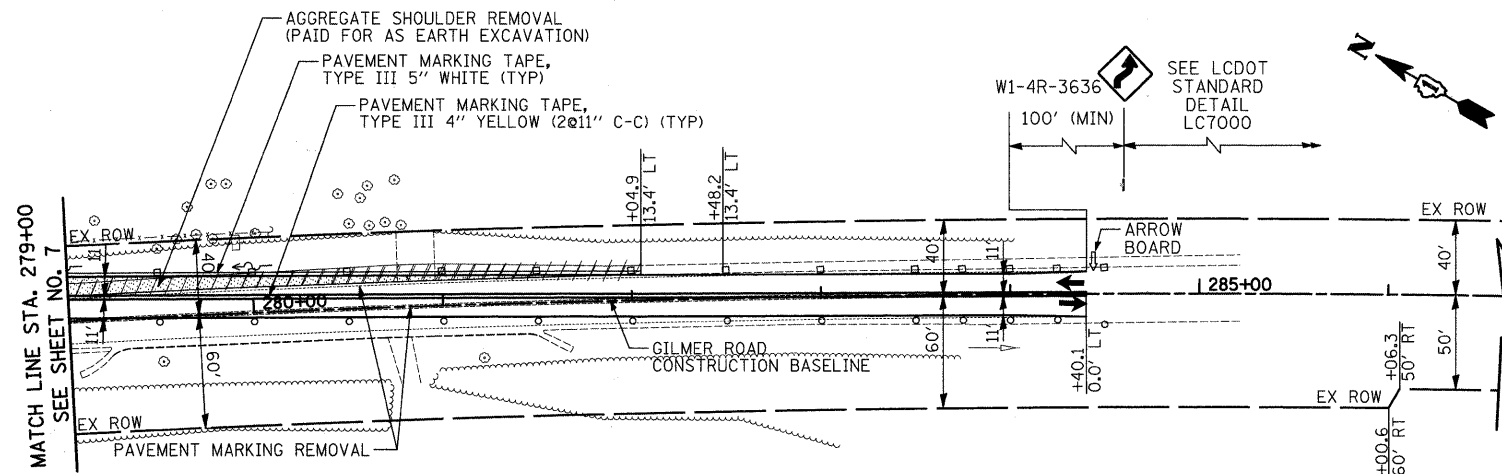

Superelevation Variables	
Radius of curve*	1000.000 ft.
Design speed =	45.000 mph
Width of lane =	11.000 ft.
e (BLRS Fig. 29-3B) =	0.055 f/f
Max Grade =	1.740 %
Normal Slope =	0.020 f/f
PC =	273+52.78, 37.78' LT
PT =	274+75.84, 37.76' LT
e <sub>max</sub>	6 %
RS (BLRS Fig. 29-3D) =	185.00
L <sub>1</sub> =	112.00 ft
TR =	41.00 ft

Superelevation Stationing and Elevations								
Transition Point	NB PGL	A =	Station	Offset	EB "e"	EB EOP	WB "e"	WB EOP
Normal	810.63	A =	272+37.99	30.81' LT	-0.020	810.41	-0.020	810.41
Zero	811.12	B =	272+78.92	33.30' LT	0.000	811.12	-0.020	810.90
Edge Breakpoint	811.57	C =	273+19.84	35.78' LT	0.020	811.79	-0.020	811.35
PC	811.91	D =	273+52.78	37.78' LT	0.036	812.31	-0.036	811.52
Start Super	812.32	E =	273+90.75	39.39' LT	0.055	812.92	-0.055	811.71
End Super	812.76	E =	274+37.88	39.38' LT	0.055	813.38	-0.055	812.15
PT	813.12	D =	274+75.84	37.76' LT	0.036	813.51	-0.036	812.72
Edge Breakpoint	813.40	C =	275+08.78	35.72' LT	0.020	813.62	-0.020	813.18
Zero	813.74	B =	275+49.70	33.19' LT	0.000	813.74	-0.020	813.52
Normal	814.07	A =	275+90.63	30.66' LT	-0.020	813.85	-0.020	813.85

**GILMORE ROAD - CONSTRUCTION STAGE 1 NOTES:**

FOR DRAINAGE INFORMATION SEE BIKE PATH SHEET NO. 10  
 ACCESS TO PRIVATE DRIVES MUST BE MAINTAINED AT ALL TIMES DURING CONSTRUCTION EXCEPT FOR PERIODS OF SHORT DURATION WHEN APPROVED BY THE ENGINEER AND IN ACCORDANCE WITH DETAIL LC7201.  
 TEMPORARY PAVEMENT MARKING TAPE, TYPE III SHALL BE USED WITHIN THE LIMITS OF EXISTING GILMER ROAD. TEMPORARY PAINT PAVEMENT MARKINGS SHALL BE USED ON ALL TEMPORARY PAVEMENT AREAS.

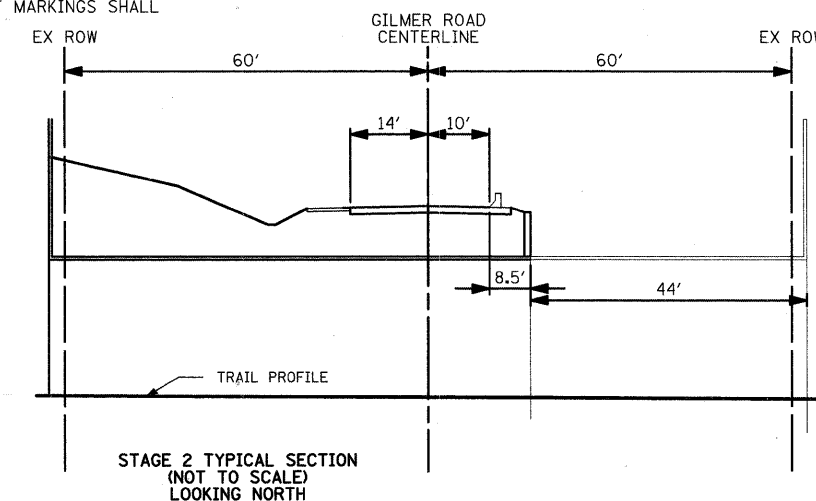
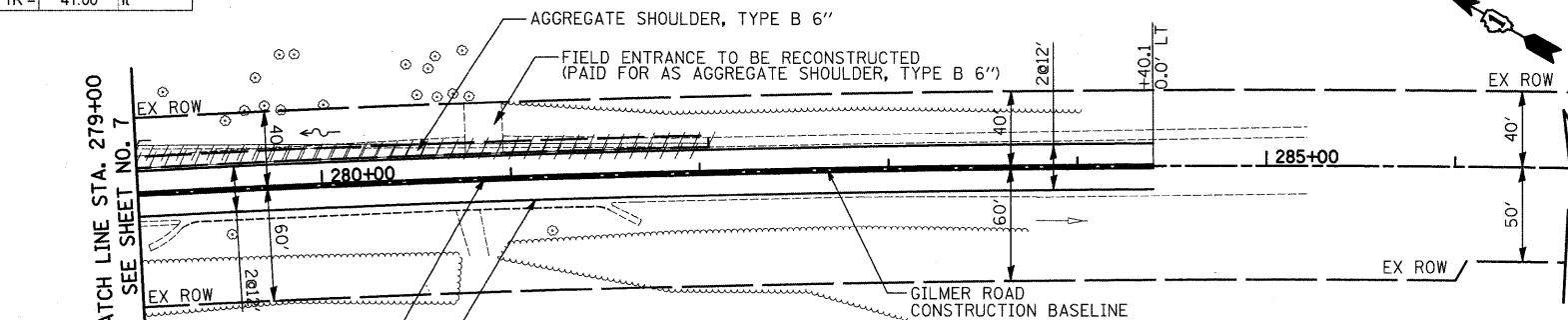

**GILMORE ROAD - CONSTRUCTION STAGE 2 NOTES:**

FOR DRAINAGE INFORMATION SEE BIKE PATH SHEET NO. 9  
 TEMPORARY PAVEMENT MARKING TAPE, TYPE III SHALL BE USED WITHIN THE LIMITS OF EXISTING GILMER ROAD. TEMPORARY PAVEMENT MARKING TAPE, TYPE III CONSTRUCTED DURING STAGE 1 SHALL BE REMOVED.  
 THE PAVEMENT PATCH OF GILMER ROAD SHALL BE CONSTRUCTED THROUGH TO BINDER COURSE WITH TEMPORARY PAVEMENT RAMPS AT EACH END AND WITH TEMPORARY PAINT PAVEMENT MARKINGS WITHIN THE CONSTRUCTED PATCH LIMITS.  
 UPON COMPLETION OF UNDERPASS WORK AND AT THE DIRECTION OF THE ENGINEER THE TEMPORARY SOIL RETENTION SYSTEM, CONCRETE BARRIERS AND TEMPORARY PAVEMENT RAMPS SHALL BE REMOVED, AND FINAL EARTHWORK GRADING, SHOULDER RESTORATION AND PERMANENT PAVEMENT MARKINGS SHALL BE COMPLETED.

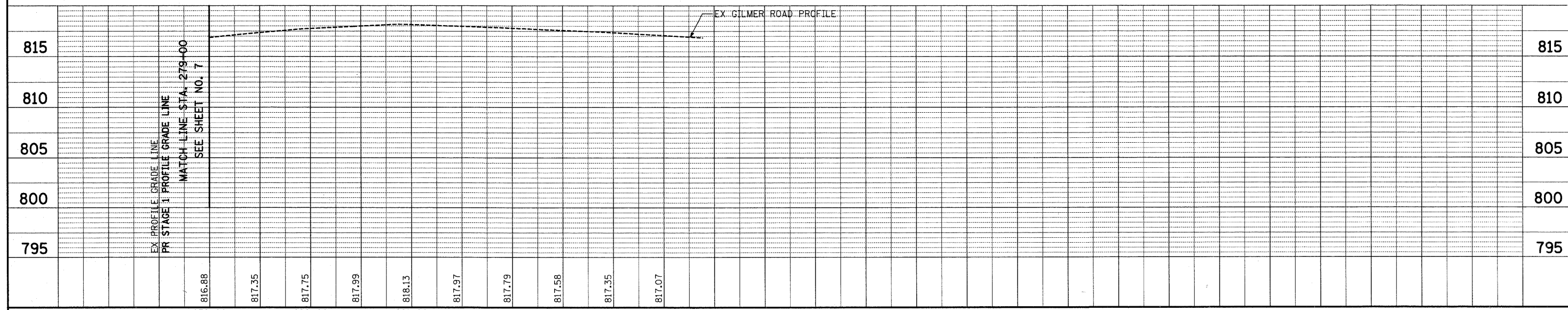

USER NAME = pk	DESIGNED - PK	REVISED -	<b>STATE OF ILLINOIS</b> <b>DEPARTMENT OF TRANSPORTATION</b>	VERT. 0 5 10 HORIZ. 0 50 100	<b>GILMER ROAD - ROADWAY PLAN &amp; PROFILE</b> <b>FORT HILL TRAIL BIKE PATH UNDERPASS</b>	F.A.U. RTE. 3602	SECTION 08-F3000-07-BT	COUNTY LAKE	TOTAL SHEETS 60	SHEET NO. 8
FILE NAME ...ced\sheet\04 PP\2130.RP_1.dgn	DRAWN - JRR	REVISED -				CONTRACT NO. 63422				
PLOT SCALE 50.0000 "/> <td>CHECKED - RTM</td> <td>REVISED -</td> <td colspan="3">FED. ROAD DIST. NO. 1 ILLINOIS FED. AID PROJECT</td>	CHECKED - RTM	REVISED -				FED. ROAD DIST. NO. 1 ILLINOIS FED. AID PROJECT				
PLOT DATE = 12/16/2010	DATE - 12/17/2010	REVISED -				SHEET NO. 2 OF 2 SHEETS STA. 279+00 TO STA. 284+40				