

F.A.U. RTE.	SECTION	COUNTY	TOTAL SHEETS	SHEET NO.
2332	03-14185-02-BR	KANE	73	1
FED. ROAD DIST. NO. 1	ILLINOIS	CONTRACT NO. 63521		

+1 = 74

STATE OF ILLINOIS  
DEPARTMENT OF TRANSPORTATION  
DIVISION OF HIGHWAYS

# PLANS FOR PROPOSED FEDERAL AID HIGHWAY

FOR INDEX OF SHEETS, SEE SHEET NO. 2

**PROJECT LOCATED IN ST. CHARLES TOWNSHIP**

F.A.U. RTE 2332 (BOLCUM ROAD)  
OVER FERSON CREEK  
SECTION 03-14185-02-BR  
PROJECT BHOS-00D(639)  
BRIDGE REMOVAL AND REPLACEMENT  
JOB NO. C-91-140-04  
KANE COUNTY

**TRAFFIC DATA**

2006 ADT = 4,650  
2030 ADT = 14,500  
DESIGN SPEED: 50 MPH

DESIGN DESIGNATION:  
1,000 (30) MAJOR COLLECTOR (HMA-20)

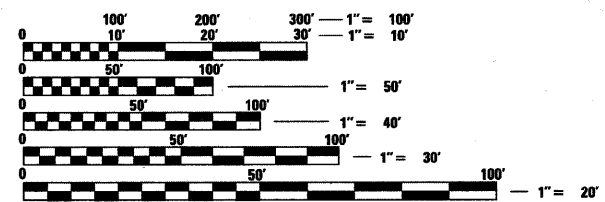

FULL SIZE PLANS HAVE BEEN PREPARED USING STANDARD ENGINEERING SCALES. REDUCED SIZED PLANS WILL NOT CONFORM TO STANDARD SCALES. IN MAKING MEASUREMENTS ON REDUCED PLANS, THE ABOVE SCALES MAY BE USED.

J.U.L.I.E.  
JOINT UTILITY LOCATION INFORMATION FOR EXCAVATION  
1-800-892-0123  
OR 811

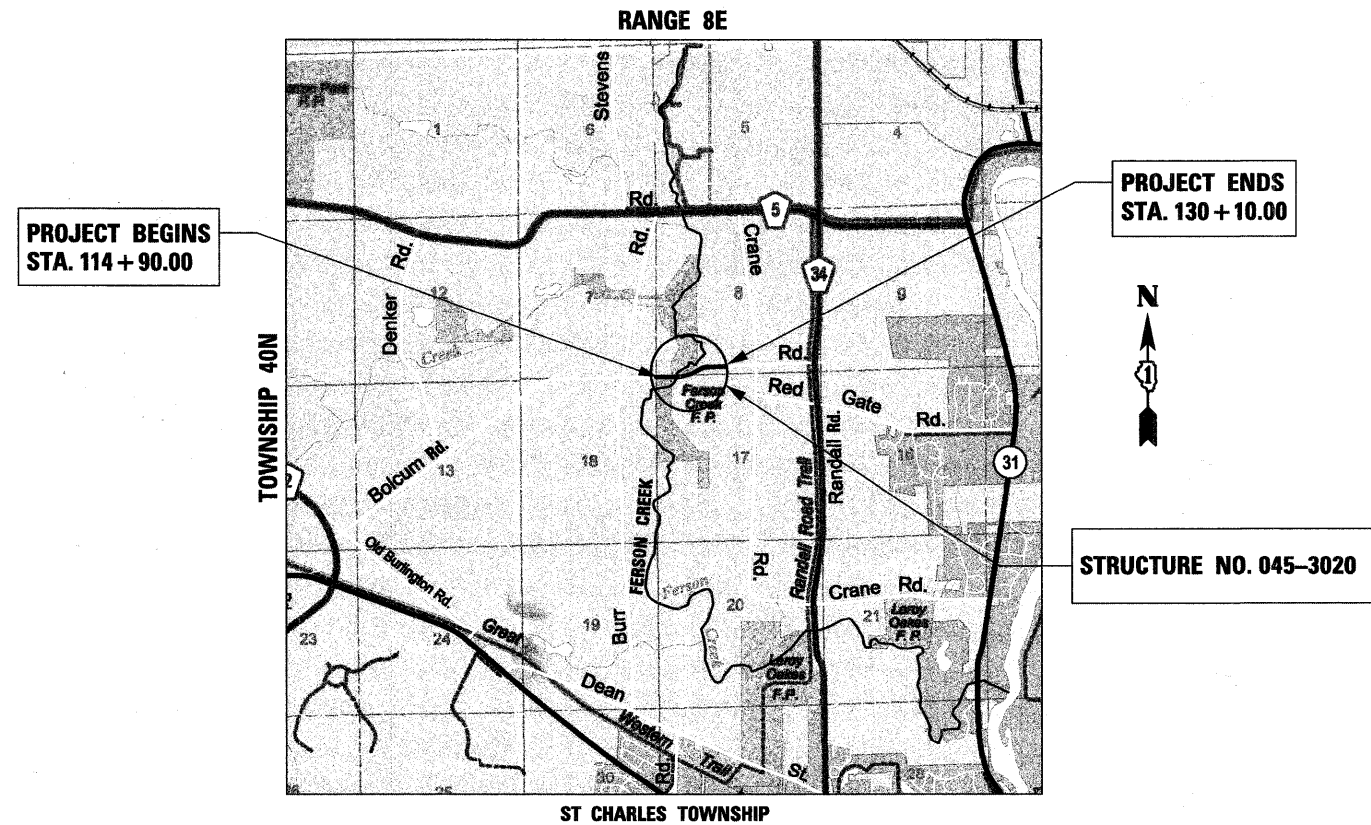

PROJECT NET AND GROSS LENGTH = 1520 FT (0.288 MILE)  
PROJECT LOCATED IN:  
PART OF SECTIONS 8 AND 17 IN TOWNSHIP 40N, RANGE 8E, OF THE THIRD PRINCIPAL MERIDIAN,  
KANE COUNTY, ILLINOIS



October 20, 2010  
*Kevin M. Anderson*  
KEVIN M. ANDERSON  
ILLINOIS REG. PROFESSIONAL ENGINEER NO. 062-055652  
EXPIRATION DATE 11-30-2011



STATE OF ILLINOIS  
DEPARTMENT OF TRANSPORTATION  
DIVISION OF HIGHWAYS

APPROVED October 20, 2010  
*Ronald Johnson*  
ST. CHARLES TOWNSHIP

PASSED NOVEMBER 5, 2010  
*Christoph Helt*  
DISTRICT 1 ENGINEER OF LOCAL ROADS & STREETS

RELEASING FOR BID  
BASED ON LIMITED  
REVIEW NOVEMBER 8, 2010  
*Diane M. O'Keefe*  
DEPUTY DIRECTOR OF HIGHWAYS, REGION 1 ENGINEER

**PRINTED BY THE AUTHORITY  
OF THE STATE OF ILLINOIS**

CONTRACT NO. 63521

PROGRAM AND OFFICE ENGINEER: CHARLES F. RIDDLE, P.E. (847) 705-4406 SCHAUMBURG, IL