

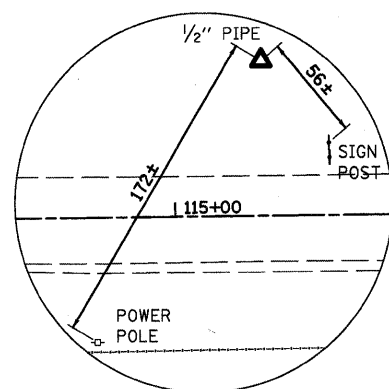

GRAPHIC SCALE

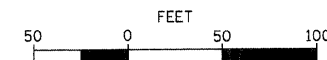

POINT NO. 51

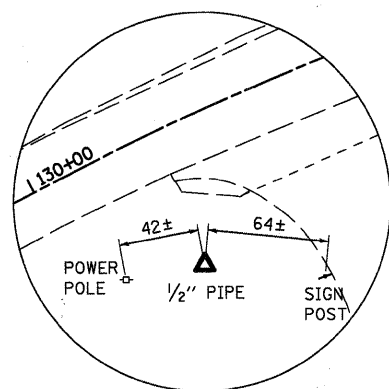

POINT NO. 53

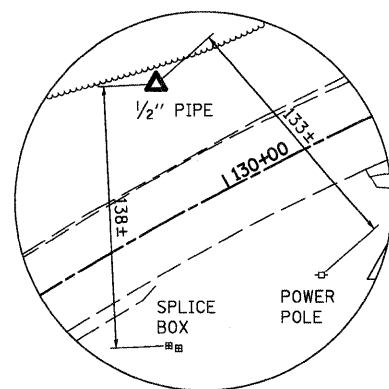

POINT NO. 104

EXIST./PROP. CURVE
 PI STA. = 125+54.61
 $\Delta = 34^\circ 05' 52''$ (LT)
 $D = 6^\circ 59' 56''$
 $R = 818.64'$
 $T = 251.05'$
 $L = 487.19'$
 $E = 37.63'$
 $e = 8\%$
 $T.R. = 48'$
 $S.E. RUN = 192'$
 $P.C. STA. = 123+03.56$
 $P.T. STA. = 127+90.75$

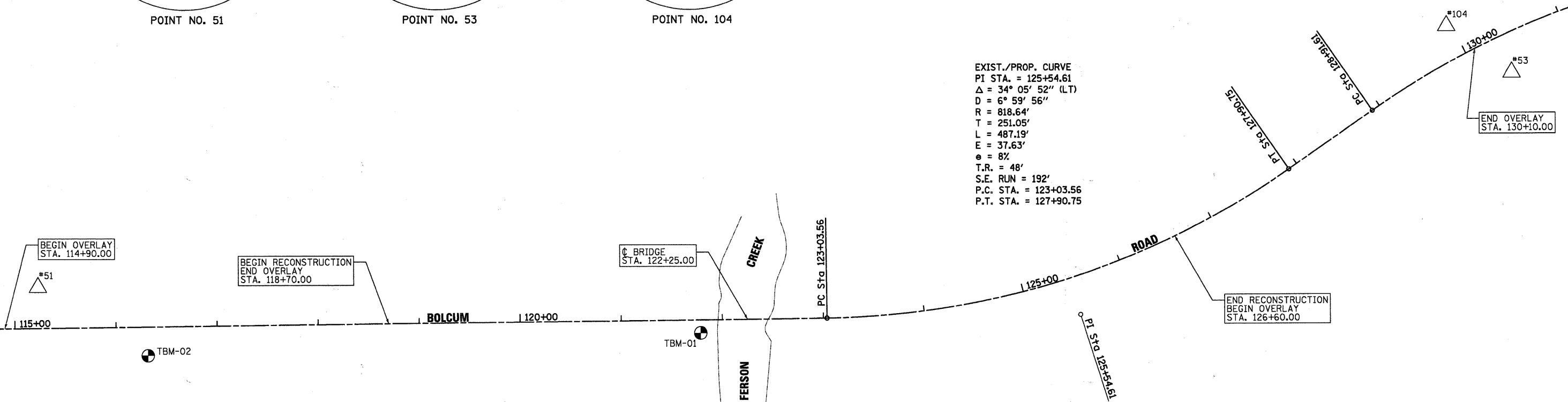

DATUM

HORIZONTAL: NAD 83
 VERTICAL: NAVD 29

LEGEND

- = TEMPORARY BENCHMARK LOCATION
- = HORIZONTAL CONTROL POINT LOCATION

CONTROL POINTS COORDINATE TABLE

POINT NO.	NORTHING	EASTING	STATION	OFFSET
51	1,926,467.908	976,995.117	115+23.25	40.76' LT
53	1,926,675.358	978,454.026	130+32.58	37.37' RT
104	1,926,721.856	978,389.566	129+95.61	33.06' LT

TBM ELEVATION DESCRIPTION

TBM	ELEVATION	DESCRIPTION
01	753.96	CHISLED 'X' ON THE SOUTHWESTERLY END OF SOUTH CONCRETE CURB OF BOLCUM ROAD BRIDGE OVER FERSON CREEK.
02	749.97	POINT LOCATED ON TOP OF THE SOUTHERLY END OF THE WESTERLY CULVERT PIPE UNDER BOLCUM ROAD, APPROXIMATELY 547 FEET WEST OF BOLCUM ROAD BRIDGE OVER FERSON CREEK.

FILE NAME = P:\CBBEL\WEST PROJECTS\2008\03\WBK\0322\Bolcum_Plan\CV1\0322\WBK\ATB_01.dgn



USER NAME = #USER#	DESIGNED -	REVISED -
	DRAWN -	REVISED -
PLOT SCALE =	CHECKED -	REVISED -
PLOT DATE = 10/21/2010	DATE - 10/22/10	REVISED -

**STATE OF ILLINOIS
 DEPARTMENT OF TRANSPORTATION**

**ALIGNMENT, TIES
 & BENCHMARKS**

SCALE: SHEET NO. 12 OF 73 SHEETS STA. 118+70 TO STA. 126+60

F.A.J. RTE. 2332	SECTION 03-14185-02-BR	COUNTY KANE	TOTAL SHEETS 73	SHEET NO. 12
CONTRACT NO. 63521				
FED. ROAD DIST. NO. 1 ILLINOIS FED. AID PROJECT				