

**ELECTRICAL LEGEND:**

- EXISTING ROADWAY LIGHTING FIXTURE TYPE A
- PROPOSED ROADWAY LIGHTING FIXTURE (POLE NUMBER AS SHOWN)
- E — PROPOSED 2#4 XLP-USE, 1#4 NEUTRAL, 1#6 GND. IN 1 1/4" UNIT DUCT. (30" MIN. BURY)
- GRS — PROPOSED GRS. CONDUIT SIZE AS NOTED (30" MIN. BURY)
- PROPOSED ELECTRICAL HANDHOLE
- PROPOSED ROADWAY LIGHTING CONTROLLER
- stub — PROPOSED CONDUIT STUB-OUT FOR FUTURE CIRCUITS
- DUCT MARKERS, SEE ELECTRICAL DETAIL-1

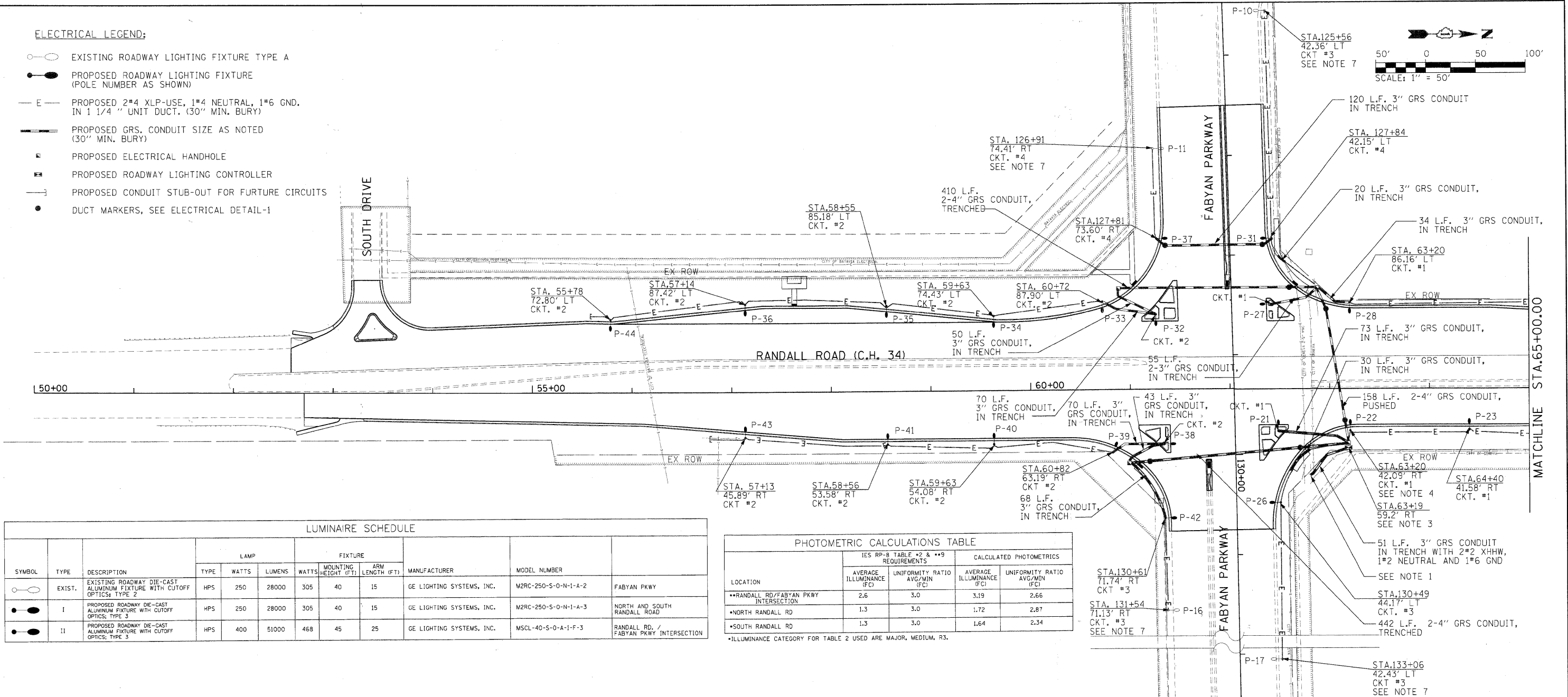
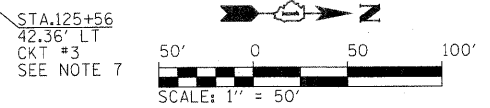

**LUMINAIRE SCHEDULE**

SYMBOL	TYPE	DESCRIPTION	LAMP			FIXTURE		MANUFACTURER	MODEL NUMBER	LOCATION	
			TYPE	WATTS	LUMENS	WATTS	MOUNTING HEIGHT (FT)				ARM LENGTH (FT)
○	EXIST.	EXISTING ROADWAY DIE-CAST ALUMINUM FIXTURE WITH CUTOFF OPTICS; TYPE 2	HPS	250	28000	305	40	15	GE LIGHTING SYSTEMS, INC.	M2RC-250-S-0-N-1-A-2	FABYAN PKWY
●	I	PROPOSED ROADWAY DIE-CAST ALUMINUM FIXTURE WITH CUTOFF OPTICS; TYPE 3	HPS	250	28000	305	40	15	GE LIGHTING SYSTEMS, INC.	M2RC-250-S-0-N-1-A-3	NORTH AND SOUTH RANDALL ROAD
●	II	PROPOSED ROADWAY DIE-CAST ALUMINUM FIXTURE WITH CUTOFF OPTICS; TYPE 3	HPS	400	51000	468	45	25	GE LIGHTING SYSTEMS, INC.	MSCL-40-S-0-A-1-F-3	RANDALL RD. / FABYAN PKWY INTERSECTION

**PHOTOMETRIC CALCULATIONS TABLE**

LOCATION	IES RP-8 TABLE #2 & #9 REQUIREMENTS		CALCULATED PHOTOMETRICS	
	AVERAGE ILLUMINANCE (FC)	UNIFORMITY RATIO AVG/MIN (FC)	AVERAGE ILLUMINANCE (FC)	UNIFORMITY RATIO AVG/MIN (FC)
••RANDALL RD/FABYAN PKWY INTERSECTION	2.6	3.0	3.19	2.66
•NORTH RANDALL RD	1.3	3.0	1.72	2.87
•SOUTH RANDALL RD	1.3	3.0	1.64	2.34

\*ILLUMINANCE CATEGORY FOR TABLE 2 USED ARE MAJOR, MEDIUM, R3.

8. CONTRACTOR SHALL CONNECT TEMPORARY INTERSECTION LIGHTING TO EXISTING LIGHTING CONTROLLER. EXISTING LIGHTING ON FABYAN PKWY AND TEMPORARY INTERSECTION LIGHTING SHALL BE MAINTAINED AND REMAINS OPERATIONAL UNTIL PROPOSED ROADWAY LIGHTING CONTROLLER IS OPERATIONAL.

**NOTES:**

1. EXISTING PAD MOUNTED UTILITY TRANSFORMER. CONTRACTOR SHALL INSTALL 2" GRS CONDUIT TO THE TRANSFORMER AND METER BASE ON SIDE OF LIGHTING CONTROLLER FOR NEW ELECTRIC SERVICE. COORDINATE ALL WORK WITH CITY OF GENEVA ELECTRIC UTILITY. CONTACT JENIFER HILKEMANN AT (630) 232-1503.
2. PROPOSED ROUTING OF CABLE IN UNIT DUCT AND CONDUIT IS SHOWN FOR INFORMATION ONLY. CONTRACTOR SHALL VERIFY EXACT ROUTING IN THE FIELD.
3. ALL SPLICES SHALL BE HEAT SHRINK AND WATERPROOF, INSTALLED INSIDE POLE BASE. DIRECT BURIED SPLICES AND SPLICES IN HANDHOLES SHALL NOT BE ALLOWED.
4. INSTALL PHOTOCCELL ON TOP OF POLE P-22. INSTALL 3#12 XLP-USE, 1#12 GND. IN 3/4" GRS CONDUIT TO THE CONTROLLER.
5. EXISTING ROADWAY LIGHTING CONTROLLER AND TRANSITION LIGHTING FOR FABYAN PARKWAY SHALL REMAIN IN SERVICE UNTIL NEW ROADWAY LIGHTING CONTROLLER IS ENERGIZED AND TESTED.
6. REFER TO IDOT STANDARD 814001-02 FOR HANDHOLE DETAILS.
7. CONNECT PROPOSED ROADWAY LIGHTING CIRCUIT TO EXISTING CIRCUIT INSIDE LIGHT POLE BASE. COST SHALL BE INCIDENTAL TO THE INSTALLATION OF PROPOSED CABLE.

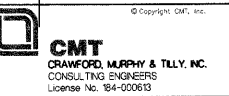
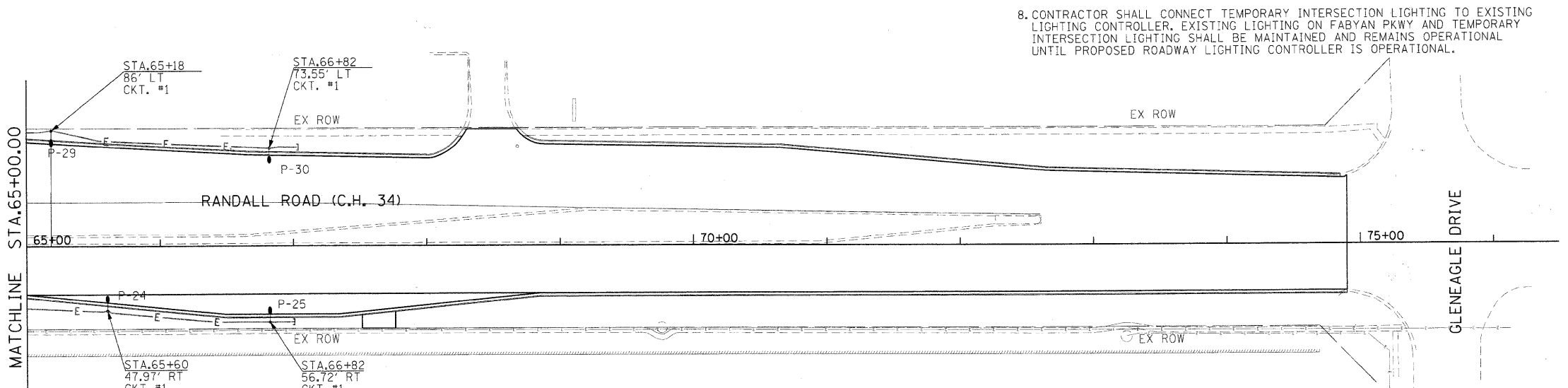

USER NAME = Matt Baldwin  
 DESIGNED - AS  
 DRAWN - ERD  
 CHECKED - AB  
 DATE - 12/29/2010

REVISED -  
 REVISED -  
 REVISED -  
 REVISED -

**STATE OF ILLINOIS  
 DEPARTMENT OF TRANSPORTATION**

**ELECTRICAL LIGHTING PLAN**

SCALE: 1"=50' SHEET NO. 1 OF 4 SHEETS STA. TO STA.

F.A.P. RTE.	SECTION	COUNTY	TOTAL SHEETS	SHEET NO.
336	01-00269-00-CH	KANE	124	82
CONTRACT NO. 63533				
ILLINOIS FED. AID PROJECT				