

NOTE: CROSS-SECTIONS DO NOT SHOW UNDERCUT OF UNSUITABLE MATERIAL. ANTICIPATED LOCATION AND AMOUNT OF UNDERCUT ARE SHOWN ON SHEET 13.

DATE	
BY	
SURVEYED	
PLotted	
NOTE BOOK	
AREAS CHECKED	
NO.	

DATE	
BY	
SURVEYED	
PLotted	
NOTE BOOK	
AREAS CHECKED	
NO.	

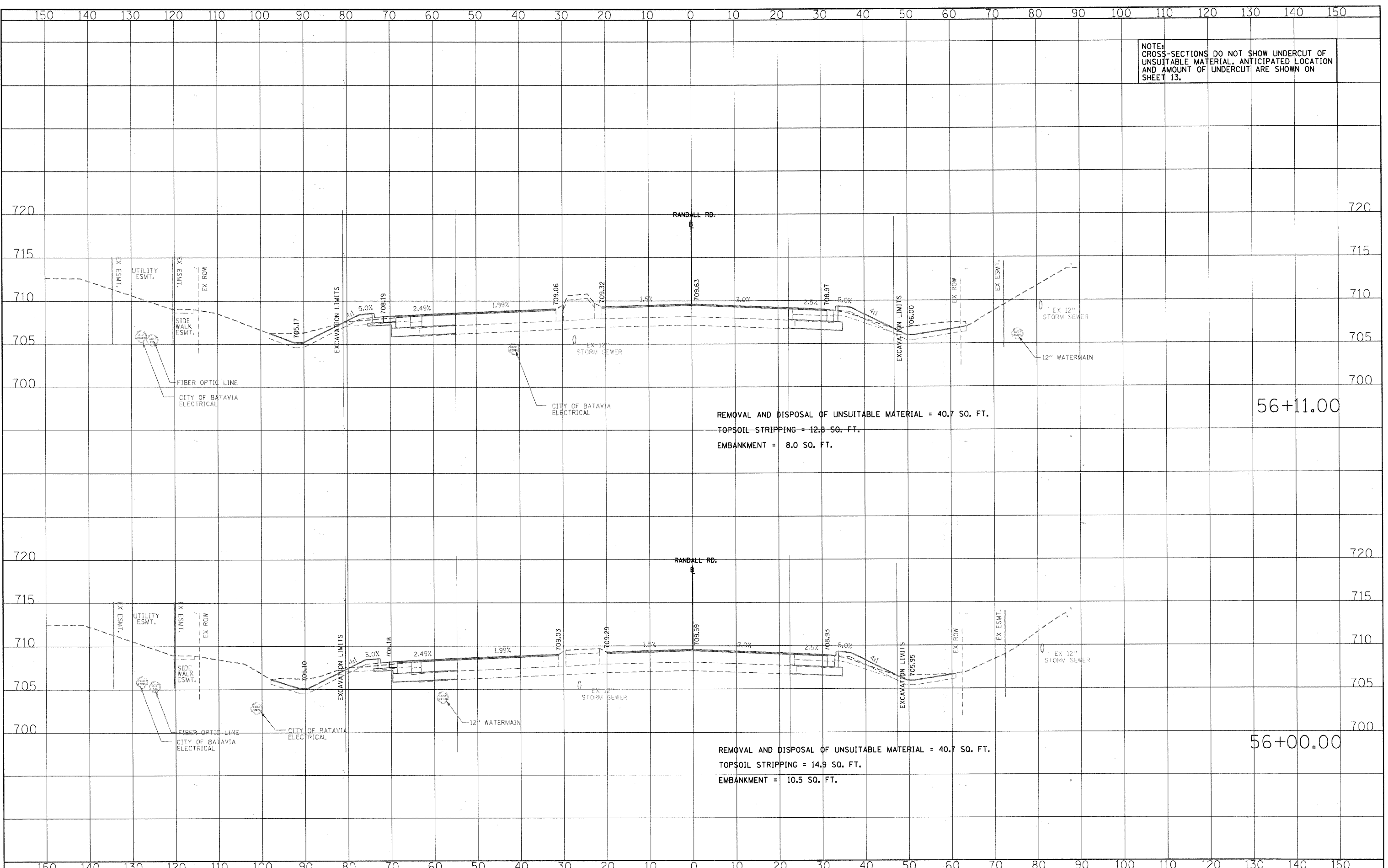

REMOVAL AND DISPOSAL OF UNSUITABLE MATERIAL = 40.7 SQ. FT.
 TOPSOIL STRIPPING = 12.8 SQ. FT.
 EMBANKMENT = 8.0 SQ. FT.

56+11.00

REMOVAL AND DISPOSAL OF UNSUITABLE MATERIAL = 40.7 SQ. FT.
 TOPSOIL STRIPPING = 14.9 SQ. FT.
 EMBANKMENT = 10.5 SQ. FT.

56+00.00

CMT
 CRAWFORD, MURPHY & TILLY, INC.
 CONSULTING ENGINEERS
 License No. 184-000613

USER NAME = Matt Baldwin	DESIGNED - PWK	REVISED -
	DRAWN - ERD	REVISED -
PLLOT SCALE = 10.0000' / IN.	CHECKED - KDF	REVISED -
PLLOT DATE = 12/29/2010	DATE -	REVISED -

**STATE OF ILLINOIS
 DEPARTMENT OF TRANSPORTATION**

RANDALL ROAD CROSS-SECTIONS

SCALE: 1" = 10' SHEET NO. OF SHEETS STA. 56+00.00 TO STA. 56+11.00

F.A.P. RTE. 336	SECTION 01-00269-00-CH	COUNTY KANE	TOTAL SHEETS 124	SHEET NO. 91
CONTRACT NO. 63533				ILLINOIS FED. AID PROJECT