

UNION ROAD

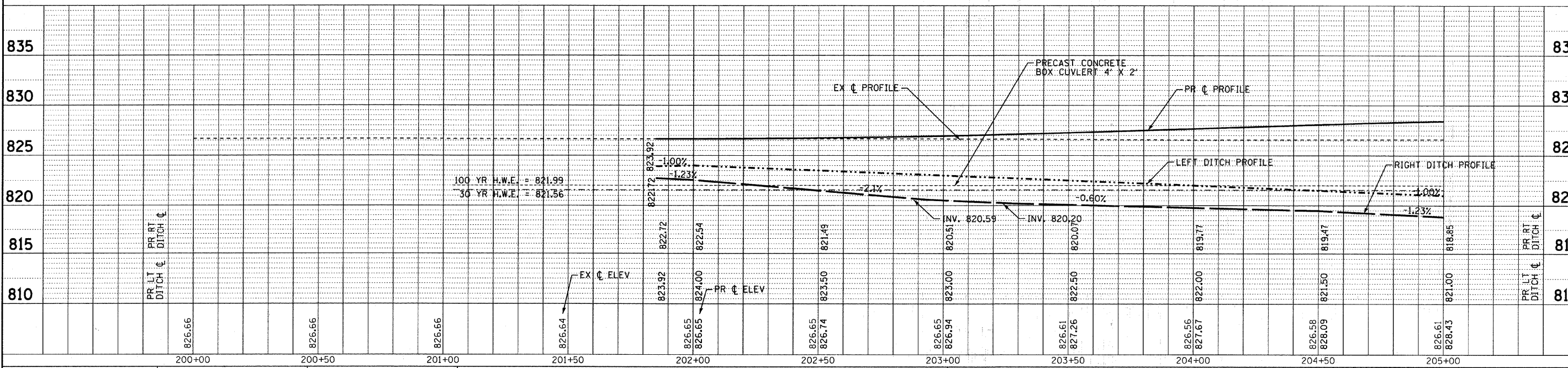

COPYRIGHT © 2010 BY BAXTER & WOODMAN, INC. ...
 STATE OF ILLINOIS - PROFESSIONAL DESIGN FIRM
 EXP. NO. 061725 AM
 PROJECT: 070630-PH2-UNION-DUL-18

	DESIGNED - CAC	REVISED - PER IDOT 10-08-10
	DRAWN - BCD	REVISED -
	CHECKED - MDW	REVISED -
	DATE - 08/20/10	FILE - 070630-PH2-UNION-DUL.shp

MCHENRY COUNTY DIVISION OF TRANSPORTATION
UNION ROAD BRIDGE OVER
SOUTH BRANCH OF KISHWAUKEE RIVER

DRAINAGE & UTILITY PLAN	
SCALE: H: 1"=20' V: 1"=5'	STA. 200+20 TO STA. 205+00

F.A.S. RTE. 0034	SECTION 06-00320-02-BR	COUNTY MCHENRY	TOTAL SHEETS 65	SHEET NO. 17
JOB NO. C-91-140-11			ILLINOIS FED. AID PROJECT	
			CONTRACT NO. 63536	
			BRS-00341071	