

- NOTES:**
- CONSTRUCTION JOINTS BETWEEN PAVED DITCH AND ADJACENT SECTIONS OF EXISTING OR PROPOSED SLOPE WALL SHALL BE FILLED WITH PREFORMED JOINT FILLER, ACCORDING TO THE REQUIREMENTS OF ARTICLE 503.10(B) OF THE STANDARD SPECIFICATIONS. COST INCLUDED WITH PAVED DITCH, TYPE A-45.
 - CONTRACTOR SHALL ENSURE CATCH BASIN INSTALLATION WILL NOT CONFLICT WITH GUARDRAIL POST LOCATIONS.

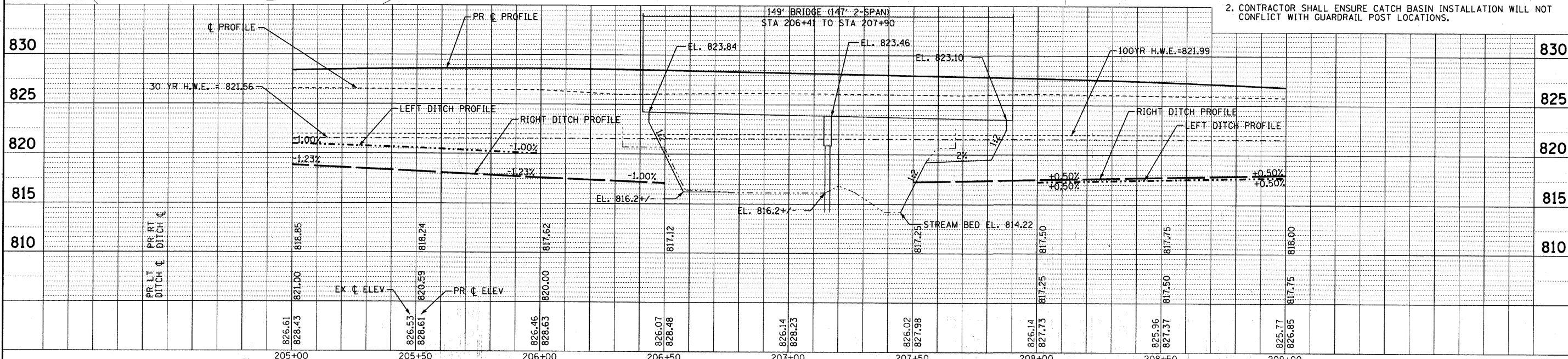

DESIGNED BY: BAXTER & WOODMAN, INC.
 STATE OF ILLINOIS PROFESSIONAL ENGINEER
 LICENSE NO. 184-00221 - EXPIRES 1/30/2018
 1/27/2018 9:17:14 AM
 PROJECT: MCHENRY COUNTY DIVISION OF TRANSPORTATION
 PROJECT NO. 06-00320-02-BR
 SHEET NO. 65 OF 18
 CONTRACT NO. 63536

	DESIGNED - CAC	REVISED - PER IDOT 10-08-10	MCHENRY COUNTY DIVISION OF TRANSPORTATION UNION ROAD BRIDGE OVER SOUTH BRANCH OF KISHWAUKEE RIVER	DRAINAGE & UTILITY PLAN		F.A.S. RTE. 0034	SECTION 06-00320-02-BR	COUNTY MCHENRY	TOTAL SHEETS 65	SHEET NO. 18		
	DRAWN - BCD	REVISED -		SCALE: H: 1"=20' V: 1"=5'		STA. 205+00 TO STA. 209+00	JOB NO. C-91-140-11	ILLINOIS FED. AID PROJECT	CONTRACT NO. 63536			
	CHECKED - MDW	REVISED -		DATE - 08/20/10		FILE - 070630-PH2-UNION-DU2.sh1						
	DATE - 08/20/10	FILE - 070630-PH2-UNION-DU2.sh1										