

LEGEND

- | | | | |
|--|--|--|---|
| | SEEDING, CLASS 2A | | SEEDING, CLASS 4 (MOD)
DETENTION BASIN |
| | SEEDING, CLASS 4 (MOD) MESIC PRAIRIE
SEEDING, CLASS 5 (MOD) MESIC PRAIRIE | | SEEDING, CLASS 3 |
| | SEEDING, CLASS 4 (MOD) WET-MESIC
SEEDING, CLASS 5 (MOD) WET-MESIC | | EXISTING RIPRAP |

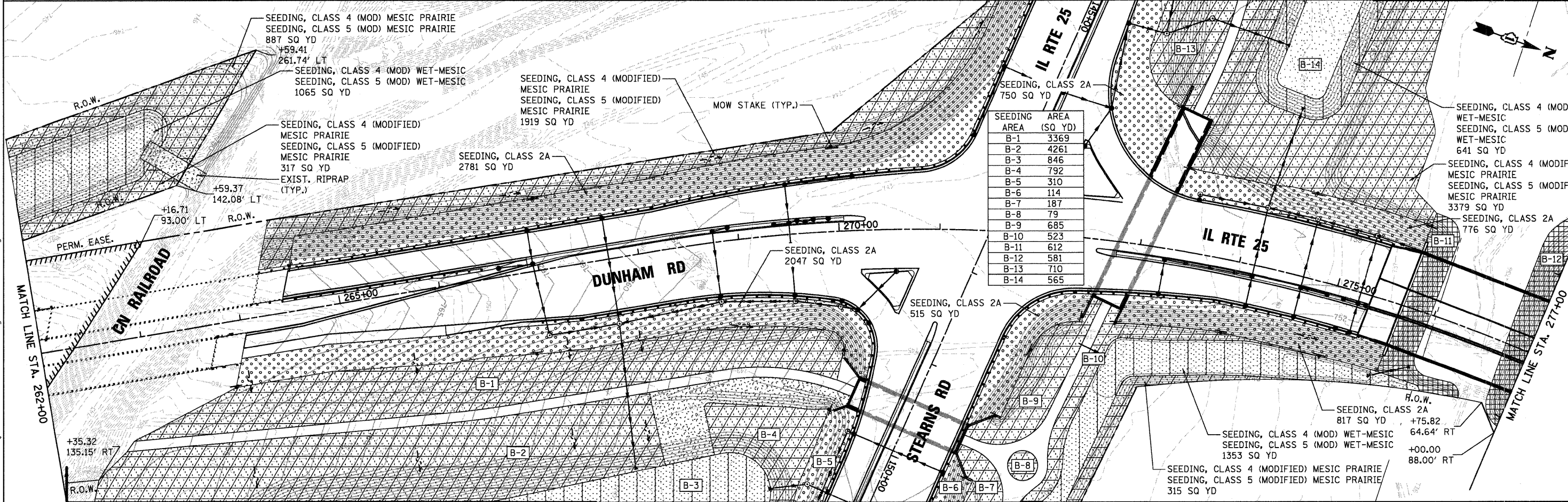
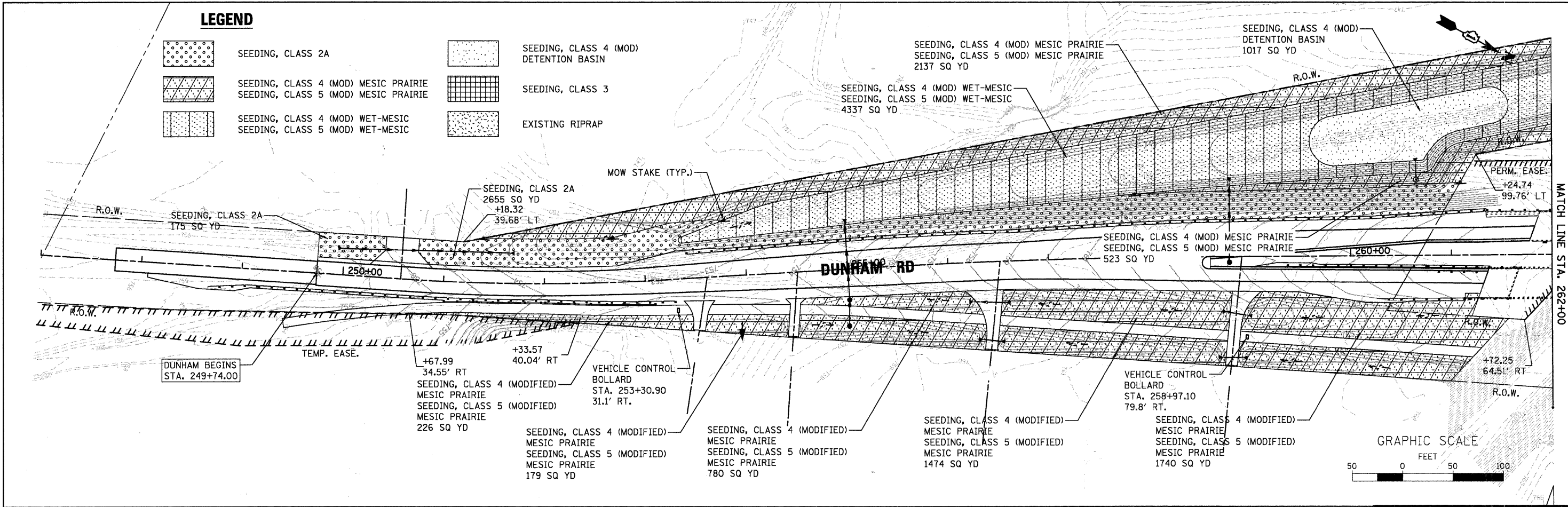

WILLS BURKE KELSEY ASSOCIATES LTD.
116 West Main Street, Suite 201
St. Charles, Illinois 60174
(630) 443-7755

USER NAME = #USER#	DESIGNED - LL	REVISED -
PLOT SCALE = AS SHOWN	DRAWN - NP	REVISED -
PLOT DATE = 12/17/2010	CHECKED -	REVISED -
	DATE - 12/17/10	REVISED -

STATE OF ILLINOIS
DEPARTMENT OF TRANSPORTATION

SEEDING PLANS
DUNHAM ROAD /IL RTE 25

SCALE: AS SHOWN SHEET NO. 34 OF 80 SHEETS STA. 247+74.0 TO STA. 277+00.0

F.A.P. RTE. 361	SECTION 09-00214-02-LS	COUNTY KANE/DUPAGE	TOTAL SHEETS 80	SHEET NO. 34
FED. ROAD DIST. NO. 1 (ILLINOIS) FED. AID PROJECT				
CONTRACT NO. 63542				