

HUNTLEY ROAD

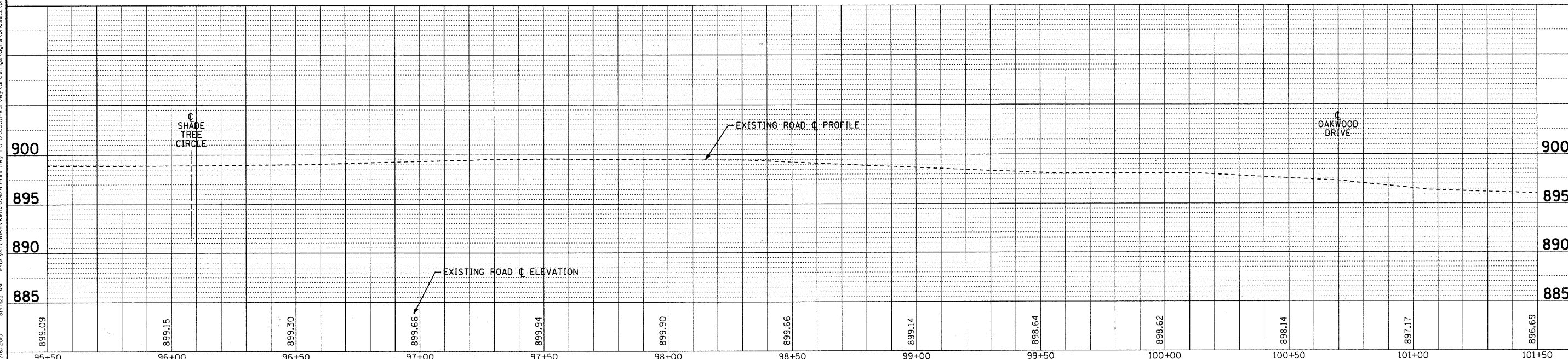

COPYRIGHT © 2010 BY BAXTER & WOODMAN, INC.
 STATE OF ILLINOIS - PROFESSIONAL DESIGN FIRM
 LICENSE NO. BR-00187083-EN, 1/2/2011
 1000 WOODMAN DRIVE, SUITE 200, BLOOMINGTON, IL 61710
 309-244-2000 FAX 309-244-2001
 www.baxterandwoodman.com

	DESIGNED - DSH	REVISED - 12/16/10 PER IDOT	VILLAGE OF LAKEWOOD, ILLINOIS HUNTLEY ROAD BICYCLE TRAIL	PLAN AND PROFILE HUNTLEY ROAD		F.A.U. RTE.	SECTION	COUNTY	TOTAL SHEETS	SHEET NO.
	DRAWN - MAC	REVISED -				0118	10-00011-00-BT	MCHENRY	35	10
	CHECKED - JJF	REVISED -				CONTRACT NO. 63545				
	DATE - 12/16/10	FILE - ph2-091263-pd4.sht				FED. ROAD DIST. NO. 1 ILLINOIS FED. AID PROJECT CMM-9003(628)				

SCALE: H: 1"=20' V: 1"=5'

STA. 95+50 TO STA. 101+50