

STORM STRUCTURES						
NO.	STATION	OFFSET	TYPE	FRAME	RIM/EP	INVERTS
S-5	91+46	19.8' RT	INLET, TYPE A	TY 1 FR, OLID	897.79	895.37 12" N
S-6	92+70	22.0' RT	INLET, TYPE A	TY 1 FR, OLID	897.30	894.87 12" S, 894.77 12" N
S-7	92+31	19.0' RT	INLET, TYPE A	TY 1 FR, OLID	897.30	894.53 12" S, 894.43 12" N
S-8	93+48	24.4' LT	INLET, TYPE A	TY 1 FR, OLID	897.23	894.53 12" S, 894.25 12" N
S-9	94+39	20.3' RT	INLET, TYPE A	TY 1 FR, OLID	897.50	893.99 12" S, 893.89 12" N
S-10	94+40	22.9' LT	INLET, TYPE A	TY 1 FR, OLID	897.20	893.80 12" S, 893.60 12" N
S-10A	94+90	22.9' LT	CATCH BASIN, TYPE C	TY 1 FR, OLID	896.97	893.36 12" S, 893.16 12" N
S-11	95+38	22.0' LT	CATCH BASIN, TYPE C	TY 1 FR, OLID	897.08	893.22 12" E & N, 893.12 12" S
S-11A	95+39	21.1' RT	INLET, TYPE A	TY 1 FR, OLID	897.40	893.49 12" S, 893.39 12" W, 894.00 12" N
DW-4	94+98	22.9' LT	DRYWELL	TY 1 FR, CLID	897.50	893.00 12" S, 892.96 12" N, BOT 889.50
FES-13	92+64	25.0' LT	PRC FLARED END SECTION	--	--	896.60 12" N

STORM PIPES					
NO.	TYPE	LENGTH (LF)	DIA (IN)	SLOPE	TBF (CY)
P-10	SS, CL A, TYPE 1 (RUBBER GASKET)	124	12	0.40%	4.4
P-11	SS, CL A, TYPE 1 (RUBBER GASKET)	61	12	0.40%	4.5
P-12	SS (WATER MAIN REQ.)	77	12	2.50%	3.4
P-13	SS, CL A, TYPE 1 (RUBBER GASKET)	109	12	0.40%	7.6
P-14	SS (WATER MAIN REQ.)	91	12	0.50%	6.4
P-15	SS, CL A, TYPE 1 (RUBBER GASKET)	100	12	0.40%	9.9
P-15A	SS, CL A, TYPE 1 (RUBBER GASKET)	43	12	0.40%	12.3
P-16	SS (WATER MAIN REQ.)	48	12	0.50%	7.5
P-16A	SS (WATER MAIN REQ.)	8	12	2.00%	0.0
P-17	SS (WATER MAIN REQ.)	40	12	0.40%	8.5

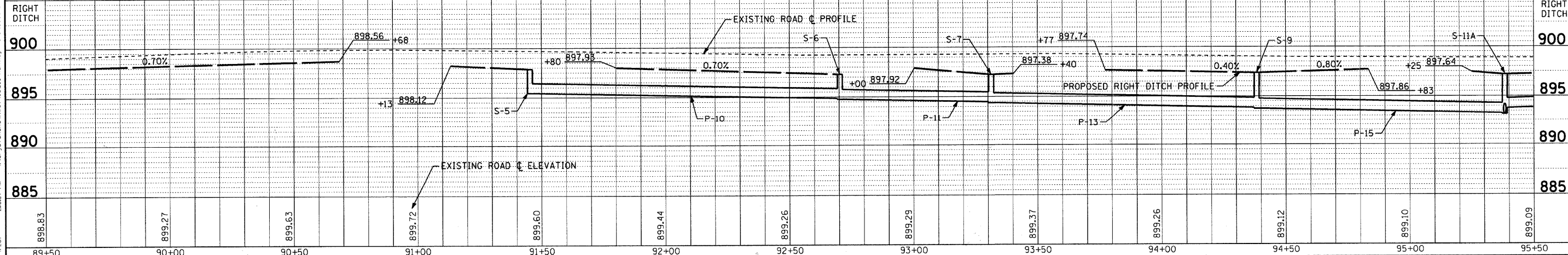
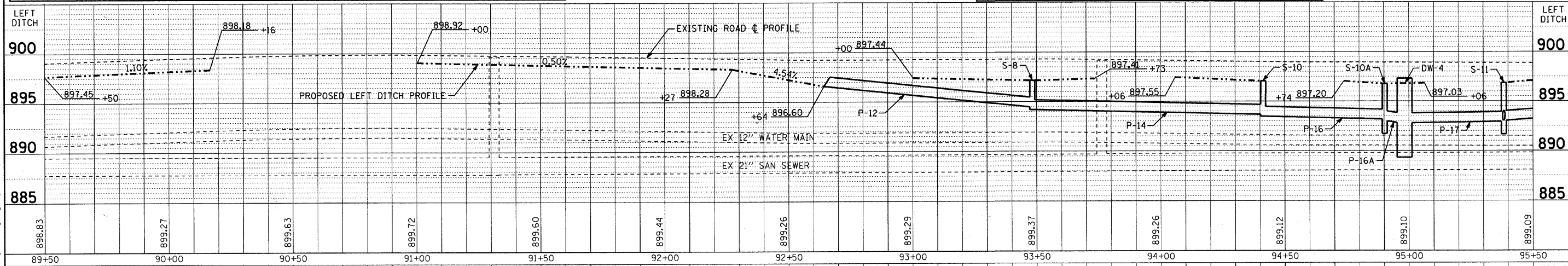

WOODMAN
Consulting Engineers

DESIGNED - DSH
DRAWN - MAC
CHECKED - JJF
DATE - 12/16/10

VILLAGE OF LAKEWOOD, ILLINOIS
HUNTLEY ROAD
BICYCLE TRAIL

DRAINAGE & UTILITY
HUNTLEY ROAD

F.A. RTE. 0118
SECTION 10-00011-00-BT
COUNTY MCHENRY
TOTAL SHEETS 35
SHEET NO. 17
CONTRACT NO. 63545
FED. ROAD DIST. NO. 1 ILLINOIS FED. AID PROJECT CMM-9003(628)

SCALE: H: 1"=20' V: 1"=5' STA. 89+50 TO STA. 95+50

PROJECT # 2010 BY BAXTER & WOODMAN, INC.
 STATE OF ILLINOIS - PROFESSIONAL DESIGN FIRM
 LICENSE NO. 084-00187 - EXP. 01/31/2011
 I:\projects\10-00011-00-BT\10-00011-00-BT.dwg
 1/2/2011