

**LEGEND**

	PAVEMENT REMOVAL		HOT-MIX ASPHALT SURFACE REMOVAL
	DRIVEWAY PAVEMENT REMOVAL		COMB. CURB AND GUTTER REMOVAL
	HMA BIKE PATH REMOVAL (TO BE PAID AS SIDEWALK REMOVAL)		

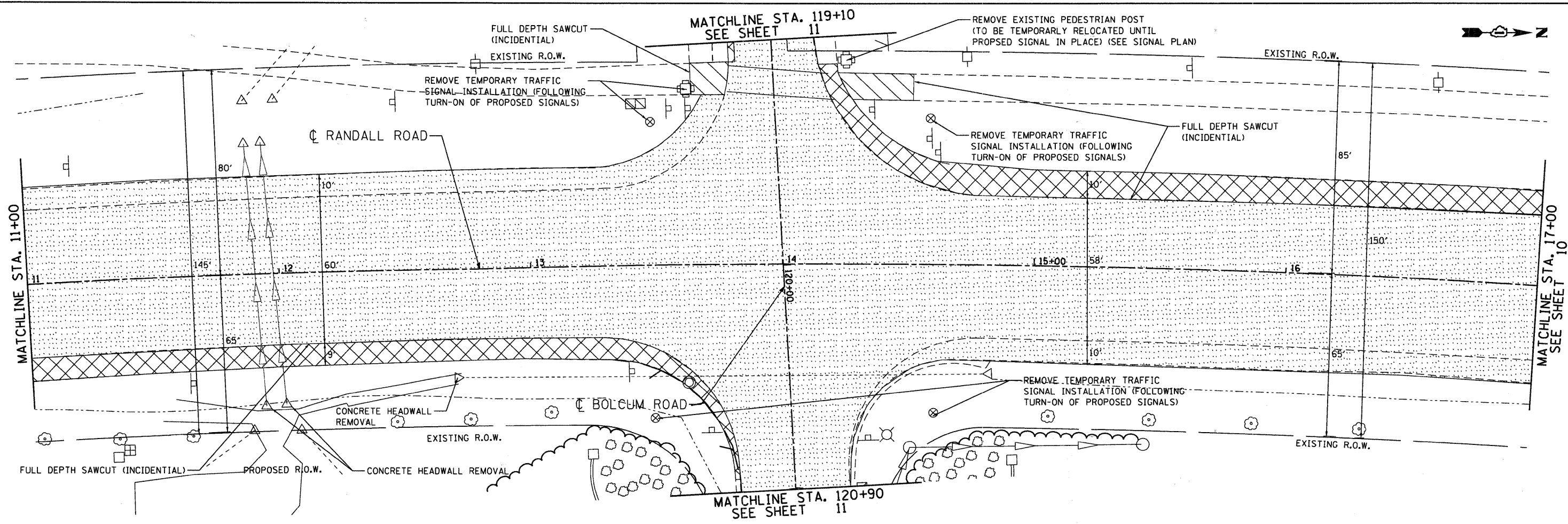

FILE NAME = m:\pcc\3383\design\Remove\3383-ranBldg.dgn

**Ciorba Group, Inc.**  
 CONSULTING ENGINEERS  
 5507 North Cumberland Avenue, Suite 402  
 Chicago, Illinois 60656  
 Tel. 773.775.4009 Fax 773.775.4014

USER NAME = espino	DESIGNED - CLG	REVISED -
PLOT SCALE = 20.0000' / IN.	DRAWN - EPS	REVISED -
PLOT DATE = 12/28/2010	CHECKED - MJL	REVISED -
	DATE - 12-20-2010	REVISED -

**KANE COUNTY DIVISION OF TRANSPORTATION**

**EXISTING CONDITION AND REMOVAL PLAN**  
 SCALE: 1" = 20'  
 SHEET NO. OF SHEETS STA. TO STA.

F.A.S. RTE. 336	SECTION 04-00325-00-TL	COUNTY KANE	TOTAL SHEETS 54	SHEET NO. 9
FED. ROAD DIST. NO. 1 (ILLINOIS) FED. AID PROJECT				

CONTRACT NO. 63547