

DATE	
BY	
REVISIONS	
PLANNED	
NOTED	
PLANNED	
NOTED	
PLANNED	
NOTED	

DATE	
BY	
REVISIONS	
PLANNED	
NOTED	
PLANNED	
NOTED	
PLANNED	
NOTED	

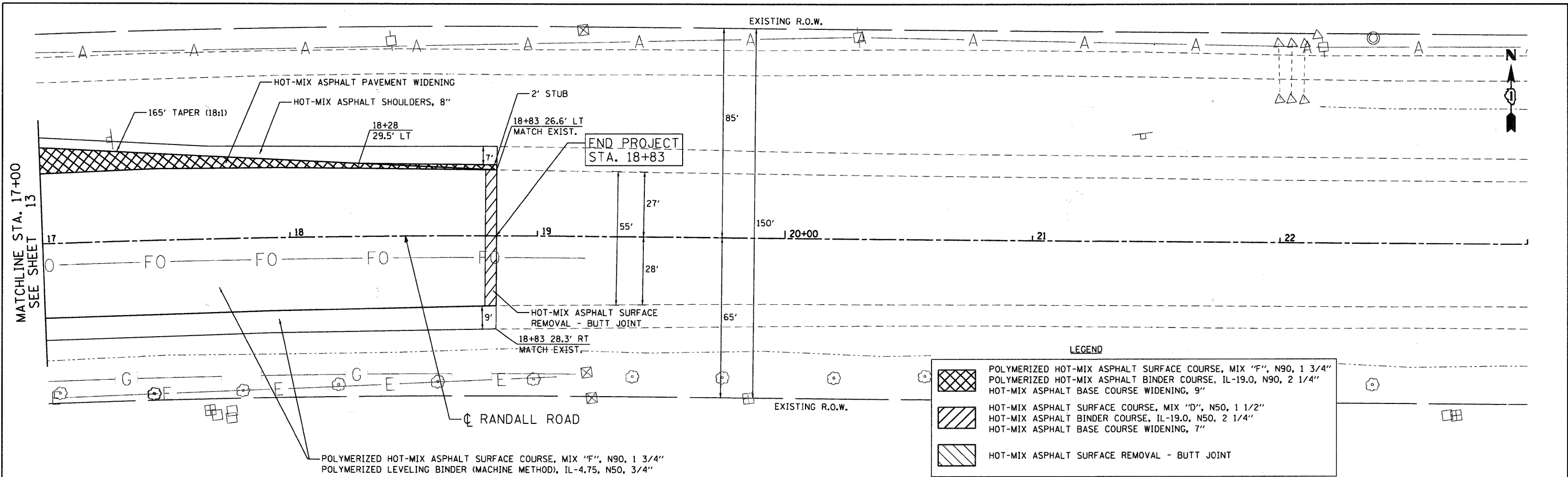

**LEGEND**

	POLYMERIZED HOT-MIX ASPHALT SURFACE COURSE, MIX "F", N90, 1 3/4"
	POLYMERIZED HOT-MIX ASPHALT BINDER COURSE, IL-19.0, N90, 2 1/4"
	HOT-MIX ASPHALT BASE COURSE WIDENING, 9"
	HOT-MIX ASPHALT SURFACE COURSE, MIX "D", N50, 1 1/2"
	HOT-MIX ASPHALT BINDER COURSE, IL-19.0, N50, 2 1/4"
	HOT-MIX ASPHALT BASE COURSE WIDENING, 7"
	HOT-MIX ASPHALT SURFACE REMOVAL - BUTT JOINT

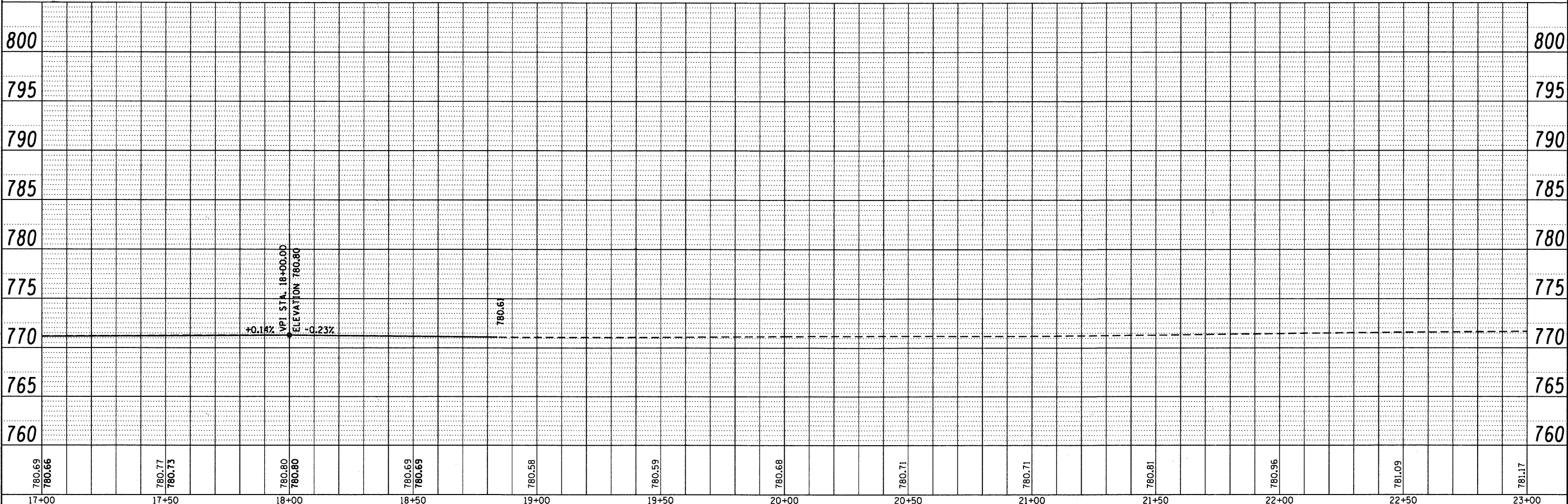

780.69	780.66	780.77	780.73	780.80	780.80	780.69	780.69	780.58	780.59	780.68	780.71	780.71	780.81	780.96	781.09	781.17
17+00	17+50	18+00	18+50	19+00	19+50	20+00	20+50	21+00	21+50	22+00	22+50	23+00				

**Ciorba Group, Inc.**  
 CONSULTING ENGINEERS  
 5507 North Cumberland Avenue, Suite 402  
 Chicago, Illinois 60656  
 Tel. 773.775.4009 Fax 773.775.4014

USER NAME = espina	DESIGNED - CLG	REVISED -
PLLOT SCALE = 20.0000' / IN.	DRAWN - EPS	REVISED -
PLLOT DATE = 12/20/2010	CHECKED - MJL	REVISED -
	DATE - 12-20-2010	REVISED -

**KANE COUNTY DIVISION OF TRANSPORTATION**

**PROPOSED PLAN AND PROFILE**

SCALE: 1" = 20' SHEET NO. OF SHEETS STA. TO STA.

F.A.P. RTE. 336	SECTION 04-00325-00-TL	COUNTY KANE	TOTAL SHEETS 54	SHEET NO. 14
CONTRACT NO. 63547				
FED. ROAD DIST. NO. 1 ILLINOIS FED. AID PROJECT				