

SUGGESTED SEQUENCE OF CONSTRUCTION

STAGE I

1. GRIND OFF EXISTING PAVEMENT MARKINGS IN CONFLICT WITH TEMPORARY PAVEMENT MARKINGS.
2. REMOVE EXISTING RECESSED REFLECTIVE PAVEMENT MARKERS IN CONFLICT WITH TEMPORARY PAVEMENT MARKINGS. REMOVE REFLECTORS ONLY OUTSIDE OF PROJECT LIMITS.
3. INSTALL STAGE I TRAFFIC CONTROL
4. INSTALL STAGE I EROSION CONTROL
5. COMPLETE STAGE I WIDENING UP TO BINDER COURSE.

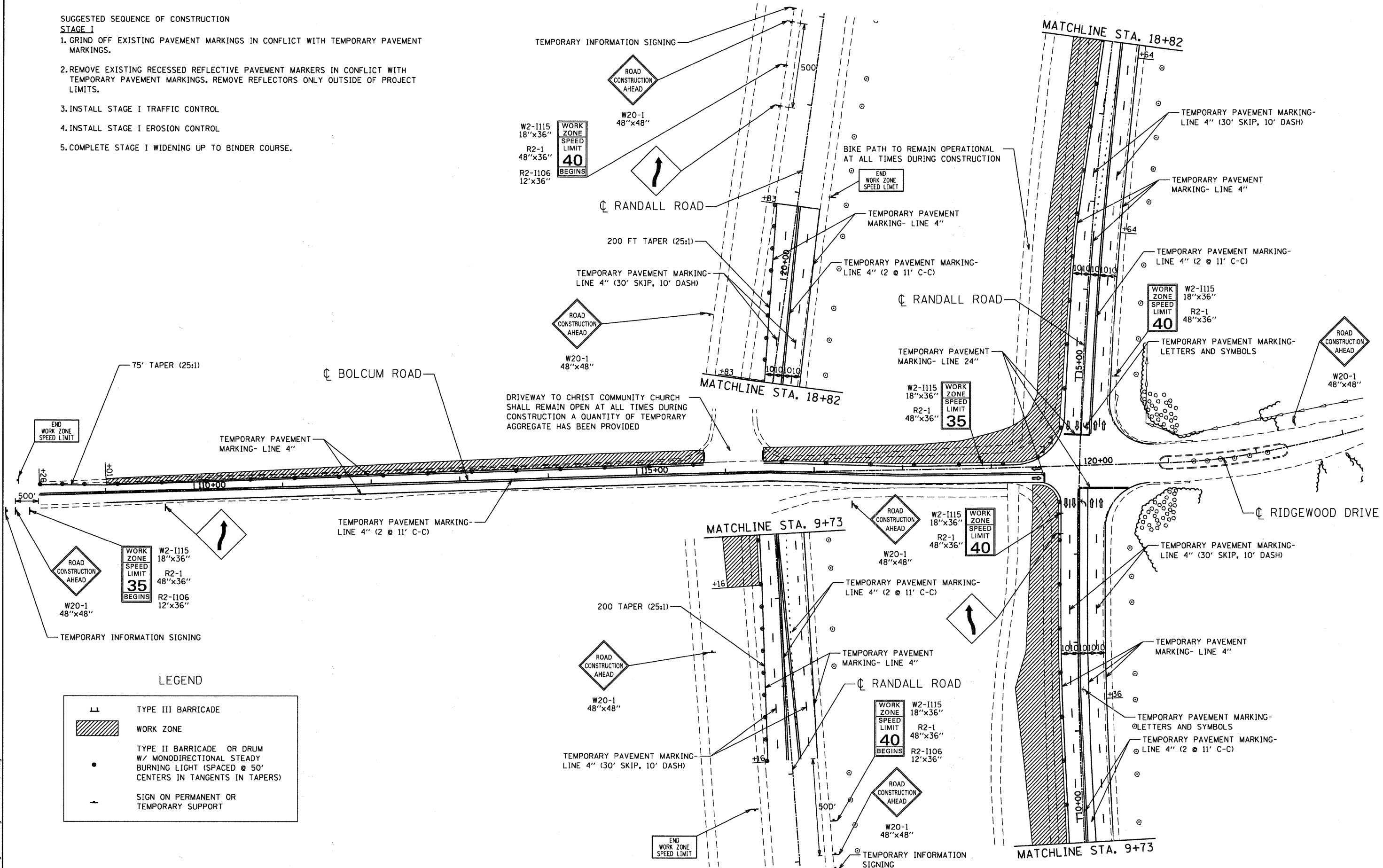

LEGEND

	TYPE III BARRICADE
	WORK ZONE
	TYPE II BARRICADE OR DRUM W/ MONODIRECTIONAL STEADY BURNING LIGHT (SPACED @ 50' CENTERS IN TANGENTS IN TAPERS)
	SIGN ON PERMANENT OR TEMPORARY SUPPORT

FILE NAME = c:\p\03383\design\m01\3383-m01.dgn

**Ciorba Group, Inc.**  
CONSULTING ENGINEERS  
5507 North Cumberland Avenue, Suite 402  
Chicago, Illinois 60656  
Tel. 773.775.4009 Fax 773.775.4014

USER NAME = espino	DESIGNED - CLG	REVISED -
PLOT SCALE = 50.0000' / IN.	DRAWN - EPS	REVISED -
PLOT DATE = 12/20/2010	CHECKED - MJL	REVISED -
	DATE - 12-20-2010	REVISED -

**KANE COUNTY DIVISION OF TRANSPORTATION**

SUGGESTED STAGES OF CONSTRUCTION			
STAGE I			
SCALE: 1" = 50'	SHEET NO.	OF SHEETS	STA. TO STA.

F.A.P. RTE. 336	SECTION 04-00325-00-TL	COUNTY KANE	TOTAL SHEETS 54	SHEET NO. 18
CONTRACT NO. 63547				
FED. ROAD DIST. NO. 1 ILLINOIS FED. AID PROJECT				