

Traffic Control Plan Stage II

Refer to Standard 701606-06 for additional details, signing & devices.

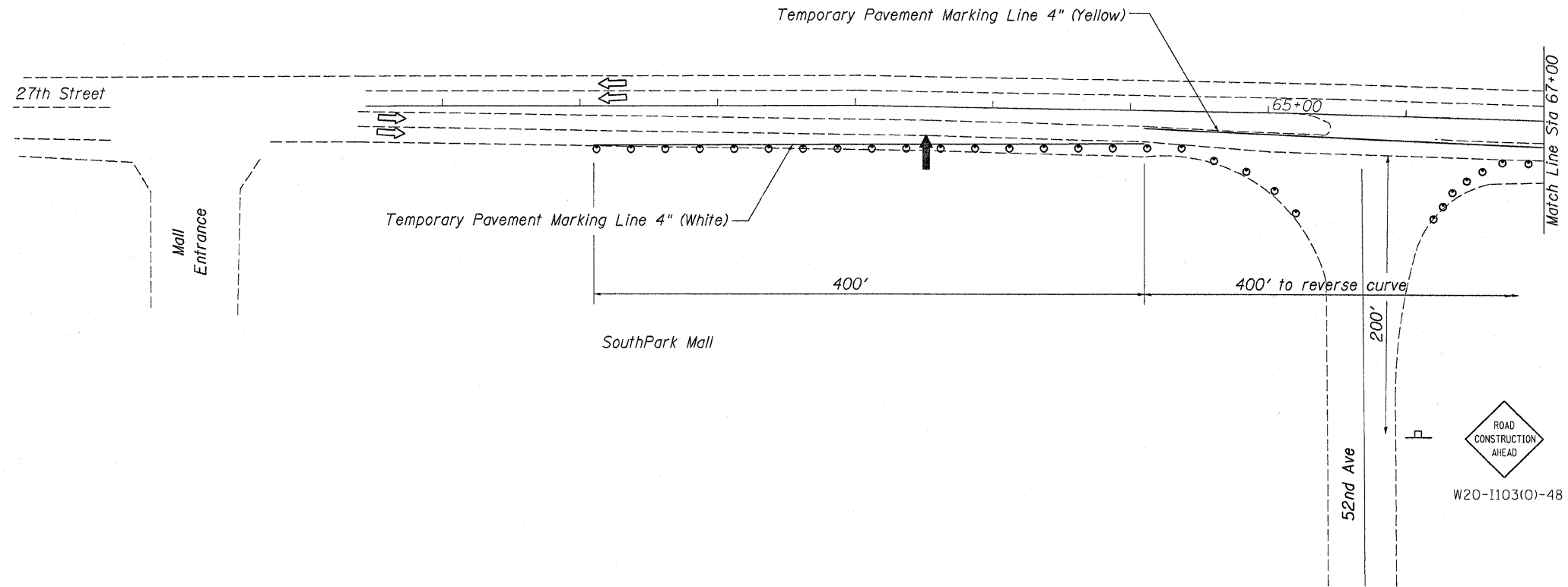

Work Zone Pavement Marking Removal

	Square Feet
Stage I	2967
Stage II	2783
	<u>5750 Square Feet</u>

Upon project completion re-stripe pavement 300' either side of and including the bridge deck

Paint Pavement Marking 4"

Double Yellow	(300' + 920' (bridge) + 300') x 2	3040
White edgelines	(300' + 920' (bridge) + 300') x 2	3040
White skip dash	((300' + 920' (bridge) + 300') x 2)/3	1014
	<u>Total</u>	<u>7094 Feet</u>

FILE NAME =	USER NAME = linkdj	DESIGNED -	REVISED -	STATE OF ILLINOIS DEPARTMENT OF TRANSPORTATION	STAGE II TRAFFIC CONTROL	F.A.U. RTE.	SECTION	COUNTY	TOTAL SHEETS	SHEET NO.
D:\BR\CADD\plans\Rock Island County\081047\2010\0810047.dgn		DRAWN -	REVISED -			5834	(115BR)M	Rock Island	22	8
PLOT SCALE = 50,0000' / IN.		CHECKED -	REVISED -			CONTRACT NO. 64G70				
PLOT DATE = Fri Dec 10 10:30:53 2010		DATE -	REVISED -			ILLINOIS FED. AID PROJECT				
SCALE: _____ SHEET NO. ____ OF ____ SHEETS STA. _____ TO STA. _____										