

Traffic Control Plan STAGE II

Refer to Standard 701321 for additional signs, details & devices

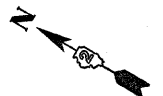

Note:

Note: Stationing shown is based on existing bridge plans using Back of South Abutment=538+18.88 and Back of North Abutment=540+31.13.

Install Changeable Message Sign 0.5 mile south of south stop bar or as directed by the engineer. "Be prepared to stop Traffic Signal 0.5 mile Ahead".

Re-stripe project from stop bar to stop bar upon completion of bridge work.

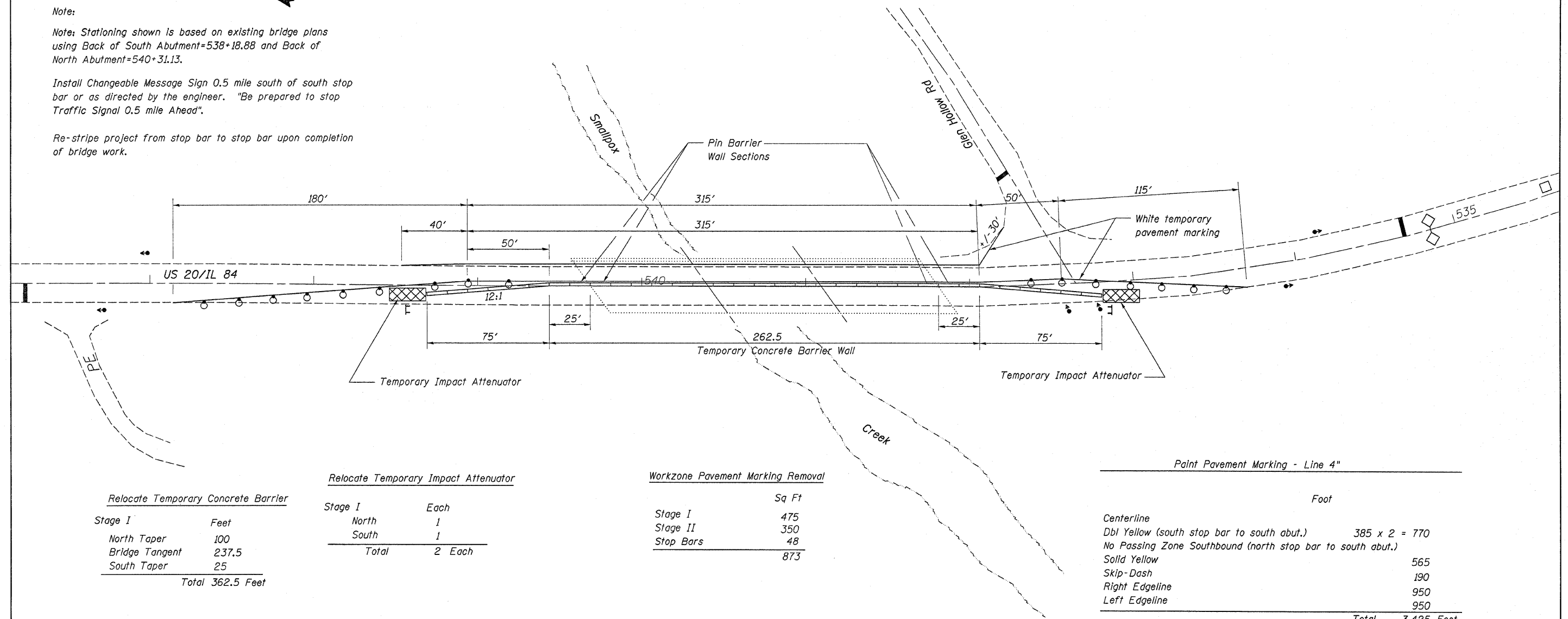

Relocate Temporary Concrete Barrier

Stage I	Feet
North Taper	100
Bridge Tangent	237.5
South Taper	25
Total	362.5 Feet

Relocate Temporary Impact Attenuator

Stage I	Each
North	1
South	1
Total	2 Each

Workzone Pavement Marking Removal

Stage I	Sq Ft
Stage I	475
Stage II	350
Stop Bars	48
Total	873

Paint Pavement Marking - Line 4"

	Foot
Centerline	
Dbl Yellow (south stop bar to south abut.)	385 x 2 = 770
No Passing Zone Southbound (north stop bar to south abut.)	
Solid Yellow	565
Skip-Dash	190
Right Edgeline	950
Left Edgeline	950
Total	3,425 Foot

Short Term Pavement Marking

Bridge Deck (No Passing Zone Southbound)

	Feet
Solid Yellow	215
skip dash	70
Total	285 Feet