

ELEVATION

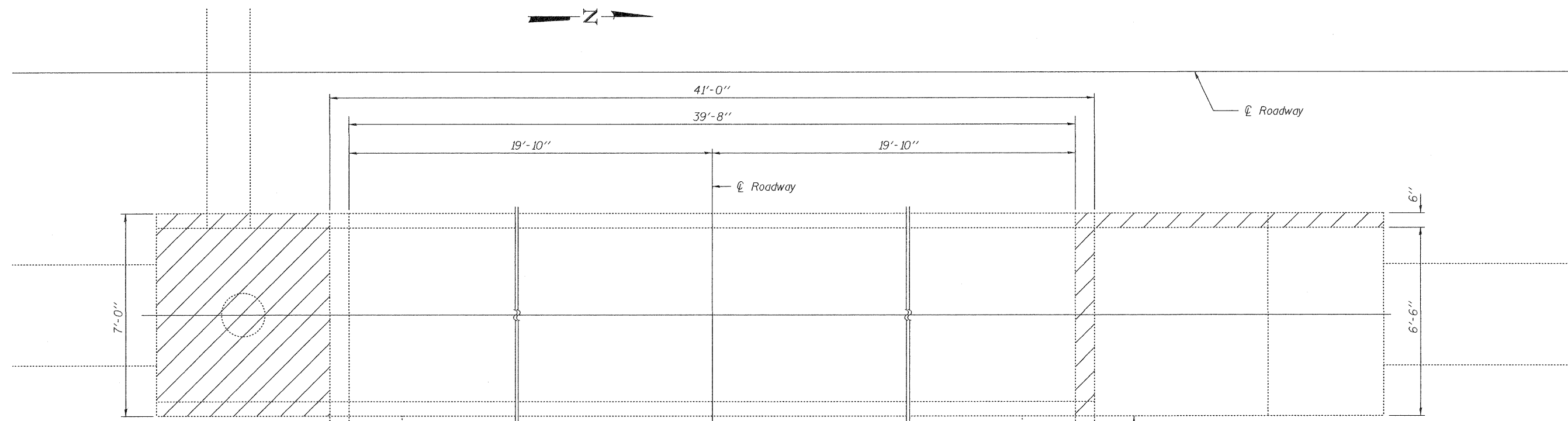
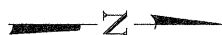

PLAN

Hatched areas indicate removal.

GENERAL NOTES

Reinforcement bars shall conform to the requirements of ASTM A 706 Gr 60. See Special Provisions.
 Reinforcement bars designated (E) shall be epoxy coated.
 Plan dimensions and details relative to existing plans are subject to nominal construction variations. The Contractor shall field verify existing dimensions and details affecting new construction and make necessary approved adjustments prior to construction or ordering of materials. Such variations shall not be cause for additional compensation for a change in scope of the work, however, the Contractor will be paid for the quantity actually furnished at the unit price bid for the work.
 Existing reinforcement bars extending into the removal area shall be cleaned, straightened and incorporated into the new construction. Any reinforcement bars that are damaged during concrete removal shall be replaced with an approved bar splicer or anchorage system. Cost included with Concrete Removal.
 The slab surface shall have its final finish tined according to Article 420.09(e)(1) of the Standard Specifications. Cost included with Concrete Superstructure.

DESIGN STRESSES

$f_y = 60,000 \text{ psi}$
 $f'_c = 3,500 \text{ psi}$

TOTAL BILL OF MATERIAL

ITEM	UNIT	QUANTITY
Concrete Removal	Cu. Yd.	3.4
Concrete Structures	Cu. Yd.	3.3
Concrete Superstructure	Cu. Yd.	7.7
Reinforcement Bars, Epoxy Coated	Pound	3160
Expansion Bolts $\frac{3}{4}$ "	Each	16
Partial Depth Removal (Variable Depth)	Sq. Yd.	39.7
Bar Splicers	Each	21



EXPIRES 11-30-2012

DESIGNED: <i>Quinn Bell</i>	EXAMINED: <i>Jon F. Smith</i>	DATE: FEBRUARY 3, 2011
CHECKED: <i>Victor H. Veliz</i>	PASSED: <i>David Carl Puzey</i>	
DRAWN: <i>balva</i>		
CHECKED: <i>[Signature]</i>		

STATE OF ILLINOIS
 DEPARTMENT OF TRANSPORTATION

REMOVAL PLAN AND ELEVATION
 SN 071-1023

SHEET NO. 1 OF 5 SHEETS

F.A. RTE.	SECTION	COUNTY	TOTAL SHEETS	SHEET NO.
-	117 M	OGLE	10	6
CONTRACT NO. 04G84			ILLINOIS FED. AID PROJECT	