

LOC. #4 STA. 834+17.5

DRAINAGE STRUCTURE IMPROVEMENT DETAIL

LOCATION #4 STA. 834 + 17.5

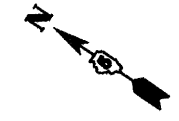

ITEM # AND DESCRIPTION	UNIT	QUANTITY
21400100 Grading and Shaping Ditches	FOOT	98
25000210 Seeding, Class 2A	ACRE	0.052
25000400 Nitrogen Fert. Nutr.	POUND	4.68
25000500 Phosphorous Fert. Nutr.	POUND	4.68
25000600 Potassium Fert. Nutr.	POUND	4.68
25100115 Mulch Method 2	ACRE	0.052
28000250 Temp. Eros. Contr. Seeding	POUND	5.2
28000305 Ditch Check Temporary	FOOT	10
28000500 Inlet and Pipe Protection	EACH	2
50105220 Pipe Culvert Removal	FOOT	8
54002010 Expansion Bolts 1/2	EACH	8
54244405 Flush Inlet Box For Median Stand. 542546	EACH	1
54248510 Concrete Collar	CU YD	0.67
542A0229 Pipe Culverts, Class A Ty 124"	FOOT	8
X6050700 Remove Inlet Box	EACH	1

GRADING AND SHAPING DITCHES (SEE SHEET # 117 & 118)
SEEDING

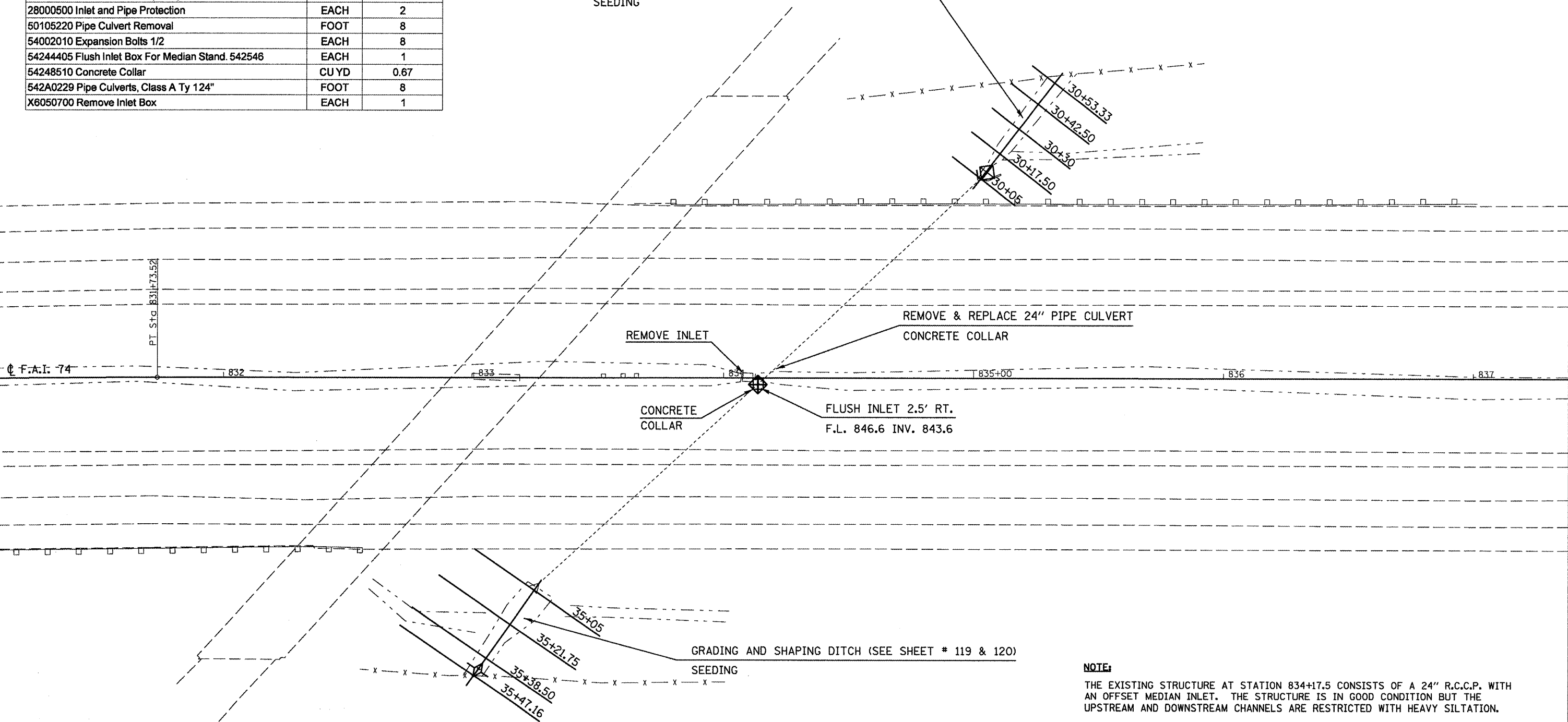

NOTE:

THE EXISTING STRUCTURE AT STATION 834+17.5 CONSISTS OF A 24" R.C.C.P. WITH AN OFFSET MEDIAN INLET. THE STRUCTURE IS IN GOOD CONDITION BUT THE UPSTREAM AND DOWNSTREAM CHANNELS ARE RESTRICTED WITH HEAVY SILTATION.

THE PROPOSED SCOPE OF WORK IS TO GRADE AND SHAPE THE CHANNEL UPSTREAM AND DOWNSTREAM OF THE STRUCTURE TO PROVIDE POSITIVE DRAINAGE TO AND AWAY FROM THE STRUCTURE. ALSO, THE MEDIAN INLET BOX AND LATERAL PIPE SHALL BE REPLACED TO ACCOMMODATE THE EXCAVATION REQUIRED TO CONSTRUCT THE IMPACT ATTENUATOR BASE AT THE ADJACENT OVERHEAD STRUCTURE.

FILE NAME =	USER NAME = hogenbj	DESIGNED - BJM	REVISED -
ca:\pwork\pwork\hogenbj\0156340\057250-shr-am_struct_det.dgn		DRAWN -	REVISED -
PLOT SCALE = 40,0000' / IN.		CHECKED -	REVISED -
PLOT DATE = 10/21/2010		DATE - 09/23/10	REVISED -

**STATE OF ILLINOIS
DEPARTMENT OF TRANSPORTATION**

**DRAINAGE STRUCTURE IMPROVEMENT DETAIL
LOCATION #4 STA. 834 + 17.5**

SCALE: 1" = 20' SHEET NO. OF SHEETS STA. TO STA.

F.A.I. RTE.	SECTION	COUNTY	TOTAL SHEETS	SHEET NO.
74	(57-2011), 21, 22 IRS-3	McLean	150	54
			CONTRACT NO. 70550	
ILLINOIS FED. AID PROJECT				