

DRAINAGE STRUCTURE IMPROVEMENT DETAIL

LOCATION #13 STA. 928 + 65.5

NOTE:

THE EXISTING STRUCTURE AT STATION 928+65.5 CONSISTS OF A 36" R.C.C.P. WITH A MEDIAN INLET AND PRECAST END SECTIONS. THERE IS MILD SCOUR AT THE DOWNSTREAM END OF THE STRUCTURE THAT HAS ALSO LED TO SOME MILD SLOPE FAILURE AROUND THE DOWNSTREAM END SECTION.

THE PROPOSED SCOPE OF WORK IS TO RE-ESTABLISH THE FORESLOPE AROUND THE DOWNSTREAM END SECTION AND GRADE THE DOWNSTREAM CHANNEL WITHIN R.O.W. TO ACCEPT A TREATMENT OF RIPRAP.

LOC. #13 STA.928+65.5

ITEM # AND DESCRIPTION	UNIT	QUANTITY
21400100 Grading and Shaping Ditches	FOOT	13
25000210 Seeding, Class 2A	ACRE	0.005
25000400 Nitrogen Fert. Nutr.	POUND	0.45
25000500 Phosphorous Fert. Nutr.	POUND	0.45
25000600 Potassium Fert. Nutr.	POUND	0.45
25100115 Mulch Method 2	ACRE	0.005
28000250 Temp. Eros. Contr. Seeding	POUND	0.5
28000305 Ditch Check Temporary	FOOT	15
28100107 Stone Rip Rap Class A4	SQ YD	31.1
28200200 Filter Fabric	SQ YD	31.1

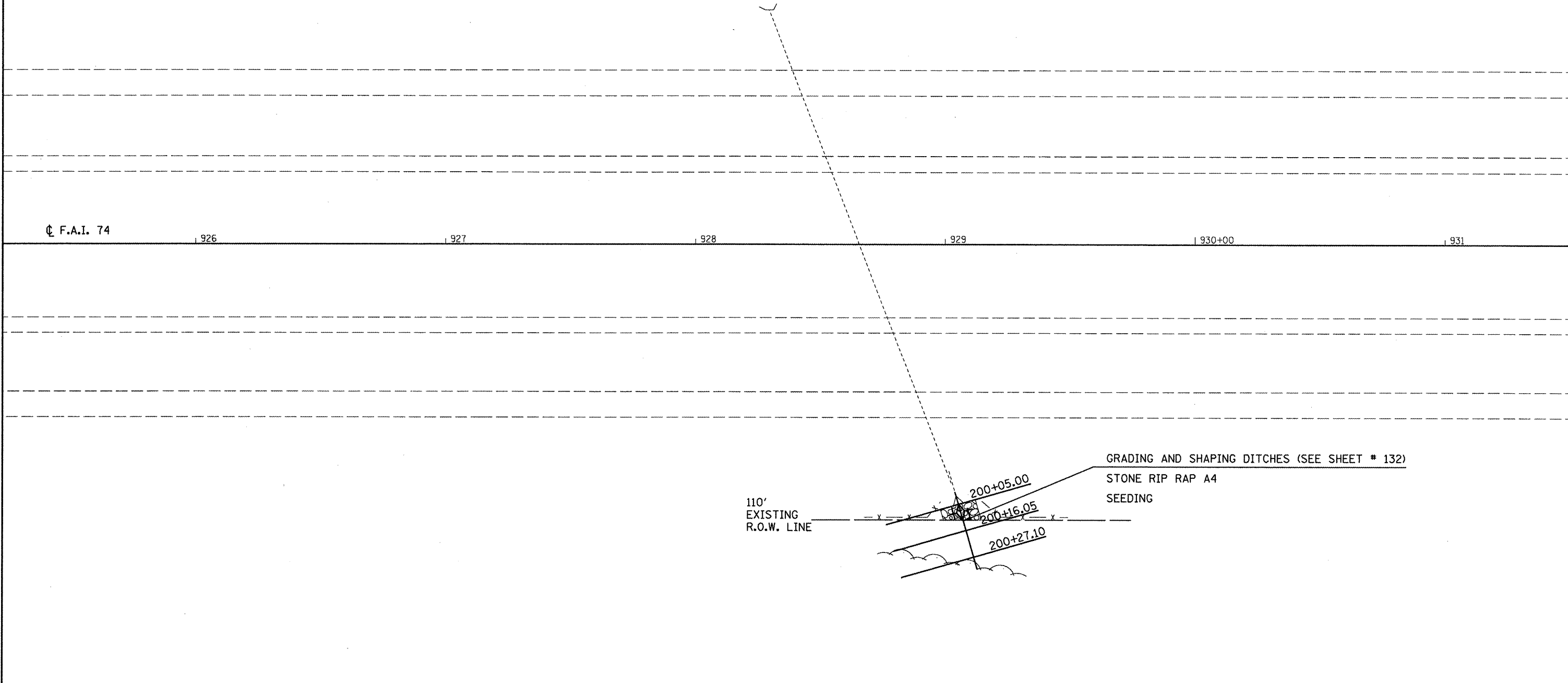

FILE NAME =	USER NAME = hogenbj	DESIGNED - BJM	REVISED -
ca\pwwork\pwwork\hogenbj\d0158340\0570550-ah-t-sm-struct-det.dgn		DRAWN -	REVISED -
	PLOT SCALE = 40.0000' / IN.	CHECKED -	REVISED -
	PLOT DATE = 10/21/2010	DATE - 09/23/10	REVISED -

**STATE OF ILLINOIS
DEPARTMENT OF TRANSPORTATION**

**DRAINAGE STRUCTURE IMPROVEMENT DETAIL
LOCATION #13 STA. 928 + 65.5**

SCALE: 1" = 20' SHEET NO. OF SHEETS STA. TO STA.

F.A.I. RTE.	SECTION	COUNTY	TOTAL SHEETS	SHEET NO.
74	(57-20(1),21,22)RS-3	McLean	150	63
CONTRACT NO. 70550			ILLINOIS FED. AID PROJECT	