

# DRAINAGE STRUCTURE IMPROVEMENT DETAIL

## LOCATION #21 STA. 18+00

### WESTBOUND ON RAMP (RAMP AC)

LOC. #21 STA. 18+00 WB ON-RAMP "AC"



ITEM # AND DESCRIPTION	UNIT	QUANTITY
21400100 Grading and Shaping Ditches	FOOT	305
25000210 Seeding, Class 2A	ACRE	0.133
25000400 Nitrogen Fert. Nutr.	POUND	11.97
25000500 Phosphorous Fert. Nutr.	POUND	11.97
25000600 Potassium Fert. Nutr.	POUND	11.97
25100115 Mulch Method 2	ACRE	0.133
28000250 Temp. Eros. Contr. Seeding	POUND	13.3
28000305 Ditch Check Temporary	FOOT	15
28000500 Inlet and Pipe Protection	EACH	2
Z0005305 Box Culverts To Be Cleaned	FOOT	30

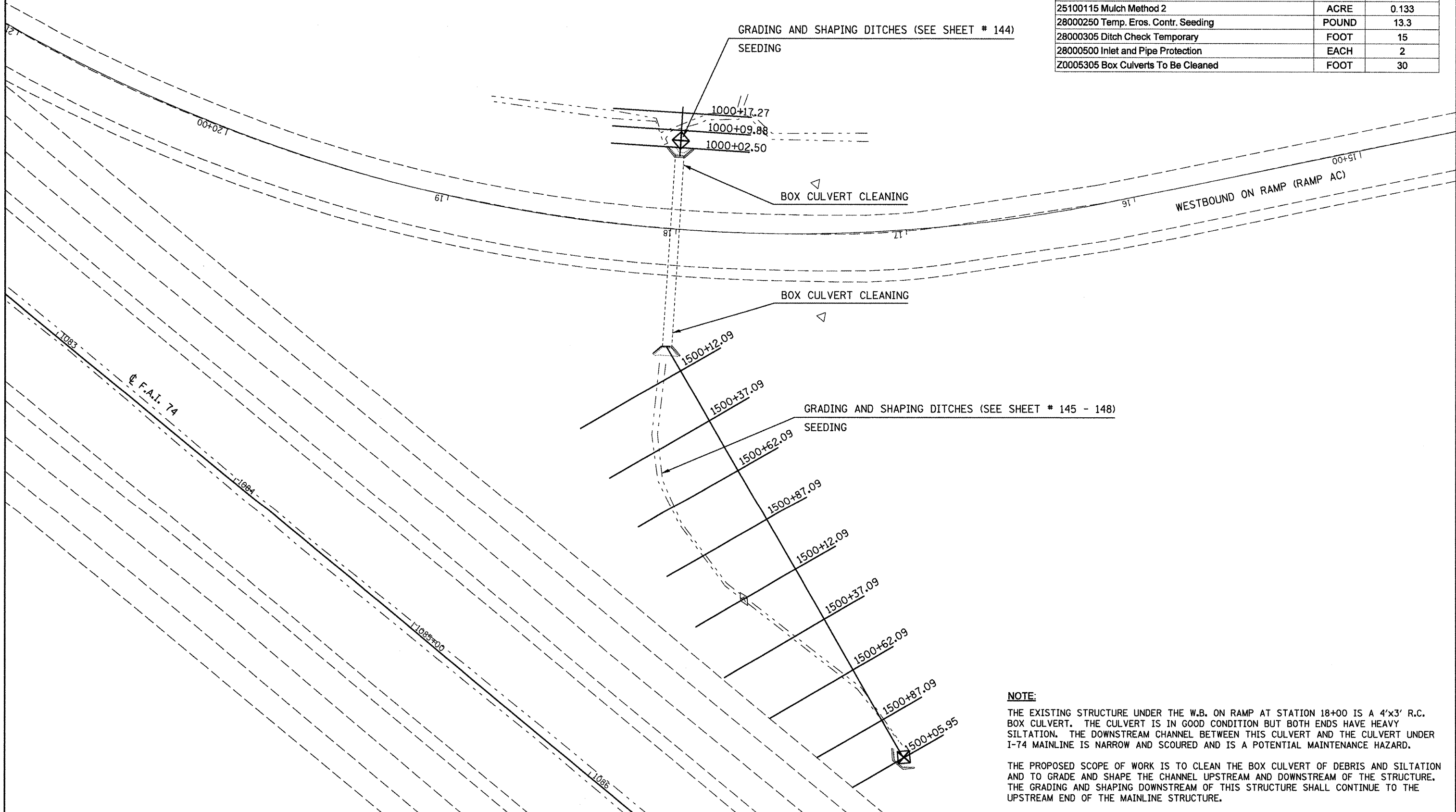

**NOTE:**  
 THE EXISTING STRUCTURE UNDER THE W.B. ON RAMP AT STATION 18+00 IS A 4'x3' R.C. BOX CULVERT. THE CULVERT IS IN GOOD CONDITION BUT BOTH ENDS HAVE HEAVY SILTATION. THE DOWNSTREAM CHANNEL BETWEEN THIS CULVERT AND THE CULVERT UNDER I-74 MAINLINE IS NARROW AND SCOURED AND IS A POTENTIAL MAINTENANCE HAZARD.  
 THE PROPOSED SCOPE OF WORK IS TO CLEAN THE BOX CULVERT OF DEBRIS AND SILTATION AND TO GRADE AND SHAPE THE CHANNEL UPSTREAM AND DOWNSTREAM OF THE STRUCTURE. THE GRADING AND SHAPING DOWNSTREAM OF THIS STRUCTURE SHALL CONTINUE TO THE UPSTREAM END OF THE MAINLINE STRUCTURE.

FILE NAME =	USER NAME = hoganbj	DESIGNED - BJM	REVISED -
ca:\pw_work\pwwork\hoganbj\0815834\0570	58-shrt-am struct det.dgn	DRAWN -	REVISED -
	PLOT SCALE = 40.0000' / IN.	CHECKED -	REVISED -
	PLOT DATE = 10/21/2010	DATE - 09/23/10	REVISED -

**STATE OF ILLINOIS**  
**DEPARTMENT OF TRANSPORTATION**

**DRAINAGE STRUCTURE IMPROVEMENT DETAIL**  
**LOCATION #21 STA. 18+00**

SCALE: 1" = 20'    SHEET NO. OF SHEETS    STA. TO STA.

F.A.I. RTE.	SECTION	COUNTY	TOTAL SHEETS	SHEET NO.
74	(57-2011), 21, 22 IRS-3	McLean	150	71
CONTRACT NO. 70550			ILLINOIS FED. AID PROJECT	