

SYMBOLS

- ⊛ (APPLICATION NO. 2) TYPE I OR II BARRICADES OR DRUMS @ 25' (7.5 m) CTS. W/STEADY BURNING LIGHTS
- ⊢ SIGN ON PORTABLE OR PERMANENT SUPPORT
- ⌈ CLASS III BARRICADES WITH RAMP CLOSED SIGNS & FLASHING LIGHTS

TYPICAL APPLICATIONS

- PAVEMENT PATCHING
- PIPE UNDERDRAINS
- HMA RESURFACING

APPLICATION NO. 2 CONTINUED
RAMP CLOSURE (ON RAMP)
NIGHTTIME OPERATIONS ONLY
MAINLINE RAMP PAVING ONLY

Traffic Control for all ramps shall be in accordance with the appropriate application of plan detail **TRAFFIC CONTROL FOR RAMPS** and will not be paid for separately, but shall be included in the contract lump sum price for Traffic Control Complete.

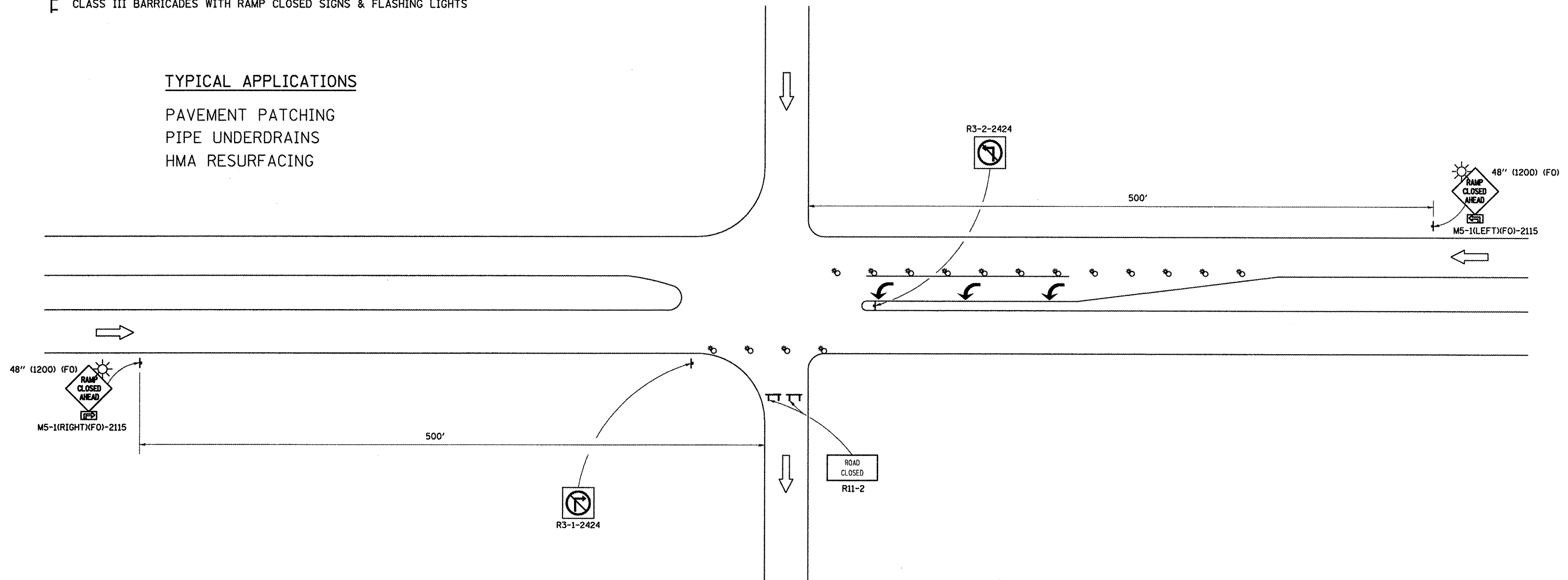

GENERAL NOTES

CONTACT THE DISTRICT TRAFFIC OPERATIONS ENGINEER AT 217-465-4181 AND OTHERS ACCORDING TO "NOTIFICATION PRIOR TO ROAD CLOSURES" SPECIAL PROVISION, TWO WEEKS PRIOR TO CLOSING THE RAMP.

Note: All dimensions are in INCHES (millimeters) unless otherwise shown.

FILE NAME =	USER NAME = hogenbj	DESIGNED -	REVISED - 11/06
c:\pw_work\pwr\dot\hogenbj\d0158340\0570558-sht-detail.dgn		DRAWN -	REVISED -
PLOT SCALE = 48,0000" / IN.		CHECKED -	REVISED -
PLOT DATE = 10/21/2010		DATE -	REVISED -

STATE OF ILLINOIS
DEPARTMENT OF TRANSPORTATION

TRAFFIC CONTROL FOR RAMPS

F.A.I. RTE.	SECTION	COUNTY	TOTAL SHEETS	SHEET NO.
74	(57-20(1),21,22)RS-3	MCLEAN	150	93A
FED. ROAD DIST. NO.			ILLINOIS FED. AID PROJECT	
			CONTRACT NO. 70550	

SCALE: SHEET NO. 2 OF 2 SHEETS STA. TO STA.