

EXIST. CURVE 102
 PI STA. = 178+57.42
 $\Delta = 14^\circ 45' 07''$ (LT)
 D = $2^\circ 11' 15''$
 R = 2,619.25'
 T = 339.07'
 L = 674.38'
 E = 21.86'
 e = -----
 T.R. = -----
 S.E. RUN = -----
 P.C. STA. = 175+18.36
 P.T. STA. = 181+92.74

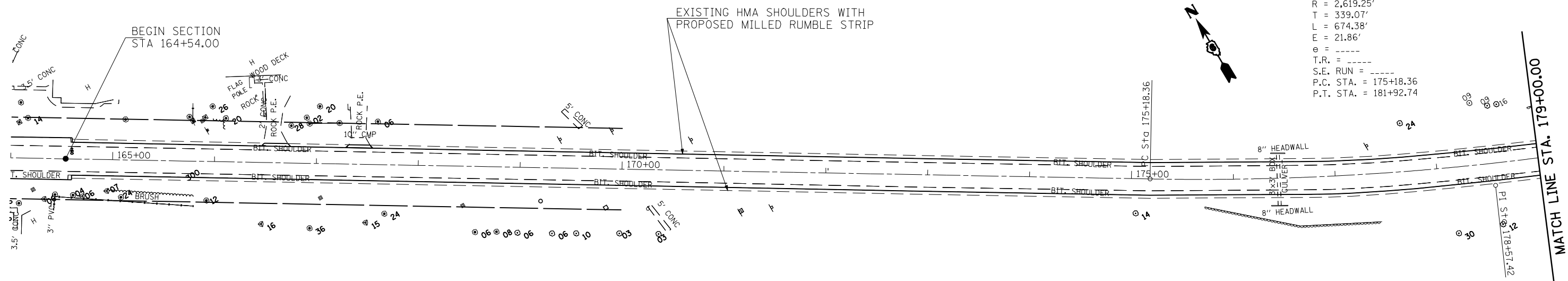

EXIST. CURVE 104
 PI STA. = 189+47.52
 $\Delta = 1^\circ 55' 21''$ (RT)
 D = $0^\circ 19' 23''$
 R = 17,735.24'
 T = 297.57'
 L = 595.09'
 E = 2.50'
 e = -----
 T.R. = -----
 S.E. RUN = -----
 P.C. STA. = 186+49.95
 P.T. STA. = 192+45.04

EXIST. CURVE 103
 PI STA. = 184+22.35
 $\Delta = 13^\circ 08' 04''$ (LT)
 D = $2^\circ 52' 22''$
 R = 1,994.49'
 T = 229.61'
 L = 457.21'
 E = 13.17'
 e = -----
 T.R. = -----
 S.E. RUN = -----
 P.C. STA. = 181+92.74
 P.T. STA. = 186+49.95

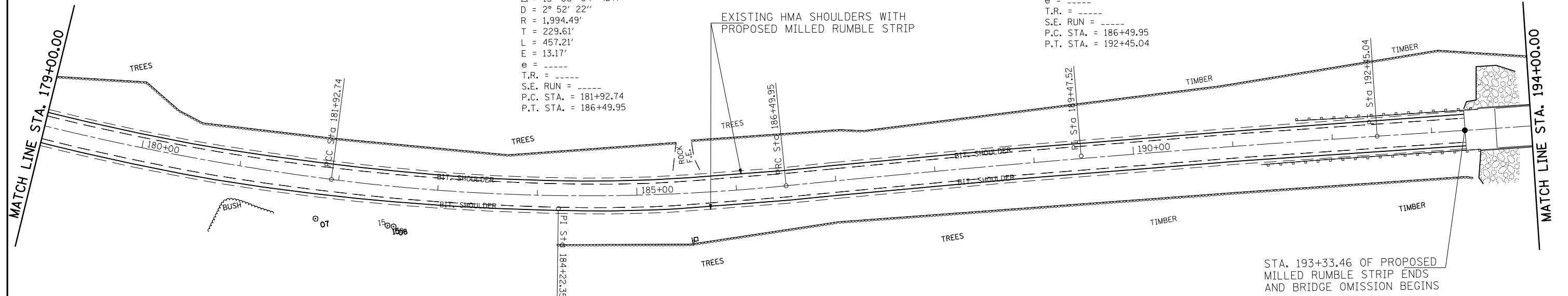

FILE NAME =	USER NAME = coxte	DESIGNED -	REVISED -	STATE OF ILLINOIS DEPARTMENT OF TRANSPORTATION	PLAN			F.A.P. RTE.	SECTION	COUNTY	TOTAL SHEETS	SHEET NO.
ei:\pw\work\p1\dot\coxte\d0230048\0672095-sh1-plan2.dgn		DRAWN -	REVISED -		753	143 I	CHRISTIAN	19	11			
PLOT SCALE = 100.0000' / IN.		CHECKED -	REVISED -		CONTRACT NO. 72D95							
PLOT DATE = Dec-28-2010 02:25:58PM		DATE -	REVISED -		ILLINOIS FED. AID PROJECT							
				SCALE:	SHEET NO.	OF SHEETS	STA.	TO STA.				