

NOTE: 1.) THE SURFACE SHALL BE FINISHED ACCORDING TO ARTICLE 420.09(a)(2).
 2.) THE TIE BARS REQUIRED FOR THIS WORK SHALL BE INCLUDED IN THE COST OF THE PCC BASE COURSE PAY ITEM.

MEDIAN REMOVAL DETAIL

EXIST. CURVE CUR40 @ NEW BUS 50
 PI STA. = 497+73.51
 $\Delta = 45^\circ 24' 50''$ (RT)
 $D = 23^\circ 17' 06''$
 $R = 246.06'$
 $T = 102.97'$
 $L = 195.03'$
 $E = 20.67'$
 P.C. STA. = 496+70.54
 P.T. STA. = 498+65.58

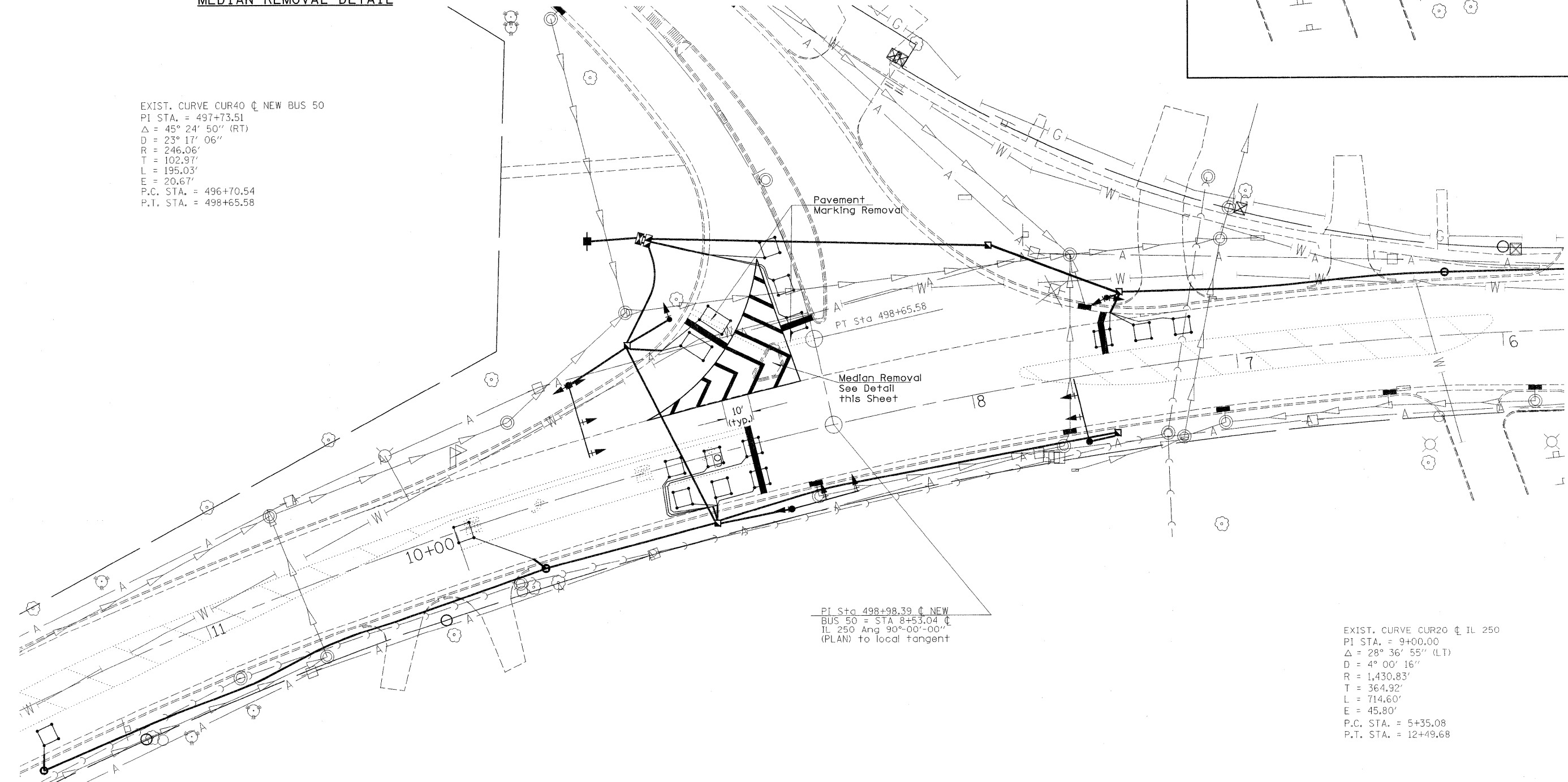
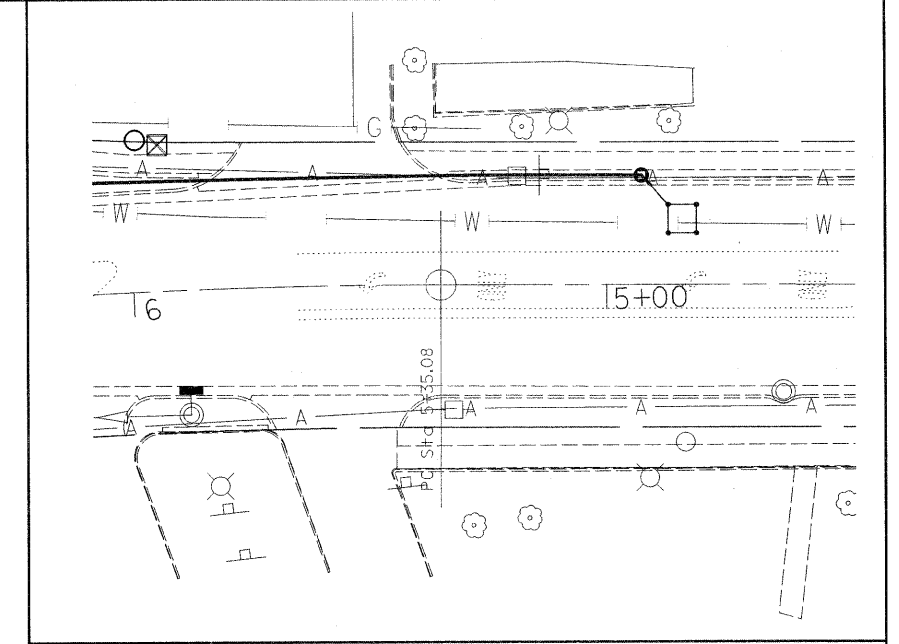

PT Sta 498+98.39 @ NEW
 BUS 50 = STA 8+53.04 @
 IL 250 Ang 90°-00'-00"
 (PLAN) to local tangent

EXIST. CURVE CUR20 @ IL 250
 PI STA. = 9+00.00
 $\Delta = 28^\circ 36' 55''$ (LT)
 $D = 4^\circ 00' 16''$
 $R = 1,430.83'$
 $T = 364.92'$
 $L = 714.60'$
 $E = 45.80'$
 P.C. STA. = 5+35.08
 P.T. STA. = 12+49.68

FILE NAME =	USER NAME = mcelianla	DESIGNED -	REVISED -	STATE OF ILLINOIS DEPARTMENT OF TRANSPORTATION	PROPOSED SIGNAL LAYOUT WITH EXISTING UTILITIES ISLAND REMOVAL & PAVEMENT MARKING	F.A.S. RTE.	SECTION	COUNTY	TOTAL SHEETS	SHEET NO.	
c:\pwork\pwork\mcelianla\0196565\0774480-TS-sht.dgn	PLOT SCALE = 20.0000' / IN.	DRAWN -	REVISED -			1809	(22)TS-1	LAWRENCE	12	5	
PLOT DATE = 12/30/2010	DATE -	CHECKED -	REVISED -			CONTRACT NO. 74480					
						ILLINOIS FED. AID PROJECT					
					SCALE:	SHEET NO. OF SHEETS		STA. TO STA.			