

ALIGNMENT, TIES AND BENCHMARKS

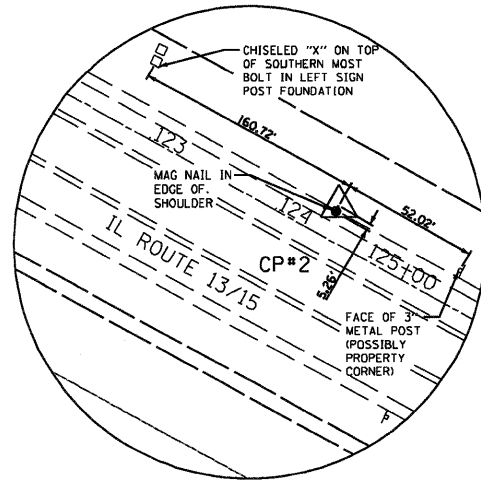

HORIZONTAL CONTROL POINT No. 2

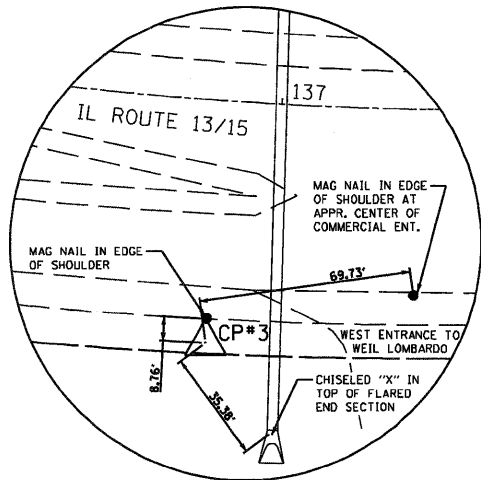

HORIZONTAL CONTROL POINT No. 3

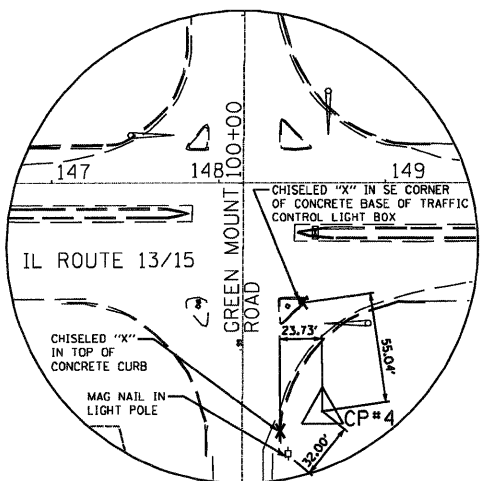

HORIZONTAL CONTROL POINT No. 4

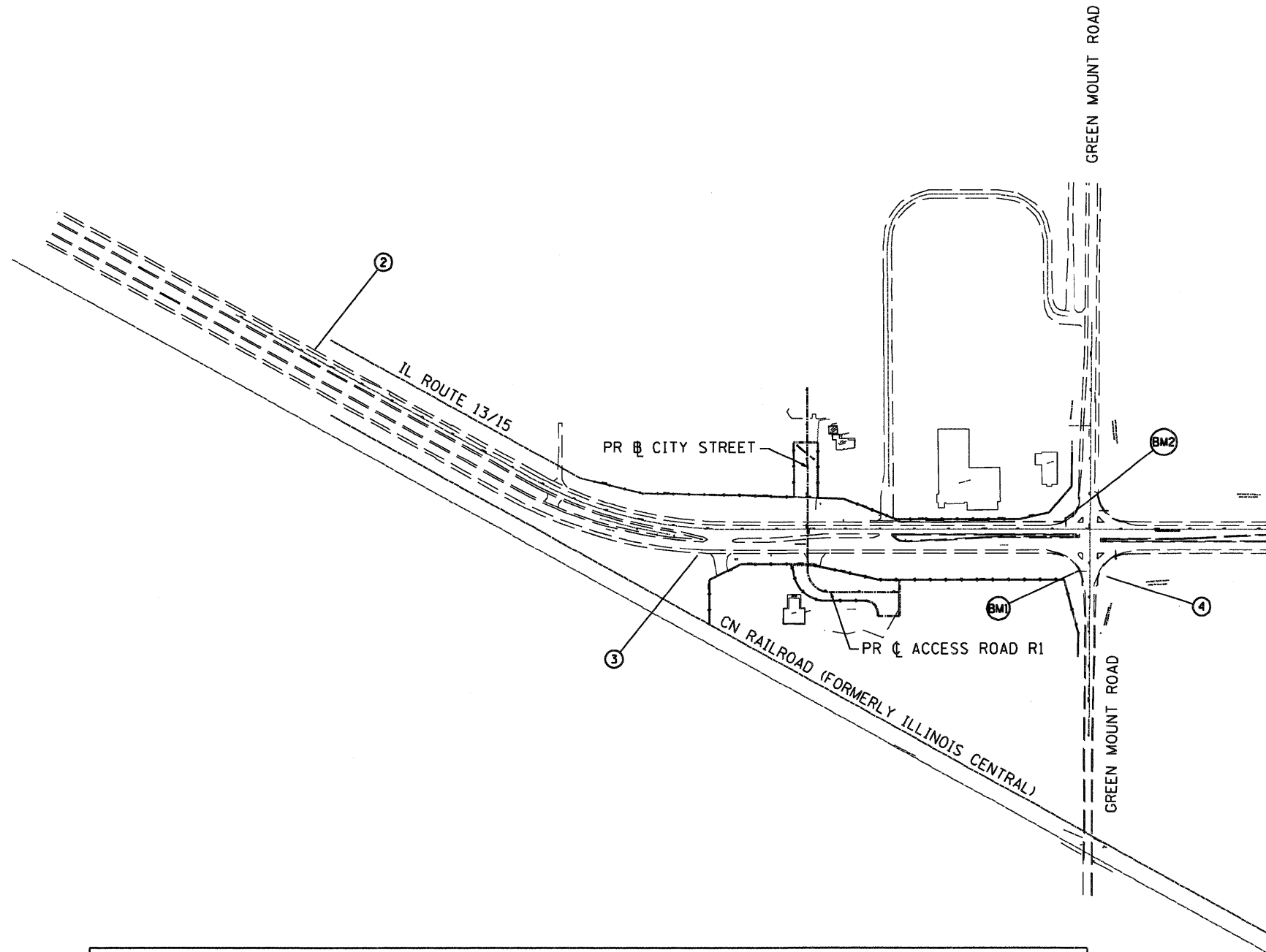

HORIZONTAL CONTROL POINTS

POINT	NORTH	EAST	CHAIN	STATION	OFFSET	DESCRIPTION
2	660575.2061	2359798.0979	CL_13-15	124+37.426	23.2889' LT	5/8" Ø X 30" REBAR WITH IDOT CAP
3	659697.8355	2360703.6665	CL_13-15	136+81.074	78.3864' RT	5/8" Ø X 30" REBAR WITH IDOT CAP
4	659314.9579	2361828.9444	CL_13-15	148+62.357	136.4020' RT	5/8" Ø X 30" REBAR WITH IDOT CAP

BENCH MARKS

NO.	NORTH	EAST	ELEVATION	CHAIN	STATION	OFFSET	DESCRIPTION
BM1	659352.4590	2361753.3210	503.149	CL_13-15	147+79.47	120.9325' RT	CHISELED SQUARE ON E. SIDE OF CONC. PAD OF MAST ARM
BM2	659509.8831	2361762.5631	503.299	CL_13-15	147+45.39	33.0357' LT	CHISELED SQUARE ON E. SIDE OF CONC. PAD OF MAST ARM

DATE TIME
-JUN-2010
-10:00:00
-REF: 0876015-shr-ATB1.dgn
-REF: 0876015-shr-ATB1.dgn
-REF: 0876015-shr-ATB1.dgn

FILE NAME = 0876015-shr-ATB1.dgn

USER NAME = dwoznarski
PLOT SCALE = N/A
PLOT DATE = 9/14/2010

DESIGNED -
DRAWN - DMW
CHECKED -
DATE - 7/9/2010

REVISED -
REVISED -
REVISED -
REVISED -

STATE OF ILLINOIS
DEPARTMENT OF TRANSPORTATION

ALIGNMENT, TIES AND BENCHMARKS

SCALE: N/A SHEET NO. 1 OF 2 SHEETS STA. TO STA.

F.A.P. RTE.	SECTION	COUNTY	TOTAL SHEETS	SHEET NO.
130	27-1-N	ST. CLAIR	50	11

CONTRACT NO. 76015
FED. ROAD DIST. NO. ILLINOIS FED. AID PROJECT