

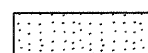

-  PAVED SHOULDER REMOVAL
-  PAVEMENT REMOVAL
-  MEDIAN REMOVAL
-  DRIVEWAY PAVEMENT REMOVAL
-  GUTTER REMOVAL

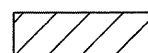
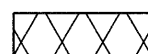
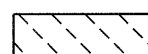
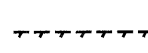
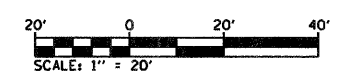
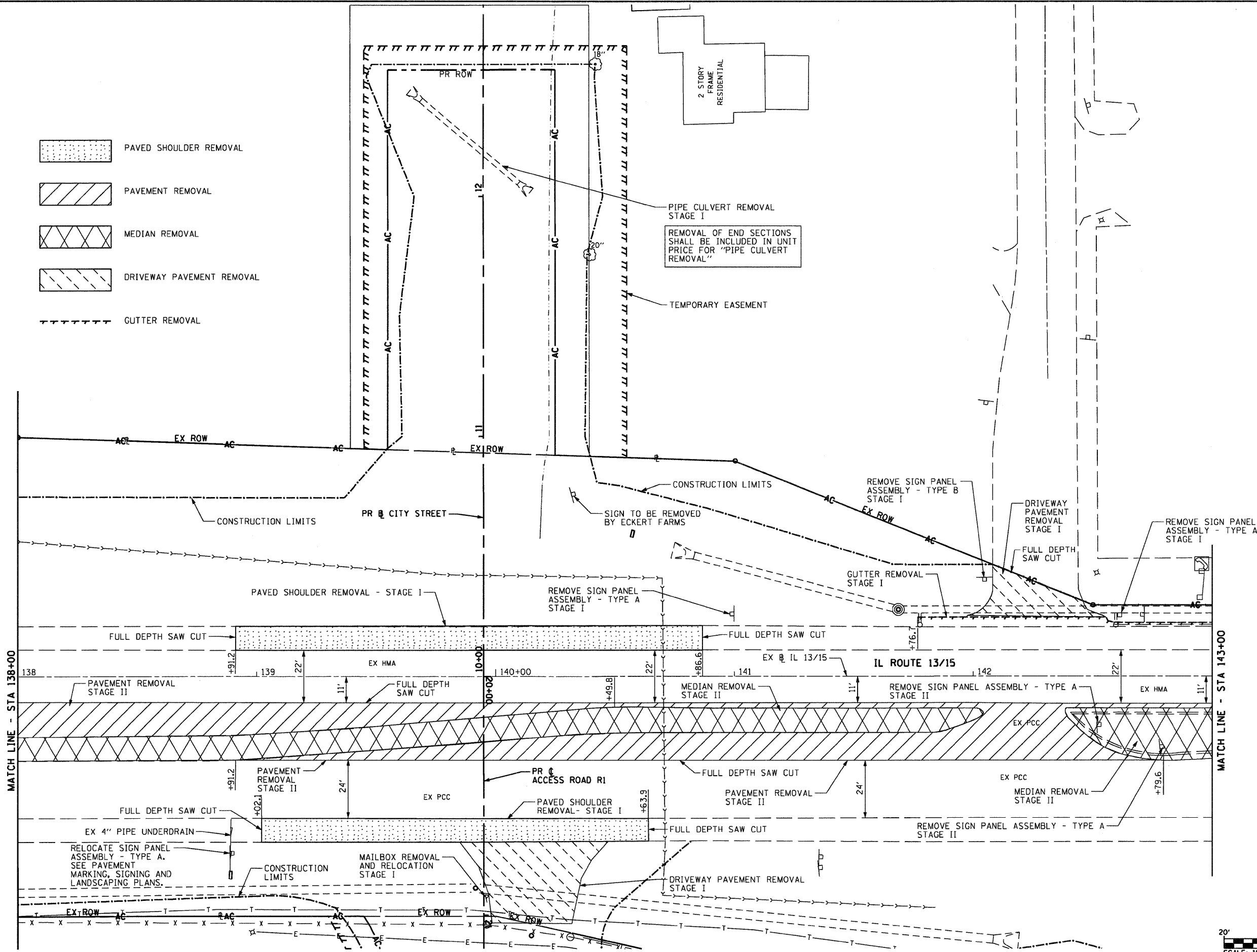

FILE NAME = 0876015-shr-ren2.dgn	USER NAME = dwozmbrsk1	DESIGNED - DRAWN - DMW	REVISED - REVISED -	STATE OF ILLINOIS DEPARTMENT OF TRANSPORTATION	REMOVAL PLAN	F.A.P. RTE. 103	SECTION 27-1-N	COUNTY ST. CLAIR	TOTAL SHEETS 50	SHEET NO. 14		
	PLOT SCALE = 40.00' / IN.	CHECKED -	REVISED -			SCALE: 1" = 20'	SHEET NO. 2 OF 4 SHEETS	STA. 139+50 TO STA. 146+00	FED. ROAD DIST. NO.	ILLINOIS FED. AID PROJECT	CONTRACT NO. 76015	
	PLOT DATE = 9/14/2010	DATE - 7/9/2010	REVISED -			REVISED -						