



- LEGEND**
-  WORK ZONE
  -  TYPE III BARRICADES (QUANTITY AS REQUIRED FOR PROPER CLOSURE)
  -  TYPE I OR II BARRICADES

**STAGE I TRAFFIC STAGING PLAN**

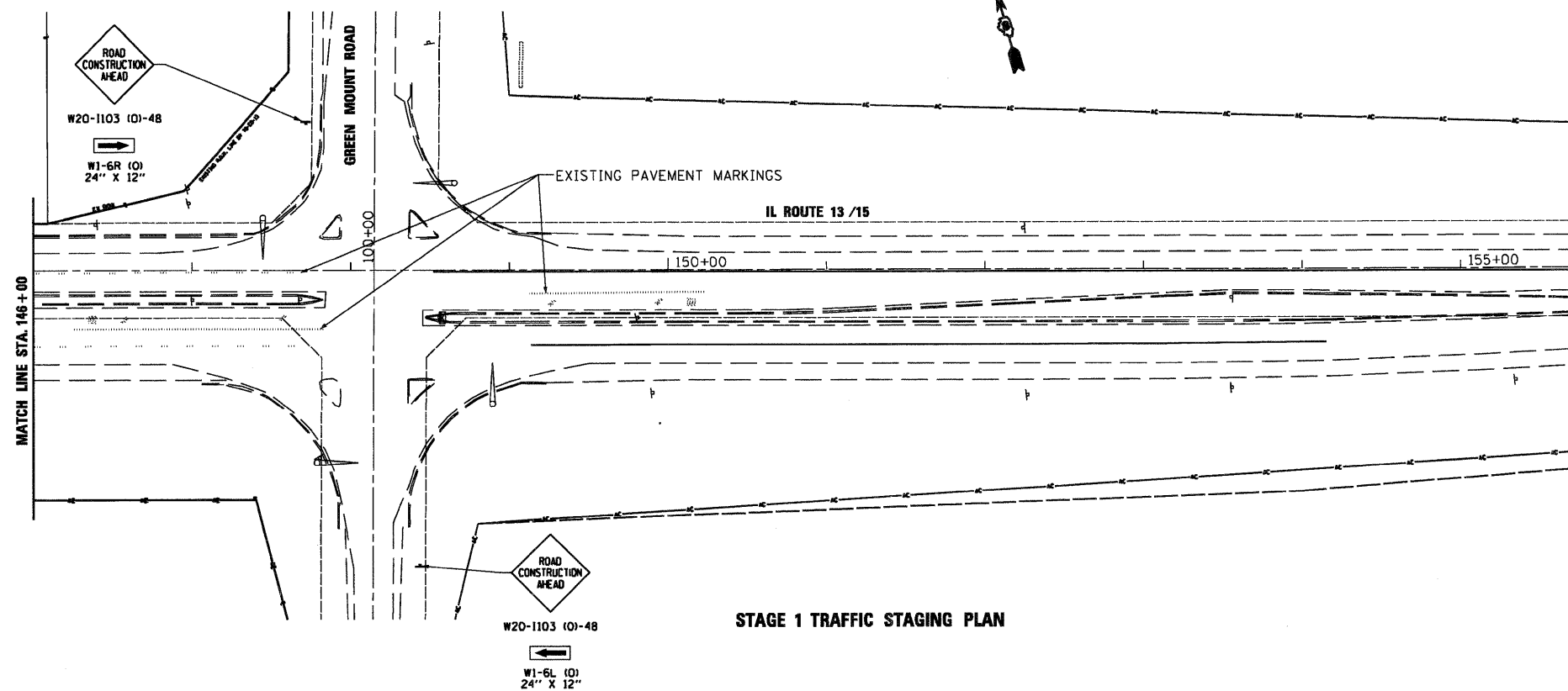

**STAGE I TRAFFIC STAGING PLAN**

**STAGE I TRAFFIC CONTROL NOTES**

1. CLOSE EXISTING ENTRANCES WHERE SHOWN WITH TYPE III BARRICADES WITH "ENTRANCE CLOSED" SIGN PANEL INCLUDED.
2. CLOSE EXISTING EASTBOUND LEFT TURN LANE INTO NORTH ENTRANCE PER STD. 701701.
3. CONSTRUCT IMPROVEMENTS NORTH AND SOUTH OF IL ROUTE 13/15 THROUGH LANE USING DAY LANE CLOSURES PER STD. 701421.
4. TYPE I & II BARRICADES USED TO PROTECT SHOULDER EXCAVATIONS DURING NIGHT TIME SHALL HAVE LEG EXTENSIONS.
5. DAY LANE CLOSURES FOR WESTBOUND IL 13/15 SHALL BEGIN WEST OF GREEN MOUNT ROAD.
6. NO OVERNIGHT LANE CLOSURES OF IL 13/15 THROUGH LANES WILL BE ALLOWED.

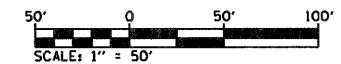

FILE NAME = DB76015-sh1-staging2.dgn	USER NAME = dvoznitski	DESIGNED -	REVISED -	<b>STATE OF ILLINOIS DEPARTMENT OF TRANSPORTATION</b>	<b>SUGGESTED MAINTENANCE OF TRAFFIC - STAGE I</b>			F.A.I. RTE.	SECTION	COUNTY	TOTAL SHEETS	SHEET NO.
	PLOT SCALE = 100.00' / IN.	DRAWN - DMW	REVISED -					103	27-1-N	ST. CLAIR	50	23
PLOT DATE = 9/14/2010	CHECKED -	REVISED -	REVISED -	SCALE: 1" = 50'    SHEET NO. 2 OF 3 SHEETS    STA. 125+00 TO STA. 146+00			CONTRACT NO. 76015					
	DATE - 7/9/2010	REVISED -	REVISED -	FED. ROAD DIST. NO. [ILLINOIS] FED. AID PROJECT								