

STATE OF ILLINOIS
DEPARTMENT OF TRANSPORTATION
DIVISION OF HIGHWAYS

**PROPOSED
HIGHWAY PLANS**

FAP ROUTE 42 (IL 127)
SECTION (130,1)RS-5
PROJECT ACF-0042(102)
RESURFACING, SHOULDERS
CLINTON COUNTY

C-98-102-10

F.A.P. RTE.	SECTION	COUNTY	TOTAL SHEETS	SHEET NO.
42	(130,1)RS-5	CLINTON	26	1
		ILLINOIS	CONTRACT NO. 76E11	

D-98-005-10

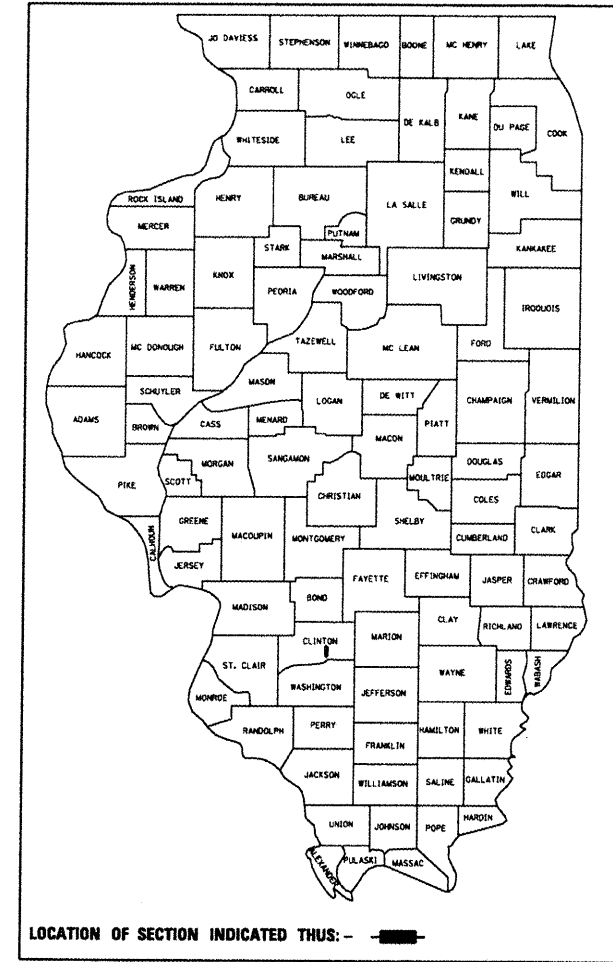

FOR INDEX OF SHEETS, SEE SHEET NO. 2

FOR TRAFFIC DATA, SEE SHEET NO. 5

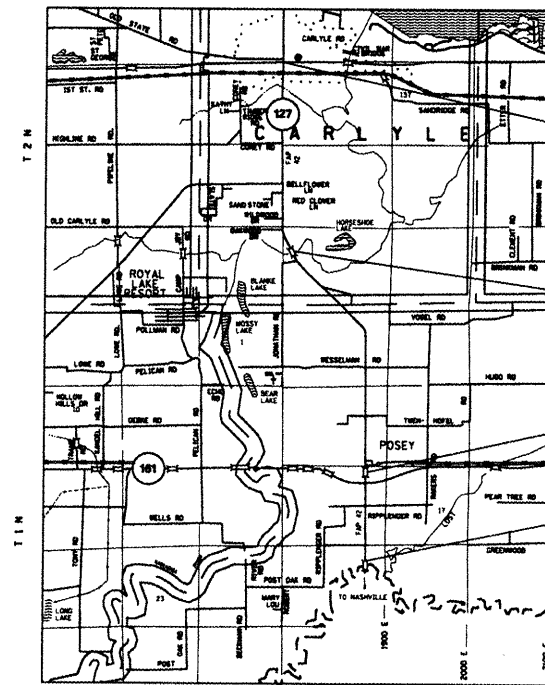

END PROJECT LAT. 38.6254
M.P. 6.73 LONG. -89.3340

BRIDGE OMISSION (S.N. 014-0014)
M.P. 4.19 TO M.P. 4.40

BRIDGE OMISSION (S.N. 014-0015)
M.P. 1.13 TO M.P. 1.23

BEGIN PROJECT LAT. 38.4417
M.P. 0.00 LONG. -89.3784

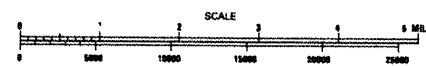

GROSS LENGTH = 35,534 FT. = 6.73 MILES
NET LENGTH = 33,897 FT. = 6.42 MILES

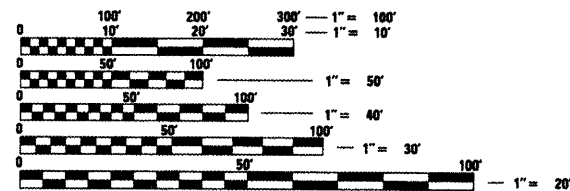

FULL SIZE PLANS HAVE BEEN PREPARED USING STANDARD ENGINEERING SCALES. REDUCED SIZED PLANS WILL NOT CONFORM TO STANDARD SCALES. IN MAKING MEASUREMENTS ON REDUCED PLANS, THE ABOVE SCALES MAY BE USED.

J.U.L.I.E.
JOINT UTILITY LOCATION INFORMATION FOR EXCAVATION
1-800-892-0123
OR 811

PROJECT ENGINEER: PATTI LEBEAU (618) 346-3179
PROJECT MANAGER: CHERYL KEPLAR (618) 346-3186

CONTRACT NO. 76E11

STATE OF ILLINOIS
DEPARTMENT OF TRANSPORTATION
DIVISION OF HIGHWAYS

SUBMITTED *December 14 20 10*
Mary C. Jamie
DEPUTY DIRECTOR OF HIGHWAYS, REGION 5 ENGINEER

February 4 20 11
Scott E. Stitt, P.E.
acting ENGINEER OF DESIGN AND ENVIRONMENT

February 4 20 11
Christine M. Reed
DIRECTOR OF HIGHWAYS, CHIEF ENGINEER

PRINTED BY THE AUTHORITY
OF THE STATE OF ILLINOIS

GENERAL NOTES

1. CARE SHALL BE TAKEN AT ALL SIDE STREETS AND ENTRANCES DURING MILLING OPERATIONS TO ENSURE THAT THE PROPOSED RESURFACING WILL MEET THE EXISTING SIDE STREETS AND ENTRANCES.
2. THE WIDTHS OF HOT-MIX ASPHALT SURFACE REMOVAL SHOWN ON THE PLANS ARE THE NOMINAL WIDTHS. IRREGULARITIES IN THE SURFACE WIDTH MAY OCCUR THROUGHOUT THE LENGTH OF THE SECTION. HOT-MIX ASPHALT SURFACE REMOVAL WILL BE PAID FOR IN SQUARE YARDS BASED UPON THE NOMINAL WIDTHS INDICATED.
3. THE THICKNESS OF HOT-MIX ASPHALT SHOWN ON THE PLANS IS THE NOMINAL THICKNESS. DEVIATIONS MAY OCCUR DUE TO IRREGULARITIES IN THE EXISTING SURFACE OR BASE ON WHICH THE HOT-MIX ASPHALT IS PLACED.
4. THE CONTRACTOR AND THE ENGINEER SHALL BE AWARE THAT NO SURVEY WAS PERFORMED FOR THIS PROJECT. THE STATIONING AND TOPO SHOWN IN THE PLANS WAS CREATED USING MICROFILM AND FIELD MEASUREMENTS MADE BY DESIGN PERSONNEL. BOTH SHALL BE ASSUMED TO BE APPROXIMATE. THE CONTRACTOR SHALL VERIFY ALL DIMENSIONS AND CONDITIONS IN THE FIELD PRIOR TO CONSTRUCTION AND ORDERING OF MATERIALS.
5. THE PROPOSED PAVEMENT MARKING SHALL MATCH THE LOCATIONS OF THE EXISTING PAVEMENT MARKING, AS DIRECTED BY THE ENGINEER.
6. ANY EXCAVATION OR DROP-OFF OF MORE THAN 3" AT EDGE OF PAVEMENT SHALL BE PROTECTED WITH EXTENDED LEG BARRICADES AND APPROPRIATE LIGHTING.
7. ILLINOIS STATE LAW REQUIRES A 48-HOUR NOTICE BE GIVEN TO UTILITIES WITHIN THE PROJECT AREA BEFORE DIGGING BY CALLING J.U.L.I.E. AND BY NOTIFYING NON-J.U.L.I.E. MEMBERS INDIVIDUALLY. AGENCIES KNOWN TO HAVE FACILITIES WITHIN THE PROJECT AREA ARE AS FOLLOWS:

UTILITY	ABOVE GROUND	BELOW GROUND
• AMEREN IP (GAS & ELECTRIC)	X	X
• AT&T ILLINOIS	X	X
• CITY OF CARLYLE		X
• CARLYLE SOUTHWEST PUBLIC WATER DISTRICT		X
• CENTERPOINT ENERGY		X
• CHARTER COMMUNICATIONS, INC.	X	X
• CLINTON CO. ELECTRIC COOP., INC.	X	
• HOFFMAN RURAL WATER DISTRICT		X
• KINDER MORGAN		X
• VERIZON BUSINESS		X
• PAETEC		X

MEMBERS OF J.U.L.I.E. (800) 892-0123 ARE INDICATED BY •. NON-J.U.L.I.E. MEMBERS MUST BE NOTIFIED INDIVIDUALLY.

8. EARTHWORK IS NEEDED FOR UPGRADE OF TERMINAL END SECTIONS. HOWEVER, CROSS SECTIONS ARE NOT AVAILABLE FOR THIS PROJECT. FURNISHED EXCAVATION WAS ESTIMATED AT 840 CU YDS AND SHALL BE VERIFIED IN THE FIELD PRIOR TO CONSTRUCTION.
9. A QUANTITY OF 0.75 ACRES OF 'SEEDING, CLASS 2' HAS BEEN INCLUDED IN THE PLANS FOR USE AT THE PROPOSED TERMINAL END SECTIONS.
10. THE CONTRACTOR SHALL POST AND MAINTAIN THE ROADWAY WITH "NO PASSING ZONES NOT STRIPED NEXT 6.73 MILES" SIGNS UNTIL MARKINGS HAVE BEEN RESTORED IN ACCORDANCE WITH ARTICLE 701.17(C). COST INCLUDED IN THE TRAFFIC CONTROL ITEM.
11. NO OVERNIGHT LANE CLOSURES WILL BE ALLOWED.
12. THE RESIDENT ENGINEER SHALL VERIFY THE EXISTENCE OF HIGHWAY LIGHTING AND/OR ITS UTILITIES WITHIN THE PROJECT LIMITS. IF HIGHWAY LIGHTING AND/OR ITS EXISTS WITHIN THE PROJECT LIMITS, AND IF THESE ITEMS REQUIRE LOCATING, THE CONTRACTOR SHALL BE DIRECTED TO DO SO ACCORDING TO SECTION 803 OF THE STANDARD SPECIFICATIONS. IF 'LOCATING UNDERGROUND CABLE' IS NOT INCLUDED AS PART OF THE PLANS, THIS WORK SHALL BE PAID FOR ACCORDING TO ARTICLE 109.04 OF THE STANDARD SPECIFICATIONS.
13. SHORT-TERM PAVEMENT MARKING SHALL BE APPLIED TO THE MILLED AND FINAL BITUMINOUS SURFACE. A QUANTITY FOR TEMPORARY PAVEMENT MARKING EQUAL TO THE AMOUNT OF PERMANENT PAVEMENT MARKING HAS BEEN ADDED TO THE PLANS. ONLY REMOVAL OF SHORT TERM PAVEMENT MARKING REMOVAL FROM FINAL SURFACE TO BE PAID AS 'WORK ZONE PAVEMENT MARKING REMOVAL'.
14. ALL EXISTING AND PROPOSED RIGHT-OF-WAY LINES AND PROPERTY LINES SHOWN ON THE PLAN SHEETS ARE GRAPHICAL REPRESENTATIONS AND SHALL NOT BE USED AS A MEANS TO ESTABLISH OWNERSHIP. IN ALL MATTERS RELATING TO RIGHT-OF-WAY, THE PLAT OF HIGHWAYS SHALL BE THE CONTROLLING DOCUMENT.

15. THE FOLLOWING MIXTURE REQUIREMENTS ARE APPLICABLE FOR THIS PROJECT:

MIXTURE USE	SURFACE	POLY-LEVEL BINDER	PATCHING	INCIDENTAL SURF
AC/PG	PG 64-22	SBS 76-22	PG 64-22	PG 64-22
RAP% (MAX)	SEE SPEC.	SEE SPEC.	SEE SPEC.	SEE SPEC.
DESIGN AIR VOIDS	4.0% @ Ndes=70	4.0% @ Ndes=50	4.0% @ Ndes=70	4.0% @ Ndes=70
MIX COMPOSITION				
(GRADATION MIXTURE)	IL 12.5/9.5	IL 4.75	IL 19.0	IL 12.5/IL 9.5
FRICITION AGG	MIXTURE "D"	MIXTURE "C"	MIXTURE "B"	MIXTURE "D"

MIXTURE USE	SHOULDERS > 2.25"	SHOULDERS < 2.25"
AC/PG	PG 64-22	PG 64-22
RAP% (MAX)	SEE CONTRACT RAP SPECIAL PROVISION	SEE CONTRACT RAP SPECIAL PROVISION
DESIGN AIR VOIDS	SEE CONTRACT RAP SPECIAL PROVISION	SEE CONTRACT RAP SPECIAL PROVISION
MIX COMPOSITION	2.0% @ Ndes=30	2.0% @ Ndes=30
(GRADATION MIXTURE)	**NMA3 3/4"	**NMA3 1/2"
FRICITION AGG		

**TOP LIFT SHOULDERS - DESIGN THIS MIX AT 2.0% VOIDS AND ADD ASPHALT TO REDUCE VOIDS TO 1.5%.

PLAN QUANTITIES FOR BITUMINOUS CONCRETE SURFACE COURSE ITEMS ARE CALCULATED USING A UNIT WEIGHT OF 112 LB/SQ YD/IN (59.8KG/SQ M/25 MM THICKNESS).

INDEX OF SHEETS

- 1 COVER SHEET
- 2 INDEX OF SHEETS, STANDARDS, AND GENERAL NOTES
- 3-4 SUMMARY OF QUANTITIES
- 5 LOCATION MAP, ADT
- 6-11 TYPICAL SECTIONS
- 12-17 SCHEDULES
- 18-20 PLAN SHEETS
- 21 DETECTOR LOOP REPLACEMENT
- 22-24 DETAILS
- 25-26 GUARDRAIL DETAILS

STANDARDS

000001-06	701201-04
406201-01	701306-03
630001-09	701311-03
630301-05	701326-04
631006-08	701336-06
631011-07	701901-01
631031-09	780001-02
631032-06	781001-03
635006-03	886001-01
635011-02	886006-01
701011-02	

COMMITMENTS

NONE

FILE NAME *	USER NAME * #USER#	DESIGNED -	REVISED -	STATE OF ILLINOIS DEPARTMENT OF TRANSPORTATION	GENERAL NOTES	F.A.P. RTE.	SECTION	COUNTY	TOTAL SHEETS	SHEET NO.	
#FILE#		DRAWN -	REVISED -			42	1130,11RS-5	CLINTON	26	2	
		CHECKED -	REVISED -			CONTRACT NO. 76E11					
		DATE -	REVISED -			FED. ROAD DIST. NO. - ILLINOIS FED. AID PROJECT					

SUMMARY OF QUANTITIES

SUMMARY OF QUANTITIES			TOTAL QUANTITIES	CONSTRUCTION TYPE CODE			SUMMARY OF QUANTITIES			TOTAL QUANTITIES	CONSTRUCTION TYPE CODE		
CODE NO	ITEM	UNIT		0005 80% FED 20% STATE	-----	-----	CODE NO	ITEM	UNIT		0005 80% FED 20% STATE	-----	-----
20200600	EXCAVATING AND GRADING EXISTING SHOULDER	UNIT	643	643		63000003	STEEL PLATE BEAM GUARD RAIL, TYPE A, 9 FOOT POSTS	FOOT	3612.5	3612.5			
20400800	FURNISHED EXCAVATION	CU YD	840	840		63000025	STEEL PLATE BEAM GUARDRAIL, ATTACHED TO STRUCTURES	FOOT	25	25			
25000200	SEEDING, CLASS 2	ACRE	0.75	0.75		63100041	TRAFFIC BARRIER TERMINAL, TYPE 1B	EACH	1	1			
25000400	NITROGEN FERTILIZER NUTRIENT	POUND	68	68		63100045	TRAFFIC BARRIER TERMINAL, TYPE 2	EACH	1	1			
25000500	PHOSPHORUS FERTILIZER NUTRIENT	POUND	68	68		63100085	TRAFFIC BARRIER TERMINAL, TYPE 6	EACH	4	4			
25000600	POTASSIUM FERTILIZER NUTRIENT	POUND	68	68		63100087	TRAFFIC BARRIER TERMINAL, TYPE 6A	EACH	4	4			
25100115	MULCH, METHOD 2	ACRE	0.75	0.75		63100167	TRAFFIC BARRIER TERMINAL, TYPE 1 (SPECIAL) TANGENT	EACH	26	26			
31101900	SUBBASE GRANULAR MATERIAL, TYPE C	TON	66	66		63100169	TRAFFIC BARRIER TERMINAL, TYPE 1 (SPECIAL) FLARED	EACH	2	2			
40200800	AGGREGATE SURFACE COURSE, TYPE B	TON	120	120		63200310	GUARDRAIL REMOVAL	FOOT	7951	7951			
40600200	BITUMINOUS MATERIALS (PRIME COAT)	TON	58.5	58.5		67000400	ENGINEER'S FIELD OFFICE, TYPE A	CAL MO	6	6			
40600300	AGGREGATE (PRIME COAT)	TON	281	281		67100100	MOBILIZATION	L SUM	1	1			
40600825	POLYMERIZED LEVELING BINDER (MACHINE METHOD), N50	TON	3865	3865		70100450	TRAFFIC CONTROL AND PROTECTION, STANDARD 701201	L SUM	1	1			
40600895	CONSTRUCTING TEST STRIP	EACH	1	1		70100460	TRAFFIC CONTROL AND PROTECTION, STANDARD 701306	L SUM	1	1			
40600982	HOT-MIX ASPHALT SURFACE REMOVAL - BUTT JOINT	SQ YD	467	467		70100500	TRAFFIC CONTROL AND PROTECTION, STANDARD 701326	L SUM	1	1			
40600985	PORTLAND CEMENT CONCRETE SURFACE REMOVAL - BUTT JOINT	SQ YD	167	167		70100600	TRAFFIC CONTROL AND PROTECTION, STANDARD 701336	L SUM	1	1			
40600990	TEMPORARY RAMP	SQ YD	198	198		70103815	TRAFFIC CONTROL SURVEILLANCE	CAL DA	10	10			
40603340	HOT-MIX ASPHALT SURFACE COURSE, MIX "D", N70	TON	7729	7729		70300100	SHORT TERM PAVEMENT MARKING	FOOT	6924	6924			
40800050	INCIDENTAL HOT-MIX ASPHALT SURFACING	TON	145	145		70300210	TEMPORARY PAVEMENT MARKING LETTERS AND SYMBOLS	SQ FT	154	154			
44000153	HOT-MIX ASPHALT SURFACE REMOVAL, 1"	SQ YD	87578	87578		70300220	TEMPORARY PAVEMENT MARKING - LINE 4"	FOOT	89415	89415			
44000158	HOT-MIX ASPHALT SURFACE REMOVAL, 2 1/4"	SQ YD	5201	5201		70300260	TEMPORARY PAVEMENT MARKING - LINE 12"	FOOT	535	535			
44000200	DRIVEWAY PAVEMENT REMOVAL	SQ YD	96	96		70300280	TEMPORARY PAVEMENT MARKING- LINE 24"	FOOT	112	112			
44004250	PAVED SHOULDER REMOVAL	SQ YD	7146	7146		70301000	WORK ZONE PAVEMENT MARKING REMOVAL	SQ FT	1154	1154			
44200168	PAVEMENT PATCHING, TYPE II, 14 INCH	SQ YD	1028	1028		78000100	THERMOPLASTIC PAVEMENT MARKING - LETTERS AND SYMBOLS	SQ FT	154	154			
44200172	PAVEMENT PATCHING, TYPE III, 14 INCH	SQ YD	996	996		78000200	THERMOPLASTIC PAVEMENT MARKING - LINE 4"	FOOT	89415	89415			
44200174	PAVEMENT PATCHING, TYPE IV, 14 INCH	SQ YD	5074	5074		78000600	THERMOPLASTIC PAVEMENT MARKING - LINE 12"	FOOT	535	535			
44300200	STRIP REFLECTIVE CRACK CONTROL TREATMENT	FOOT	68540	68540		78000650	THERMOPLASTIC PAVEMENT MARKING - LINE 24"	FOOT	112	112			
48102100	AGGREGATE WEDGE SHOULDER, TYPE B	TON	1695	1695		78100100	RAISED REFLECTIVE PAVEMENT MARKER	EACH	461	461			
48203034	HOT-MIX ASPHALT SHOULDERS, 9 1/4"	SQ YD	21437	21437		78200410	GUARDRAIL MARKERS, TYPE A	EACH	96	96			
48203100	HOT-MIX ASPHALT SHOULDERS	TON	35	35		78201000	TERMINAL MARKER - DIRECT APPLIED	EACH	27	27			
48300300	PORTLAND CEMENT CONCRETE SHOULDERS 8"	SQ YD	22	22									
50102400	CONCRETE REMOVAL	CU YD	5	5									
63000001	STEEL PLATE BEAM GUARD RAIL, TYPE A, 6 FOOT POSTS	FOOT	2812.5	2812.5									

FILE NAME #	USER NAME # USER#	DESIGNED -	REVISED -	STATE OF ILLINOIS DEPARTMENT OF TRANSPORTATION	SUMMARY OF QUANTITIES	F.A.P. RTE.	SECTION	COUNTY	TOTAL SHEETS	SHEET NO.	
#FILE#		DRAWN -	REVISED -			42	(130,11RS-5)	CLINTON	26	3	
		CHECKED -	REVISED -			CONTRACT NO. 76E11					
		DATE	REVISED			FED. ROAD DIST. NO. - ILLINOIS FED. AID PROJECT					

SUMMARY OF QUANTITIES

SUMMARY OF QUANTITIES			TOTAL QUANTITIES	CONSTRUCTION TYPE CODE			SUMMARY OF QUANTITIES			TOTAL QUANTITIES	CONSTRUCTION TYPE CODE		
CODE NO	ITEM	UNIT		80% FED 20% STATE	-----	-----	CODE NO	ITEM	UNIT		-----	-----	-----
78300200	RAISED REFLECTIVE PAVEMENT MARKER REMOVAL	EACH	461	461									
80300100	LOCATING UNDERGROUND CABLE	FOOT	50	50									
88600600	DETECTOR LOOP REPLACEMENT	FOOT	810	810									
Z0048665	RAILROAD PROTECTIVE LIABILITY INSURANCE	L SUM	1	1									
Ⓢ Z0076600	TRAINNEES	HOUR	500	500									
Ⓢ 0042													

FILE NAME : #FILE#	USER NAME : #USER#	DESIGNED - ---	REVISED - ---	STATE OF ILLINOIS DEPARTMENT OF TRANSPORTATION	SUMMARY OF QUANTITIES	F.A.P. RTE.	SECTION	COUNTY	TOTAL SHEETS	SHEET NO.
		DRAWN - ---	REVISED - ---			42	(130), IRS-5	CLINTON	26	4
		CHECKED - ---	REVISED - ---			CONTRACT NO. 76E11				
		PLOT SCALE : #SCALE#	REVISED - ---	SCALE: _____ SHEET NO. ___ OF ___ SHEETS STA. _____ TO STA. _____		FED. ROAD DIST. NO. _____ ILLINOIS FED. AID PROJECT				
		PLOT DATE : #DATE#	REVISED - ---							

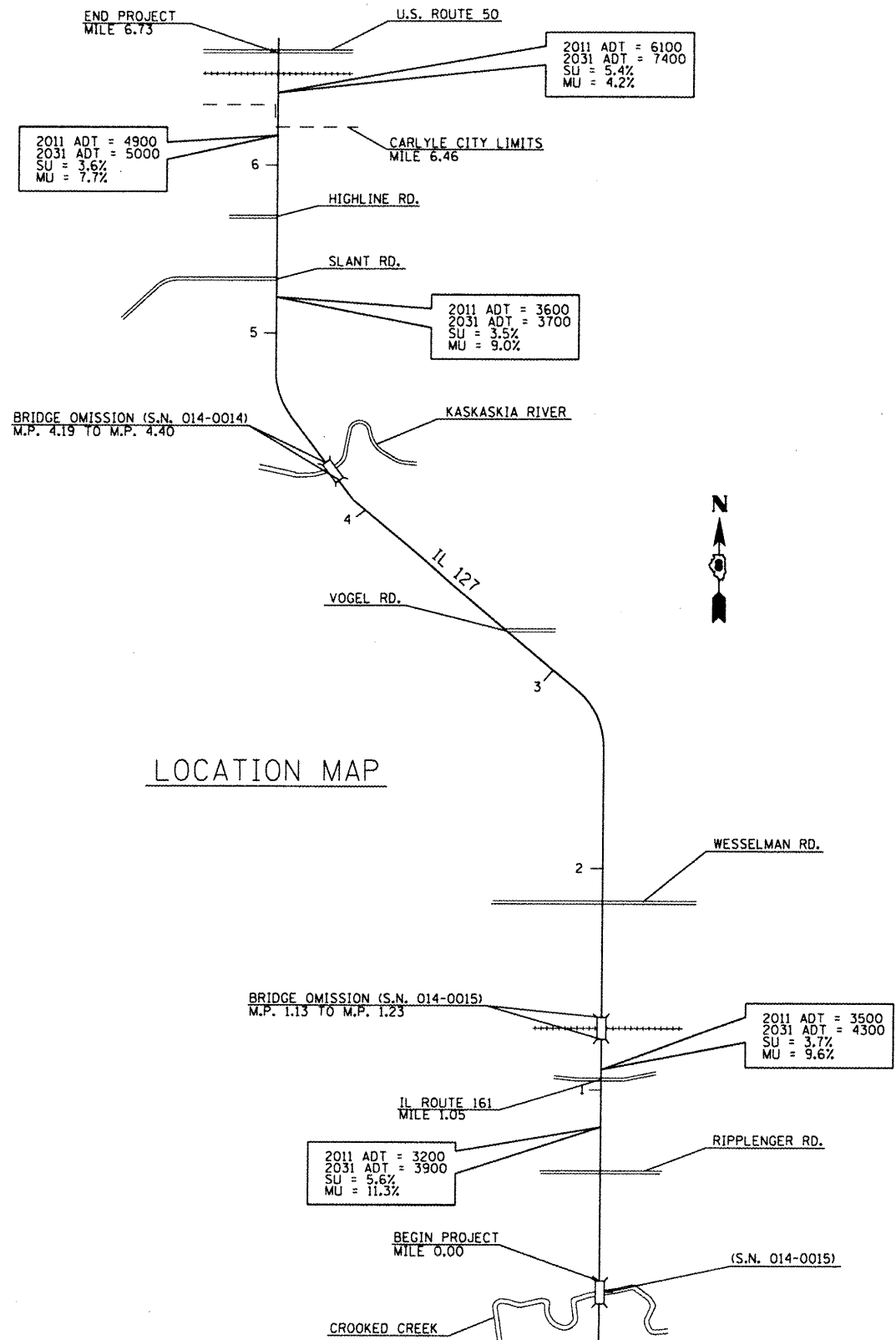

LOCATION MAP

FILE NAME : #FILE#	USER NAME : #USER#	DESIGNED - DRAWN -	REVISED - REVISED -
	PLOT SCALE : #SCALE#	CHECKED -	REVISED -
	PLOT DATE : #DATE#	DATE -	REVISED -

**STATE OF ILLINOIS
DEPARTMENT OF TRANSPORTATION**

LOCATION MAP, ADT

F.A.P. RTE.	SECTION	COUNTY	TOTAL SHEETS	SHEET NO.
42	(130,11RS-5	CLINTON	26	5
CONTRACT NO. 76E11				
FED. ROAD DIST. NO. - ILLINOIS FED. AID PROJECT				

SCALE: _____ SHEET NO. ___ OF ___ SHEETS STA. _____ TO STA. _____

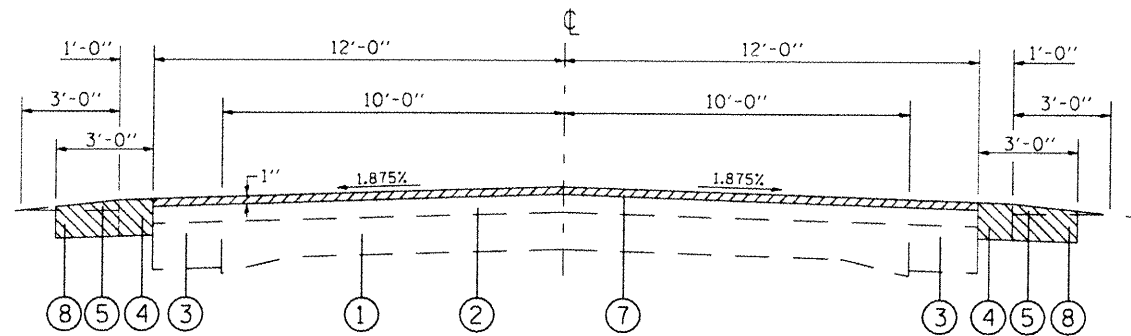

TYPICAL SECTION

M.P. 0.00 TO M.P. 1.13
M.P. 1.16 TO M.P. 2.49
M.P. 2.57 TO M.P. 2.84
M.P. 3.02 TO M.P. 4.08
M.P. 4.40 TO M.P. 4.52
M.P. 4.72 TO M.P. 6.46

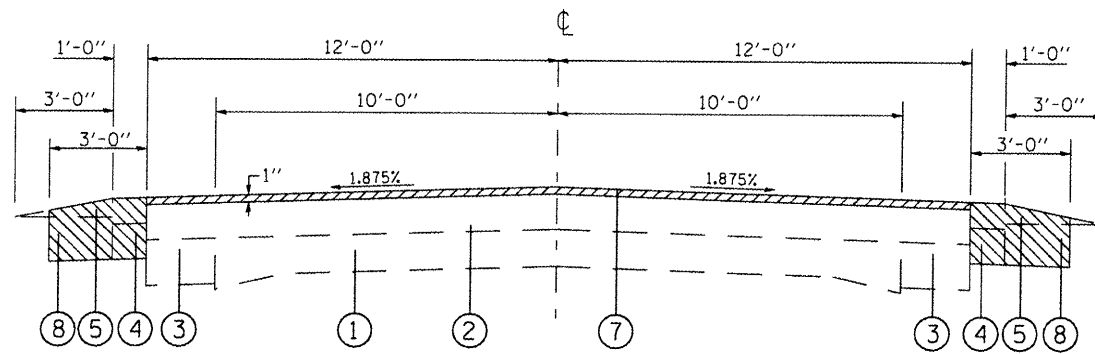

TYPICAL SECTION

M.P. 2.49 TO M.P. 2.57*

LEGEND

- ① EXISTING CONCRETE PAVEMENT 9-6-9
- ② EXISTING RESURFACING, 4 1/2" (8" DEPTH*)
- ③ EXISTING PCC WIDENING, 8"
- ④ EXISTING HMA SHOULDERS, 8" (TO BE REMOVED)
- ⑤ EXISTING AGGREGATE SHOULDER
- ⑥ EXISTING CONC. CURB & GUTTER
- ⑦ PROPOSED HMA SURFACE COURSE REMOVAL
- ⑧ PROPOSED EXCAVATING AND GRADING EXISTING SHOULDERS
- ⑨ PROPOSED BITUMINOUS MATERIALS (PRIME COAT)
- ⑩ PROPOSED AGGREGATE (PRIME COAT)
- ⑪ PROPOSED LEVELING BINDER, 3/4 "
- ⑫ PROPOSED SURFACE COURSE, 1 1/2"
- ⑬ PROPOSED HOT-MIX ASPHALT SHOULDER, 9 1/4"
- ⑭ PROPOSED SUBBASE GRANULAR MATERIAL, TYPE C, 4"
- ⑮ PROPOSED STRIP REFLECTIVE CRACK CONTROL
- ⑯ PROPOSED AGGREGATE WEDGE SHOULDER, TYPE B

NOTE:
THE INTENT OF THE MILLING IS TO REMOVE
HMA SURFACE MATERIAL ONLY. THE UNDERLYING
CONCRETE PAVEMENT SHALL NOT BE DISTURBED.

FILE NAME : #FILE#	USER NAME : #USER#	DESIGNED - ---	REVISED - ---	STATE OF ILLINOIS DEPARTMENT OF TRANSPORTATION	EXISTING TYPICALS	F.A.P. RTE.	SECTION	COUNTY	TOTAL SHEETS	SHEET NO.
	PLOT SCALE : #SCALE#	DRAWN - ---	REVISED - ---			42	(130,1)RS-5	CLINTON	26	6
	PLOT DATE : #DATE#	CHECKED - ---	REVISED - ---			CONTRACT NO. 76E11		FED. ROAD DIST. NO. ILLINOIS FED. AID PROJECT		
				SCALE: _____ SHEET NO. ___ OF ___ SHEETS STA. _____ TO STA. _____						

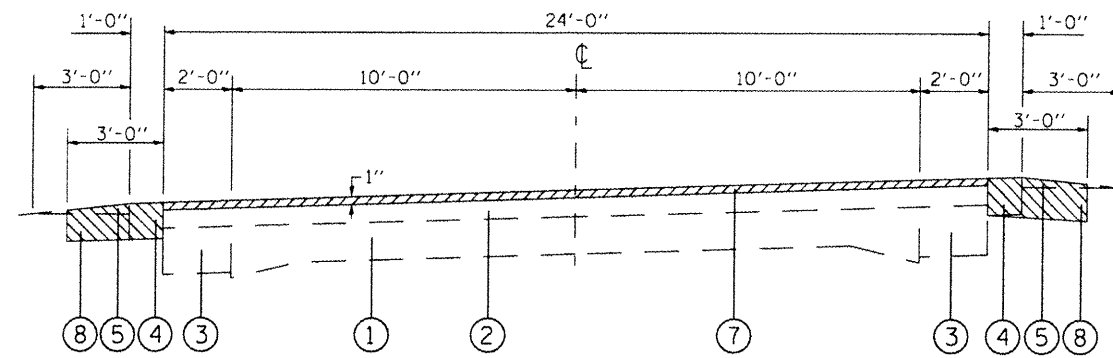

TYPICAL SECTION
M.P. 2.84 TO M.P. 3.02

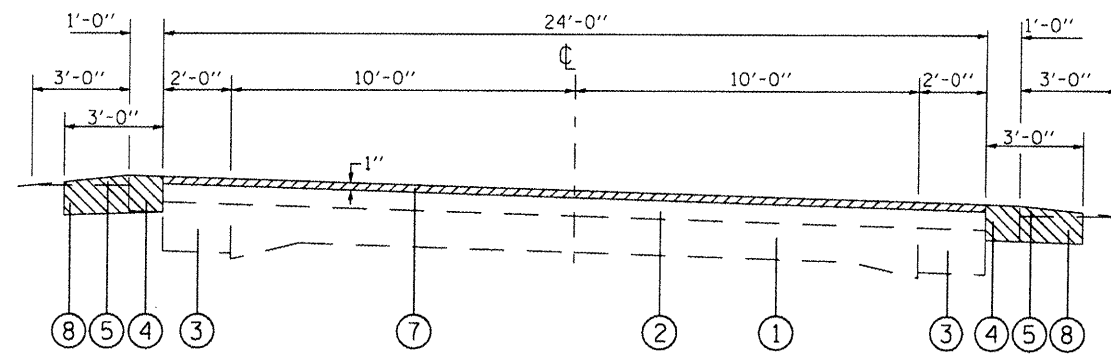

TYPICAL SECTION
M.P. 4.08 TO M.P. 4.18
M.P. 4.52 TO M.P. 4.72

LEGEND

- ① EXISTING CONCRETE PAVEMENT 9-6-9
- ② EXISTING RESURFACING, 4 1/2" (8" DEPTH*)
- ③ EXISTING PCC WIDENING, 8"
- ④ EXISTING HMA SHOULDERS, 8" (TO BE REMOVED)
- ⑤ EXISTING AGGREGATE SHOULDER
- ⑥ EXISTING CONC. CURB & GUTTER
- ⑦ PROPOSED HMA SURFACE COURSE REMOVAL
- ⑧ PROPOSED EXCAVATING AND GRADING EXISTING SHOULDERS
- ⑨ PROPOSED BITUMINOUS MATERIALS (PRIME COAT)
- ⑩ PROPOSED AGGREGATE (PRIME COAT)
- ⑪ PROPOSED LEVELING BINDER, 3/4 "
- ⑫ PROPOSED SURFACE COURSE, 1 1/2"
- ⑬ PROPOSED HOT-MIX ASPHALT SHOULDER, 9 1/4"
- ⑭ PROPOSED SUBBASE GRANULAR MATERIAL, TYPE C, 4"
- ⑮ PROPOSED STRIP REFLECTIVE CRACK CONTROL
- ⑯ PROPOSED AGGREGATE WEDGE SHOULDER, TYPE B

NOTE:
THE INTENT OF THE MILLING IS TO REMOVE
HMA SURFACE MATERIAL ONLY. THE UNDERLYING
CONCRETE PAVEMENT SHALL NOT BE DISTURBED.

FILE NAME *	USER NAME * #USER#	DESIGNED -	REVISD -	STATE OF ILLINOIS DEPARTMENT OF TRANSPORTATION	EXISTING TYPICALS	F.A.P. RTE.	SECTION	COUNTY	TOTAL SHEETS	SHEET NO.	
#FILE#		DRAWN -	REVISD -			42	(130,1)RS-5	CLINTON	26	7	
		CHECKED -	REVISD -			CONTRACT NO. 76E11					
		DATE	REVISD -			FED. ROAD DIST. NO. ILLINOIS FED. AID PROJECT					
				SCALE: _____ SHEET NO. _____ OF _____ SHEETS STA. _____ TO STA. _____							

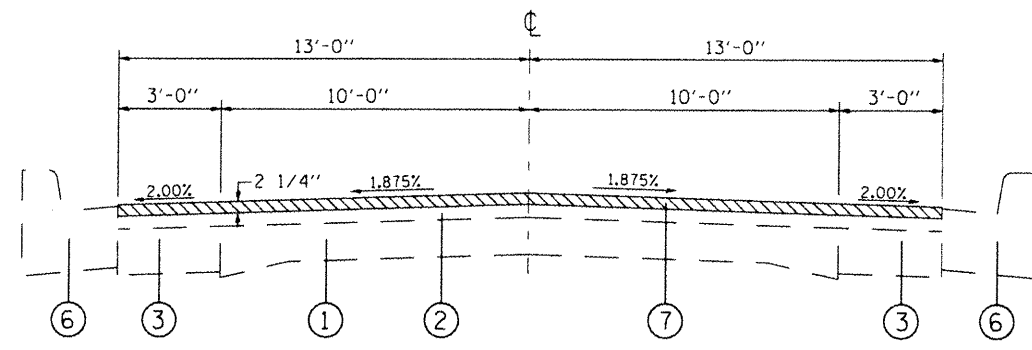

TYPICAL SECTION

M.P. 6.46 TO M.P. 6.65
M.P. 6.65 TO M.P. 6.68*

*OVERALL PAVEMENT WIDTH = 30'

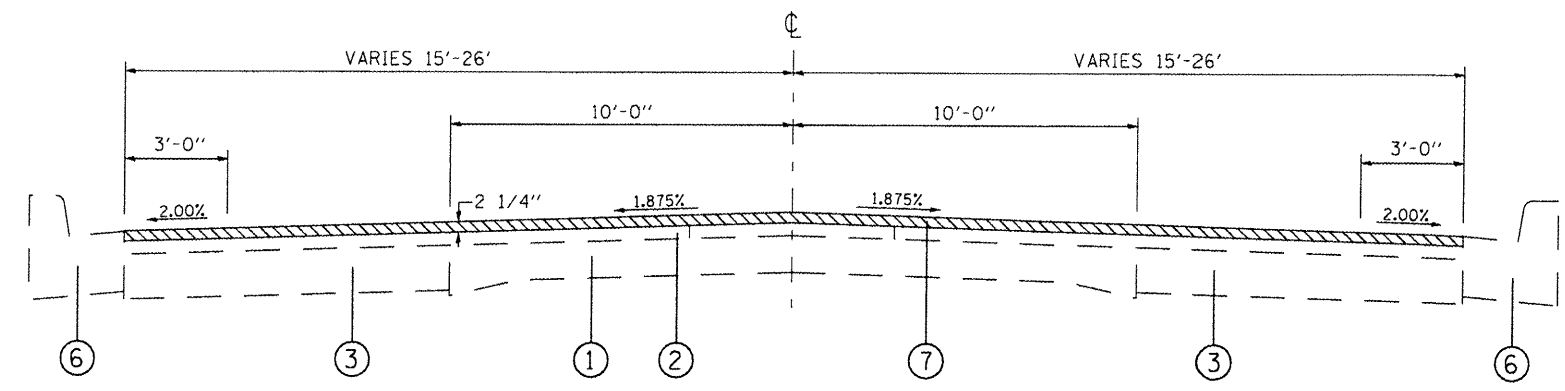

TYPICAL SECTION

M.P. 6.68 TO M.P. 6.73

LEGEND

- ① EXISTING CONCRETE PAVEMENT 9-6-9
- ② EXISTING RESURFACING, 4 1/2" (8" DEPTH*)
- ③ EXISTING PCC WIDENING, 8"
- ④ EXISTING HMA SHOULDERS, 8" (TO BE REMOVED)
- ⑤ EXISTING AGGREGATE SHOULDER
- ⑥ EXISTING CONC. CURB & GUTTER
- ⑦ PROPOSED HMA SURFACE COURSE REMOVAL
- ⑧ PROPOSED EXCAVATING AND GRADING EXISTING SHOULDERS
- ⑨ PROPOSED BITUMINOUS MATERIALS (PRIME COAT)
- ⑩ PROPOSED AGGREGATE (PRIME COAT)
- ⑪ PROPOSED LEVELING BINDER, 3/4 "
- ⑫ PROPOSED SURFACE COURSE, 1 1/2"
- ⑬ PROPOSED HOT-MIX ASPHALT SHOULDER, 9 1/4"
- ⑭ PROPOSED SUBBASE GRANULAR MATERIAL, TYPE C, 4"
- ⑮ PROPOSED STRIP REFLECTIVE CRACK CONTROL
- ⑯ PROPOSED AGGREGATE WEDGE SHOULDER, TYPE B

NOTE:
THE INTENT OF THE MILLING IS TO REMOVE HMA SURFACE MATERIAL ONLY. THE UNDERLYING CONCRETE PAVEMENT SHALL NOT BE DISTURBED.

FILE NAME : *FILEL*	USER NAME : *USER*	DESIGNED - DRAWN -	REVISED - REVISED -	STATE OF ILLINOIS DEPARTMENT OF TRANSPORTATION	EXISTING TYPICALS	F.A.P. RTE. 42	SECTION (130,11RS-5)	COUNTY CLINTON	TOTAL SHEETS 26	SHEET NO. 8	
PLOT SCALE : *SCALE*	CHECKED -	REVISED -	SCALE: _____			SHEET NO. _____ OF _____ SHEETS	STA. _____ TO STA. _____	CONTRACT NO. 76E11			
PLOT DATE : *DATE*	DATE -	REVISED -	FED. ROAD DIST. NO. - ILLINOIS FED. AID PROJECT								

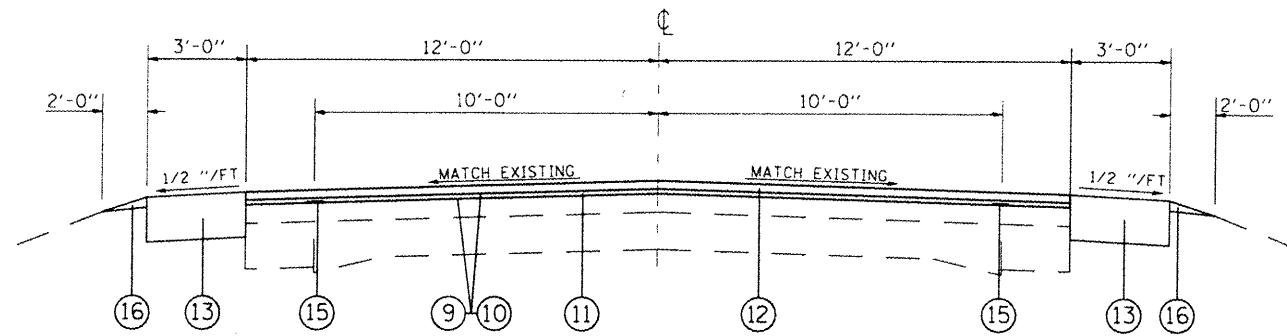

TYPICAL SECTION

M.P. 0.00 TO M.P. 1.13
M.P. 1.16 TO M.P. 2.49
M.P. 2.57 TO M.P. 2.84
M.P. 3.02 TO M.P. 4.08
M.P. 4.40 TO M.P. 4.52
M.P. 4.72 TO M.P. 6.46

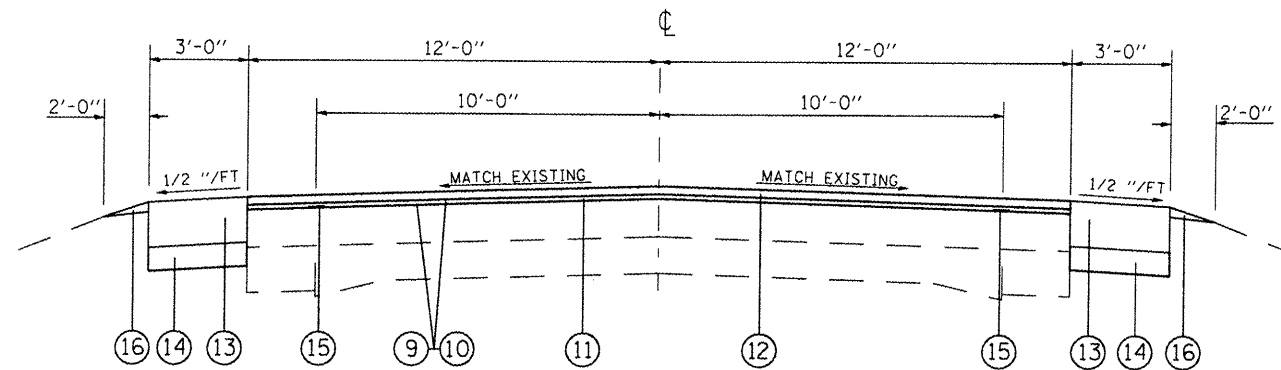

TYPICAL SECTION

M.P. 2.49 TO M.P. 2.57 *

LEGEND

- ① EXISTING CONCRETE PAVEMENT 9-6-9
- ② EXISTING RESURFACING, 4 1/2" (8" DEPTH*)
- ③ EXISTING PCC WIDENING, 8"
- ④ EXISTING HMA SHOULDERS, 8" (TO BE REMOVED)
- ⑤ EXISTING AGGREGATE SHOULDER
- ⑥ EXISTING CONC. CURB & GUTTER
- ⑦ PROPOSED HMA SURFACE COURSE REMOVAL
- ⑧ PROPOSED EXCAVATING AND GRADING EXISTING SHOULDERS
- ⑨ PROPOSED BITUMINOUS MATERIALS (PRIME COAT)
- ⑩ PROPOSED AGGREGATE (PRIME COAT)
- ⑪ PROPOSED LEVELING BINDER, 3/4 "
- ⑫ PROPOSED SURFACE COURSE, 1 1/2"
- ⑬ PROPOSED HOT-MIX ASPHALT SHOULDER, 9 1/4"
- ⑭ PROPOSED SUBBASE GRANULAR MATERIAL, TYPE C, 4"
- ⑮ PROPOSED STRIP REFLECTIVE CRACK CONTROL
- ⑯ PROPOSED AGGREGATE WEDGE SHOULDER, TYPE B

FILE NAME : #FILE#	USER NAME : #USER#	DESIGNED - ---	REVISED - ---	STATE OF ILLINOIS DEPARTMENT OF TRANSPORTATION	PROPOSED TYPICALS	F.A.P. RTE.	SECTION	COUNTY	TOTAL SHEETS	SHEET NO.
	PLOT SCALE : #SCALE#	DRAWN - ---	REVISED - ---			42	(130,1)RS-5	CLINTON	26	9
	PLOT DATE : #DATE#	CHECKED - ---	REVISED - ---			CONTRACT NO. 76E11			FED. ROAD DIST. NO. ILLINOIS FED. AID PROJECT	
				SCALE: _____ SHEET NO. _____ OF _____ SHEETS STA. _____ TO STA. _____						

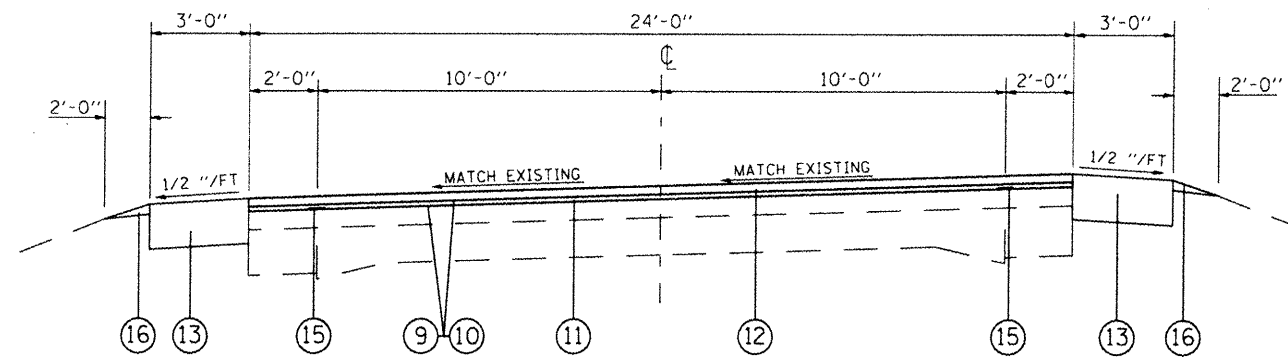

TYPICAL SECTION
M.P. 2.84 TO M.P. 3.02

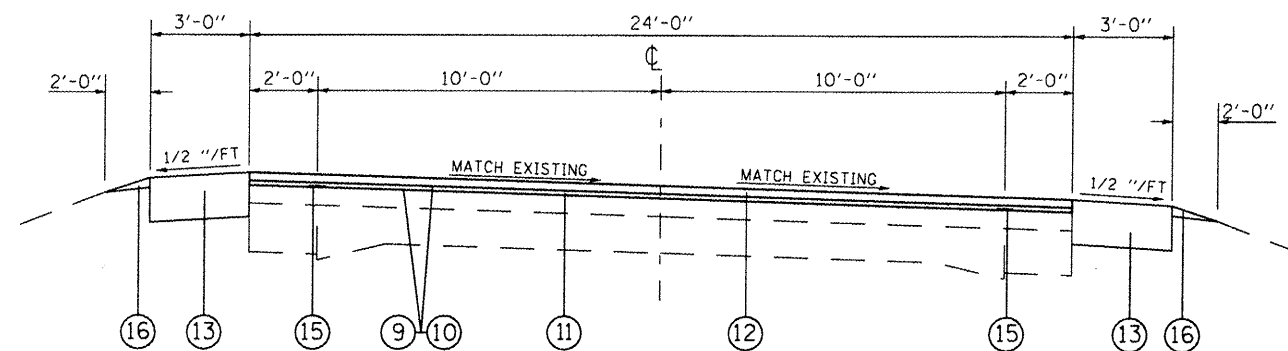

TYPICAL SECTION
M.P. 4.08 TO M.P. 4.18
M.P. 4.52 TO M.P. 4.72

LEGEND

- ① EXISTING CONCRETE PAVEMENT 9-6-9
- ② EXISTING RESURFACING, 4 1/2" (8" DEPTH*)
- ③ EXISTING PCC WIDENING, 8"
- ④ EXISTING HMA SHOULDERS, 8" (TO BE REMOVED)
- ⑤ EXISTING AGGREGATE SHOULDER
- ⑥ EXISTING CONC. CURB & GUTTER
- ⑦ PROPOSED HMA SURFACE COURSE REMOVAL
- ⑧ PROPOSED EXCAVATING AND GRADING EXISTING SHOULDERS
- ⑨ PROPOSED BITUMINOUS MATERIALS (PRIME COAT)
- ⑩ PROPOSED AGGREGATE (PRIME COAT)
- ⑪ PROPOSED LEVELING BINDER, 3/4 "
- ⑫ PROPOSED SURFACE COURSE, 1 1/2"
- ⑬ PROPOSED HOT-MIX ASPHALT SHOULDER, 9 1/4"
- ⑭ PROPOSED SUBBASE GRANULAR MATERIAL, TYPE C, 4"
- ⑮ PROPOSED STRIP REFLECTIVE CRACK CONTROL
- ⑯ PROPOSED AGGREGATE WEDGE SHOULDER, TYPE B

FILE NAME :	USER NAME : *USER*	DESIGNED -	REVISED -	STATE OF ILLINOIS DEPARTMENT OF TRANSPORTATION	PROPOSED TYPICALS	F.A.P. RTE.	SECTION	COUNTY	TOTAL SHEETS	SHEET NO.
FILE#		DRAWN -	REVISED -			42	(130,1)RS-5	CLINTON	26	10
		CHECKED -	REVISED -			CONTRACT NO. 76E11				
		DATE	REVISED -	SCALE: _____ SHEET NO. _____ OF _____ SHEETS STA. _____ TO STA. _____		FED. ROAD DIST. NO. _____ ILLINOIS FED. AID PROJECT				

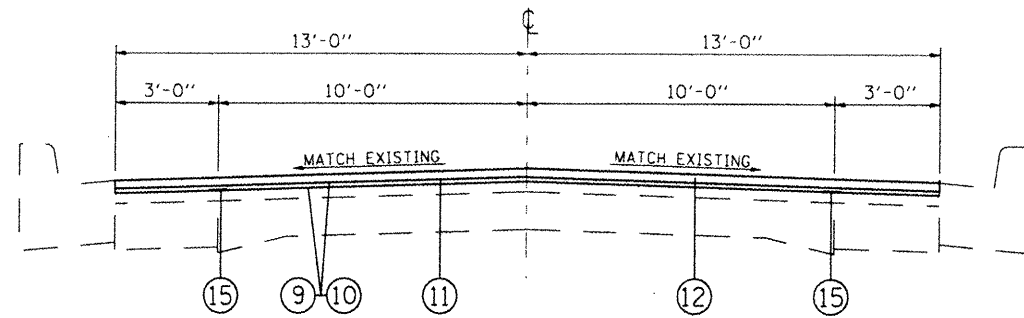

TYPICAL SECTION

M.P. 6.46 TO M.P. 6.65
M.P. 6.65 TO M.P. 6.68*

*OVERALL PAVEMENT
WIDTH = 30'

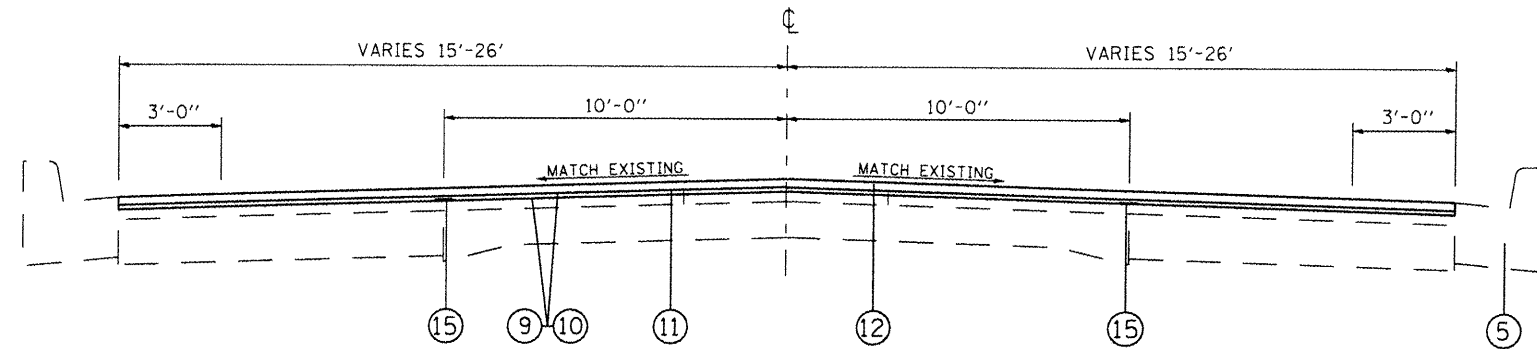

TYPICAL SECTION

M.P. 6.68 TO M.P. 6.73

LEGEND

- ① EXISTING CONCRETE PAVEMENT 9-6-9
- ② EXISTING RESURFACING, 4 1/2" (8" DEPTH)
- ③ EXISTING PCC WIDENING, 8"
- ④ EXISTING HMA SHOULDERS, 8" (TO BE REMOVED)
- ⑤ EXISTING AGGREGATE SHOULDER
- ⑥ EXISTING CONC. CURB & GUTTER
- ⑦ PROPOSED HMA SURFACE COURSE REMOVAL
- ⑧ PROPOSED EXCAVATING AND GRADING EXISTING SHOULDERS
- ⑨ PROPOSED BITUMINOUS MATERIALS (PRIME COAT)
- ⑩ PROPOSED AGGREGATE (PRIME COAT)
- ⑪ PROPOSED LEVELING BINDER, 3/4 "
- ⑫ PROPOSED SURFACE COURSE, 1 1/2"
- ⑬ PROPOSED HOT-MIX ASPHALT SHOULDER, 9 1/4"
- ⑭ PROPOSED SUBBASE GRANULAR MATERIAL, TYPE C, 4"
- ⑮ PROPOSED STRIP REFLECTIVE CRACK CONTROL
- ⑯ PROPOSED AGGREGATE WEDGE SHOULDER, TYPE B

FILE NAME =	USER NAME = *USER*	DESIGNED -	REVISIONS -	STATE OF ILLINOIS DEPARTMENT OF TRANSPORTATION	PROPOSED TYPICALS	F.A.P. RTE.	SECTION	COUNTY	TOTAL SHEETS	SHEET NO.	
FILE#		DRAWN -	REVISIONS -			42	(130,)RS-5	CLINTON	26	11	
		CHECKED -	REVISIONS -			CONTRACT NO. 76E11					
		DATE -	REVISIONS -			ILLINOIS FED. AID PROJECT					
				SCALE: _____	SHEET NO. _____ OF _____ SHEETS	STA. _____ TO STA. _____					

MAINLINE RESURFACING SCHEDULE										
LOCATION			HMA SURFACE REMOVAL 1" (SQ YD)	HMA SURFACE REMOVAL 2 1/4" (SQ YD)	BIT. MAT'L PRIME COAT (TON)	AGGREGATE PRIME COAT (TON)	LEVELING BINDER (TON)	HMA SURFACE COURSE (TON)	STRIP REFLECTIVE CRACK CONTROL (FOOT)	COMMENTS
M.P.	to	M.P.								
0.00	to	1.13	15910		9.96	47.74	668.24	1336.47	11932.80	
BRIDGE OMISSION										
1.16	to	4.19	42662		26.7	127.98	1791.82	3583.64	31996.80	
BRIDGE OMISSION										
4.40	to	6.46	29005		18.16	87.02	1218.20	2436.4	21753.60	
6.46	to	6.65		2898	1.82	8.70	121.72	243.44	2006.40	
6.65	to	6.71								
6.71	to	6.72								
6.72	to	6.73								
SUB-TOTAL										
6.65	to	6.73		1532	0.96	4.60	64.35	128.7	850.00	
TOTAL =			87578	4430	57.6	277	3865	7729	68540	

TEMPORARY RAMP/BUTT JOINT SCHEDULE					
LOCATION	DEPTH	WIDTH	LENGTH	TEMPORARY RAMP	HMA SURFACE REMOVAL, BUTT JOINT
MILE PT.	(INCH)	FOOT	FOOT	SQ YD	SQ YD
MAINLINE					
0.00	1.00	24.00	3.00	8.00	26.67
1.13	1.00	24.00	3.00	8.00	26.67
1.23	1.00	24.00	3.00	8.00	26.67
4.19	1.00	24.00	3.00	8.00	26.67
4.40	1.00	24.00	3.00	8.00	26.67
6.73	2.25	51.00	7.00	39.67	
SIDROADS					
6.52 (LT)	2.25	24.00	7.00	18.67	
6.52 (RT)	2.25	24.00	7.00	18.67	
6.59 (LT)	2.25	24.00	7.00	18.67	
6.59 (RT)	2.25	32.00	7.00	24.89	
6.67 (LT)	2.25	24.00	7.00	18.67	
6.67 (RT)	2.25	24.00	7.00	18.67	
TOTAL =				198	133

SHOULDER SCHEDULE									
LOCATION			EXCAV. & GRAD. FOR EXISTING SHLDR. (UNIT)	PAVED SHOULDER REMOVAL (SQ YD)	HMA SHOULDERS 9 1/4" (SQ YD)	HMA SHOULDERS (TON)	SUB-BASE GRANULAR MATERIAL TYPE C (TON)	AGGREGATE WEDGE SHOULDER, TYPE B (TON)	COMMENTS
M.P.	to	M.P.							
0.00	to	1.01	106.66	1185.11	3555.33			276.51	
1.01	to	1.04				16.33		9.07	EXT. CONC. SHLDR.
IL 161									
1.06	to	1.07				3.73		2.07	EXT. CONC. SHLDR.
1.07	to	1.09	2.12	23.56	70.67			5.50	
1.09	to	1.13				9.01		10.01	EXT. CONC. SHLDR.
BRIDGE OMISSION									
1.16	to	1.19				6.16		6.84	EXT. CONC. SHLDR.
1.19	to	2.49	137.28	1525.33	4576.00			355.89	
2.49	to	2.57	8.45	93.87	281.60		65.70	21.90	
2.57	to	4.19	171.07	1900.80	5702.40			443.49	
BRIDGE OMISSION									
4.40	to	6.46	217.54	2417.07	7251.20			563.95	
TOTAL =			643	7146	21437	35	66	1695	

*See Sheet 21 for Details

FILE NAME	USER NAME	DESIGNED	REVISED	STATE OF ILLINOIS DEPARTMENT OF TRANSPORTATION	SCHEDULES	F.A.P. RTE.	SECTION	COUNTY	TOTAL SHEETS	SHEET NO.	
#FILE#	#USER#	DRAWN	REVISED			42	(130,1)RS-5	CLINTON	26	12	
		CHECKED	REVISED			CONTRACT NO. 76E11					
		DATE	REVISED			FED. ROAD DIST. NO. ILLINOIS FED. AID PROJECT					
				SCALE: _____ SHEET NO. ___ OF ___ SHEETS STA. _____ TO STA. _____							

ENTRANCE SCHEDULE

LOCATION	SIDE	SURFACE TYPE	P.C.C. SURFACE REMOVAL, BUTT JOINT	DRIVEWAY PAVEMENT REMOVAL	AGGREGATE SURFACE COURSE, TYPE B, 6"	INCIDENTAL HMA SURFACING	COMMENTS
MILE PT.	LT/RT		SO YD	SO YD	TON	TON	
0.27	RT	CONCRETE	25.00			3.92	
0.28	RT	CONCRETE	25.00			3.92	
0.44	RT	AGGREGATE			2.10		
0.59	LT	CONCRETE	25.00			3.92	
0.65	RT	AGGREGATE			2.10		
0.66	LT	CONCRETE	25.00			3.92	
0.95	LT	FIELD			2.10		
1.06	LT	AGGREGATE			2.10		
1.10	LT	HMA		12.00	2.10	1.34	
1.22	LT	AGGREGATE			2.10		
1.24	RT	AGGREGATE			2.10		
1.24	RT	AGGREGATE			2.10		
1.27	RT	AGGREGATE			2.10		
1.28	LT	FIELD			2.10		
1.30	LT	FIELD			2.10		
1.46	LT	FIELD			2.10		
1.46	RT	FIELD			2.10		
1.50	LT	AGGREGATE			2.10		
1.58	LT	FIELD			2.10		
1.68	LT	FIELD			2.10		
1.79	RT	FIELD			2.10		
1.81	LT	FIELD			2.10		
1.96	LT	FIELD			2.10		
2.08	LT	AGGREGATE			2.10		
2.08	RT	FIELD			2.10		
2.22	RT	AGGREGATE			2.10		
2.22	LT	FIELD			2.10		
2.48	RT	FIELD			2.10		
2.66	LT	FIELD			2.10		
2.90	RT	FIELD			2.10		
3.00	LT	FIELD			2.10		
3.00	RT	FIELD			2.10		
3.20	RT	AGGREGATE			2.10		
3.21	LT	HMA		12.00	2.10	1.34	
3.24	RT	AGGREGATE			2.10		
3.33	RT	AGGREGATE			2.10		
3.70	RT	AGGREGATE			2.10		
3.80	RT	AGGREGATE			2.10		
3.87	RT	AGGREGATE			2.10		
4.02	LT	FIELD			2.10		
4.08	RT	AGGREGATE			2.10		
4.39	LT	AGGREGATE			2.10		
4.62	RT	AGGREGATE			2.10		
CONT.							

LOCATION	SIDE	SURFACE TYPE	P.C.C. SURFACE REMOVAL, BUTT JOINT	DRIVEWAY PAVEMENT REMOVAL	AGGREGATE SURFACE COURSE, TYPE B, 6"	INCIDENTAL HMA SURFACING	COMMENTS
MILE PT.	LT/RT		SO YD	SO YD	TON	TON	
4.75	RT	AGGREGATE			2.10		
4.90	RT	AGGREGATE			2.10		
5.13	RT	AGGREGATE			2.10		
5.14	RT	AGGREGATE			2.10		
5.17	RT	AGGREGATE			2.10		
5.19	LT	HMA		12.00	2.10	1.34	
5.22	RT	AGGREGATE			2.10		
5.23	RT	AGGREGATE			2.10		
5.25	LT	HMA		12.00	2.10	1.34	
5.40	RT	HMA		12.00	2.10	1.34	
5.40	LT	HMA		12.00	2.10	1.34	
5.41	RT	HMA		12.00	2.10	1.34	
5.47	RT	HMA		12.00	2.10	1.34	
5.53	RT	AGGREGATE			2.10		
5.56	RT	AGGREGATE			2.10		
5.65	RT	AGGREGATE			2.10		
5.90	LT	AGGREGATE			2.10		
6.16	LT	FIELD			2.10		
TOTAL			100	96	120	26	

SIDE ROAD SCHEDULE

LOCATION	SIDE	LENGTH	HMA SURFACE REMOVAL 2 1/4"	P.C.C SURFACE REMOVAL, BUTT JOINT	HMA SURFACE REMOVAL, BUTT JOINT	BIT. MAT'L PRIME COAT	AGGREGATE PRIME COAT	INCIDENTAL HMA SURFACING	COMMENTS
MILE PT.	LT/RT	(FEET)	(SQ YD)	(SQ YD)	(SQ YD)	(TON)	(TON)	(TON)	
0.27	LT	9.00			66.67	0.06	0.30	8.40	POST OAK RD.
0.72	LT	9.00			33.33	0.03	0.15	4.20	RIPPLENGER RD.
1.30	RT	9.00			46.67	0.04	0.21	5.88	POSEY RD.
1.86	LT	9.00			26.67	0.03	0.12	3.36	WESSELMAN RD.
1.86	RT	9.00			26.67	0.03	0.12	3.36	WESSELMAN RD.
2.47	LT	9.00			26.67	0.03	0.12	3.36	TWENHAFEL RD
2.47	RT	9.00			26.67	0.03	0.12	3.36	TWENHAFEL RD
3.36	RT	9.00			46.67	0.04	0.21	5.88	VOGEL RD.
4.15	LT	9.00			33.33	0.03	0.15	4.20	JONATHAN RD.
4.58	LT	9.00		33.33		0.02	0.10	2.80	RED CLOVER LN.
4.63	LT	9.00		33.33		0.02	0.10	2.80	OAKWOOD RD.
5.65	LT	9.00				0.05	0.24	6.72	HIGHLINE RD.
6.52	LT	30.00	125.00			0.08	0.38	10.50	RIDGE ST.
6.52	RT	30.00	128.00			0.08	0.38	10.75	RIDGE ST.
6.59	LT	30.00	127.00			0.08	0.38	10.67	METHODIST ST.
6.59	RT	30.00	150.00			0.09	0.45	12.60	METHODIST ST.
6.67	LT	30.00	120.00			0.08	0.36	10.08	WASHINGTON ST.
6.67	RT	30.00	121.00			0.08	0.36	10.16	WASHINGTON ST.
TOTAL =			771	67	334	0.9	4	119	

FILE NAME	USER NAME	DESIGNED	REVISED	STATE OF ILLINOIS DEPARTMENT OF TRANSPORTATION	SCHEDULES	F.A.P. RTE.	SECTION	COUNTY	TOTAL SHEETS	SHEET NO.	
*FILE#	*USER#	DRAWN	REVISED			42	(130,1)RS-5	CLINTON	26	13	
		CHECKED	REVISED			SCALE: _____	SHEET NO. _____ OF _____ SHEETS	CONTRACT NO. 76E11			
		DATE	REVISED			STA. _____ TO STA. _____		FED. ROAD DIST. NO. _____ ILLINOIS FED. AID PROJECT			

PAVEMENT MARKING

LOCATION			THERMOPLASTIC PAVEMENT MARKING										RAISED REFLECTIVE PAVEMENT MARKER					
			4"					12"		24"	LETTERS & SYMBOLS	RAISED REFLECTIVE PAVEMENT MARKER REMOVAL				ONE WAY AMBER	TWO WAY AMBER	ONE WAY CRYSTAL
			SOLID WHITE EDGE LINE	SOLID WHITE LANE LINE	SKIP-DASH YELLOW CENTERLINE	SOLID DOUBLE YELLOW LINE - MEDIAN	SOLID YELLOW CENTER LINE	SOLID YELLOW DIAGONAL	SOLID WHITE CROSS WALKS	SOLID WHITE	LEFT TURN ARROW							
MILE PT.	TO	MILE PT.	FOOT	FOOT	FOOT	FOOT	FOOT	FOOT	FOOT	FOOT	SQ FT	EACH	EACH	EACH	EACH			
0.00	TO	1.03	5440	10880	1405							68		68				
1.03	TO	1.16	670	1340	168			670				8		8				
1.20	TO	1.43	1228	2456	307			1228				15		15				
1.43	TO	3.45	11175	22350	2794							140		140				
3.45	TO	3.54	480	960	120			480				6		6				
3.54	TO	3.68	715	1430	179							9		9				
3.68	TO	3.78	550	1100	138			550				7		7				
3.78	TO	3.87	470	940	118							6		6				
3.87	TO	4.09	1140	2280	285			1140				14		14				
4.09	TO	4.11	120	240				240				2		2				
4.11	TO	4.16	240	480	60			240				3		3				
4.16	TO	4.38	1161	2322	290			1161				15		15				
4.38	TO	4.41	120	240	30			120				2		2				
4.41	TO	4.69	1490	2980	373							19		19				
4.69	TO	4.84	820	1640	205			820				10		10				
4.84	TO	4.91	330	660	83							4		4				
4.91	TO	5.05	760	1520	190			760				10		10				
5.05	TO	6.46	7438	14876	1860							93		93				
6.46	TO	6.59	686	1372	169					24		9		9				
6.59	TO	6.67	425	850	107			425		24	62	5		5				
6.67	TO	6.73	317	634	100		850	200	80	455	64	92	18	12	3	3		
SUB-TOTALS				71550	100	8881	850	8034	80	455	112	154	461	12	446	3		
TOTALS						89415				535	112	154	461		461			

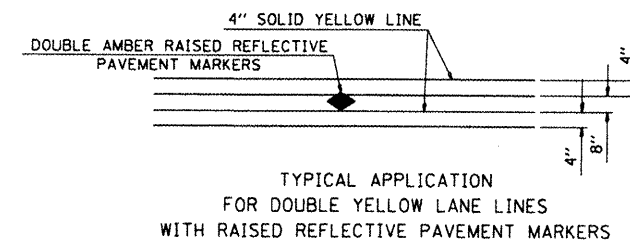
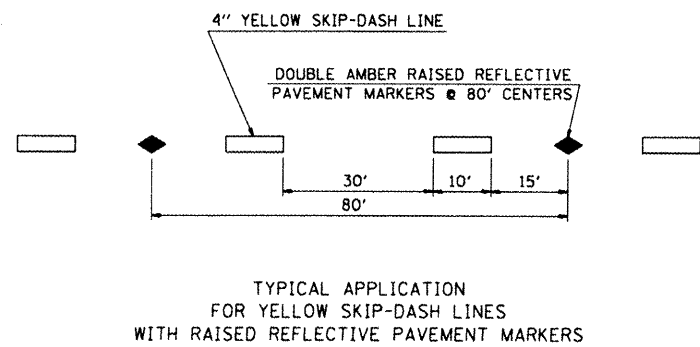

FILE NAME : #FILE#	USER NAME : #USER#	DESIGNED - ---	REVISED - ---	STATE OF ILLINOIS DEPARTMENT OF TRANSPORTATION	SCHEDULES	F.A.P. RTE. 42	SECTION (130,1RS-5)	COUNTY CLINTON	TOTAL SHEETS 26	SHEET NO. 14
PLOT SCALE : #SCALE#	CHECKED - ---	DATE - ---	REVISED - ---	SCALE: -----	SHEET NO. ___ OF ___ SHEETS	CONTRACT NO. 76E11				
PLOT DATE : #DATE#	DATE - ---	REVISED - ---	REVISED - ---	STA. ----- TO STA. -----		FED. ROAD DIST. NO. - [ILLINOIS] FED. AID PROJECT				

PATCHING SCHEDULE

LOCATION	NB/SB	LENGTH (FEET)	WIDTH (FEET)	PAVEMENT PATCHING 14"			COMMENTS
				TYPE 2	TYPE 3	TYPE 4	
				(SQ YDS)	(SQ YDS)	(SQ YDS)	
0.019	SB	20	12			27	
0.019	NB	20	12			27	
0.034	NB	100	6			67	
0.080	NB	15	6	10			
0.096	NB	10	6	7			
0.116	NB	20	6	13			
0.219	SB	20	6	13			
0.288	SB	12	12		16		
0.314	SB	30	6		20		
0.368	SB	15	12		20		
0.368	NB	15	12		20		
0.505	NB	4	12	5			
0.505	SB	4	12	5			
0.544	NB	40	4		18		
0.587	SB	6	12	8			
0.587	NB	6	12	8			
0.598	NB	40	4		18		
0.613	NB	20	6	13			
0.625	NB	4	12	5			
0.671	NB	100	4			44	
0.700	SB	15	6	10			
0.700	NB	100	6			67	
0.710	SB	20	12			27	
0.710	NB	20	12			27	
0.726	SB	6	12	8			
0.726	NB	6	12	8			
0.732	SB	6	12	8			
0.732	NB	6	12	8			
0.812	NB	6	12	8			
0.830	SB	12	12		16		
0.830	NB	12	12		16		
0.843	NB	100	6			67	
0.863	NB	40	4		18		
0.863	SB	40	4		18		
0.876	NB	4	12				
0.909	NB	25	6		17		
0.920	NB	15	6	10			
0.930	SB	40	12			53	
0.930	NB	40	12			53	
0.939	SB	40	4		18		
0.944	SB	6	12	8			
0.944	NB	6	12	8			
0.980	SB	20	12			27	
0.980	NB	4	12	5			
1.018	NB	40	12			53	
1.131	SB	6	12	8			
1.131	NB	6	12	8			
1.549	SB	120	4			53	
1.576	SB	30	12			40	
1.576	NB	30	12			40	
1.658	SB	12	12		16		
1.658	NB	12	12		16		
1.670	SB	15	12		20		
1.690	SB	30	12			40	
1.690	NB	30	12			40	
SUB-TOTALS				184	267	752	

PATCHING SCHEDULE

LOCATION	NB/SB	LENGTH (FEET)	WIDTH (FEET)	PAVEMENT PATCHING 14"			COMMENTS
				TYPE 2	TYPE 3	TYPE 4	
				(SQ YDS)	(SQ YDS)	(SQ YDS)	
1.734	SB	120	4			53	
1.793	NB	160	4			71	
1.837	SB	160	4			71	
1.837	NB	12	4	5			
1.861	SB	12	12		16		
1.861	NB	12	12		16		
1.910	SB	100	6			67	
1.915	NB	15	12		20		
1.924	NB	20	4	9			
1.932	SB	20	4	9			
1.954	SB	90	6			60	
1.965	SB	50	12			67	
1.965	NB	12	12		16		
1.992	NB	20	12			27	
2.017	SB	15	12		20		
2.020	SB	20	4	9			
2.042	NB	15	12		20		
2.050	NB	50	12			67	
2.064	SB	60	12			80	
2.100	SB	20	4	9			
2.125	SB	50	6			33	
2.137	SB	30	12			40	
2.144	NB	90	12			120	
2.157	NB	12	12		16		
2.176	SB	240	6			160	
2.176	NB	50	6			33	
2.186	SB	50	12			67	
2.186	NB	50	12			67	
2.206	NB	20	12			27	
2.206	SB	20	12			27	
2.214	NB	30	4	13			
2.230	SB	100	6			67	
2.249	NB	4	12	5			
2.264	SB	120	4			53	
2.272	SB	30	12			40	
2.272	NB	15	12		20		
2.279	SB	12	12		16		
2.279	NB	12	12		16		
2.286	SB	25	6		17		
2.360	SB	12	12		16		
2.360	NB	12	12		16		
2.370	SB	15	6	10			
2.378	NB	6	12	8			
2.388	SB	4	12	5			
2.617	NB	40	4		18		
2.637	SB	200	4			89	
2.707	SB	200	4			89	
2.730	NB	4	12	5			
2.736	SB	4	12	5			
2.736	NB	6	12	8			
2.743	SB	15	12		20		
2.754	SB	8	12	11			
2.754	NB	8	12	11			
2.765	SB	12	12		16		
2.765	NB	200	6			133	
2.815	NB	4	12	5			
2.817	SB	20	4	9			
SUB-TOTALS				136	279	1608	

PATCHING SCHEDULE

LOCATION	NB/SB	LENGTH (FEET)	WIDTH (FEET)	PAVEMENT PATCHING 14"			COMMENTS
				TYPE 2	TYPE 3	TYPE 4	
				(SQ YDS)	(SQ YDS)	(SQ YDS)	
2.853	SB	6	12	8			
2.857	SB	30	4	13			
2.890	SB	12	12		16		
2.890	NB	12	12		16		
2.914	SB	20	12			27	
2.914	NB	30	12			40	
2.964	SB	6	12	8			
2.964	NB	6	12	8			
2.997	NB	6	12	8			
3.082	SB	15	6	10			
3.082	NB	15	6	10			
3.115	SB	50	4				
3.115	NB	25	4	11			
3.134	SB	50	4			22	
3.134	NB	50	4			22	
3.148	NB	80	6			53	
3.162	SB	150	6			100	
3.174	NB	20	6	13			
3.182	SB	20	4	9			
3.192	SB	15	6	10			
3.250	NB	20	4	9			
3.277	SB	80	4			36	
3.290	NB	30	4	13			
3.295	SB	20	6	13			
3.318	SB	12	12		16		
3.347	SB	60	4			27	
3.369	NB	60	4			27	
3.372	SB	20	6	13			
3.381	SB	20	12			27	
3.381	NB	20	12			27	
3.390	SB	30	6		20		
3.390	NB	30	6		20		
3.548	SB	180	4			80	
3.590	NB	480	4			213	
3.616	NB	100	4			44	
3.627	SB	120	4			63	
3.636	NB	15	4	7			
3.664	NB	4	12	5			
3.709	SB	20	3	7			
3.718	SB	160	4			71	
3.755	SB	20	4	9			
3.800	NB	4	12	5			
3.823	SB	400	6			267	
3.831	NB	60	4			27	
3.851	SB	100	12			133	
3.851	NB	12	12		16		
3.871	SB	12	12		16		
3.880	NB	120	4			53	
3.890	SB	50	6			33	
3.909	SB	20	12			27	
3.909	NB	20	12			27	
3.934	SB	40	4		18		
3.934	NB	4	12	5			
3.949	NB	30	4	13			
3.964	NB	30	4	13			
3.999	SB	280	6			187	
3.999	NB	180	4			80	
4.015	SB	15	12		20		
4.015	NB	15	12		20		
4.043	NB	120	4			53	
SUB-TOTALS				220	178	1766	

PATCHING SCHEDULE

LOCATION	NB/SB	LENGTH (FEET)	WIDTH (FEET)	PAVEMENT PATCHING 14"			COMMENTS
				TYPE 2	TYPE 3	TYPE 4	
				(SQ YDS)	(SQ YDS)	(SQ YDS)	
4.052	SB	120	6			80	
4.063	SB	4	12	5			
4.073	SB	4	12	5			
4.441	SB	60	4			27	
4.441	NB	60	4			27	
4.502	SB	200	4			89	
4.554	NB	6	12	8			
4.570	SB	20	4	9			
4.600	SB	100	4			44	
4.627	SB	12	12		16		
4.627	NB	12	12		16		
4.632	SB	12	12		16		
4.632	NB	12	12		16		
4.638	NB	120	4			53	
4.642	SB	6	12	8			
4.642	NB	6	12	8			
4.659	SB	4	12	5			
4.659	NB	8	12	11			
4.830	SB	4	12	5			
4.830	NB	4	12	5			
4.831	SB	15	12		20		
4.831	NB	15	12		20		
4.845	SB	4	12	5			
4.845	NB	4	12	5			
4.856	SB	4	12	5			
4.856	NB	4	12	5			
4.860	NB	4	12	5			
4.881	SB	200	4			89	
4.881	NB	200	4			89	
4.885	SB	6	12	8			
4.885	NB	6	12	8			
4.894	SB	6	12	8			
4.894	NB	12	12		16		
4.897	SB	120	2			27	
4.945	SB	60	4			27	
4.964	SB	4	12	5			
4.964	NB	4	12	5			
4.986	SB	6	12	8			
4.986	NB	6	12	8			
4.996	SB	24	12			32	
4.996	NB	4	12	5			
5.013	NB	4	12	5			
5.017	NB	8	12	11			
5.018	SB	40	4		18		
5.044	SB	25	12			33	
5.044	NB	25	12			33	
5.068	SB	120	4			53	
5.092	SB	6	12	8			
5.092	NB	6	12	8			
5.115	NB	6	12	8			
5.131	SB	120	4			53	
5.145	SB	4	12	5			
5.151	SB	6	12	8			
5.151	NB	12	12		16		
5.169	SB	12	12		16		
5.169	NB	40	4		18		
5.172	SB	12	12		16		
5.172	NB	12	12		16		
5.185	SB	6	12	8			
5.185	NB	6	12	8			
5.208	NB	4	12	5			
5.216	SB	4	12	5			
5.216	NB	4	12	5			
SUB-TOTALS				233	220	756	

PATCHING SCHEDULE

LOCATION	NB/SB	LENGTH (FEET)	WIDTH (FEET)	PAVEMENT PATCHING 14"			COMMENTS
				TYPE 2	TYPE 3	TYPE 4	
				(SQ YDS)	(SQ YDS)	(SQ YDS)	
5.236	SB	24	12			32	
5.236	NB	120	4			53	
5.279	SB	20	4	9			
5.279	NB	30	4	13			
5.290	NB	20	4	9			
5.309	NB	20	4	9			
5.313	NB	8	12	11			
5.374	SB	15	12		20		
5.374	NB	15	12		20		
5.386	SB	8	12	11			
5.388	SB	8	12	11			
5.419	NB	4	12	5			
5.470	NB	4	12	5			
5.483	SB	6	12	8			
5.483	NB	6	12	8			
5.502	SB	15	12		20		
5.502	NB	15	12		20		
5.525	SB	6	12	8			
5.525	NB	15	12		20		
5.553	NB	6	12	8			
5.571	NB	4	12	5			
5.596	SB	4	12	5			
5.596	NB	4	12	5			
5.608	NB	15	12		20		
5.629	SB	12	12		16		
5.629	NB	12	12		16		
5.638	SB	4	12	5			
5.638	NB	12	12		16		
5.650	SB	4	12	5			
5.650	NB	4	12	5			
5.658	SB	4	12				
5.658	NB	12	12		16		
5.761	SB	4	12	5			
5.761	NB	4	12	5			
5.790	SB	4	12	5			
5.790	NB	4	12	5			
5.813	SB	6	12		8		
5.813	NB	20	12			27	
5.838	NB	30	12			40	
5.838	SB	30	12			40	
5.859	SB	4	12	5			
5.872	SB	6	12	8			
5.872	NB	12	12		16		
5.887	SB	4	12	5			
5.887	NB	4	12	5			
5.990	NB	4	12	5			
5.990	SB	4	12	5			
6.005	NB	4	12	5			
6.005	SB	4	12	5			
6.023	NB	4	12	5			
6.029	NB	4	12	5			
6.041	NB	12	12		16		
6.041	SB	12	12		16		
6.118	NB	12	12		16		
6.118	SB	12	12		16		
6.151	NB	4	12	5			
6.210	SB	4	12	5			
6.230	SB	8	12	11			
6.234	NB	8	12	11			
6.250	NB	4	12	5			
SUB-TOTALS				255	272	192	
GRAND TOTALS				1028	996	5074	

FILE NAME :
#FILE#

USER NAME : #USER#
PLOT SCALE : #SCALE#
PLOT DATE : #DATE#

DESIGNED - ---
DRAWN - ---
CHECKED - ---
DATE - ---

REVISED - ---
REVISED - ---
REVISED - ---
REVISED - ---

STATE OF ILLINOIS
DEPARTMENT OF TRANSPORTATION

SCHEDULES

SCALE: _____ SHEET NO. ___ OF ___ SHEETS STA. _____ TO STA. _____

F.A.P. RTE.	SECTION	COUNTY	TOTAL SHEETS	SHEET NO.
42	(130,11RS-5	CLINTON	26	17
FED. ROAD DIST. NO. - ILLINOIS FED. AID PROJECT			CONTRACT NO. 76E11	

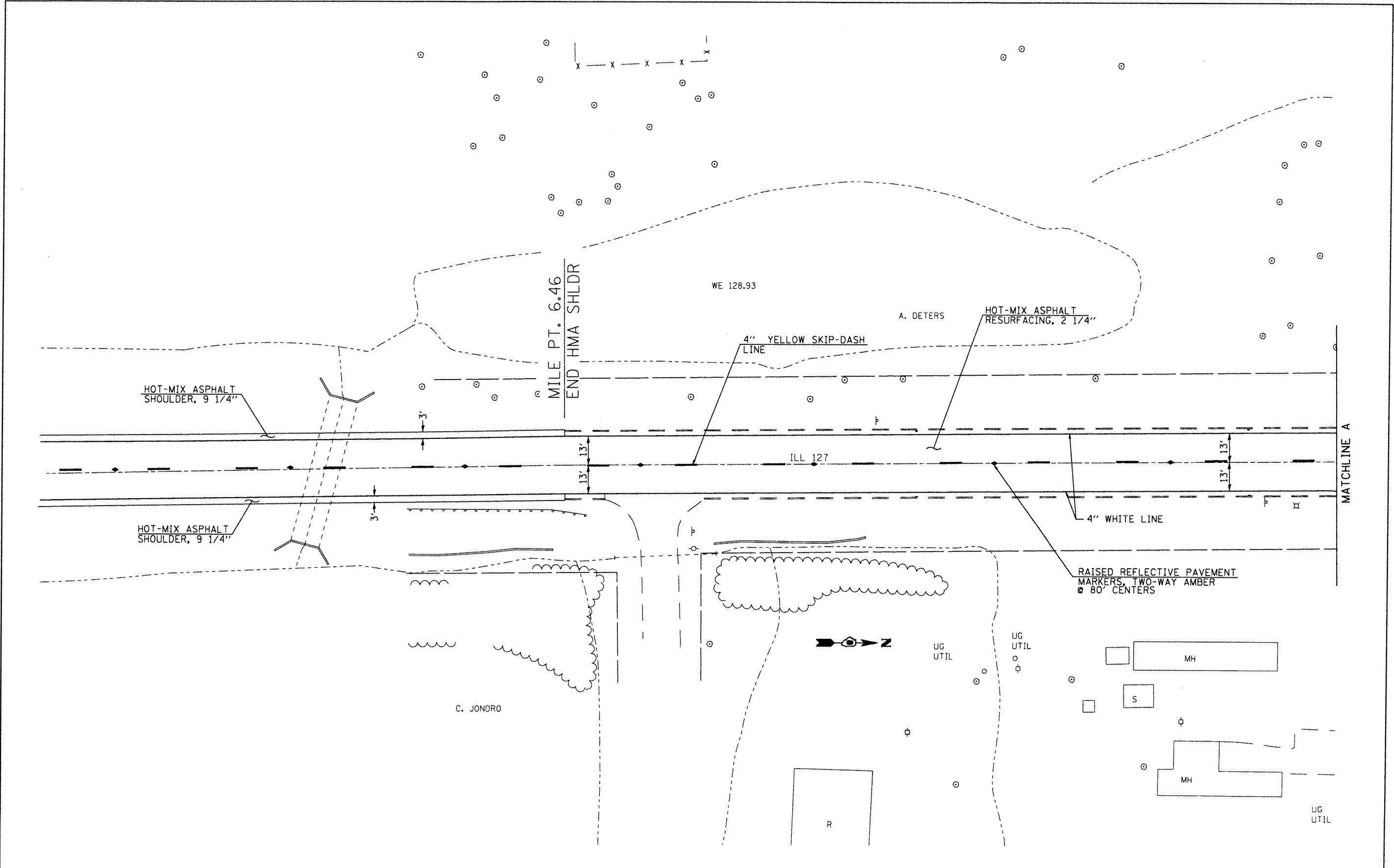

MATCHLINE A

FILE NAME : #FILE#	USER NAME : #USER#	DESIGNED - ---	REVISED - ---
		DRAWN - ---	REVISED - ---
	PLOT SCALE : #SCALE#	CHECKED - ---	REVISED - ---
	PLOT DATE : #DATE#	DATE - ---	REVISED - ---

**STATE OF ILLINOIS
DEPARTMENT OF TRANSPORTATION**

PLAN/PAVEMENT MARKING SHEETS

SCALE: _____ SHEET NO. ___ OF ___ SHEETS STA. _____ TO STA. _____

F.A.P. RTE.	SECTION	COUNTY	TOTAL SHEETS	SHEET NO.
42	(130)RS-5	CLINTON	26	18
CONTRACT NO. 76E11			ILLINOIS FED. AID PROJECT	

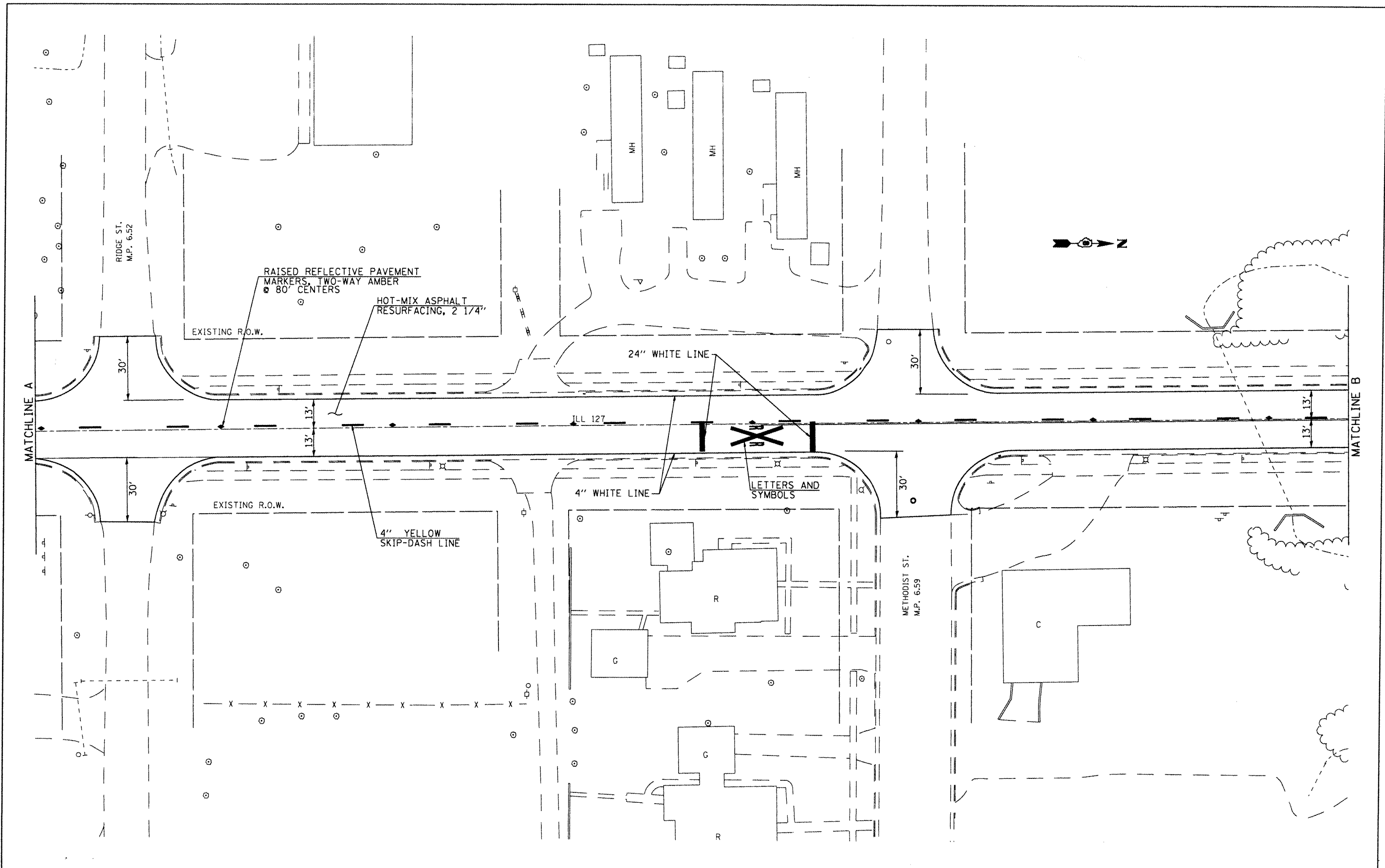

FILE NAME :
#FILE#

USER NAME : #USER#
DESIGNED -
DRAWN -
PLOT SCALE : #SCALE#
CHECKED -
PLOT DATE : #DATE#

DESIGNED -
DRAWN -
CHECKED -
DATE -

REVISED -
REVISED -
REVISED -
REVISED -

**STATE OF ILLINOIS
DEPARTMENT OF TRANSPORTATION**

PLAN/PAVEMENT MARKING SHEETS
SCALE: _____ SHEET NO. ____ OF ____ SHEETS STA. _____ TO STA. _____

RTE.	SECTION	COUNTY	TOTAL SHEETS	SHEET NO.
	(130,1)RS-5	CLINTON	26	19
CONTRACT NO. 76E11				
ILLINOIS FED. AID PROJECT				

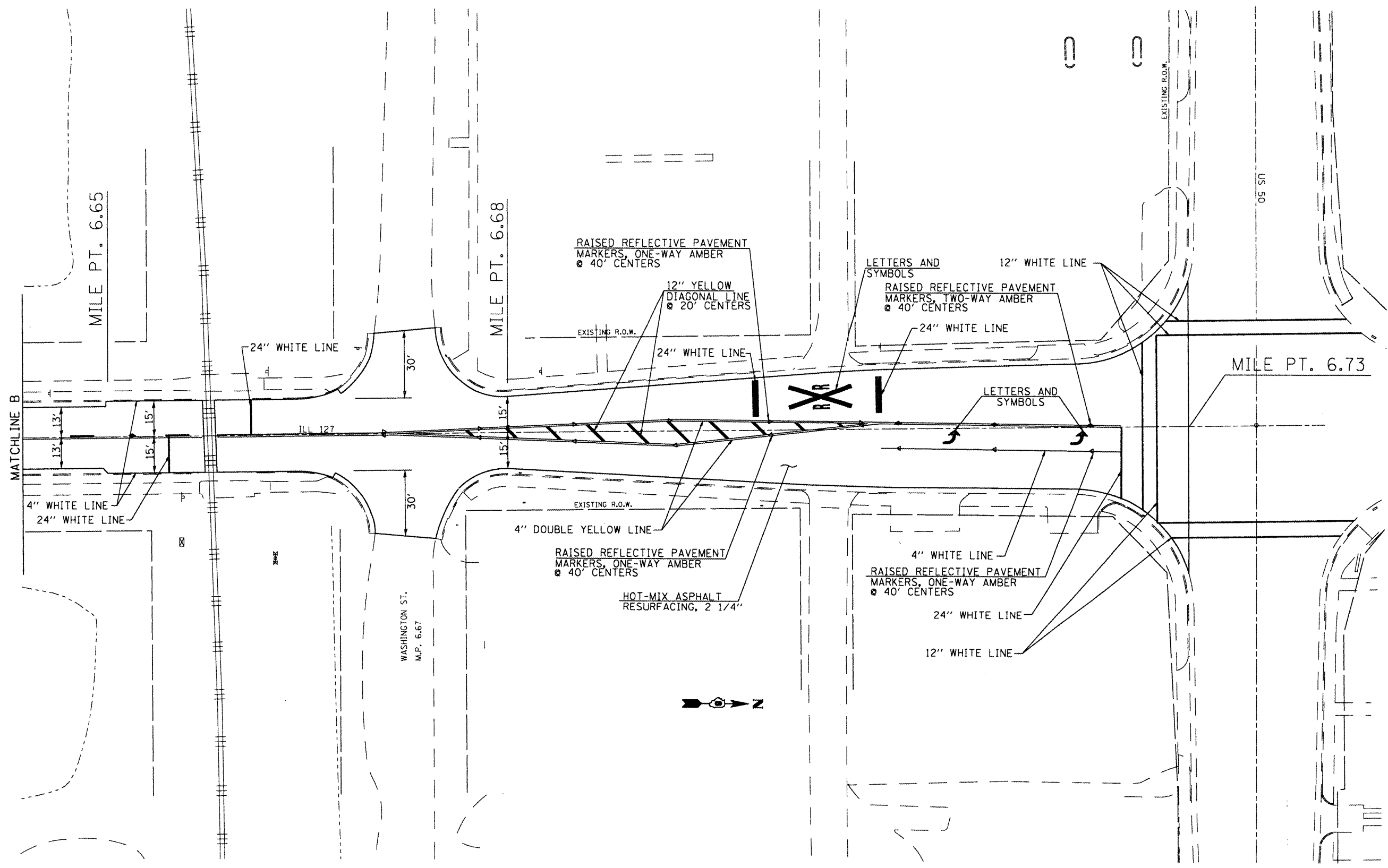

FILE NAME :	USER NAME : #USER#	DESIGNED -	REVISED -
#FILE#		DRAWN -	REVISED -
	PLOT SCALE : #SCALE#	CHECKED -	REVISED -
	PLOT DATE : #DATE#	DATE -	REVISED -

**STATE OF ILLINOIS
DEPARTMENT OF TRANSPORTATION**

PLAN/PAVEMENT MARKING SHEETS

SCALE: _____ SHEET NO. ____ OF ____ SHEETS STA. _____ TO STA. _____

F.A.P. RTE.	SECTION	COUNTY	TOTAL SHEETS	SHEET NO.
42	(130.1)RS-5	CLINTON	26	20
CONTRACT NO. 76E11				
ILLINOIS FED. AID PROJECT				

DETECTOR LOOP REQUIREMENTS AND CALCULATIONS
FOR US 50 AND IL 127, SOUTH JUNCTION-CARLYLE

LOOP	LOOP SIZE(FT)	REQUIRED # OF TURNS	CALCULATED INDUCTANCE MICROHENRIES (μH)	CALCULATED RESISTANCE OHMS (Ω)
NB CCO #1	6X6	5	247	2.08
NB LT TURN LN #2	6X50	3-6-3	830	2.60
NB THRU LN #3	6X50	3-6-3	830	2.60
EB LT TURN LN #4	6X50	3-6-3	804	2.00
EB THRU LN #5	6X50	3-6-3	804	2.00

THE ABOVE VALUES ARE CALCULATED OF COMBINED LOOP AND LEAD-IN INDUCTANCE AND RESISTANCE. ACTUAL MEASURED VALUES SHOULD BE WITHIN +/- 20% OF THESE VALUES.

ELECTRICAL QUANTITIES:

CODE NO.	DESCRIPTION	UNIT	QUANTITY
88600600	DETECTOR LOOP REPLACEMENT	FOOT	810
80300100	LOCATING UNDER GROUND CABLE	FOOT	50

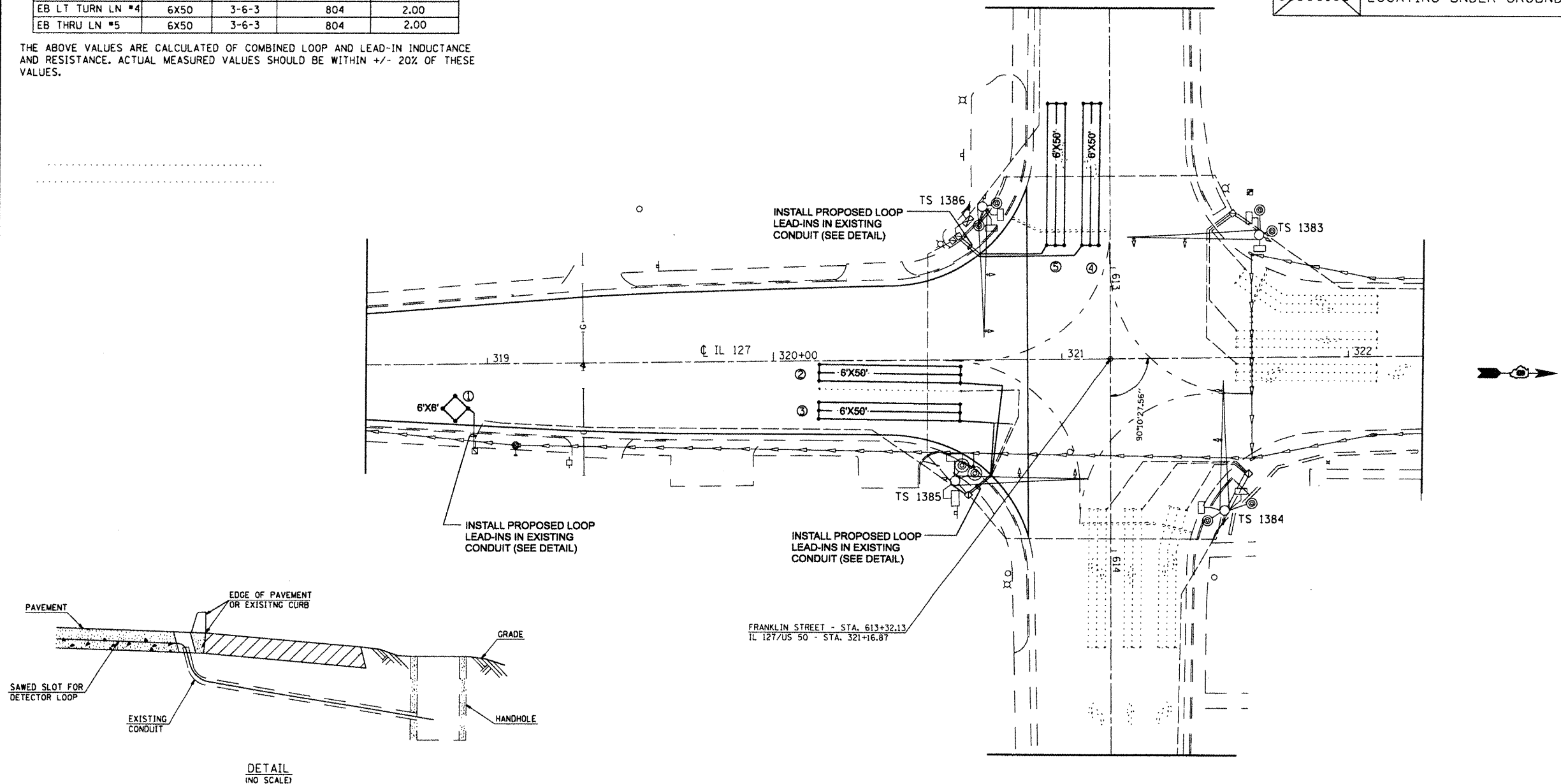

DETAIL
(NO SCALE)

RE-USE EXISTING DETECTOR LOOP LEAD-IN CABLE IN CONDUIT

- 1 LOCATE UNDERGROUND CABLE FROM H.H. TO PAVEMENT.
- 2 DRILL OUT PAVEMENT SEALANT AND CLEAN EXISTING CONDUIT.
- 3 REMOVE EXISTING LEAD-IN CONDUCTORS TO HANDHOLE.
- 4 INSTALL LOOP LEAD-IN CONDUCTORS IN EXISTING CONDUIT.
- 5 SPLICE NEW DETECTOR LOOP LEAD-IN CONDUCTORS TO EXISTING LEAD-IN CABLE IN HANDHOLE.
- 6 FILL HOLE WITH APPROVED SEALER. PREVENT SEALER FROM ENTERING INTO CONDUIT.

THE COST OF THIS WORK SHALL BE INCLUDED IN THE PAY ITEM "DETECTOR LOOP REPLACEMENT", EXCEPT LOCATE UNDERGROUND CABLE IS A SEPARATE PAY ITEM.

ELECTRICAL GENERAL NOTE:

THE EXISTING DETECTOR LOOP CONDUIT FROM PAVEMENT TO THE HANDHOLE WILL BE RE-USED FOR THE REPLACED DETECTOR LOOP. THE CONTRACTOR WILL BE RESPONSIBLE FOR PROTECTING THE EXISTING CONDUIT DURING THE CONSTRUCTION OPERATION. SHOULD ANY DAMAGE OCCURE DUE TO THE CONTRACTOR'S OPERATIONS, REPAIRS WILL BE MADE TO THE SATISFACTION OF THE ENGINEER AND WILL BE DONE AT THE CONTRACTOR'S EXPENSE.

FILE NAME *	USER NAME * #USER#	DESIGNED - ---	REVISED - ---	STATE OF ILLINOIS DEPARTMENT OF TRANSPORTATION	DETECTOR LOOP REPLACEMENT	F.A.P. RTE.	SECTION	COUNTY	TOTAL SHEETS	SHEET NO.
#FILE#	PLOT SCALE * #SCALE#	DRAWN - ---	REVISED - ---			42	(130-1)RS-5	CLINTON	26	21
	PLOT DATE * #DATE#	CHECKED - ---	REVISED - ---			CONTRACT NO. 76E11				
				SCALE: 1/20	SHEET NO. 1 OF 1 SHEET	STA. _____ TO STA. _____		FED. ROAD DIST. NO. - ILLINOIS FED. AID PROJECT		

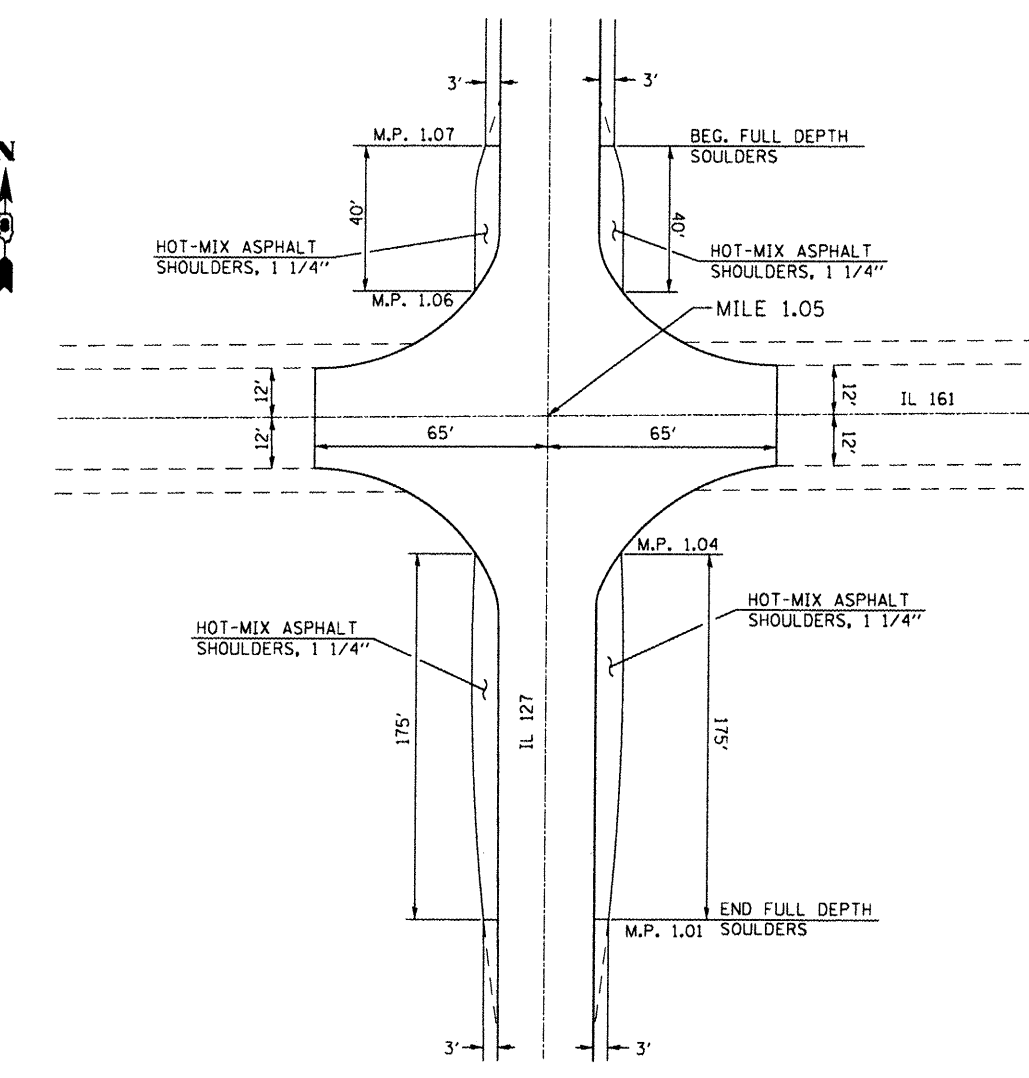

RESURFACING DETAIL
AT IL 161

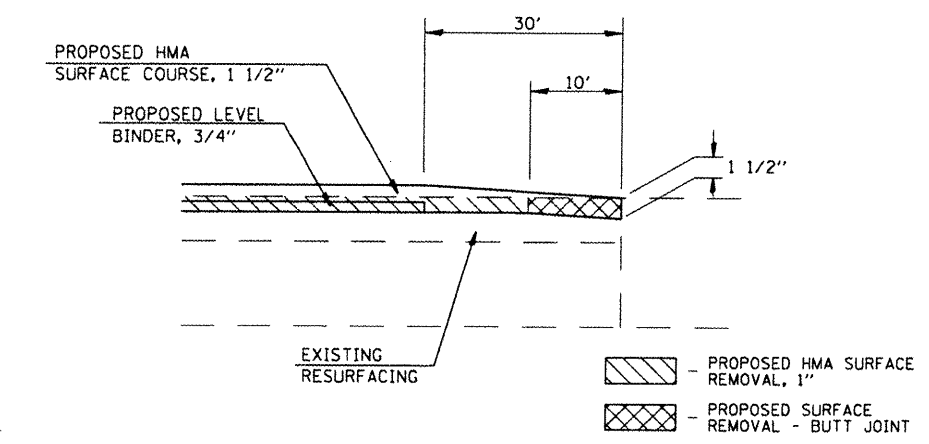

RESURFACING TRANSITION
ON IL 161

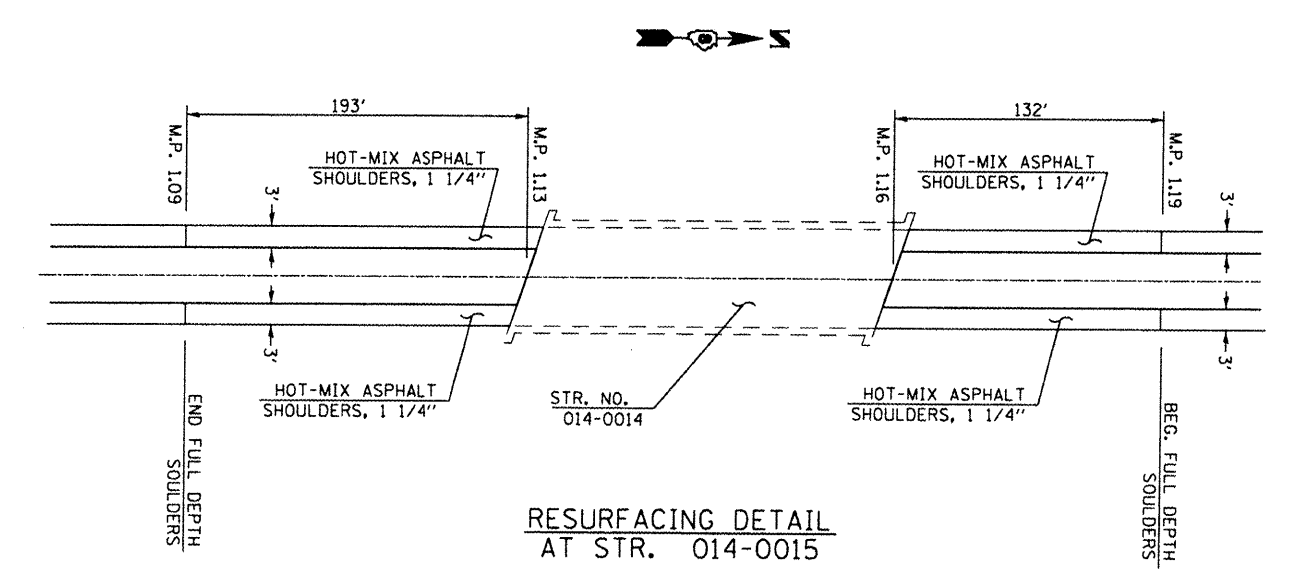

RESURFACING DETAIL
AT STR. 014-0015



FILE NAME	USER NAME	DESIGNED	REVISED	STATE OF ILLINOIS DEPARTMENT OF TRANSPORTATION	DETAILS	F.A.P. SITE	SECTION	COUNTY	TOTAL SHEETS	SHEET NO.						
FILE#	#USER#	DRAWN	REVISED								42	130,1RS-5	CLINTON	26	22	
PLOT SCALE	#SCALE#	CHECKED	REVISED								CONTRACT NO. 76E11					
PLOT DATE	#DATE#	DATE	REVISED								ILLINOIS FED. AID PROJECT					

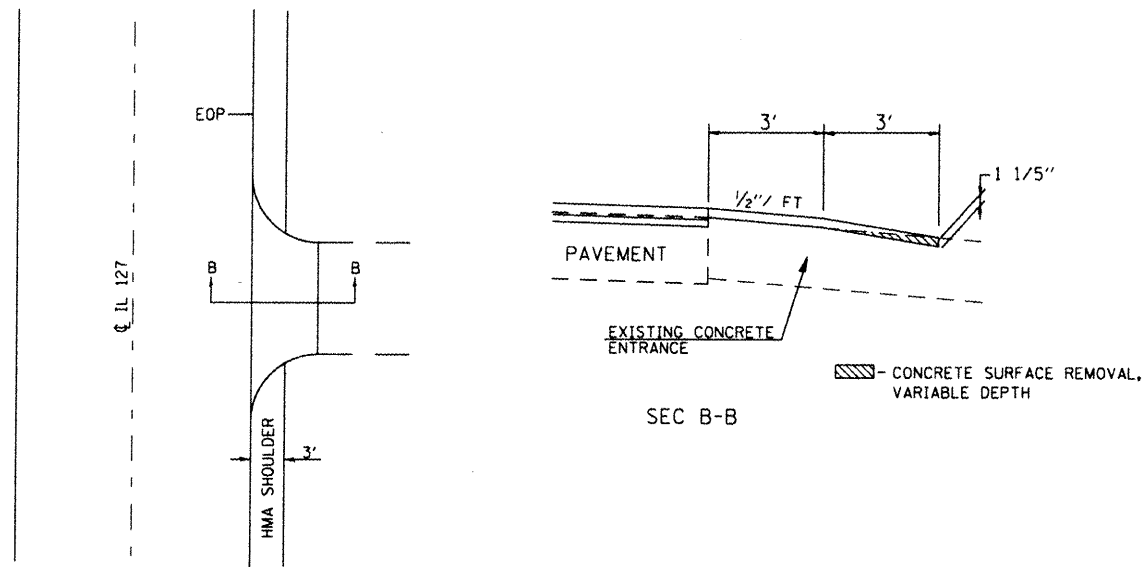

CONCRETE ENTRANCE DETAIL

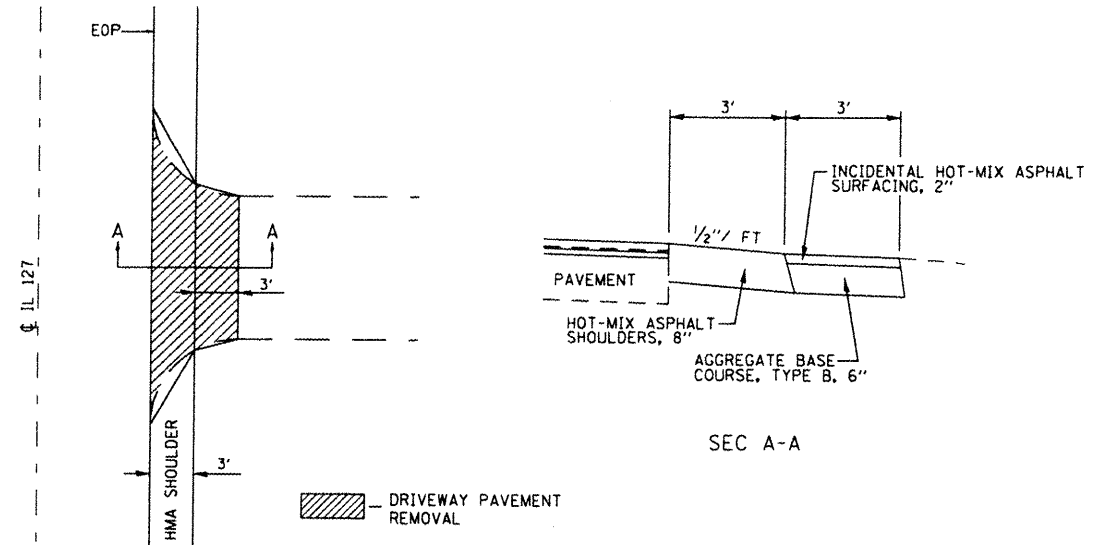

HMA ENTRANCE DETAIL

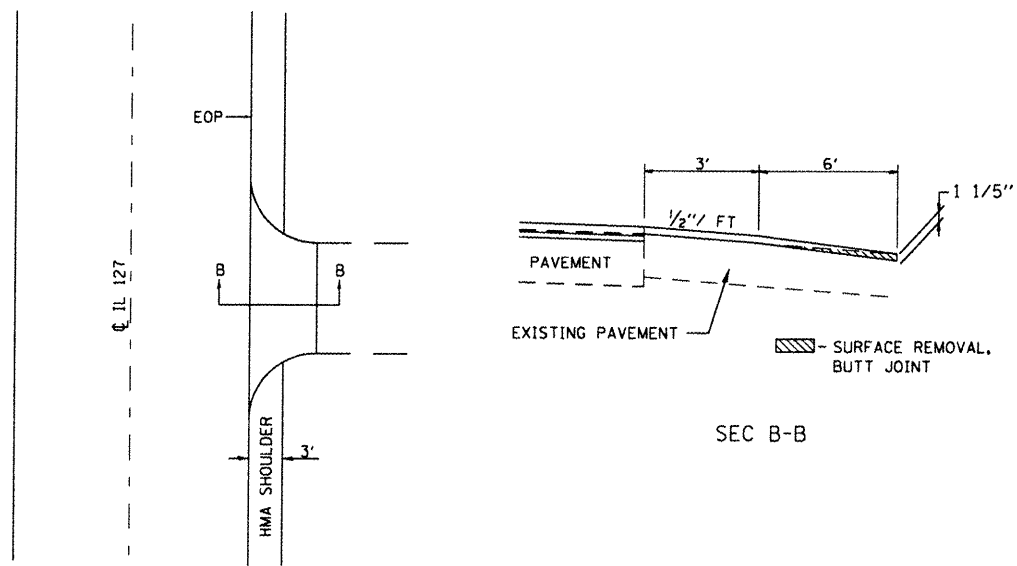

SIDE ROAD DETAIL

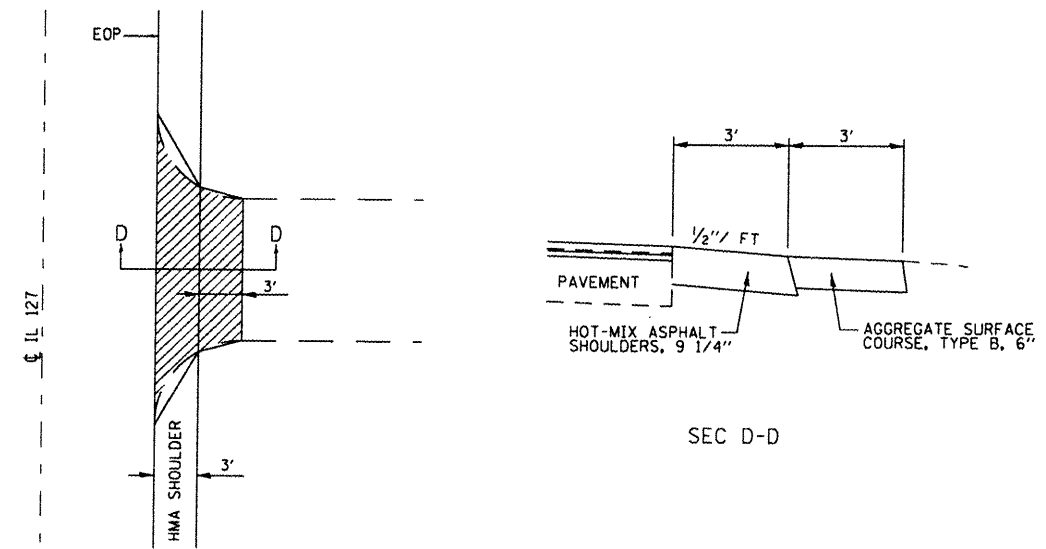

AGGREGATE AND FIELD ENTRANCE DETAIL

FILE NAME :	USER NAME : *USER*	DESIGNED -	REVISD -
*FILE#		DRAWN -	REVISD -
	PLOT SCALE : *SCALE*	CHECKED -	REVISD -
	PLOT DATE : *DATE*	DATE -	REVISD -

STATE OF ILLINOIS
DEPARTMENT OF TRANSPORTATION

ENTRANCE AND
SIDE ROAD DETAILS

F.A.P. RTE.	SECTION	COUNTY	TOTAL SHEETS	SHEET NO.
42	(130,11RS-5	CLINTON	26	23
FED. ROAD DIST. NO. - ILLINOIS FED. AID PROJECT			CONTRACT NO. 76E11	

SCALE: _____ SHEET NO. _____ OF _____ SHEETS STA. _____ TO STA. _____

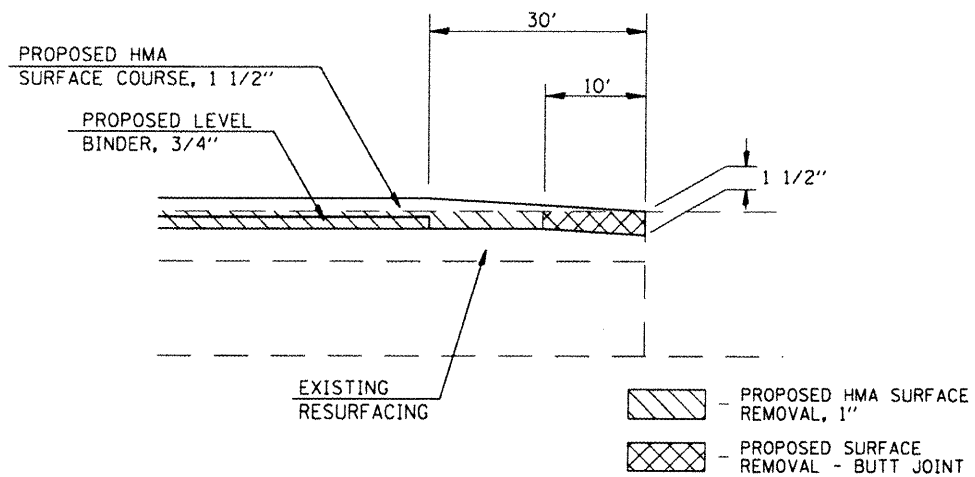

RESURFACING TRANSITION AT BRIDGES,
AND BEGINING OF RESURFACING

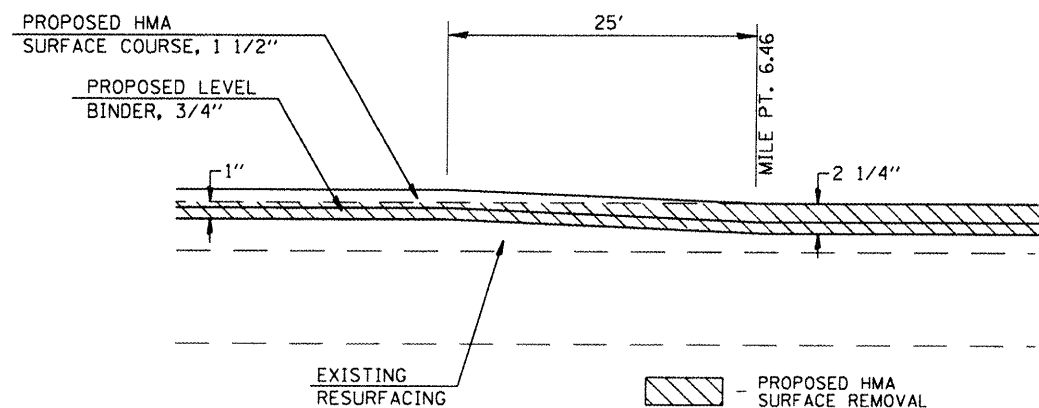

RESURFACING TRANSITION

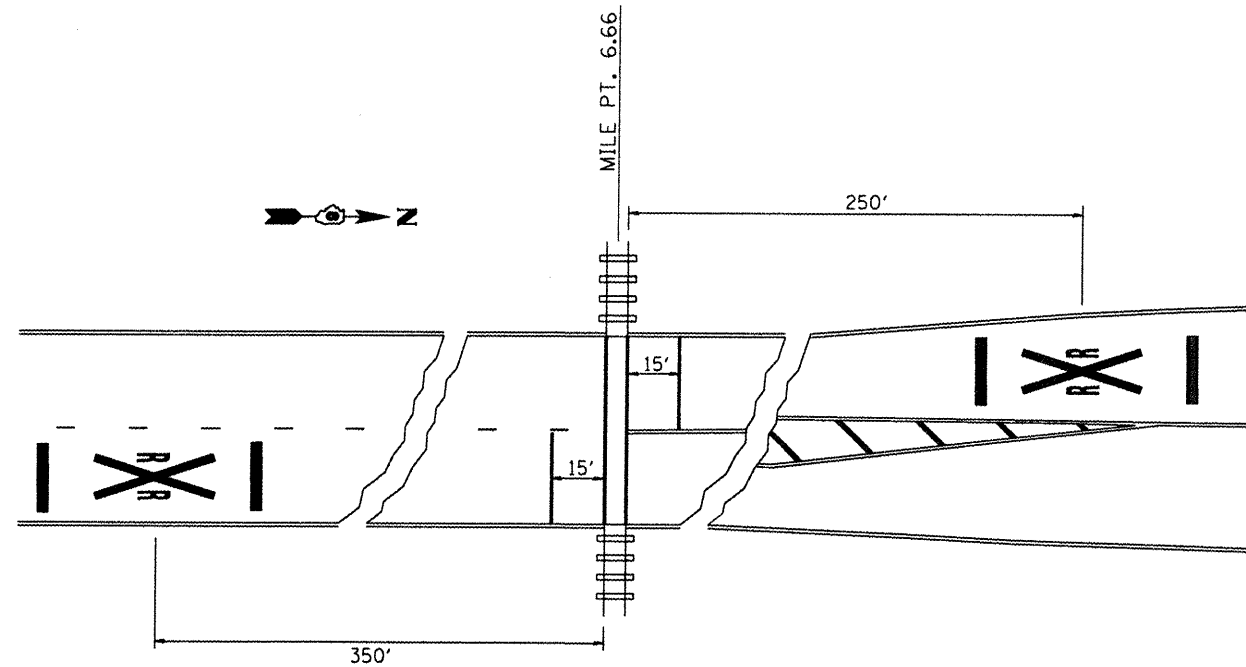

RAILROAD CROSSING
PAVEMENT MARKING

FILE NAME : #FILE#	USER NAME : #USER#	DESIGNED -	REVISED -
		DRAWN -	REVISED -
	PLOT SCALE : #SCALE#	CHECKED -	REVISED -
	PLOT DATE : #DATE#	DATE -	REVISED -

STATE OF ILLINOIS
DEPARTMENT OF TRANSPORTATION

DETAILS

SCALE: _____ SHEET NO. ___ OF ___ SHEETS STA. _____ TO STA. _____

F.A.P. RTE.	SECTION	COUNTY	TOTAL SHEETS	SHEET NO.
42	(130,11RS-5	CLINTON	26	24
FED. ROAD DIST. NO. - ILLINOIS FED. AID PROJECT			CONTRACT NO. 76E11	



STEEL PLATE BEAM GUARDRAIL
REMOVAL = 190 FT

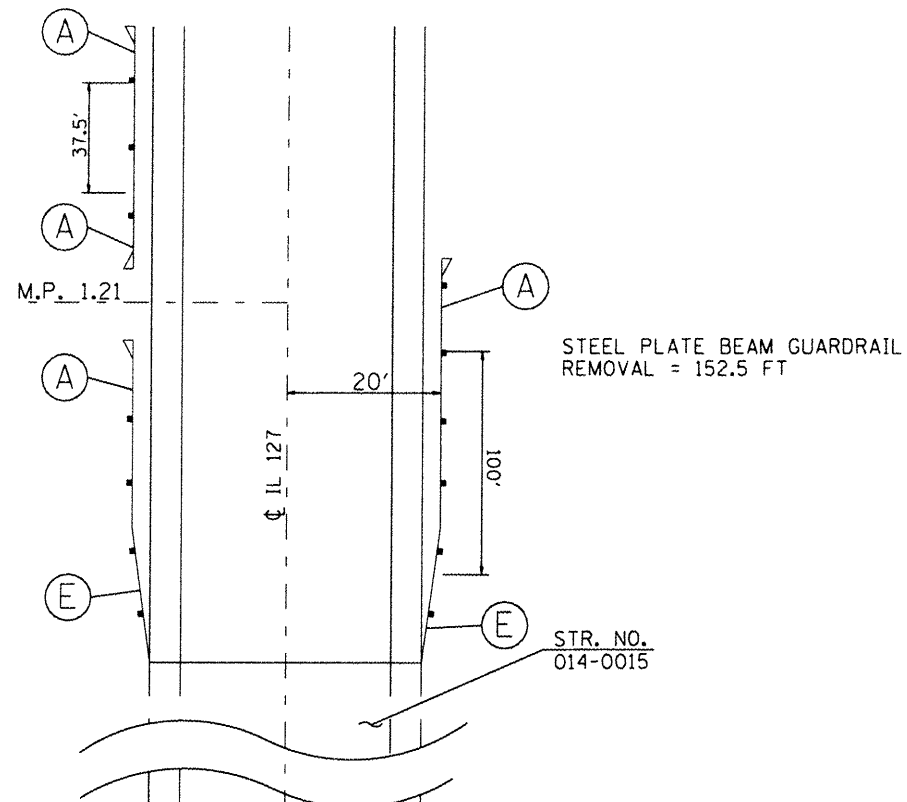

STEEL PLATE BEAM GUARDRAIL
REMOVAL = 152.5 FT

STEEL PLATE BEAM GUARDRAIL
REMOVAL = 477.5 FT

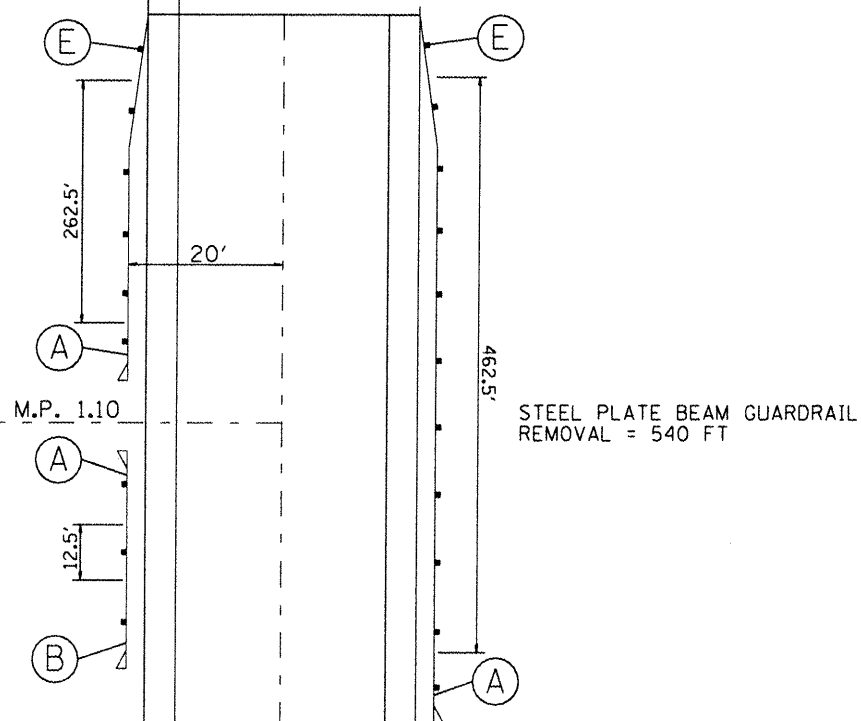

STEEL PLATE BEAM GUARDRAIL
REMOVAL = 540 FT

STEEL PLATE BEAM GUARDRAIL
REMOVAL = 337.5 FT

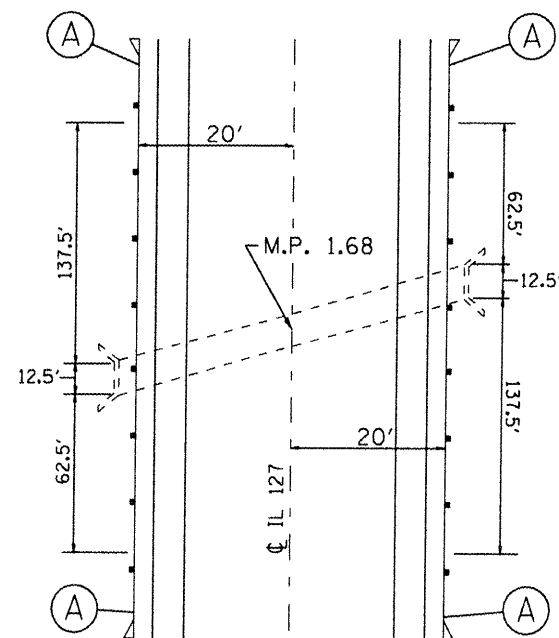

STEEL PLATE BEAM GUARDRAIL
REMOVAL = 337.5 FT

- (A) TRAFFIC BARRIER TERMINAL, TYPE 1 (SPECIAL) TANGENT
- (B) TRAFFIC BARRIER TERMINAL, TYPE 1 (SPECIAL) FLARED
- (C) TRAFFIC BARRIER TERMINAL, TYPE 1B
- (D) TRAFFIC BARRIER TERMINAL, TYPE 2
- (E) TRAFFIC BARRIER TERMINAL, TYPE 6
- (F) TRAFFIC BARRIER TERMINAL, TYPE 6A

NOT TO SCALE

FILE NAME	USER NAME	DESIGNED	REVISED	STATE OF ILLINOIS DEPARTMENT OF TRANSPORTATION	GUARDRAIL DETAILS (PLAN VIEW)	F.A.P. RTE.	SECTION	COUNTY	TOTAL SHEETS	SHEET NO.	
#FILE#	#USER#	DRAWN	REVISED			42	(130,1)RS-5	CLINTON	26	25	
PLOT SCALE	#SCALE#	CHECKED	REVISED			CONTRACT NO. 76E11					
PLOT DATE	#DATE#	DATE	REVISED			FED. ROAD DIST. NO. ILLINOIS FED. AID PROJECT					
SCALE: _____					SHEET NO. _____ OF _____ SHEETS STA. _____ TO STA. _____						

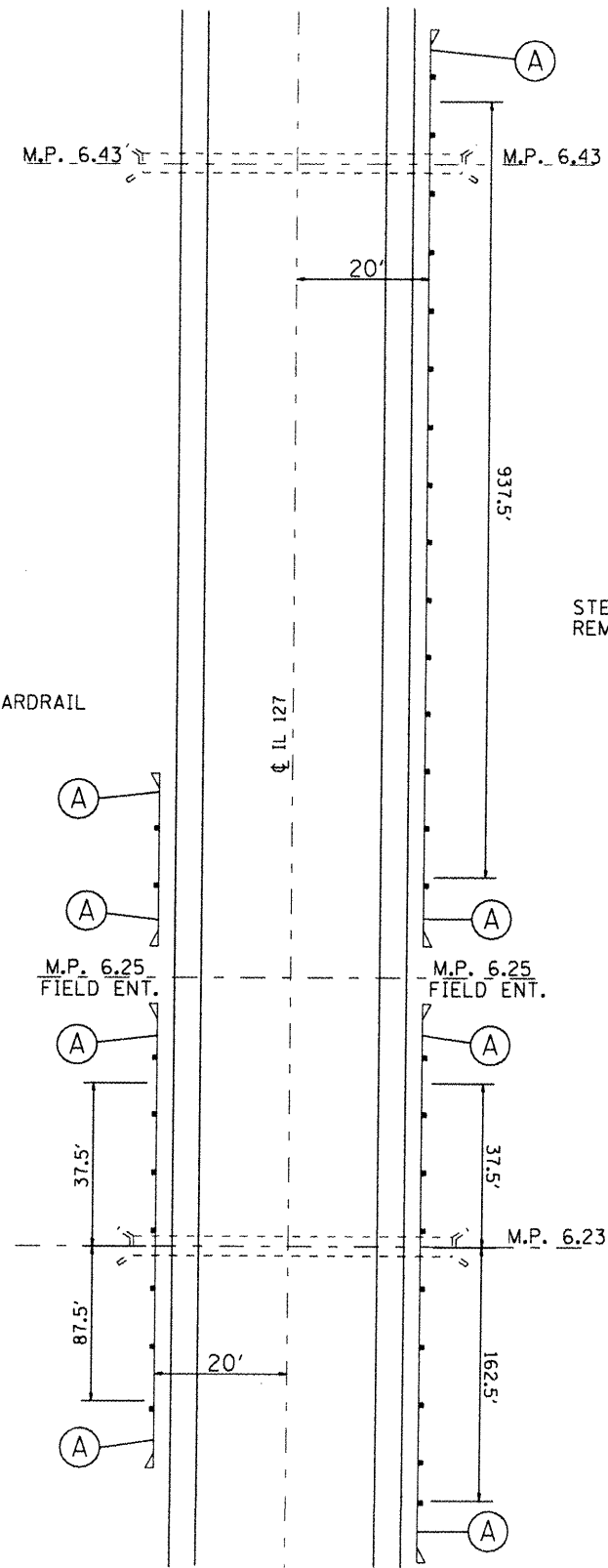
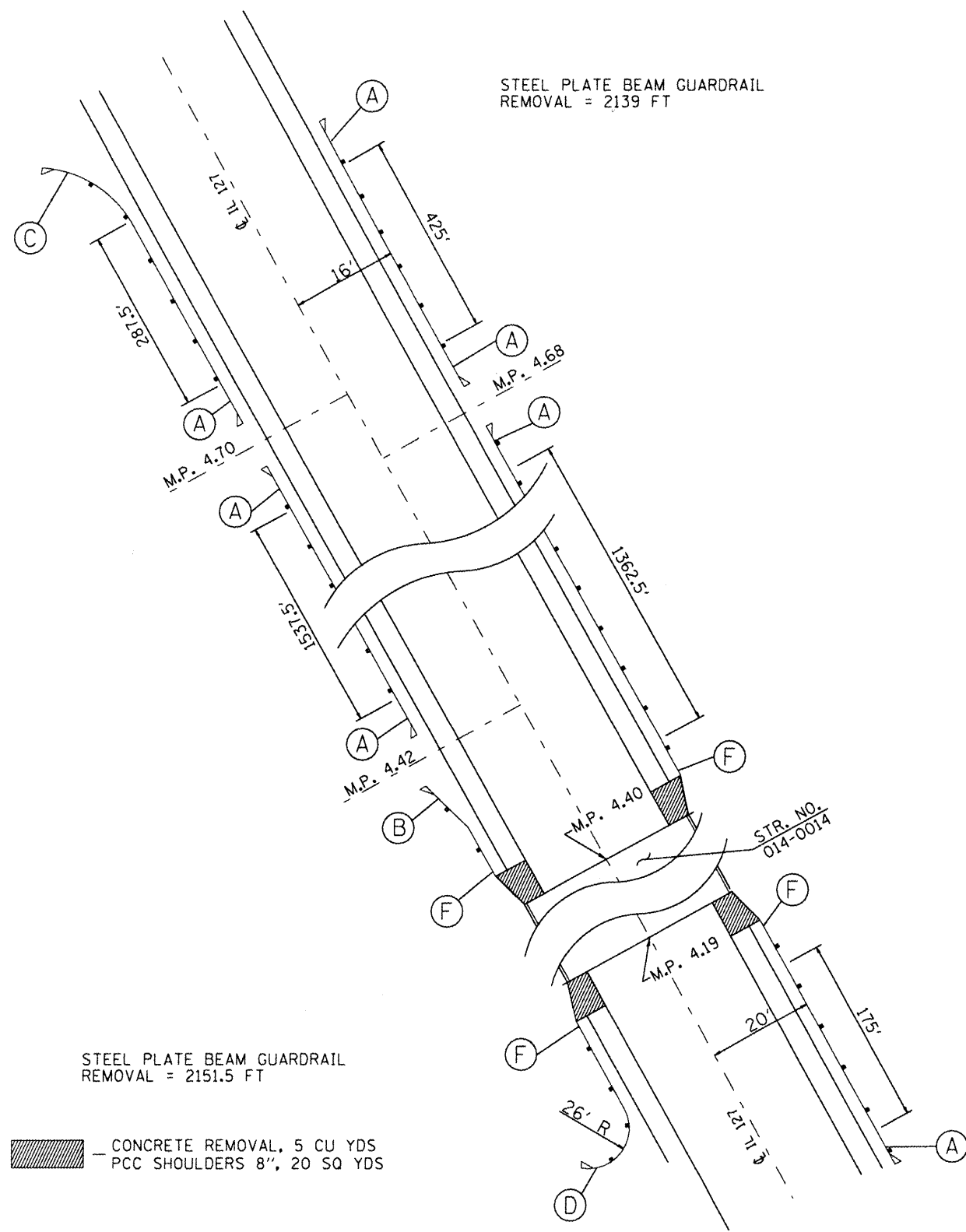

- Ⓐ TRAFFIC BARRIER TERMINAL, TYPE 1 (SPECIAL) TANGENT
- Ⓑ TRAFFIC BARRIER TERMINAL, TYPE 1 (SPECIAL) FLARED
- Ⓒ TRAFFIC BARRIER TERMINAL, TYPE 1B
- Ⓓ TRAFFIC BARRIER TERMINAL, TYPE 2
- Ⓔ TRAFFIC BARRIER TERMINAL, TYPE 6
- Ⓕ TRAFFIC BARRIER TERMINAL, TYPE 6A

NOT TO SCALE

FILE NAME	USER NAME	DESIGNED	REVISED	STATE OF ILLINOIS DEPARTMENT OF TRANSPORTATION	GUARDRAIL DETAILS (PLAN VIEW)	F.A.P. RTE.	SECTION	COUNTY	TOTAL SHEETS	SHEET NO.	
*FILE#		DRAWN	REVISED			42	(130,11RS-5)	CLINTON	26	26	
		CHECKED	REVISED			CONTRACT NO. 76E11					
		DATE	REVISED			FED. ROAD DIST. NO. ILLINOIS FED. AID PROJECT					