

PLAN VIEW

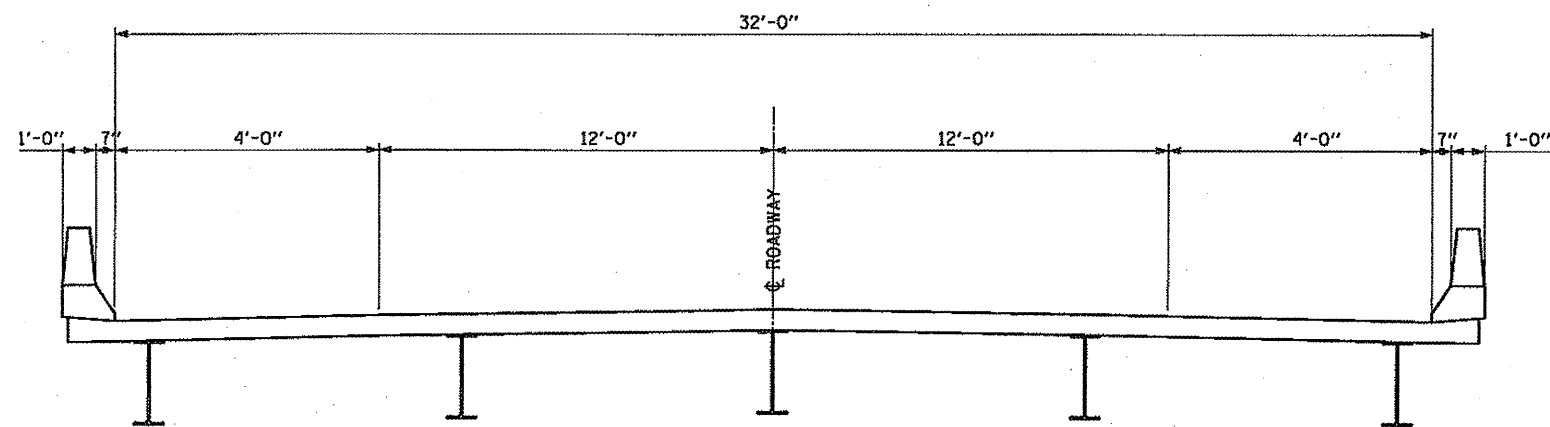

TYPICAL SECTION THRU BRIDGE [A-A]

TOTAL BILL OF MATERIAL

ITEM	UNIT	TOTAL
CONCRETE SEALER	SQ FT	13,242

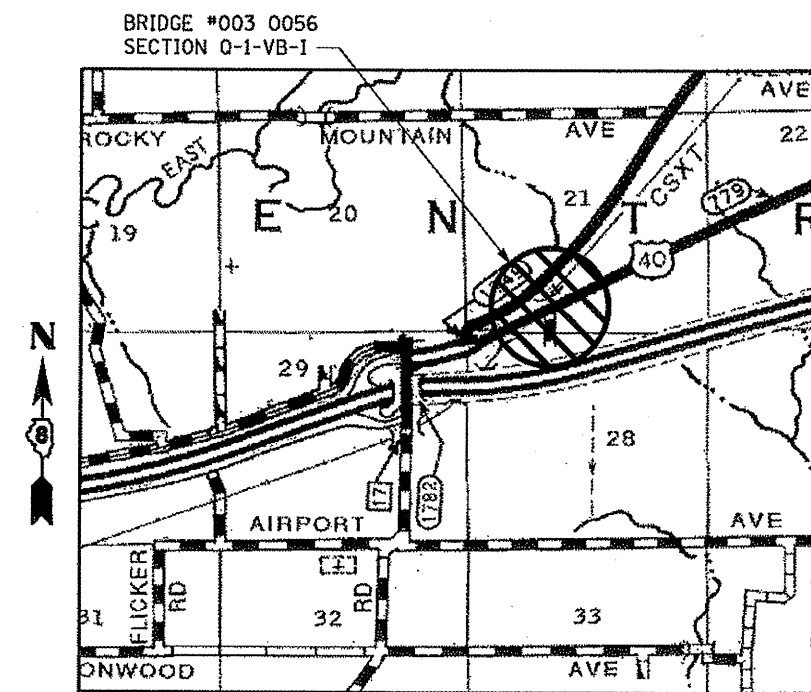

FILE NAME =	USER NAME = #USER#	DESIGNED - JAH	REVISED -
P:\10E2166-1\Design\Plans\15 - SN803-899.dgn		DRAWN - JAH	REVISED -
	PLOT SCALE = 40.0000 "/ IN.	CHECKED - WJS	REVISED -
	PLOT DATE = 12/10/2010	DATE - 11-2-10	REVISED -

STATE OF ILLINOIS
DEPARTMENT OF TRANSPORTATION

BRIDGE #003-0056 F.A. ROUTE OR-12D (US RTE. 40) OVER
CONRAIL RAILROAD PLAN & SECTION VIEWS

SCALE: SHEET NO. OF SHEETS STA. TO STA.

F.A.P. RTE.	SECTION	COUNTY	TOTAL SHEETS	SHEET NO.
VAR		BOND	19	15
CONTRACT NO. 76E41				
FED. ROAD DIST. NO. ILLINOIS FED. AID PROJECT				
DISTRICT 8 BRIDGE DECK 2011-1				