

STATE OF ILLINOIS
DEPARTMENT OF TRANSPORTATION

GENERAL NOTES

A Concrete Sealer shall be applied to the surfaces of the deck and parapets. See Special Provisions for Bridge Deck Concrete Sealer.

Existing pavement markings shall be temporarily covered prior to application of the deck surface treatment, to prevent the material from being applied over the markings. The temporary covering shall be removed after the application of the deck surface treatment and prior to opening to traffic. Cost included with Concrete Sealer.

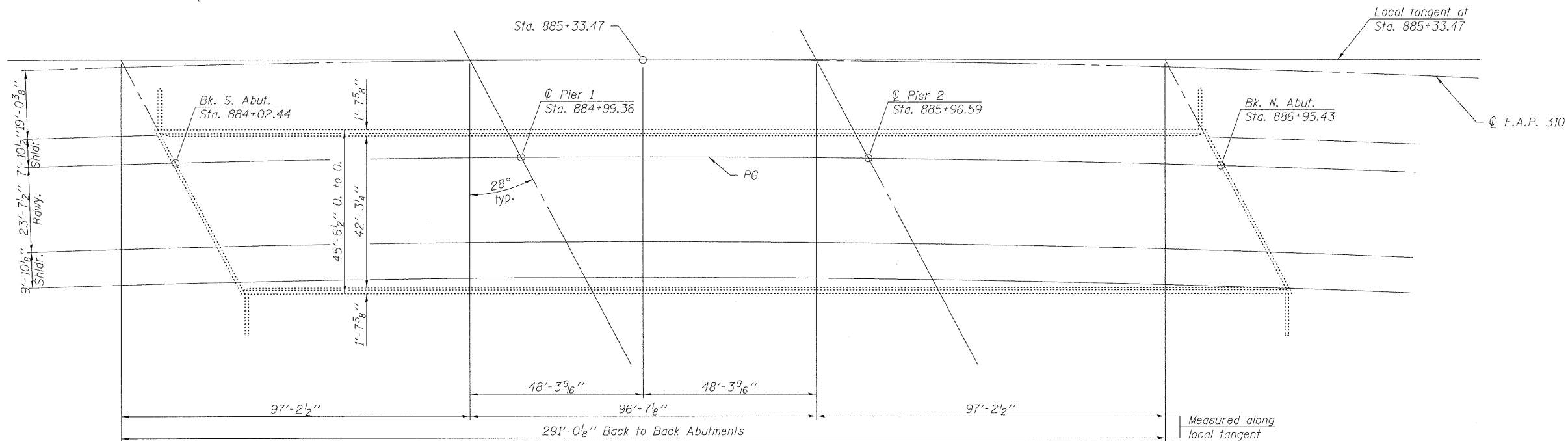

PLAN

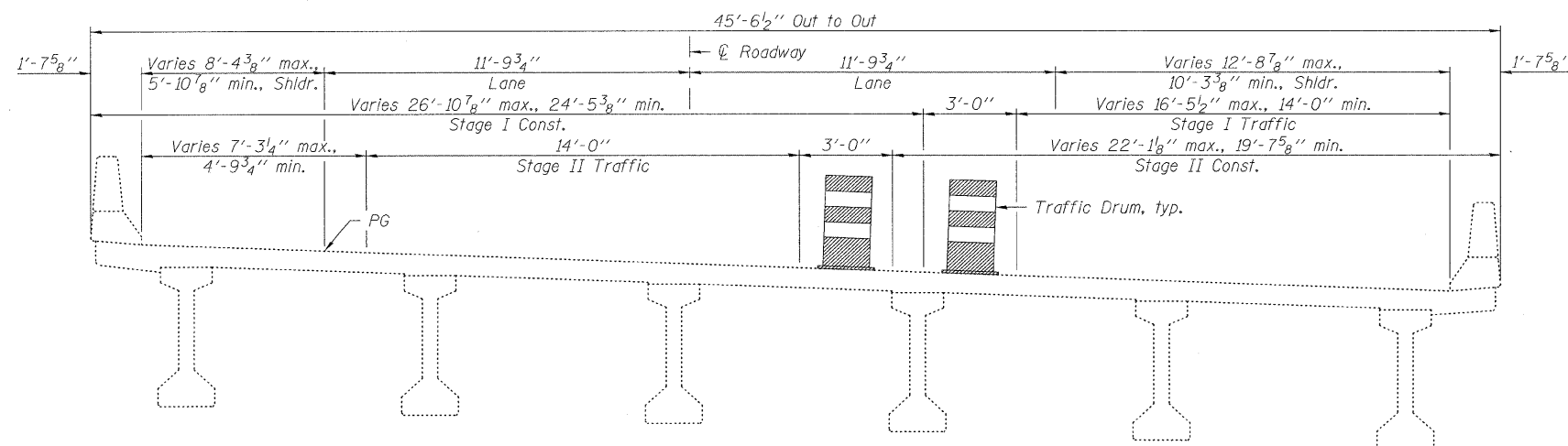

CROSS SECTION
(Looking North)

| | |
|----------|-----|
| DESIGNED | --- |
| CHECKED | --- |
| DRAWN | EML |
| CHECKED | KAK |

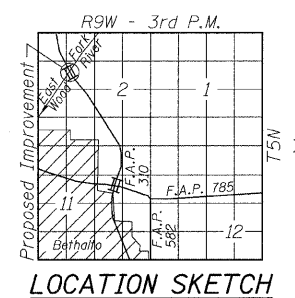

LOCATION SKETCH

Note:
All stations and dimensions are converted from Metric units. Original Metric
structure station = 26+985.000.

TOTAL BILL OF MATERIAL

| ITEM | UNIT | SUPER | SUB | TOTAL |
|-----------------|---------|--------|-----|--------|
| Concrete Sealer | Sq. Ft. | 14,431 | | 14,431 |

GENERAL PLAN
ILLINOIS ROUTE 255 OVER
EAST FORK WOODRIVER CREEK
F.A.P. RTE. 310
SEC. DIST. 8 BRIDGE DECK 2011-2
MADISON COUNTY
STATION 885+33.47
STRUCTURE NO. 060-0295 (N.B.)

| | | | | | |
|---------------------------|-------------|---------------------------|---------|--------------|-----------|
| SHEET NO. 1 1 SHEETS | F.A.P. RTE. | SECTION | COUNTY | TOTAL SHEETS | SHEET NO. |
| | 310 | DIST 8 BRIDGE DECK 2011-2 | MADISON | 29 | 26 |
| CONTRACT NO. 76E42 | | | | | |
| ILLINOIS FED. AID PROJECT | | | | | |

HORNER & SHIFRIN, INC.
ENGINEERS