

STATE OF ILLINOIS
DEPARTMENT OF TRANSPORTATION

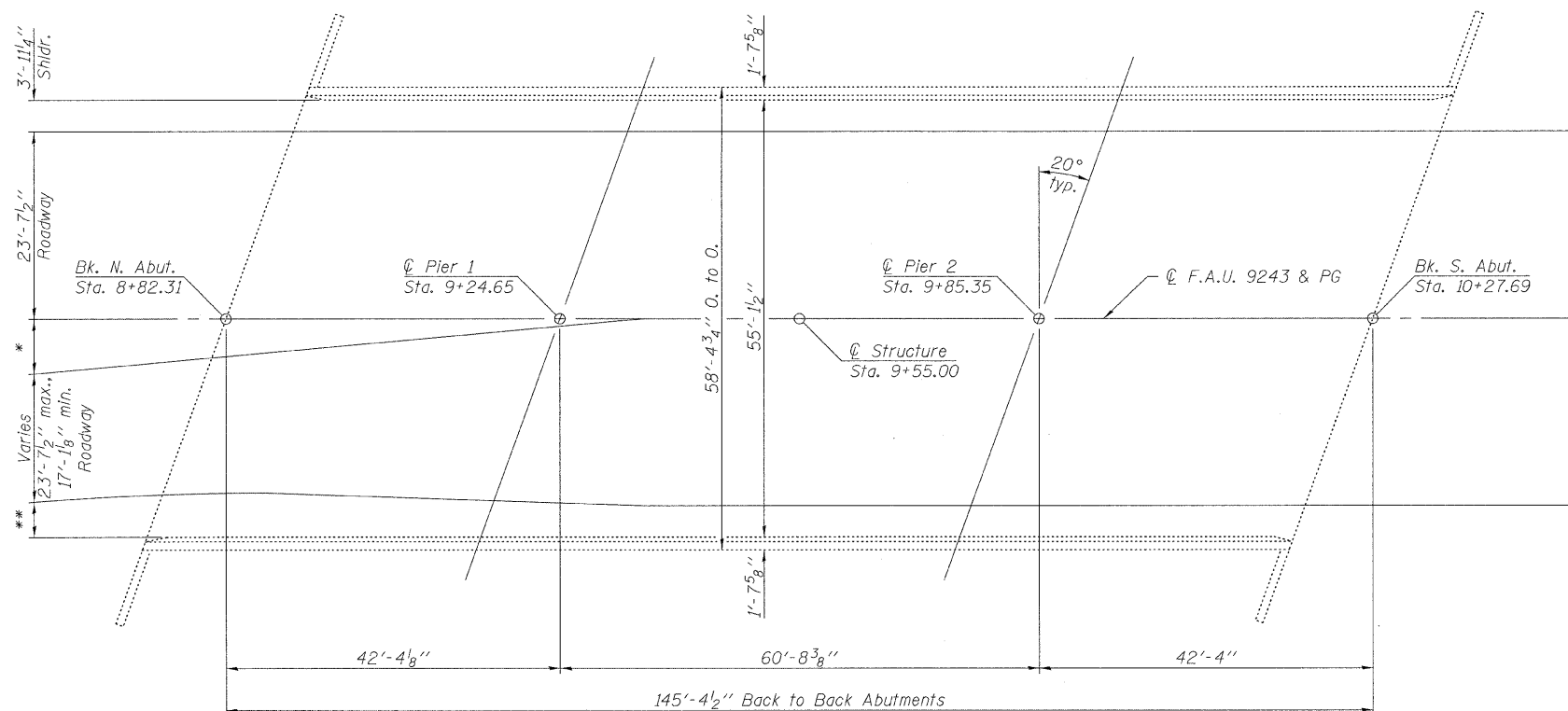

PLAN

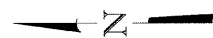
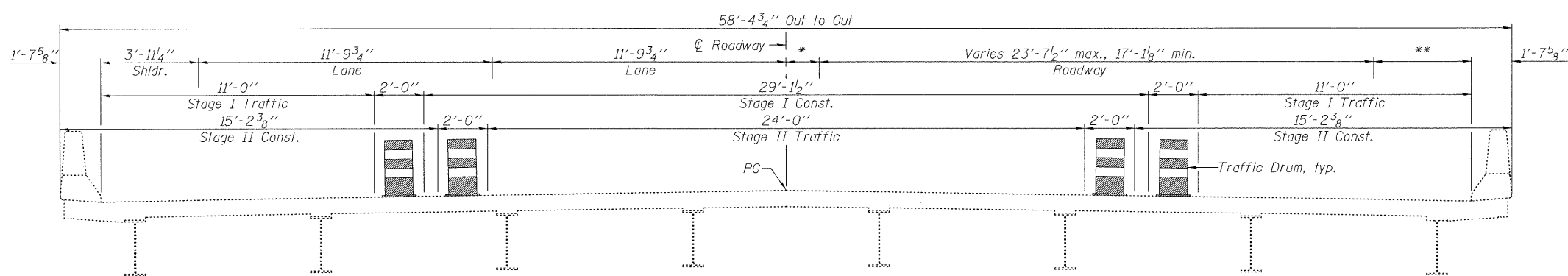

CROSS SECTION
(Looking South)

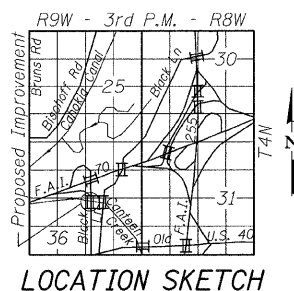

LOCATION SKETCH

GENERAL NOTES

A Concrete Sealer shall be applied to the surfaces of the deck and parapets. See Special Provisions for Bridge Deck Concrete Sealer.

Existing pavement markings shall be temporarily covered prior to application of the deck surface treatment, to prevent the material from being applied over the markings. The temporary covering shall be removed after the application of the deck surface treatment and prior to opening to traffic. Cost included with Concrete Sealer.

- * Varies 4'-10⁷/₈" max., to 0'-0" min.
- ** Varies 5'-6³/₄" max., 3'-11¹/₄" min. Shoulder.

Notes:
All stations and dimensions are converted from Metric units. Original Metric \O structure station = 0+291.084.

TOTAL BILL OF MATERIAL

ITEM	UNIT	SUPER	SUB	TOTAL
Concrete Sealer	Sq. Ft.	9,087		9,087

DESIGNED	---
CHECKED	---
DRAWN	KAK
CHECKED	EML

GENERAL PLAN
BLACK LANE OVER CANTEN CREEK
F.A.U. RTE. 9243
SEC. DIST. 8 BRIDGE DECK 2011-3
MADISON COUNTY
STATION 9+55.00
STRUCTURE NO. 060-0327



SHEET NO. 1 1 SHEETS	F.A. RTE.	SECTION	COUNTY	TOTAL SHEETS	SHEET NO.
	VAR.	DIST 8 BRIDGE DECK 2011-3	MADISON	29	18
			CONTRACT NO. 76E43		
ILLINOIS FED. AID PROJECT					