

L = 1.00  
 E = 2,590.95  
 E = 111.18'  
 T.R. =  
 S.E. RUN = 5800+38.35  
 P.C. STA. = 5826+29.34  
 P.T. STA. = 5826+29.34

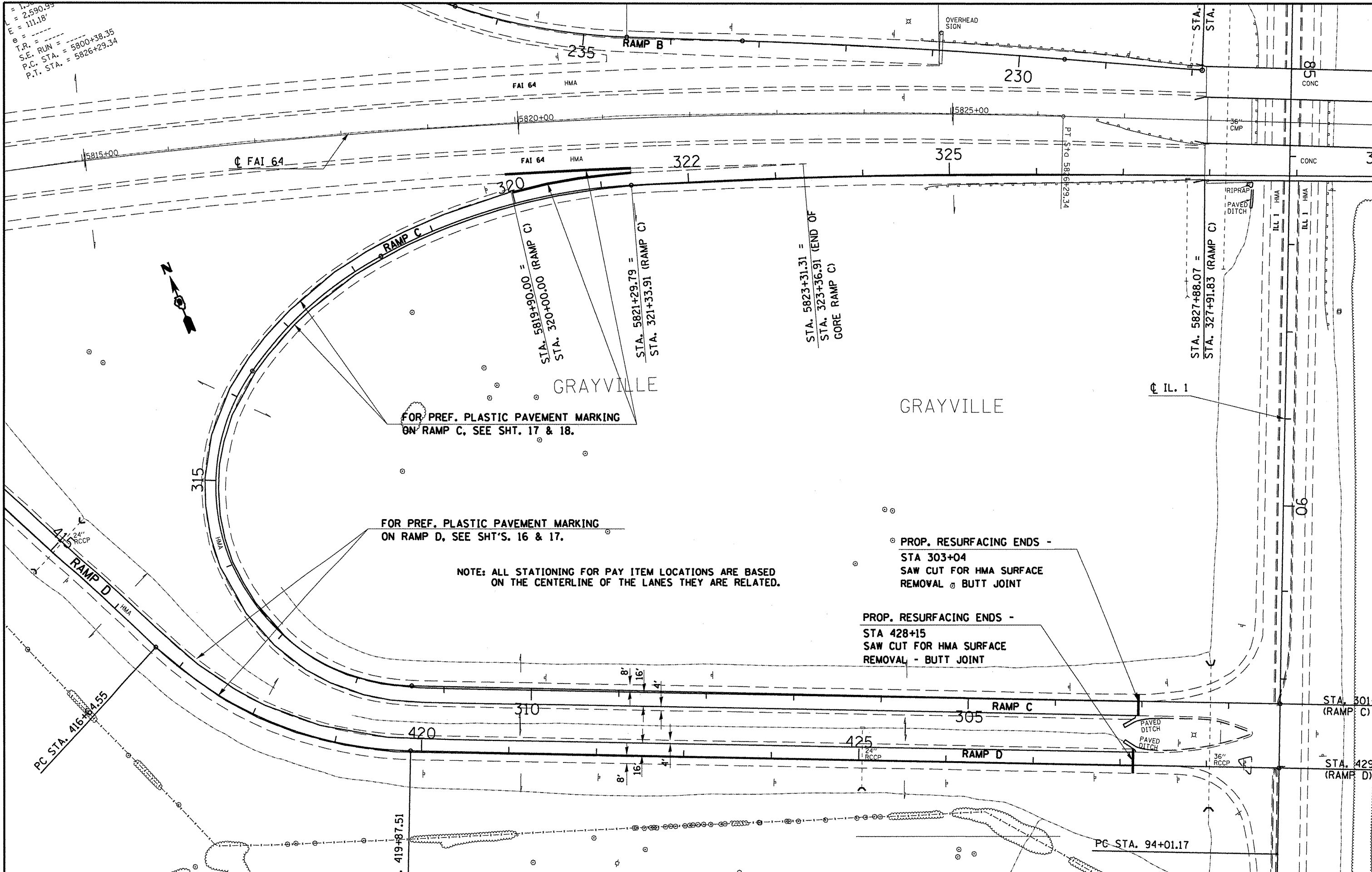

FOR PREF. PLASTIC PAVEMENT MARKING ON RAMP C, SEE SHT. 17 & 18.

FOR PREF. PLASTIC PAVEMENT MARKING ON RAMP D, SEE SHT'S. 16 & 17.

NOTE: ALL STATIONING FOR PAY ITEM LOCATIONS ARE BASED ON THE CENTERLINE OF THE LANES THEY ARE RELATED.

PROP. RESURFACING ENDS -  
 STA 303+04  
 SAW CUT FOR HMA SURFACE REMOVAL @ BUTT JOINT

PROP. RESURFACING ENDS -  
 STA 428+15  
 SAW CUT FOR HMA SURFACE REMOVAL - BUTT JOINT

FILE NAME =	USER NAME = mcoordkr	DESIGNED -	REVISED -	<b>STATE OF ILLINOIS DEPARTMENT OF TRANSPORTATION</b>	<b>FAI 64 PLAN LAYOUT RAMPS C AND D</b>	F.A.I. RTE.	SECTION	COUNTY	TOTAL SHEETS	SHEET NO.	
c:\pwwork\pwwork\mcoordkr\d0186975\sh	plan.dgn	DRAWN -	REVISED -			64	(97-2)RS-2	WHITE	34	24	
PLOT SCALE = 100.0000' / IN.		CHECKED -	REVISED -			CONTRACT NO. 78211					
PLOT DATE = 11/3/2010		DATE -	REVISED -			ILLINOIS FED. AID PROJECT					