

PROJECT BEGINS
STA. 80+50.00

PROPERTY OWNERS:
MARK J. WROBLEWSKI &
DEBORAH A. WROBLEWSKI

PROP. CURVE CURVE2
PI STA. = 82+32.43
Δ = 11° 09' 42" (RT)
D = 18° 47' 08"
R = 305.00'
T = 29.80'
L = 59.42'
E = 1.45'
e = 4.0%
T.R. = 28'
S.E. RUN = 55'
P.C. STA = 82+02.63
P.T. STA = 82+62.04

STA. 83+50.00 (WELCH ROAD) =
STA. 14+41.13 (SCOUT CAMP ROAD)

PROPERTY OWNER:
WILLIAM C. DZIERZYNSKI

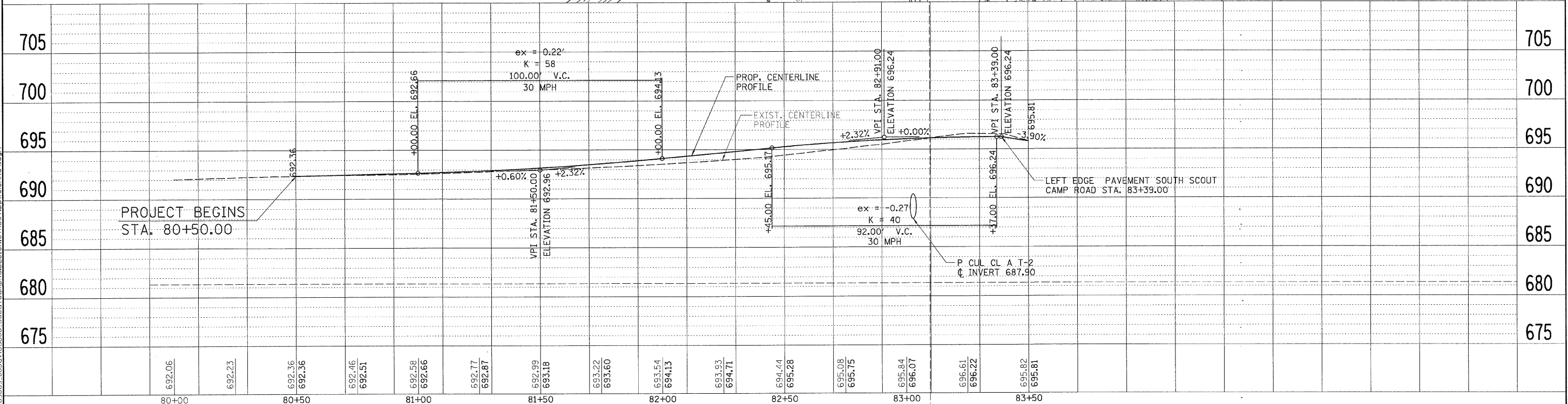
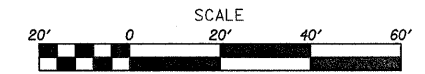

REV.	DATE	BY	REMARKS

**JO DAVIESS COUNTY
SCOUT CAMP ROAD AND
WELCH ROAD IMPROVEMENTS**



**WELCH ROAD
PLAN & PROFILE**

F.A.S. 73
FED. AID PROJECT -
FED. ROAD DIST. NO. 7 ILLINOIS
STA. 80+00.00 - STA. 83+50.00

SECTION	COUNTY	TOTAL SHEETS	SHEET NO.
09-00133-00-BR	JO DAVIESS	48	14
STA. 80+00.00 - STA. 83+50.00			
WHA PROJECT: 1169D09		DATE: XX/XX/XXXX	

FILE = S:\PROJECTS\2009\1169D09_JoDavlessCo_ScoutCampRoad\DESIGN\STRUCT\pWelchRd.dgn