

STATE OF ILLINOIS
DEPARTMENT OF TRANSPORTATION
DIVISION OF HIGHWAYS
PLANS FOR PROPOSED
HIGHWAY BRIDGE PROGRAM

SECTIONS 06-02148-00-BR & 06-18148-00-BR
IROQUOIS COUNTY
ASH GROVE – MILFORD ROAD DISTRICTS
PROJECT NO. BROS-0075(137)

T.R. 228
C-93-051-10

ROUTE NO.	SECTION	COUNTY	TOTAL SHEETS	SHEET NO.
T.R. 228	**	IROQUOIS	1	19
ROAD DISTRICT		ILLINOIS	ASH GROVE/MILFORD	
**06-02148-00-BR			CONTRACT NO. 87446	
06-18148-00-BR				

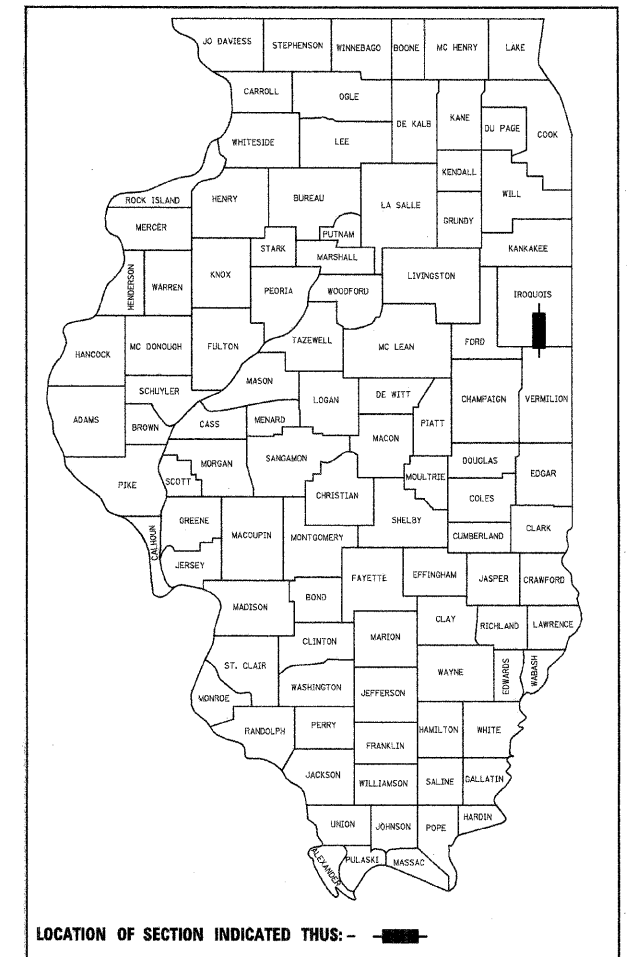

INDEX OF SHEETS

SHEET NO.	TITLE
1.	COVER SHEET
2.	SUMMARY OF QUANTITIES, GENERAL NOTES & TYPICAL SECTIONS
3.	PLAN AND PROFILE SHEET
4.-13.	BRIDGE PLANS
14.-19.	STATION CROSS SECTIONS

STANDARDS

000001-06	STANDARD SYMBOLS, ABBREVIATIONS AND PATTERNS
280001-05	TEMPORARY EROSION CONTROL SYSTEMS
515001-03	NAME PLATE FOR BRIDGES
635006-03	REFLECTOR AND TERMINAL MARKER PLACEMENT
701901-01	TRAFFIC CONTROL DEVICES
720011-01	METAL POSTS FOR SIGNS, MARKERS AND DELINEATORS
728001-01	TELESCOPING STEEL SIGN SUPPORT
729001-01	APPLICATIONS OF TYPES A & B METAL POSTS (FOR SIGNS AND MARKERS)
BLR 21-8	TYPICAL APPLICATION OF TRAFFIC CONTROL DEVICES FOR CONSTRUCTION ON RURAL LOCAL HIGHWAYS

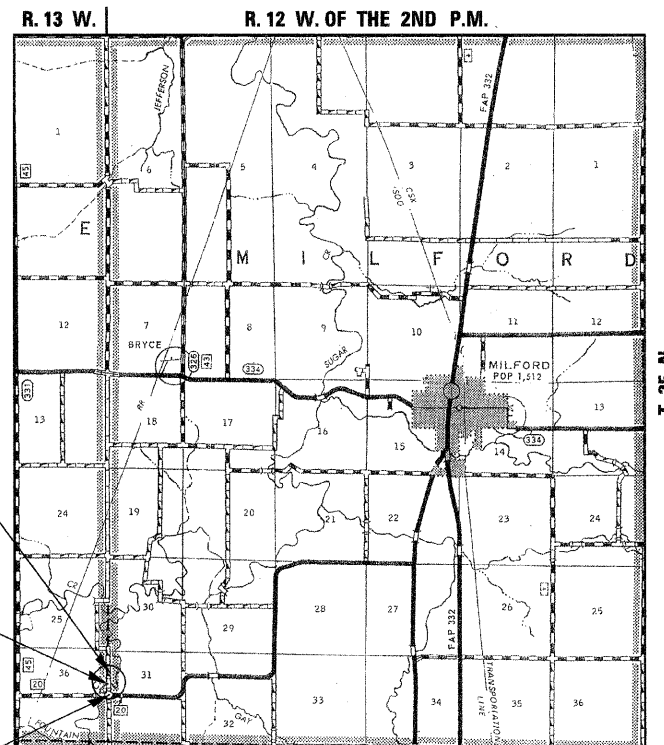

LOCATION PLAN

GROSS LENGTH OF SECTION = 890.00 FEET = 0.169 MILES
 NET LENGTH OF SECTION = 890.00 FEET = 0.169 MILES

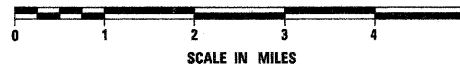

IMPROVEMENT ENDS
STA. 19 + 00

STA. 14 + 52.50 - SPECIAL BRIDGE DESIGN
 PRECAST PRESTRESSED CONCRETE DECK
 BEAM BRIDGE (21" DEPTH), THREE SPANS @
 56'-0"; 169'-9 3/4" BK.-BK. ABUTS.; 30'-0" ROADWAY;
 15° SKEW LT.
 EXISTING S.N. 038-4733
 PROPOSED S.N. 038-4751

IMPROVEMENT BEGINS
STA. 10 + 10

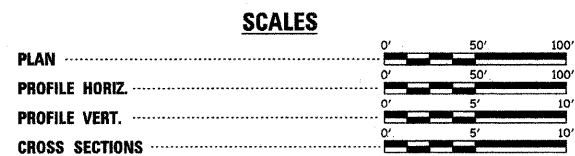

Gary J. Cartwright 12-2-10
 ILLINOIS PROFESSIONAL NO. 43498
 EXPIRES 11-30-11

CONTRACT NO. **87446**

4440 ASH GROVE
 SPRINGFIELD, IL. 62711
 (217) 793-3600
 www.fehr-graham.com

FEHR-GRAHAM & ASSOCIATES LLC
 ENGINEERING AND SCIENCE CONSULTANTS
 PEORIA, IL. ROCKFORD, IL. ROCKFORD, IL. SPRINGFIELD, IL.

CLASSIFICATION: LOCAL ROAD (NON-URBAN)
DESIGN VOLUME: UNDER 250 ADT
CURRENT ADT: 35 (2010)
DESIGN SPEED: 30 MPH

TOLL FREE JOINT UTILITY LOCATING
 INFORMATION FOR EXCAVATORS (J.U.L.I.E.)
 TELEPHONE NUMBER 1-800-892-0123

PASSED	12-20	20 10
	<i>Jay D. Binder</i>	ROAD DISTRICT COMMISSIONER
PASSED	12/13	20 10
	<i>Norman Anderson</i>	ROAD DISTRICT COMMISSIONER
APPROVED	12-21	20 10
	<i>[Signature]</i>	COUNTY ENGINEER
PASSED		20
	<i>[Signature]</i>	DISTRICT THREE IMPLEMENTATION ENGINEER
RELEASED FOR BID BASED ON LIMITED REVIEW		20
	<i>[Signature]</i>	DEPUTY DIRECTOR OF HIGHWAYS, REGION TWO ENGINEER
STATE OF ILLINOIS DEPARTMENT OF TRANSPORTATION		