

STATE OF ILLINOIS  
 DEPARTMENT OF TRANSPORTATION  
 DIVISION OF HIGHWAYS  
 PLANS FOR PROPOSED  
 FEDERAL-AID HIGHWAY BRIDGE PROGRAM

LAWRENCE COUNTY  
 SECTION 09-08134-00-BR  
 PETTY ROAD DISTRICT  
 STRUCTURE NO. 051-3298  
 PROJECT NO. BROS-101(036)  
 JOB NO. C-97-002-11  
 TR 10 A

INDEX OF SHEETS

- 1 COVER SHEET
- 2 PLAN & PROFILE
- 3-4 CROSS SECTIONS
- 5-13 BRIDGE PLANS & BORINGS

- STANDARDS:
- 280001-06 - EROSION CONTROL
  - 515001-03 - NAME PLATE
  - 701901-01 - TRAFFIC
  - BLR 21-8 - TRAFFIC
  - BLR 22-6 - TRAFFIC

SCALES

- PLAN 1 INCH = 50 FEET
- PROFILE HORZ. 1 INCH = 50 FEET
- PROFILE VERT. 1 INCH = 10 FEET
- CROSS SECTION 1 INCH = 5 FEET

SUMMARY OF QUANTITIES

QUANTITY	UNIT	ITEMS	CODE NO.
44	UNITS	TREE REMOVAL, (OVER 15 UNITS DIAMETER)	20100210
722	CU YD	EARTH EXCAVATION	20200100
25	CU YD	CHANNEL EXCAVATION	20300100
1248	CU YD	FURNISHED EXCAVATION	20400800
0.5	ACRE	SEEDING, CLASS 2 (SPECIAL)	<b>X2501000</b>
36	FOOT	TEMPORARY DITCH CHECKS	28000305
60	FOOT	PERIMETER EROSION BARRIER	28000400
181	TON	STONE DUMPED RIPRAP, CLASS A4	28100807
33	TON	<b>AGGREGATE DITCH (SPECIAL)</b>	<b>Y2830495</b>
1	EACH	REMOVAL OF EXISTING STRUCTURES	50100100
26.8	CU YD	CONCRETE STRUCTURES	50300225
2.6	CU YD	CONCRETE ENCASEMENT	50300280
1680	SQ FT	PRECAST PRESTRESSED CONCRETE DECK BEAMS (27" DEPTH)	50400505
2730	POUND	REINFORCEMENT BARS	50800105
116	FOOT	STEEL RAILING, TYPE S1	50900205 *
490	FOOT	FURNISHING STEEL PILES HP 12X53	51201600
490	FOOT	DRIVING PILES	51202305
1	EACH	TEST PILE STEEL HP 12X53	51203600
1	EACH	NAME PLATES	51500100
74	FOOT	PIPE CULVERTS, CLASS D, TYPE 1 15"	542D0220
1	L SUM	MOBILIZATION	67100100
1	L SUM	TRAFFIC CONTROL AND PROTECTION (SPECIAL)	<b>X1010216</b>
<b>344</b>	TON	AGGREGATE SURFACE COURSE, TYPE B	<b>40200800</b>

\* Specialty Items

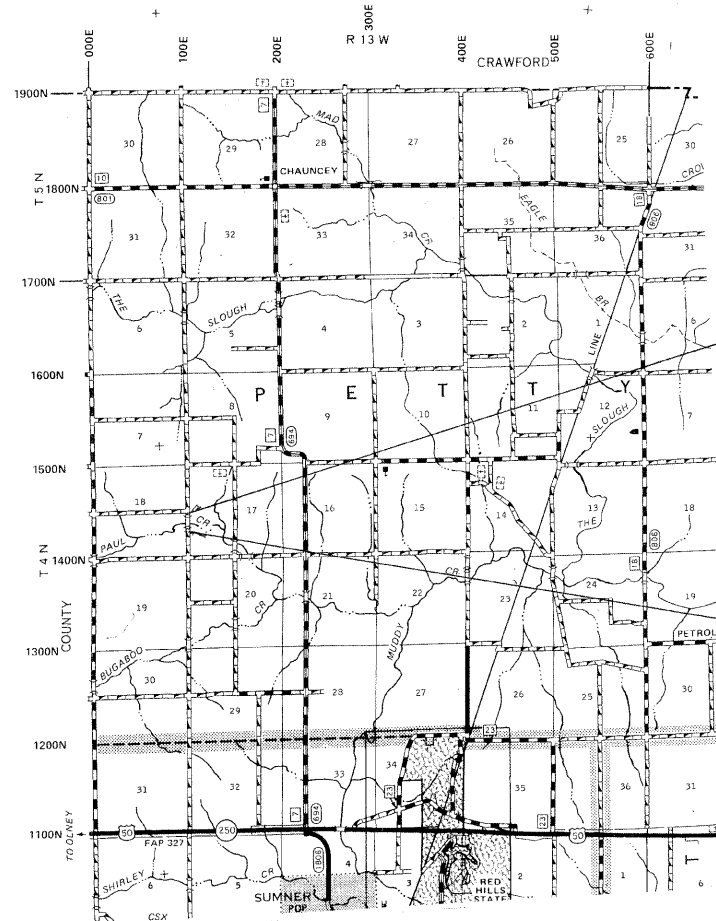

SECTION 09-08134-00-BR  
 ENDS STA. 8+00

STA. 5+00 - SPECIAL BRIDGE DESIGN  
 PROPOSED PRECAST PRESTRESSED CONCRETE DECK  
 BEAM BRIDGE. 1 SPAN @ 60', 28' RDWY., SKEW = 0'  
 EXISTING STR. NO. 051-3041  
 PROPOSED STR. NO. 051-3298

SECTION 09-08134-00-BR  
 BEGINS STA. 2+00

FUNCTIONAL CLASS: RURAL LOCAL ROAD  
 ADT = 75  
 DESIGN SPEED = 30 MPH

CONTRACT NO. 95638

LOCATION MAP

APPROXIMATE SCALE: 1 INCH = 1 MILE  
 NET LENGTH = 600 L.F. = 0.114 MILES

TOLL FREE JOINT UTILITY LOCATING  
 INFORMATION FOR EXCAVATORS (J.U.L.I.E.)  
 TELEPHONE NO. 1-800-892-0123

PROFESSIONAL DESIGN FIRM #184-000832

*John A. Stone*  
 ILLINOIS REGISTERED PROFESSIONAL ENGINEER # 55012  
 LICENSE EXPIRES NOVEMBER 30, 2011  
 11/17/2010

ILLINOIS DEPARTMENT OF TRANSPORTATION	
APPROVED: <u>11-17</u> , 2010	
LAWRENCE COUNTY ENGINEER	
PASSED: <u>11-17</u> , 2010	
DISTRICT SEVEN ENGINEER OF LOCAL ROADS & STREETS	
RELEASING FOR BID BASED ON LIMITED REVIEW <u>11-17</u> , 2010	
DEPUTY DIRECTOR OF HIGHWAYS, REGION FOUR ENGINEER	