

STATE OF ILLINOIS  
DEPARTMENT OF TRANSPORTATION  
DIVISION OF HIGHWAYS

SECTION	COUNTY	TOTAL SHEETS	SHEET NO.
10-00091-00-BT	EFFINGHAM	17	1
CONTRACT NO. 95646			

Joint Utility Locating Information for Excavators  
JULIE 1-800-892-0123

PLANS FOR PROPOSED  
TRANSPORTATION, COMMUNITY, AND SYSTEM PRESERVATION PROJECT  
PEDESTRIAN TRUSS BRIDGE AND APPROACH WALKWAYS

SECTION 10-00091-00-BT  
PROJECT TCSP-IL09(029)  
JOB NO. C-97-033-11  
EFFINGHAM COUNTY

INDEX OF SHEETS

SHEET	ITEM
1	COVER SHEET
2	SUMMARY OF QUANTITIES/TYPICAL SECTIONS
3	OVERALL PLAN AND PROFILE
4	GENERAL PLAN AND ELEVATION
5	BRIDGE DETAILS
6	ABUTMENT AND WINGWALL PLAN - DIMENSIONS
7	ABUTMENT AND WINGWALL PLAN - REINFORCEMENT
8	ABUTMENT AND WINGWALL SECTIONS AND DETAILS
9	WEST WOOD DECKING SPECIAL, PLAN AND PROFILE
10	EAST WOOD DECKING SPECIAL, PLAN AND PROFILE
11	WOOD DECKING SPECIAL, ABUTMENT DETAILS
12-13	WOOD DECKING SPECIAL, DETAILS
14-17	CROSS SECTIONS

- STANDARD DRAWINGS
- STANDARD 000001-06
  - STANDARD 280001-05
  - STANDARD 515001-03
  - STANDARD 542401-01
  - STANDARD 701901-01

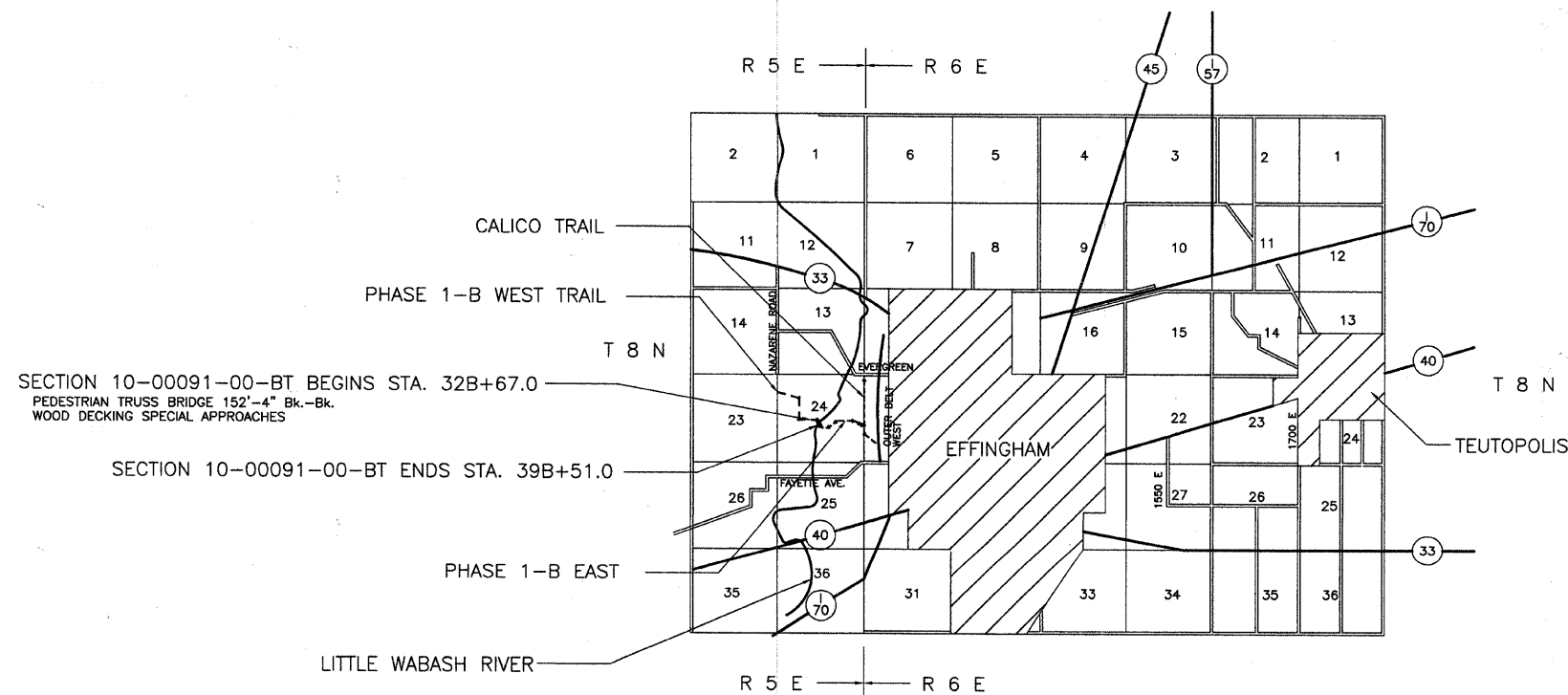
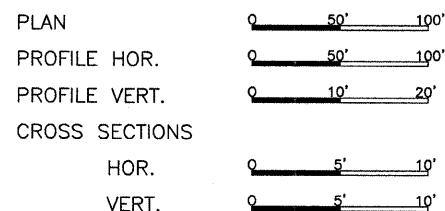

NET LENGTH SECTION 10-00091-00-BT = 684.0 Ft. = 0.129 Mi.

*John A. Charlton*  
Ill. Reg. Prof. Eng. #29175  
11/1/2011  
Lic Expires 11/30/2011

CHARLESTON ENGINEERING INC.  
105 N. KITCHELL  
P.O. BOX 397  
OLNEY, ILLINOIS 62450  
PH. 618-392-0736

APPROVED *John A. Charlton* 2011  
COUNTY ENGINEER

PASSED *Maureen Koehl* 1-18 2011  
DISTRICT SEVEN ENGINEER OF  
LOCAL ROADS AND STREETS

Releasing For  
Bid Based on  
Limited Review

*Roger L. Dishell* 1-18 2011  
DEPUTY DIRECTOR OF HIGHWAYS  
REGION FOUR ENGINEER