

**WEST CURB LINE**

Location	Station	Offset	Theoretical Grade Elevations
End South Appr. Slab	240+10.57	-18.00	427.75
A	240+20.53	-18.00	427.80
B	240+30.50	-18.00	427.85
Back South Abut.	240+40.48	-18.00	427.89

**WEST EDGE OF PAVEMENT**

Location	Station	Offset	Theoretical Grade Elevations
End South Appr. Slab	240+08.33	-12.00	427.95
A	240+18.26	-12.00	428.00
B	240+28.21	-12.00	428.04
Back South Abut.	240+38.17	-12.00	428.08

**☉ ROADWAY & PROFILE GRADE**

Location	Station	Offset	Theoretical Grade Elevations
End South Appr. Slab	240+03.86	0.00	428.33
A	240+13.76	0.00	428.38
B	240+23.66	0.00	428.43
Back South Abut.	240+33.57	0.00	428.47

**LOCAL TANGENT AT STA. 240+96.00**

Location	Station	Offset	Theoretical Grade Elevations
End South Appr. Slab	240+03.36	1.35	428.38
A	240+13.35	1.07	428.42
B	240+23.35	0.83	428.46
Back South Abut.	240+33.34	0.62	428.49

**EAST EDGE OF PAVEMENT**

Location	Station	Offset	Theoretical Grade Elevations
End South Appr. Slab	239+99.43	12.00	428.73
A	240+09.28	12.00	428.77
B	240+19.14	12.00	428.82
Back South Abut.	240+29.02	12.00	428.86

**EAST CURB LINE**

Location	Station	Offset	Theoretical Grade Elevations
End South Appr. Slab	239+97.23	18.00	428.93
A	240+07.06	18.00	428.96
B	240+16.90	18.00	429.01
Back South Abut.	240+26.75	18.00	429.06

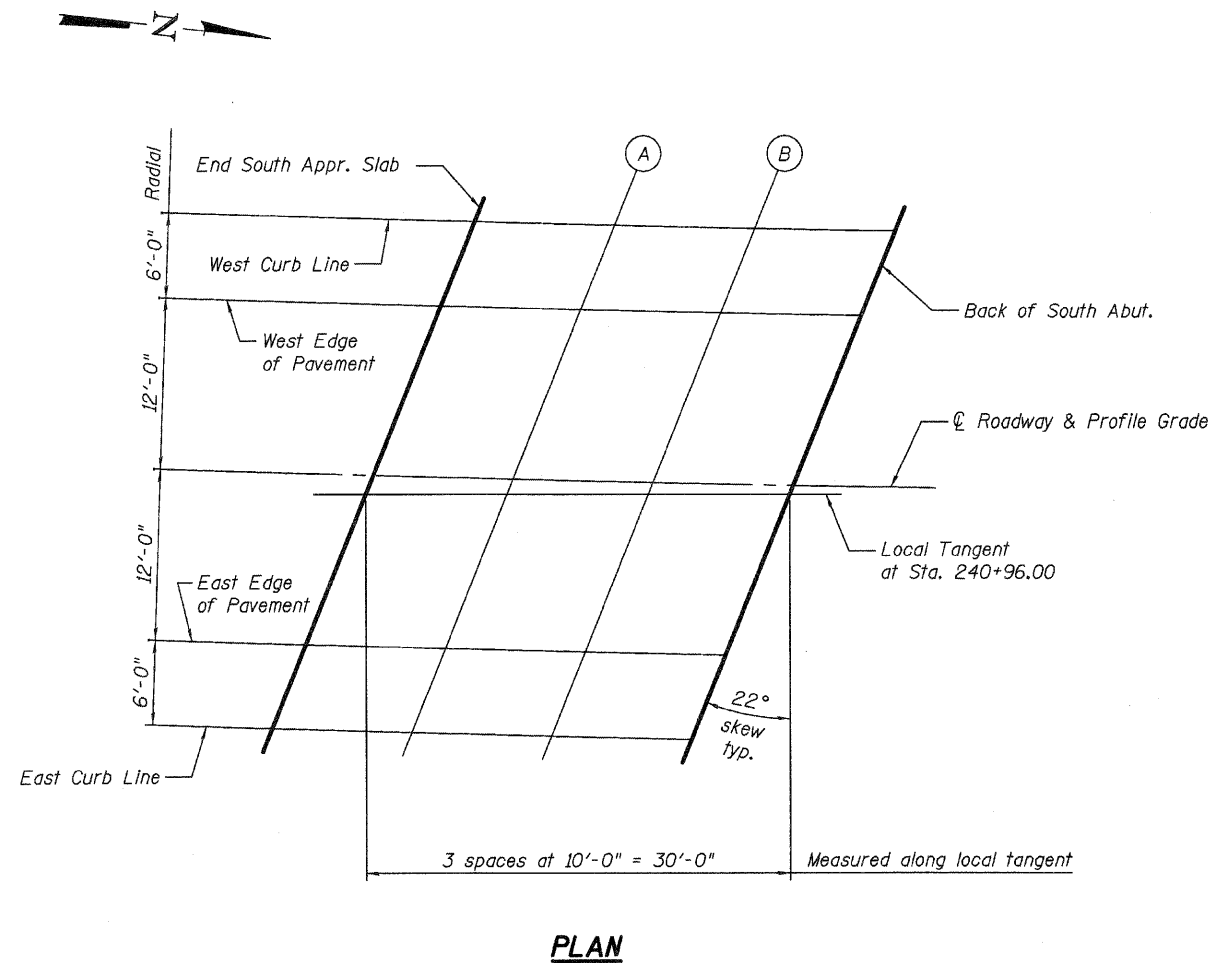

FILE NAME =	USER NAME =	DESIGNED - MJP	REVISED -	<b>STATE OF ILLINOIS DEPARTMENT OF TRANSPORTATION</b>	<b>TOP OF SOUTH APPROACH SLAB ELEVATIONS STRUCTURE NO. 039-0073</b>	F.A.S. RTE.	SECTION	COUNTY	TOTAL SHEETS	SHEET NO.	
		CHECKED - RLM	REVISED -			1908	(13B)I-2	JACKSON	71	47	
		DRAWN - PRC	REVISED -			<b>CONTRACT NO. 98898</b>					
		CHECKED - MJP	REVISED -			ILLINOIS FED. AID PROJECT					
	PLOT SCALE =			SHEET NO. 8 OF 32 SHEETS							
	PLOT DATE = 12/02/2010										