

ROUTE	SECTION	COUNTY	TOTAL SHEETS	SHEET NO.
SRTS	10-00045-00-SW	MASSAC	12	1
COVER SHEET				
FEDERAL PROJECT NO. SRTS-4009(024)			CONTRACT NO. 99446	

STATE OF ILLINOIS
DEPARTMENT OF TRANSPORTATION
DIVISION OF HIGHWAYS

SAFE ROUTES TO SCHOOL (SRTS) METROPOLIS/BROOKPORT 2010

METROPOLIS ELEMENTARY SCHOOL - BROOKPORT ELEMENTARY SCHOOL
SECTION 10-00045-00-SW
FEDERAL PROJECT NO. SRTS-4009(024)
JOB NO. C-40-108-09
CONTRACT NO. 99446
CITY OF METROPOLIS
SRTS FUNDING

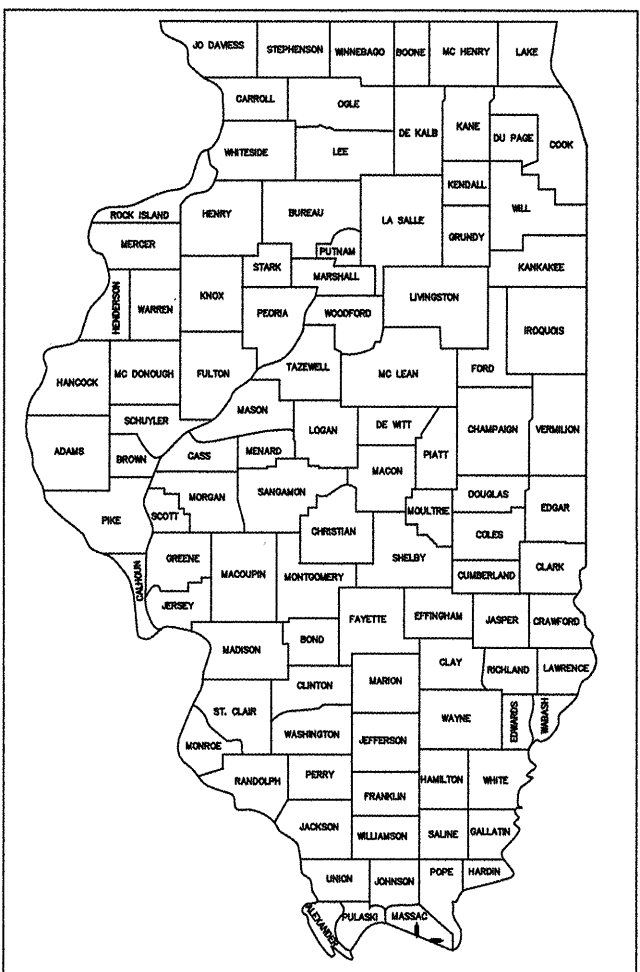

INDEX OF SHEETS

1. COVER SHEET
2. SUMMARY OF QUANTITIES
3. SIGNAGE AND PAVEMENT MARKINGS KEYNOTES AND DETAILS
4. SCHEDULE OF QUANTITIES FOR METROPOLIS AND BROOKPORT
5. METROPOLIS ELEMENTARY SIGNAGE AND PAVEMENT MARKINGS PLAN
6. BROOKPORT ELEMENTARY SIGNAGE AND PAVEMENT MARKINGS PLAN
7. TYPICAL SIDEWALK DETAILS
8. METROPOLIS ELEMENTARY SIDEWALK PLAN AND PROFILE
9. METROPOLIS ELEMENTARY SIDEWALK DETAILS
10. BROOKPORT ELEMENTARY SIDEWALK PLAN AND PROFILE
11. BROOKPORT ELEMENTARY SIDEWALK DETAILS
12. BROOKPORT ELEMENTARY SIDEWALK DETAILS

SEE PROPOSAL BOOKLET FOR HIGHWAY STANDARDS AND SPECIAL PROVISIONS

- IDOT STD. DWGS.:
- 000001-6
 - 424001-05
 - 701301-04
 - 701901-01
 - 720001-01
 - 720006-02
 - 720011-01
 - 728001-01
 - 729001-01
 - 780001-02



BURIED UTILITIES NOTE

Buried utilities are shown at their APPROXIMATE location(s) based upon the best available information obtained from utility companies and field evidence. Not all utilities, whether underground or above-ground, are shown in these drawings; other utilities may exist on or adjacent to the subject site that are not specifically shown on these drawings. The Contractor must assume responsibility for all utilities, whether shown in these drawings or not, and must realize that the actual locations of utilities shown may vary from the locations indicated. USE EXTREME CAUTION during excavation and contact U L I E prior to any construction and/or excavation operations. All existing utilities encountered during work pertaining to this project shall be the Contractor's responsibility to maintain in service.

IMPROVEMENT BEGINS
STA. 49+57.89

IMPROVEMENT ENDS
STA. 58+46.71

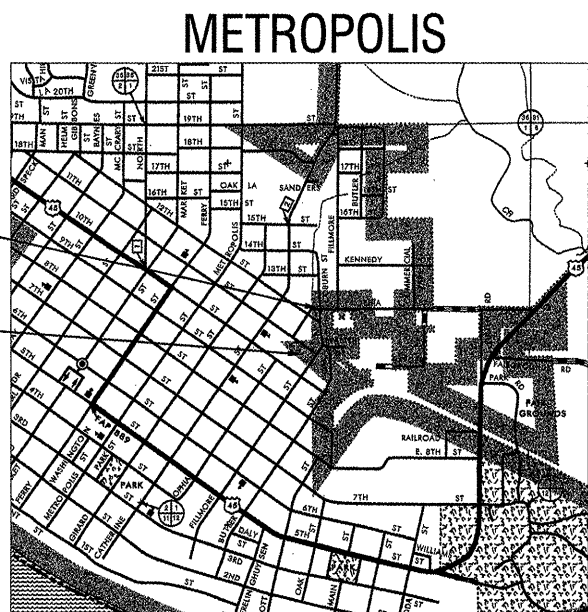

NET LENGTH OF IMPROVEMENT = 888.82 FEET = 0.168 MILES
STA. 49+57.89 TO STA. 58+46.71

APPROX. SCALE: 1" = 1/2 MILE

FUNCTIONAL STREET CLASSIFICATION: URBAN COLLECTOR

BROOKPORT

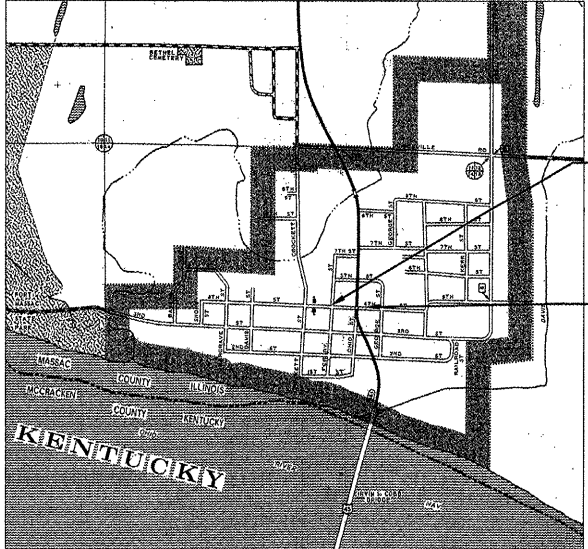

NET LENGTH OF IMPROVEMENT = 436.18 FEET = 0.083 MILES
STA. 9+71.70 TO STA. 14+07.88

APPROX. SCALE: 1" = 1/2 MILE

FUNCTIONAL STREET CLASSIFICATION: LOCAL ROAD

IMPROVEMENT BEGINS
STA. 9+71.70

IMPROVEMENT ENDS
STA. 14+07.88



Joseph E. Matesevac
signature date 12/08/2010
November 30, 2011
license expires

LOCATION OF SECTION INDICATED THUS:

STATE OF ILLINOIS DEPARTMENT OF TRANSPORTATION

APPROVED 12/08/2010
Date
Billy McDaniel
Mayor, City of Metropolis

PASSED 12/14/2010
Date
Den W. Hall
District 9 Engineer of Local Roads & Streets

RELEASING FOR BID
BASED ON LIMITED
REVIEW 12/15/10
Date
Mary C. Lami
Deputy Director of Highways, Region 5 Engineer



504 N Market Street
Metropolis, Illinois 62960
ph: (618) 524-1085
fax: (618) 524-8902
engineering, inc. IL LICENSE NO. 184-004492

SUMMARY OF QUANTITIES - SAFE ROUTES TO SCHOOL METROPOLIS/BROOKPORT 2010

<u>IDOT CODED</u>	<u>PAY ITEM</u>	<u>ITEM DESCRIPTION</u>	<u>UNIT</u>	<u>TOTAL QUANTITY</u>
	31100100	SUBBASE GRANULAR MATERIAL, TYPE A	TON	107
	42400800	DETECTABLE WARNINGS	SQ. FT.	171
	44201301	CLASS C PATCHES, TYPE I, 6-INCH	SQ. YD.	11
	44201309	CLASS C PATCHES, TYPE III, 6-INCH	SQ. YD.	17
	542C0217	PIPE CULVERTS, CLASS C, TYPE 1 12"	FOOT	20
	542C0220	PIPE CULVERTS, CLASS C, TYPE 1 15"	FOOT	8
	67100100	MOBILIZATION	L. SUM	1
	72000100	SIGN PANEL TYPE 1	SQ. FT.	108
	72400500	RELOCATE SIGN PANEL ASSEMBLY - TYPE A	EACH	2
	72800100	TELESCOPING STEEL SIGN SUPPORT	FOOT	146
	72900200	METAL POST - TYPE B	FOOT	27
△	78000100	THERMOPLASTIC PAVEMENT MARKING - LETTERS AND SYMBOLS	SQ. FT.	455
△	78000200	THERMOPLASTIC PAVEMENT MARKING - LINE 4"	FOOT	348
△	78000600	THERMOPLASTIC PAVEMENT MARKING - LINE 12"	FOOT	1,021
△ *	X0325714	FLASHING BEACON, POST MOUNTED, SOLAR POWERED INSTALLATION	EACH	4
*	X4240420	PORTLAND CEMENT CONCRETE SIDEWALK 4 INCH, SPECIAL	SQ. FT.	4,417

△ SPECIALTY ITEMS

ROUTE	SECTION	COUNTY	TOTAL SHEETS	SHEET NO.
SRTS	10-00045-00-SW	MASSAC	12	3
SIGNAGE AND PAVEMENT MARKINGS KEYNOTES AND DETAILS				
FEDERAL PROJECT NO. SRTS-4009(024)			CONTRACT NO. 99446	



S1-1
 SIZE: 36"x36"
 SYMBOLS/LETTERING/BORDER: BLACK
 BACKGROUND: FLUORESCENT YELLOW-GREEN



W16-7P
 SIZE: 24"x12"
 SYMBOLS/LETTERING/BORDER: BLACK
 BACKGROUND: FLUORESCENT YELLOW-GREEN

* MOUNTED ON TELESCOPING STEEL SIGN SUPPORT (MIN. LENGTH 16.0 FT.)

1 SCHOOL CROSSING ASSEMBLY SIGNS



CARMANAH R829 FLASHING SOLAR LED 12" Ø AMBER BEACON ASSEMBLY WITH TIMER CONTROL AND SOFTWARE PACKAGE FOR TIMER PROGRAMMING



S4-3P
 SIZE: 24"x8"
 SYMBOLS/LETTERING/BORDER: BLACK
 BACKGROUND: FLUORESCENT YELLOW-GREEN

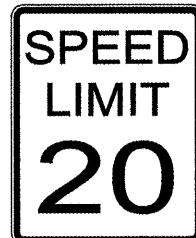

R2-1
 SIZE: 24"x30"
 SYMBOLS/LETTERING/BORDER: BLACK
 BACKGROUND: WHITE



S4-2P
 SIZE: 24"x10"
 SYMBOLS/LETTERING/BORDER: BLACK
 BACKGROUND: WHITE

* MOUNTED ON TELESCOPING STEEL SIGN SUPPORT (MIN. LENGTH 17.0 FT.)

2 SCHOOL SPEED LIMIT ASSEMBLY SIGNS



S1-1
 SIZE: 36"x36"
 SYMBOLS/LETTERING/BORDER: BLACK
 BACKGROUND: FLUORESCENT YELLOW-GREEN



S4-3P
 SIZE: 24"x8"
 SYMBOLS/LETTERING/BORDER: BLACK
 BACKGROUND: FLUORESCENT YELLOW-GREEN

* MOUNTED ON TELESCOPING STEEL SIGN SUPPORT (MIN. LENGTH 16.0 FT.)

3 ADVANCE SCHOOL ZONE WARNING ASSEMBLY SIGNS

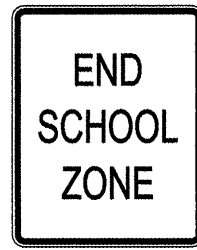

S5-2
 SIZE: 24"x30"
 SYMBOLS/LETTERING/BORDER: BLACK
 BACKGROUND: WHITE

* MOUNTED ON TYPE B METAL POST (MIN. LENGTH 13.5 FT.)

4 END SCHOOL ZONE SIGN

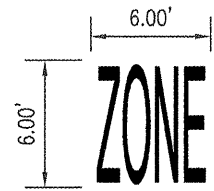

WHITE THERMOPLASTIC LETTERS AND SYMBOLS

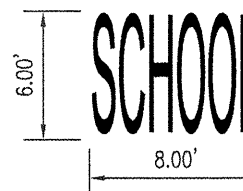

WHITE THERMOPLASTIC LETTERS AND SYMBOLS

5 "SCHOOL ZONE" PAVEMENT MARKING

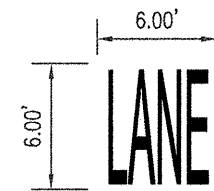

WHITE THERMOPLASTIC LETTERS AND SYMBOLS

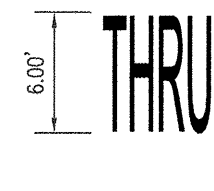

WHITE THERMOPLASTIC LETTERS AND SYMBOLS

7 "THRU LANE" MARKING

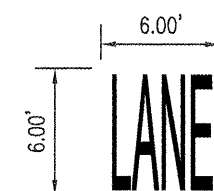

WHITE THERMOPLASTIC LETTERS AND SYMBOLS



WHITE THERMOPLASTIC LETTERS AND SYMBOLS

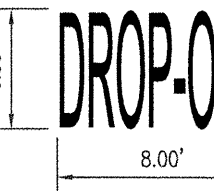

WHITE THERMOPLASTIC LETTERS AND SYMBOLS

8 "DROP-OFF/PICK-UP LANE" MARKING

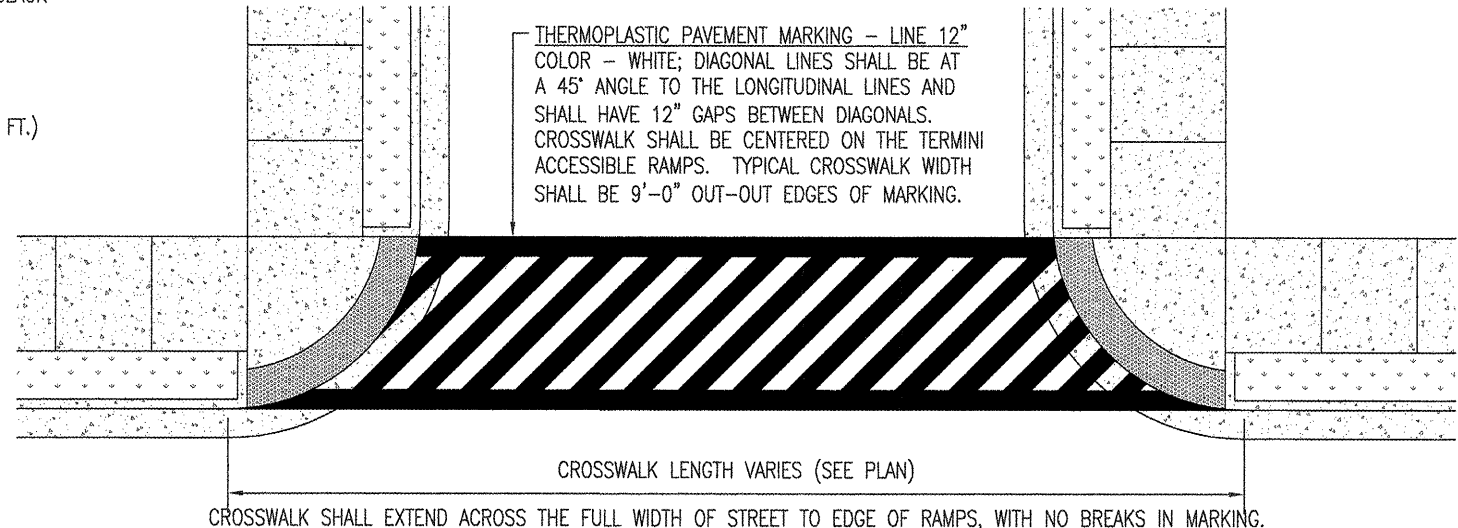

6 TYPICAL CROSSWALK PAVEMENT MARKINGS

(NOT TO SCALE - DOES NOT REPRESENT ACCURATE SPECIFIC SITE CONDITIONS)

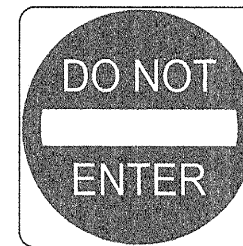

R5-1
 SIZE: 30"x30"
 SYMBOL: RED
 LETTERING/BACKGROUND: WHITE

13 "DO NOT ENTER" SIGN

MOUNT NEW DO NOT ENTER SIGN ON SAME POST AS STOP SIGN, FACING APPROACHING TRAFFIC FROM INTERSECTION OF FERRY AND 3RD STREETS

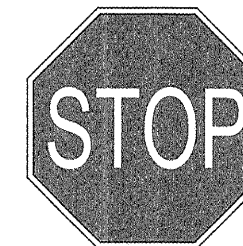

R1-1
 SIZE: 30"x30"
 SYMBOLS/LETTERING/BORDER: WHITE
 BACKGROUND: RED

14 "STOP" SIGN

RE-MOUNT EXISTING STOP SIGN FACING APPROACHING TRAFFIC ALONG FERRY STREET FROM WEST

GENERAL NOTES

- ALL SIGNS AND PAVEMENT MARKINGS SHALL MEET THE STANDARDS AND SPECIFICATIONS OF THE MANUAL ON UNIFORM TRAFFIC CONTROL DEVICES (MUTCD), CURRENT EDITION AND STANDARD HIGHWAY SIGNS AND MARKINGS (SHSM), CURRENT EDITION, FOR DIMENSIONS, SIZES, COLORS, RETROREFLECTIVITY, AND ALL OTHER FEATURES.
- ALL EXISTING PAVEMENT MARKINGS ON FOURTH STREET AND FERRY STREET IN BROOKPORT, SHALL BE REMOVED PRIOR TO INSTALLING NEW MARKINGS.
- ALL SIGN DESIGNATIONS NOTED ON THE DETAILS SHALL CORRESPOND DIRECTLY TO MUTCD AND SHSM.
- ALL SIGN ASSEMBLIES SHALL BE MOUNTED SUCH THAT THE BOTTOM EDGE OF THE LOWEST SIGN IS 7 FT. ABOVE THE ADJACENT GRADE.

9 WHITE THERMOPLASTIC PAVEMENT MARKING - LINE 4"; SKIP DASHES (DASH IS 10 L.F. WITH 20 L.F. SPACE)

10 WHITE THERMOPLASTIC PAVEMENT MARKING - LINE 4"; SOLID SINGLE WHITE LINE

11 WHITE THERMOPLASTIC PAVEMENT MARKING - LETTERS AND SYMBOLS; RIGHT-TURN/STRAIGHT COMBINATION ARROW (LARGE)

12 WHITE THERMOPLASTIC PAVEMENT MARKING - LETTERS AND SYMBOLS; LEFT-TURN ARROW (LARGE)

ROUTE	SECTION	COUNTY	TOTAL SHEETS	SHEET NO.
SRTS	10-00045-00-SW	MASSAC	12	4
SCHEDULE OF QUANTITIES FOR METROPOLIS AND BROOKPORT				
FEDERAL PROJECT NO. SRTS-4008(024)			CONTRACT NO. 99446	

SCHEDULE OF QUANTITIES - SAFE ROUTES TO SCHOOL METROPOLIS/BROOKPORT 2010

<u>ITEM DESCRIPTION</u>	<u>UNIT</u>	<u>METROPOLIS QUANTITY</u>	<u>BROOKPORT QUANTITY</u>	<u>TOTAL QUANTITY</u>
SUBBASE GRANULAR MATERIAL, TYPE A	TON	60	47	107
DETECTABLE WARNINGS	SQ. FT.	110	61	171
CLASS C PATCHES, TYPE I, 6-INCH	SQ. YD.	0	11	11
CLASS C PATCHES, TYPE III, 6-INCH	SQ. YD.	17	0	17
PIPE CULVERTS, CLASS C, TYPE 1 12"	FOOT	20	0	20
PIPE CULVERT, CLASS C, TYPE 1 15"	FOOT	8	0	8
MOBILIZATION	L. SUM	0.5	0.5	1
SIGN PANEL TYPE 1	SQ. FT.	97	11	108
RELOCATE SIGN PANEL ASSEMBLY - TYPE A	EACH	1	1	2
TELESCOPING STEEL SIGN SUPPORT	FOOT	130	16	146
METAL POST - TYPE B	FOOT	27	0	27
THERMOPLASTIC PAVEMENT MARKING - LETTERS AND SYMBOLS	SQ. FT.	127.6	327.4	455
THERMOPLASTIC PAVEMENT MARKING - LINE 4"	FOOT	0	348	348
THERMOPLASTIC PAVEMENT MARKING - LINE 12"	FOOT	535	486	1,021
FLASHING BEACON, POST MOUNTED, SOLAR POWERED INSTALLATION	EACH	2	2	4
PORTLAND CEMENT CONCRETE SIDEWALK 4 INCH, SPECIAL	SQ. FT.	2,465	1,952	4,417

ROUTE	SECTION	COUNTY	TOTAL SHEETS	SHEET NO.
SRTS	10-00045-00-SW	MASSAC	12	5
METROPOLIS ELEMENTARY SIGNAGE AND PAVEMENT MARKINGS PLAN				
FEDERAL PROJECT NO. SRTS-4009(024)			CONTRACT NO. 99446	



METROPOLIS ELEMENTARY SIGNAGE AND PAVEMENT MARKINGS PLAN

SCALE: 1" = 200'

ROUTE	SECTION	COUNTY	TOTAL SHEETS	SHEET NO.
SRTS	10-00045-00-SW	MASSAC	12	6



- 1a SCHOOL CROSSING ASSEMBLY SIGNS
- 2a SCHOOL SPEED LIMIT ASSEMBLY SIGNS
- 3a ADVANCE SCHOOL ZONE WARNING ASSEMBLY SIGNS

BROOKPORT ELEMENTARY SIGNAGE AND PAVEMENT MARKINGS PLAN

ROUTE	SECTION	COUNTY	TOTAL SHEETS	SHEET NO.
SRTS	10-00045-00-SW	MASSAC	12	7
TYPICAL SIDEWALK DETAILS				
FEDERAL PROJECT NO. SRTS-4009(024)			CONTRACT NO. 99446	

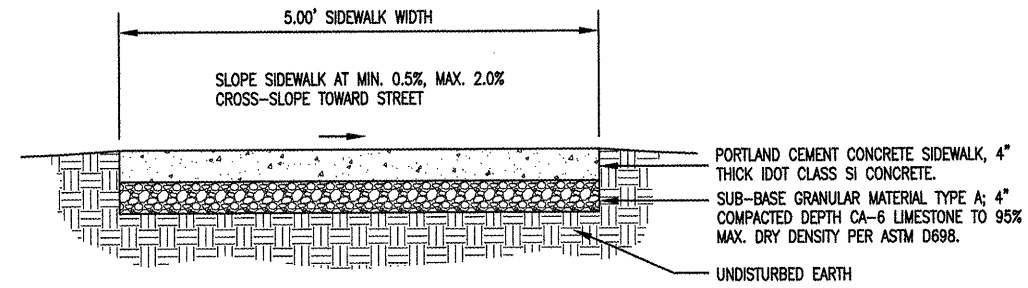

TYPICAL SIDEWALK SECTION
BROOKPORT ELEMENTARY STA. 9+71.70 TO 14+07.88

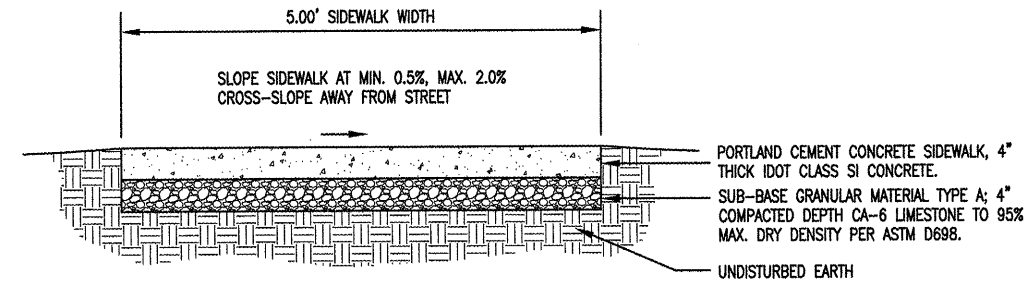

TYPICAL SIDEWALK SECTION
METROPOLIS ELEMENTARY STA. 49+57.89 TO 58+46.71

GENERAL SIDEWALK NOTES:

1. THE MAXIMUM LONGITUDINAL SLOPE ON A PUBLIC SIDEWALK SHALL BE 5.0%. WHERE 5.0% OR LESS LONGITUDINAL SLOPES CANNOT BE ACHIEVED, RAMP MUST BE DESIGNED TO CONFORM TO THE STATE OF ILLINOIS ACCESSIBILITY CODE, THE ILLINOIS ENVIRONMENTAL BARRIERS ACT, AND ADA.
2. SIDEWALKS SHALL HAVE A CROSS-SLOPE OF NO LESS THAN 0.5% AND NO GREATER THAN 2.0%, SLOPED IN THE GENERAL DIRECTION OF THE SURROUNDING AREA SLOPE.
3. SIDEWALKS SHALL BE CONSTRUCTED IN A MANNER TO FACILITATE PROPER DRAINAGE. IN NO CASE SHALL SIDEWALKS OBSTRUCT THE NECESSARY DRAINAGE OF THE SURROUNDING AREA.
4. SIDEWALKS SHALL HAVE 3/4" TRANSVERSE EXPANSION JOINTS ON INTERVALS NOT EXCEEDING 100 LINEAR FEET, OR AS SHOWN ON THE PLAN.
5. SEE PLAN AND PROFILE AND OTHER SPECIFIC DETAIL SHEETS FOR RIGHT-OF-WAY LOCATIONS AND SPECIFIC SITE CONDITIONS INCLUDING STREET LOCATION/CONDITIONS, UTILITY LOCATIONS (IF APPLICABLE), DIMENSIONS, ELEVATIONS (GRADE PROFILE), ETC.

LEGEND:

- CONCRETE WALKING SURFACE (LIGHT BROOM FINISH)
- DETECTIBLE WARNING SURFACE (TRUNCATED DOMES)
- NON-WALKING SURFACE

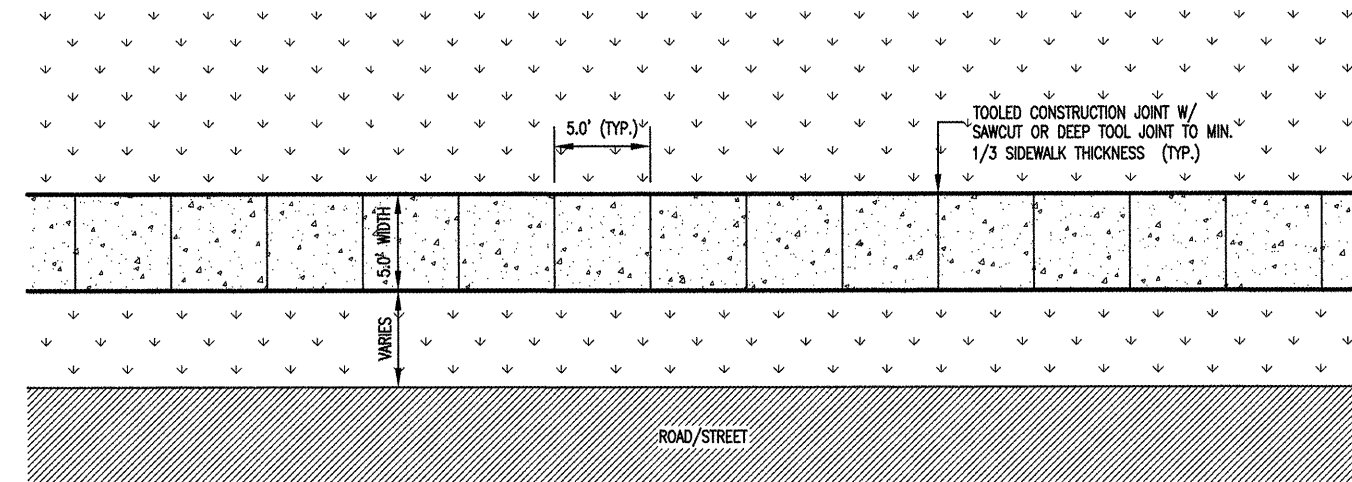

TYPICAL SIDEWALK PLAN

(NOT TO SCALE - DOES NOT REPRESENT ACCURATE SPECIFIC SITE DIMENSIONS/LOCATIONS)

GENERAL ACCESSIBLE RAMP NOTES:

1. ACCESSIBLE RAMPS SHALL MEET ALL REQUIREMENTS OF THE ILLINOIS ACCESSIBILITY CODE, ILLINOIS ENVIRONMENTAL BARRIERS ACT, ADA, ILLINOIS DEPARTMENT OF TRANSPORTATION (IDOT), AND THE ILLINOIS ATTORNEY GENERAL OFFICE. INFORMATION MAY BE OBTAINED @ www.illinoisattorneygeneral.gov.
2. TRUNCATED DOMES SHALL MEET THE COLOR CONTRAST REQUIREMENTS OF ALL OF THE AFOREMENTIONED AGENCY REQUIREMENTS.
3. "ADA" REFERS TO THE AMERICANS WITH DISABILITIES ACT STANDARDS FOR ACCESSIBLE DESIGN, 28 CFR PART 36, AS PUBLISHED BY THE U.S. DEPARTMENT OF JUSTICE.
4. 6" CURB MAY BE DELETED WHERE NO CURB IS PROVIDED ON THE STREETS
5. SEE IDOT STANDARD 424001, CURB RAMPS FOR SIDEWALKS, FOR FURTHER DETAIL.

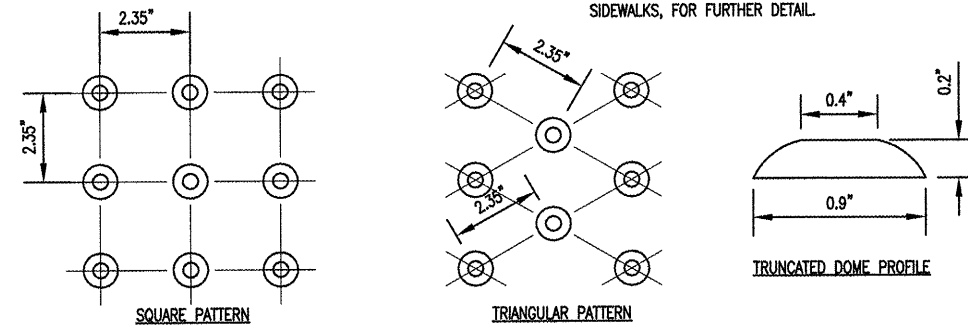

DETECTIBLE WARNING SURFACE (TRUNCATED DOMES)

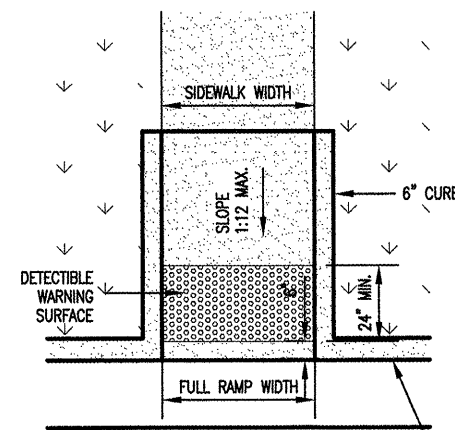

TYPICAL TYPE A RAMP

TYP. STREET CURB & GUTTER. EXIST. CURB & GUTTER MUST BE SAWCUT AND REMOVED FOR INSTALLATION OF RAMP. NEW RAMP CURB SHALL BE TIED INTO EXIST CURB & GUTTER.

ROUTE	SECTION	COUNTY	TOTAL SHEETS	SHEET NO.
N/A	10-00045-00-SW	MASSAC	12	8
PLAN AND PROFILE - METROPOLIS ELEMENTARY SIDEWALK				
FEDERAL PROJECT NO. SRTS-4009(024)			CONTRACT NO. 99446	

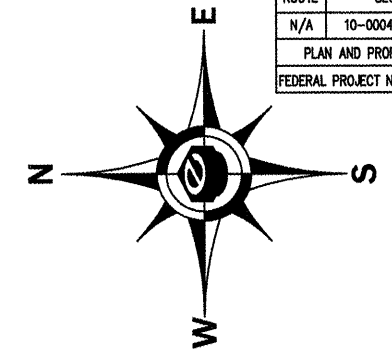

STA. 49+57.89 TO STA. 49+70.02
PORTLAND CEMENT CONCRETE SIDEWALK 4-INCH;
5.00 FEET WIDE; SEE TYPICAL SIDEWALK DETAILS;
SEE PLAN DIMENSIONS FOR SIDEWALK OFFSETS

STA. 49+65.30 TO STA. 49+67.30
DETECTABLE WARNING SURFACE

STA. 50+04.91 TO STA. 50+06.91
DETECTABLE WARNING SURFACE

STA. 50+31
RELOCATE STOP SIGN

STA. 50+00.00 TO STA. 52+13.21
PORTLAND CEMENT CONCRETE SIDEWALK 4-INCH;
5.00 FEET WIDE; SEE TYPICAL SIDEWALK DETAILS;
SEE PLAN DIMENSIONS FOR SIDEWALK OFFSETS

STA. 51+21
EXTEND 15" CMP WITH 8 FT.
PIPE CULVERT CL. C, TYPE 1, 15"

STA. 52+05.78 TO STA. 52+07.78
DETECTABLE WARNING SURFACE

STA. 52+13.21 TO STA. 52+37.24
CROSSWALK - SEE TYPICAL
CROSSWALK DETAIL

STA. 52+38.29 TO STA. 52+40.29
DETECTABLE WARNING SURFACE

STA. 52+37.24 TO STA. 54+14.05
PORTLAND CEMENT CONCRETE SIDEWALK 4-INCH;
5.00 FEET WIDE; SEE TYPICAL SIDEWALK DETAILS;
SEE PLAN DIMENSIONS FOR SIDEWALK OFFSETS

STA. 54+10.90 TO STA. 54+12.90
DETECTABLE WARNING SURFACE

STA. 54+14.05 TO STA. 54+46.96
CROSSWALK - SEE TYPICAL
CROSSWALK DETAIL

STA. 54+48.84 TO STA. 54+50.84
DETECTABLE WARNING SURFACE

STA. 54+46.96 TO STA. 54+76.41
PORTLAND CEMENT CONCRETE SIDEWALK 4-INCH;
5.00 FEET WIDE; SEE TYPICAL SIDEWALK DETAILS;
SEE PLAN DIMENSIONS FOR SIDEWALK OFFSETS

STA. 54+76.41 TO STA. 54+77.78
DETECTABLE WARNING SURFACE

STA. 54+76.41 TO STA. 54+86.63
CROSSWALK - SEE TYPICAL
CROSSWALK DETAIL

STA. 54+76.41 TO STA. 54+86.63
SAWCUT AND REMOVE APPROX. 10'x15' SECTION OF
EXISTING ALLEY. EXTEND 12" RCP APPROX. 8 FT.
BENEATH PROPOSED SIDEWALK AND BACKFILL FULL
DEPTH WITH CA-6. REMOVE 6" PIPE CROSSING
ALLEY AND REPLACE WITH 12 FT. PIPE CULVERT
CLASS C, TYPE 1, 12" AT NEW LOCATION AS SHOWN
REPLACE ALLEY SURFACE WITH PORTLAND CEMENT
CONCRETE CLASS C PATCH, TYPE III, 6-INCH.
GRADE AND RE-SHAPE DITCHES TO ACCOMMODATE
NEW PIPE AND ASSOCIATED DRAINAGE.

STA. 54+87.32 TO STA. 54+89.32
DETECTABLE WARNING SURFACE

STA. 54+86.63 TO STA. 54+94.95
PORTLAND CEMENT CONCRETE SIDEWALK 4-INCH;
4.00 FEET WIDE; SEE TYPICAL SIDEWALK DETAILS;
SEE PLAN DIMENSIONS FOR SIDEWALK OFFSETS;
TIE INTO EXISTING CONCRETE SIDEWALK

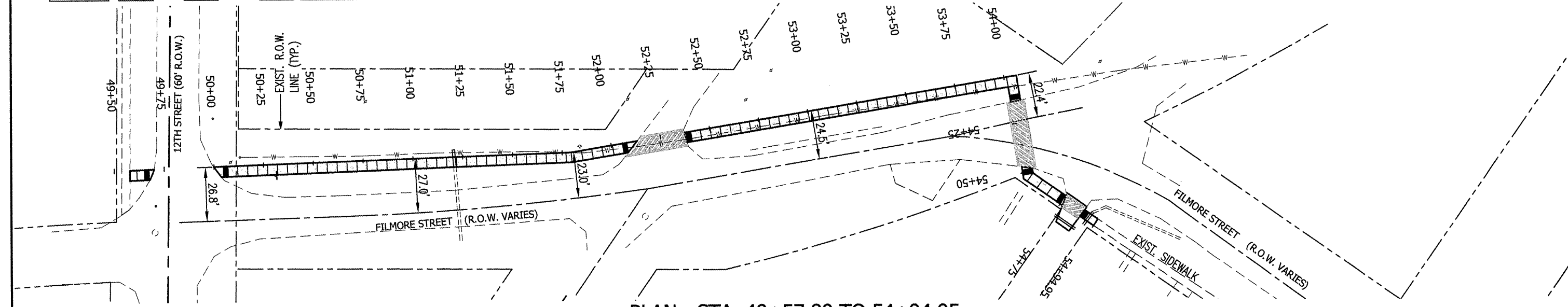

PLAN - STA. 49+57.89 TO 54+94.95

SCALE: 1" = 50'

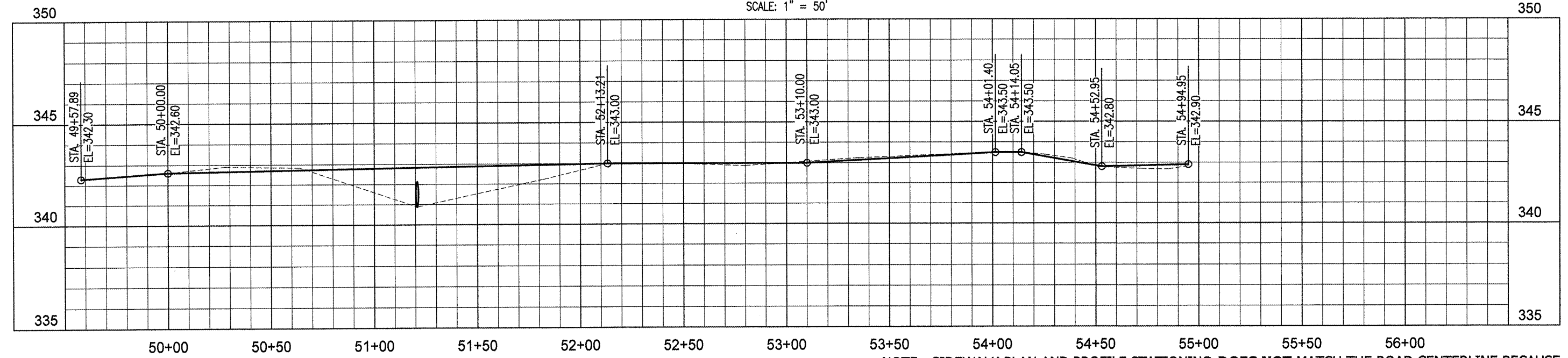

PROFILE - STA. 49+57.89 TO 54+94.95

SCALE: 1" = 50' (HORIZ.); 1" = 5' (VERT.)

NOTE: SIDEWALK PLAN AND PROFILE STATIONING **DOES NOT** MATCH THE ROAD CENTERLINE BECAUSE SIDEWALK DOES NOT PARALLEL ROAD CENTERLINE. PLAN AND PROFILE STATIONING IS ALONG THE BACK EDGE OF SIDEWALK.

ROUTE	SECTION	COUNTY	TOTAL SHEETS	SHEET NO.
SRTS	10-00045-00-SW	MASSAC	12	9
PLAN AND PROFILE - METROPOUS ELEMENTARY SIDEWALK				
FEDERAL PROJECT NO. SRTS-4009(024)			CONTRACT NO. 99446	

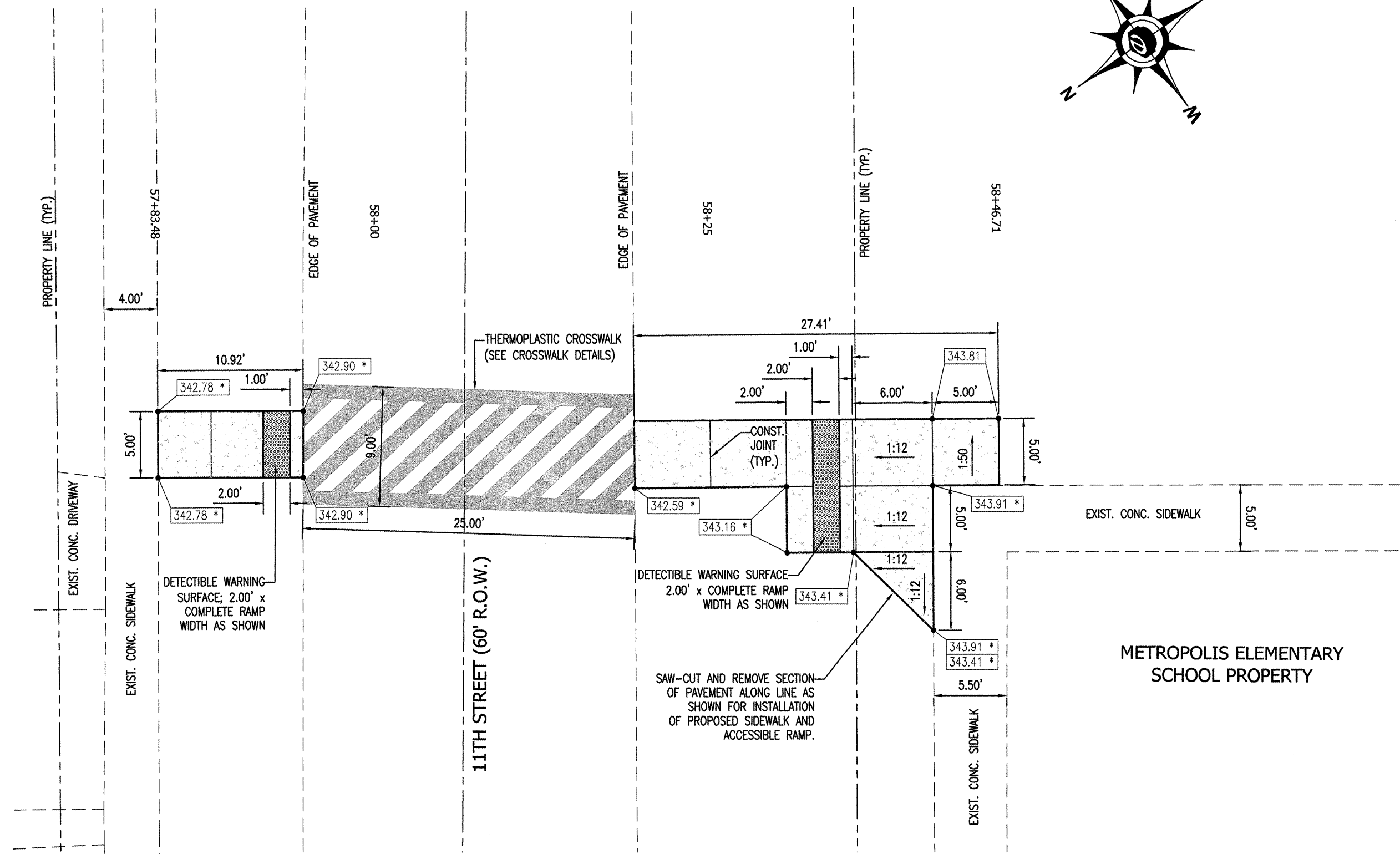
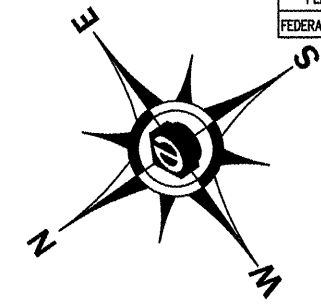

STA. 57+83.48 TO 58+46.71

DETAIL @ 11th STREET AND METROPOUS ELEMENTARY PROPERTY

SCALE: 1/8" = 1'

SPOT ELEVATION NOTES:

1. SPOT ELEVATIONS DENOTED WITH AN ASTERISK (*) MUST MATCH THE EXISTING ELEVATIONS OF THE ADJACENT PAVEMENT/CURB. IF PROPOSED ELEVATIONS VARY FROM THE EXISTING ELEVATIONS, ADJUST THE PROPOSED ELEVATIONS TO MATCH. CONTRACTOR MUST NOTIFY ENGINEER OF ANY DISCREPANCIES PRIOR TO CONSTRUCTION OF ANY PROPOSED ITEMS.
2. SINGLE SPOT ELEVATIONS DENOTE ELEVATION ON PAVEMENT SURFACE AND FLUSH ADJOINING SURFACE. DOUBLE SPOT ELEVATIONS DENOTE ELEVATION ON PAVEMENT SURFACE AND ADJACENT SIDEWALK OR CURB VERTICAL RISE/DROP.

ROUTE	SECTION	COUNTY	TOTAL SHEETS	SHEET NO.
SRTS	10-00045-00-SW	MASSAC	12	10
PLAN AND PROFILE - BROOKPORT ELEMENTARY SIDEWALK				
FEDERAL PROJECT NO. SRTS-4009(024)			CONTRACT NO. 99446	

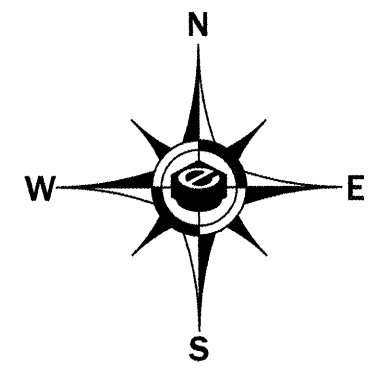

BROOKPORT
ELEMENTARY SCHOOL

STA. 9+71.70 TO STA. 10+00.00
CROSSWALK - SEE TYPICAL
CROSSWALK DETAIL

STA. 10+00.00 TO STA. 10+09.75
TYPE A RAMP - SEE RAMP DETAIL

STA. 10+09.75 TO STA. 13+35.15
PORTLAND CEMENT CONCRETE
SIDEWALK 4-INCH; 5.00 FEET WIDE;
SEE TYPICAL SIDEWALK DETAILS;
BACK EDGE OF SIDEWALK OFFSET
29.50' LEFT

STA. 13+35.15 TO STA. 13+42.37
TYPE A RAMP - SEE RAMP DETAIL

STA. 13+42.37 TO STA. 13+85.23
CROSSWALK - SEE TYPICAL
CROSSWALK DETAIL

STA. 13+85.23 TO STA. 14+07.88
TYPE A RAMP - SEE RAMP DETAIL

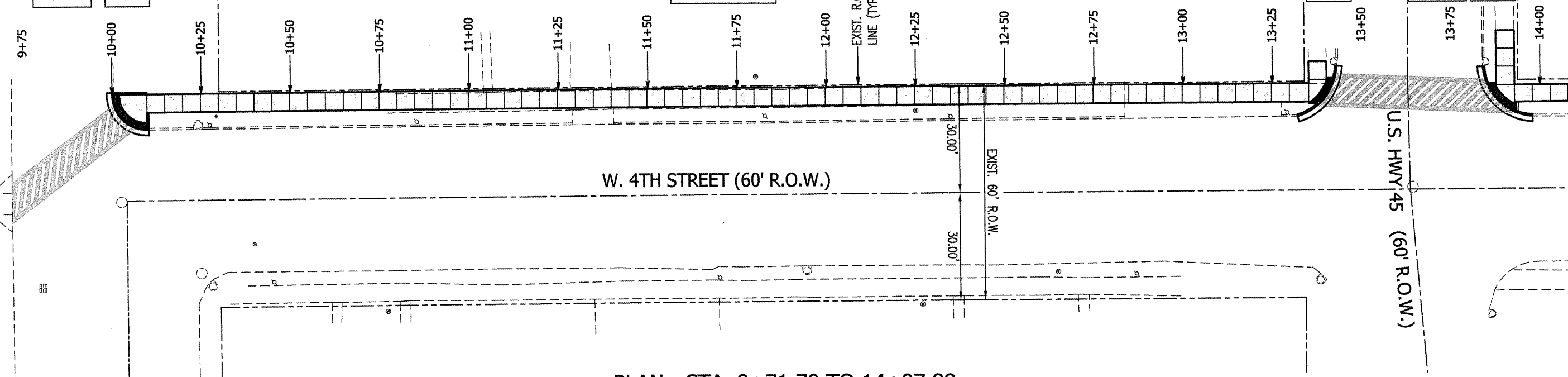

PLAN - STA. 9+71.70 TO 14+07.88

SCALE: 1" = 30'

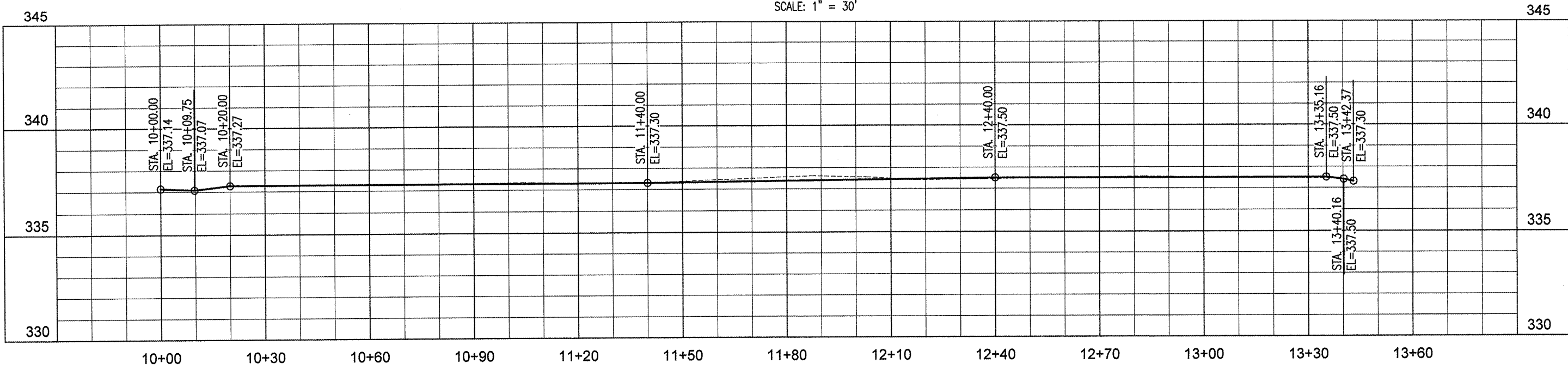

PROFILE - STA. 10+00.00 TO 13+42.37

SCALE: 1" = 30' (HORIZ.); 1" = 5' (VERT.)

ROUTE	SECTION	COUNTY	TOTAL SHEETS	SHEET NO.
SRTS	10-0045-00-SW	MASSAC	12	11
DETAILS - BROOKPORT ELEMENTARY SIDEWALK RAMPS				
FEDERAL PROJECT NO. SRTS-4009(024) CONTRACT NO. 98446				

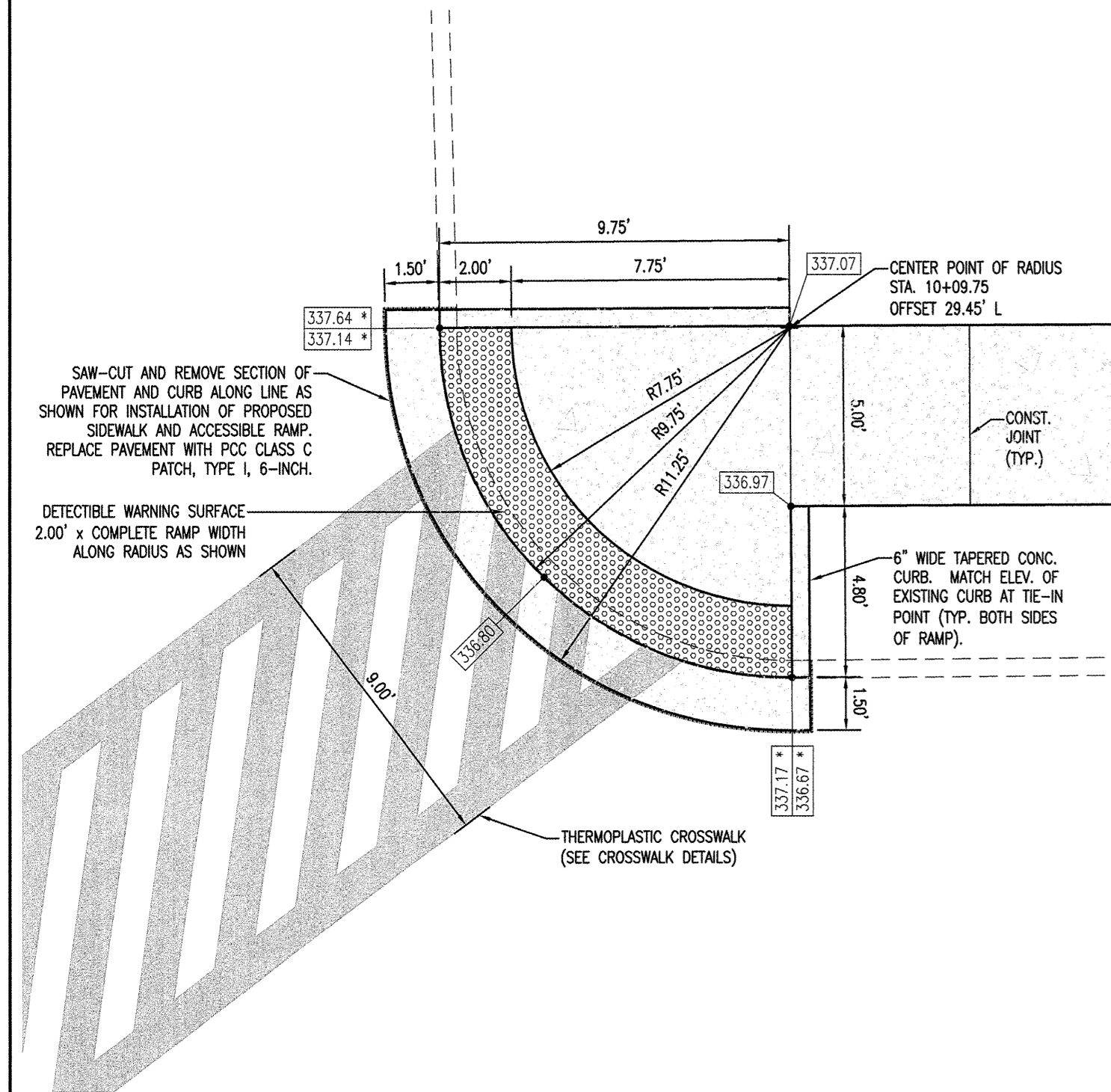

RAMP DETAIL - STA. 10+00 TO 10+09.75
SCALE: 1/4" = 1'

- SPOT ELEVATION NOTES:**
- SPOT ELEVATIONS DENOTED WITH AN ASTERISK (*) MUST MATCH THE EXISTING ELEVATIONS OF THE ADJACENT PAVEMENT/CURB. IF PROPOSED ELEVATIONS VARY FROM THE EXISTING ELEVATIONS, ADJUST THE PROPOSED ELEVATIONS TO MATCH. CONTRACTOR MUST NOTIFY ENGINEER OF ANY DISCREPANCIES PRIOR TO CONSTRUCTION OF ANY PROPOSED ITEMS.
 - SINGLE SPOT ELEVATIONS DENOTE ELEVATION ON PAVEMENT SURFACE AND FLUSH ADJOINING SURFACE. DOUBLE SPOT ELEVATIONS DENOTE ELEVATION ON PAVEMENT SURFACE AND ADJACENT SIDEWALK OR CURB VERTICAL RISE/DROP.

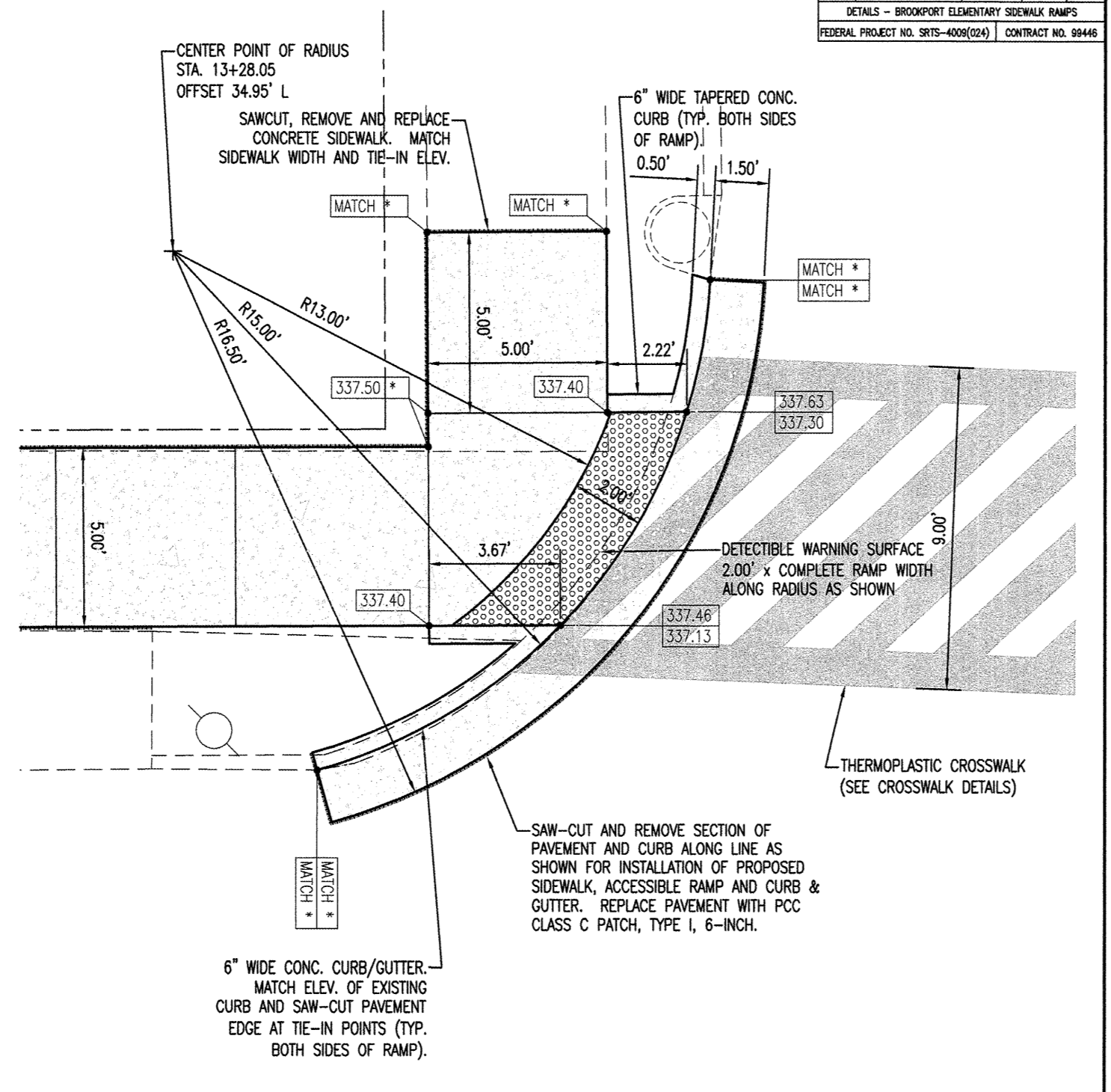

RAMP DETAIL - STA. 13+35.15 TO 13+42.37
SCALE: 1/4" = 1'

- SPOT ELEVATION NOTES:**
- SPOT ELEVATIONS DENOTED WITH AN ASTERISK (*) MUST MATCH THE EXISTING ELEVATIONS OF THE ADJACENT PAVEMENT/CURB. IF PROPOSED ELEVATIONS VARY FROM THE EXISTING ELEVATIONS, ADJUST THE PROPOSED ELEVATIONS TO MATCH. CONTRACTOR MUST NOTIFY ENGINEER OF ANY DISCREPANCIES PRIOR TO CONSTRUCTION OF ANY PROPOSED ITEMS.
 - SINGLE SPOT ELEVATIONS DENOTE ELEVATION ON PAVEMENT SURFACE AND FLUSH ADJOINING SURFACE. DOUBLE SPOT ELEVATIONS DENOTE ELEVATION ON PAVEMENT SURFACE AND ADJACENT SIDEWALK OR CURB VERTICAL RISE/DROP.

ROUTE	SECTION	COUNTY	TOTAL SHEETS	SHEET NO.
SRTS	10-00045-00-SW	MASSAC	12	12
DETAILS - BROOKPORT ELEMENTARY SIDEWALK RAMPS				
FEDERAL PROJECT NO. SRTS-4009(024)			CONTRACT NO. 99446	

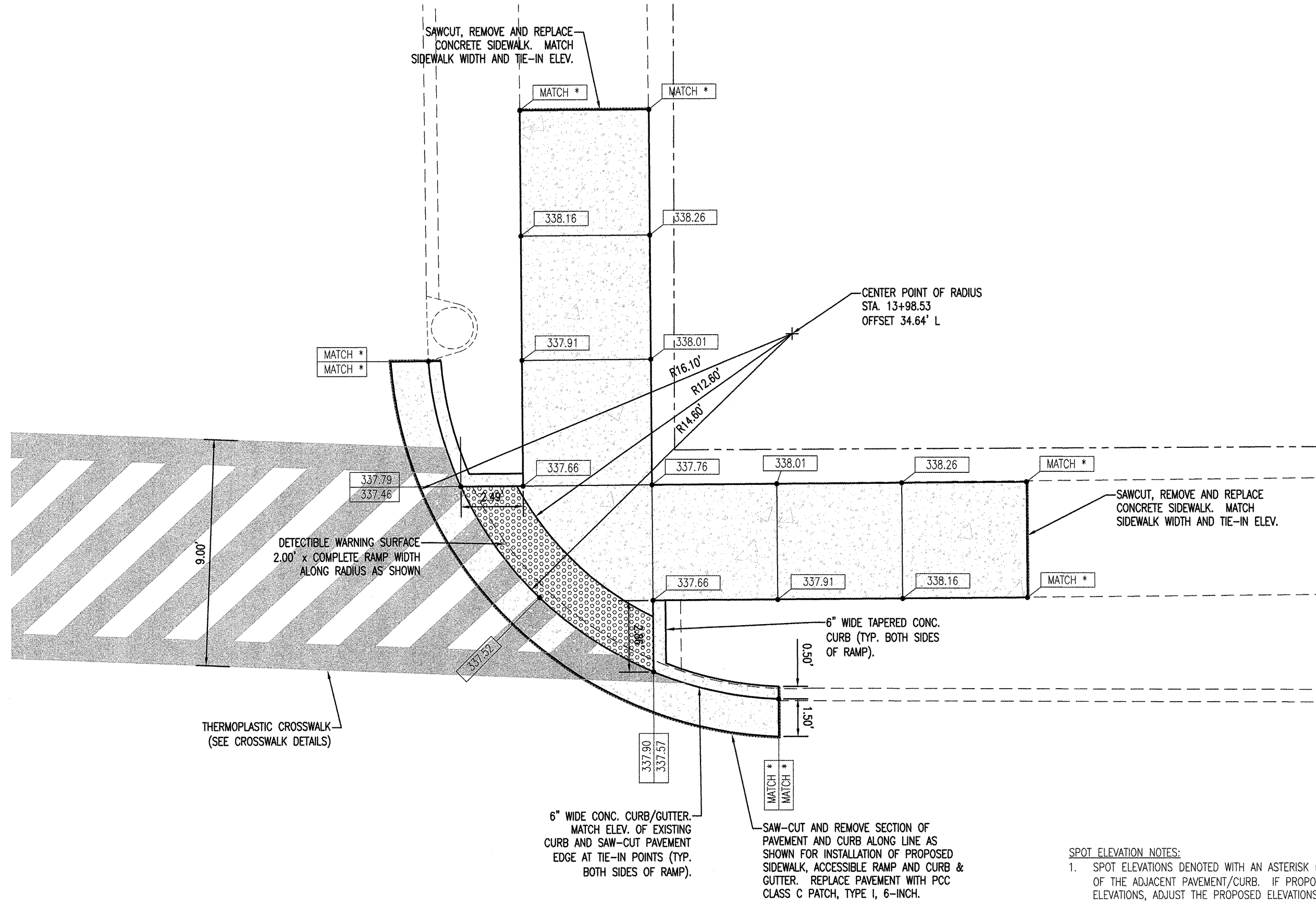

RAMP DETAIL - STA. 13+85.23 TO 14+07.88

SCALE: 1/4" = 1'

SPOT ELEVATION NOTES:

1. SPOT ELEVATIONS DENOTED WITH AN ASTERISK (*) MUST MATCH THE EXISTING ELEVATIONS OF THE ADJACENT PAVEMENT/CURB. IF PROPOSED ELEVATIONS VARY FROM THE EXISTING ELEVATIONS, ADJUST THE PROPOSED ELEVATIONS TO MATCH. CONTRACTOR MUST NOTIFY ENGINEER OF ANY DISCREPANCIES PRIOR TO CONSTRUCTION OF ANY PROPOSED ITEMS.
2. SINGLE SPOT ELEVATIONS DENOTE ELEVATION ON PAVEMENT SURFACE AND FLUSH ADJOINING SURFACE. DOUBLE SPOT ELEVATIONS DENOTE ELEVATION ON PAVEMENT SURFACE AND ADJACENT SIDEWALK OR CURB VERTICAL RISE/DROP.