

F.A. RTE.	SECTION	COUNTY	TOTAL SHEETS	SHEET NO.
317	(94 - 16H)BR	-	9	1
		ILLINOIS	CONTRACT NO. 68G28	

INDEX OF SHEETS

- 1 COVER SHEET
- 2 COMMITMENTS/JOB SPECIFIC NOTES
- 3 SUMMARY OF QUANTITIES
- 4 SCHEDULE OF QUANTITIES
- 5-6 LINE DIAGRAMS
- 7-9 CADD STANDARD

STATE OF ILLINOIS
DEPARTMENT OF TRANSPORTATION

PROPOSED HIGHWAY PLANS

FAP ROUTE 317 (US 24/IL 9), FAP ROUTE 669 (IL 29)
SECTION : (46-1, 11) CJS
PROJECT NHPP-4DLB(391)
TYPE OF IMPROVEMENT : PAVEMENT PRESERVATION
PEORIA & TAZEWELL COUNTIES

D-94-030-21

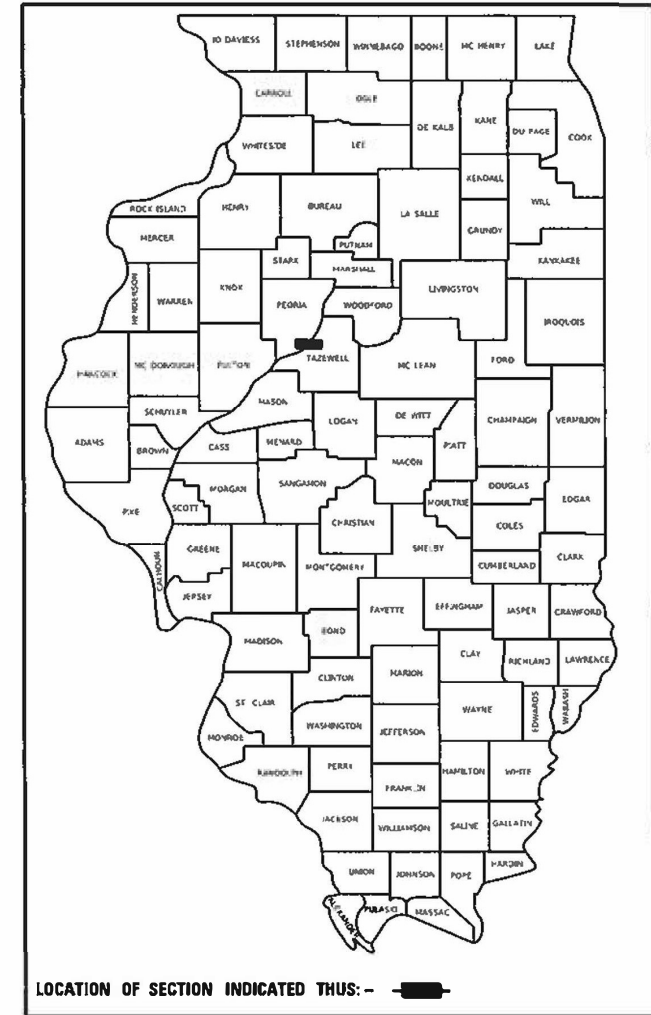

PROJECT DESCRIPTION
CRACK & JOINT SEALING ON US 24/IL 9 FROM N OF PFEIFFER RD IN BARTONVILLE TO 0.16MI SW OF IL 9(E) AND ON IL 29 FROM MARGARET DRIVE IN CREVE COEUR TO N OF LASALLE BLVD IN MARQUETTE HEIGHT

STATE OF ILLINOIS
DEPARTMENT OF TRANSPORTATION

SUBMITTED December 1, 2021
[Signature]
REGIONAL ENGINEER

February 4, 2022
[Signature]
ENGINEER OF DESIGN AND ENVIRONMENT

February 4, 2022
[Signature]
DIRECTOR OF HIGHWAYS PROJECT IMPLEMENTATION

**PRINTED BY THE AUTHORITY
OF THE STATE OF ILLINOIS**

HIGHWAY STANDARDS

- 701426-09
- 701427-05
- 701601-09
- 701602-10
- 701701-10
- 701901-08
- 701411-09

DISTRICT STANDARDS

- 452001
- 780001



C-94-049-21

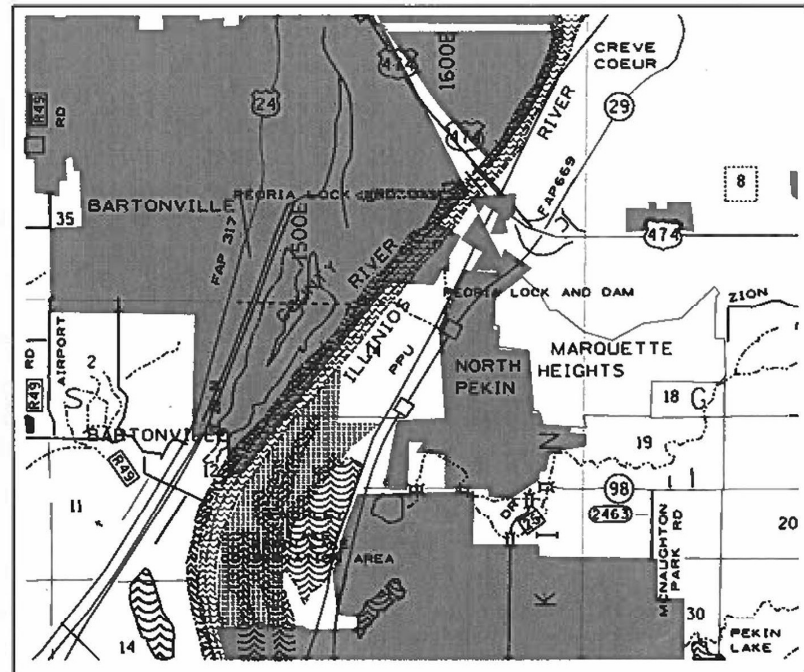

GROSS LENGTH = NA
NET LENGTH = NA

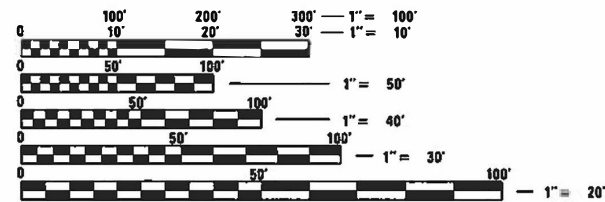

FULL SIZE PLANS HAVE BEEN PREPARED USING STANDARD ENGINEERING SCALES. REDUCED SIZED PLANS WILL NOT CONFORM TO STANDARD SCALES. IN MAKING MEASUREMENTS ON REDUCED PLANS, THE ABOVE SCALES MAY BE USED.

J.U.L.I.E.
JOINT UTILITY LOCATION INFORMATION FOR EXCAVATORS
1-800-892-0123
OR 811

PROJECT ENGINEER: RICHARD DOTSON (309) 671-3455
PROJECT MANAGER: MICHAEL JACOBS (309) 671-3460

CATALOG NO. 036194-00D
CONTRACT NO. 68G28

COMMITMENTS

COMMITMENTS ARE NOT TO BE ALTERED WITHOUT THE WRITTEN CONSENT OF ALL PARTIES TO WHICH THE COMMITMENT WAS MADE

NO COMMITMENTS HAVE BEEN MADE FOR THIS PROJECT.

JOB SPECIFIC NOTES

CARE SHALL BE EXERCISED TO KEEP SEALANT OFF EXISTING PAVEMENT MARKINGS. SEE NOTE ⑥ IN DISTRICT CADD STANDARD 452001-D4 (INCLUDED IN PLANS) REGARDING HOW TO TREAT CRACKS NEAR OR IN PAVEMENT MARKINGS. NOTIFY THE BUREAU OF OPERATION PRIOR TO APPLYING THE PAVEMENT MARKING:
 BILL HARRMANN 309-693-5173 (EAST) OR
 DARRYL HOLMES 309-693-5176 (WEST)

ALL DIRT AND DEBRIS CREATED BY THE ROUTING OPERATION SHALL BE CLEANED FROM THE PAVEMENT AND PAVED SHOULDERS AT THE END OF THE DAY'S OPERATIONS ACCORDING TO ARTICLE 107.15 OF THE STANDARD SPECIFICATIONS.

LOCATIONS FOR PROPOSED "CRACK ROUTING AND FILLING" ARE NUMBERED BY PRIORITY. LOCATIONS SHALL BE COMPLETED IN THIS ORDER ONLY.

LOCATION 1: US 24
 NORTHBOUND LANES: NO LANE CLOSURES BEFORE 8:30 AM
 SOUTHBOUND LANES: NO LANE CLOSURES AFTER 3:30 PM

LOCATION 2: IL 29
 NORTHBOUND LANES: NO LANE CLOSURES BEFORE 8:30 AM
 SOUTHBOUND LANES: NO LANE CLOSURES AFTER 3:30 PM

MODEL: Default
 FILE NAME: p:\118801.pw\hcnlvey.com\p\118801\Documents\118801\DOT_Offices\District_4\Projects\118801_4857\118801\CAD\DigitalCAD\hcnlvey\118801\118801.dgn

* FAP 317.693.669 *TAEWELL & PEORIA

STATE OF ILLINOIS
 DEPARTMENT OF TRANSPORTATION

COMMITMENTS/JOB SPECIFIC NOTES

F A RTE	SECTION	COUNTY	TOTAL SHEETS	SHEET NO.
*	146 - 1, III CJS	*	9	2
			CONTRACT NO. 68G28	
ILLINOIS FED. AID PROJECT				

SCALE: SHEET OF SHEETS STA. TO STA.

CODE NO.	ITEM	UNIT	TOTAL QUANTITY	CONST. CODE	
				80% FEDERAL	80% FEDERAL
				20% STATE	20% STATE
				PEORIA	TAZEWELL
				0005	0005
67100100	MOBILIZATION	L SUM	1	0.5	0.5
70107025	CHANGEABLE MESSAGE SIGN	CALDA	10	5	5
* 78009004	MODIFIED URETHANE PAVEMENT MARKING LINE 4"	FOOT	122907	105890	17017
* 78009006	MODIFIED URETHANE PAVEMENT MARKING LINE 6"	FOOT	15680	11870	3810
* 78009008	MODIFIED URETHANE PAVEMENT MARKING LINE 8"	FOOT	8,779	5948	2831
X4510100	CRACK ROUTING AND FILLING	POUND	86857	64274	22583
X7010216	TRAFFIC CONTROL AND PROTECTION (SPECIAL)	L SUM	1	0.5	0.5

URBAN

* = SPECIALTY ITEM

FILE NAME : p:\11\dot-pw.bentley.com\PM1001\Documents\1100T_Drfices\District 4\Projects\04_68028\DRAWN\CAD\sheet\C4xxxxx\sh-co-or.dgn	USER NAME : ja-isa-	DESIGNED -	REVISED -	STATE OF ILLINOIS DEPARTMENT OF TRANSPORTATION	SUMMARY OF QUANTITIES	- FAP 317,623,659	• TAZEWELL & PEORIA				
	PLOT SCALE : 1/4" = 1' - 0" / in.	CHECKED -	REVISED -				F.R.T.E.	SECTION	COUNTY	TOTAL SHEETS	SHEET NO.
	PLOT DATE : 11/30/2021	DATE -	REVISED -				.	146 - 1, 111 CJS	.	9	3

CONTRACT NO. 68G28
ILLINOIS FED. AID PROJECT

CRACK ROUTING AND FILLING			POUND
	ROUTE	LOCATION	
PEORIA COUNTY			
LOCATION 1	US 24/IL9	FROM N OF PFEIFFER RD IN BARTONVILLE TO 0.16 MI SW OF IL9 E	64274
TAZEWELL COUNTY			
LOCATION 2	IL 29	FROM MARGARET DRIVE IN CREVE COEUR TO N OF LASALLE BLVD IN MARQUETTE HEIGHTS	22583
GRAND TOTAL			86857

MODIFIED URETHANE PAVEMENT MARKINGS								
STATION	TO	STATION	LENGTH	WHITE	YELLOW		WHITE	WHITE
				LINE 4"	LINE 4"	DOUBLE 4"	LINE 6"	LINE 8"
				(FOOT)	FOOT		(FOOT)	(FOOT)
PEORIA COUNTY								
US24								
75+37	to	79+80	443	0	0	1248	222	228
79+80	to	81+84	204	0	0	230	50	1170
81+84	to	84+63	279	0	0	914	140	102
84+63	to	88+57	394	0	0	1442	198	0
88+57	to	115+00	2643	0	0	5286	1322	0
115+00	to	117+85	285	100	0	472	142	65
117+85	to	123+08	523	523	0	2092	262	0
123+73	to	128+87	514	944	0	2056	258	0
128+87	to	131+32	245	488	0	860	122	112
131+32	to	157+97	2665	5330	0	9880	1332	0
157+97	to	163+36	539	1057	0	1838	270	222
163+36	to	206+47	4311	8622	0	17108	2156	0
206+47	to	239+74	3327	6367	0	12292	1664	987
239+74	to	267+77	2803	5606	0	11084	1402	0
267+77	to	277+58	981	1845	0	3500	1718	927
277+58	to	290+63	1305	2182	2524	0	612	2135
				33064	2524	70302	11870	5948
PEORIA COUNTY SUBTOTAL				105890		11870		5948
TAZEWELL COUNTY								
IL 29								
180+54	to	231+76		6364	9987	666	3810	2831
TAZEWELL COUNTY SUBTOTAL				17017		3810		2831
TOTAL				122907		15680		8779

CHANGEABLE MESSAGE SIGN	
LOCATION	CAL DA
TAZEWELL	5
PEORIA	5
TOTAL	10

TRAFFIC CONTROL AND PROTECTION (SPRCIAL)	
LOCATION	L SUM
TAZEWELL	0.5
PEORIA	0.5
TOTAL	1

MOBILIZATION	
LOCATION	L SUM
TAZEWELL	0.5
PEORIA	0.5
TOTAL	1

US 24
IMPROVEMENT BEGINS
STA. 75+37

US 24
IMPROVEMENT ENDS
STA. 290+63

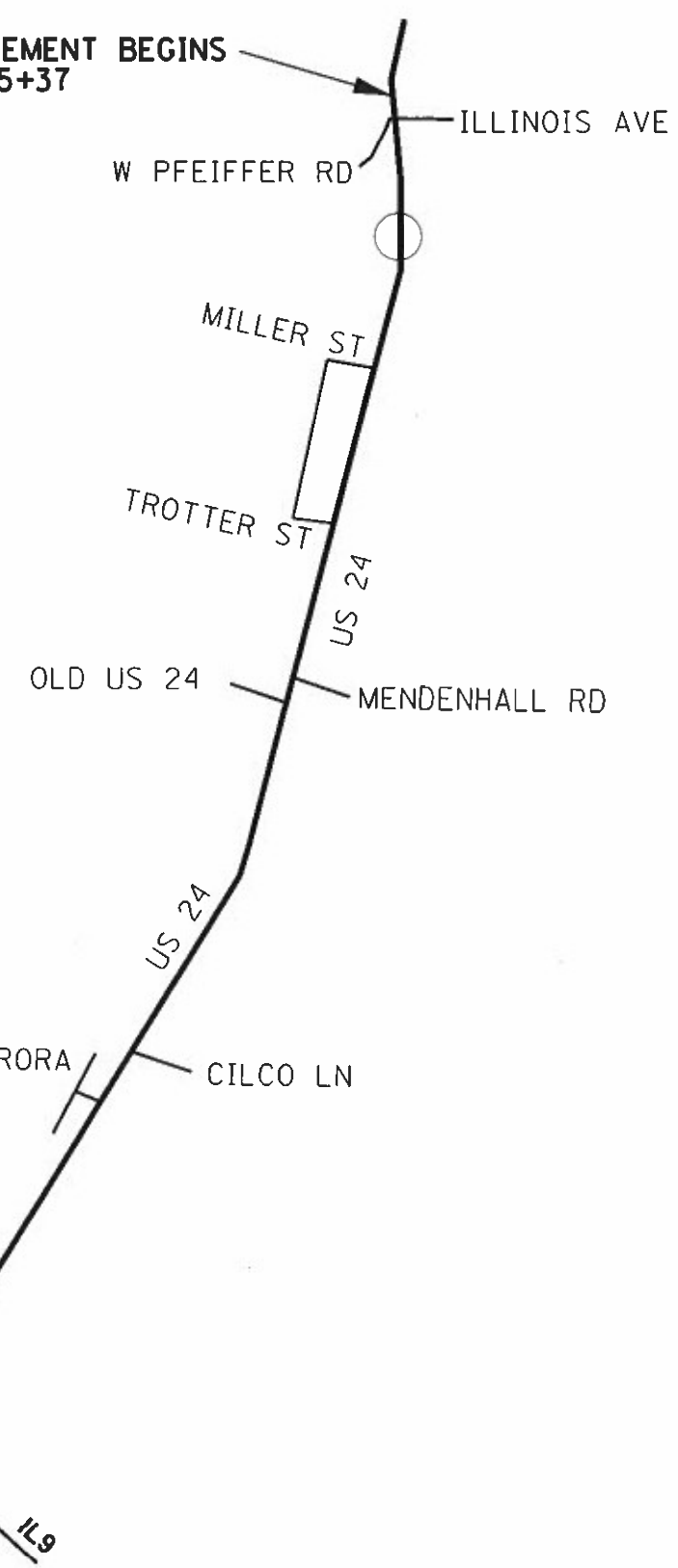

NOT TO
SCALE

DRAWING NOT TO SCALE

FILE NAME :	USER NAME :	DESIGNED :	REVISED :	STATE OF ILLINOIS DEPARTMENT OF TRANSPORTATION	LINE DIAGRAM LOCATION 1 (US 24 /IL 9)			F.A.P.	SECTION	COUNTY	TOTAL SHEETS	SHEET NO.
pe:\ildot\p-bentley.com\PI000\Documents\1001 Offices\District 4\Projects\04.68C28	pe\1001 Offices\District 4\Projects\04.68C28	DRAWN :	REVISED :					.	(46 - 1, 11) CJS	.	9	5
Default		CHECKED :	REVISED :		CONTRACT NO. 68C28			ILLINOIS FED. AID PROJECT				
		DATE :	REVISED :		SCALE:	SHEET	OF	SHEETS	STA.	TO STA.		

FAP 317,693,669

TAEWELL & PEORIA

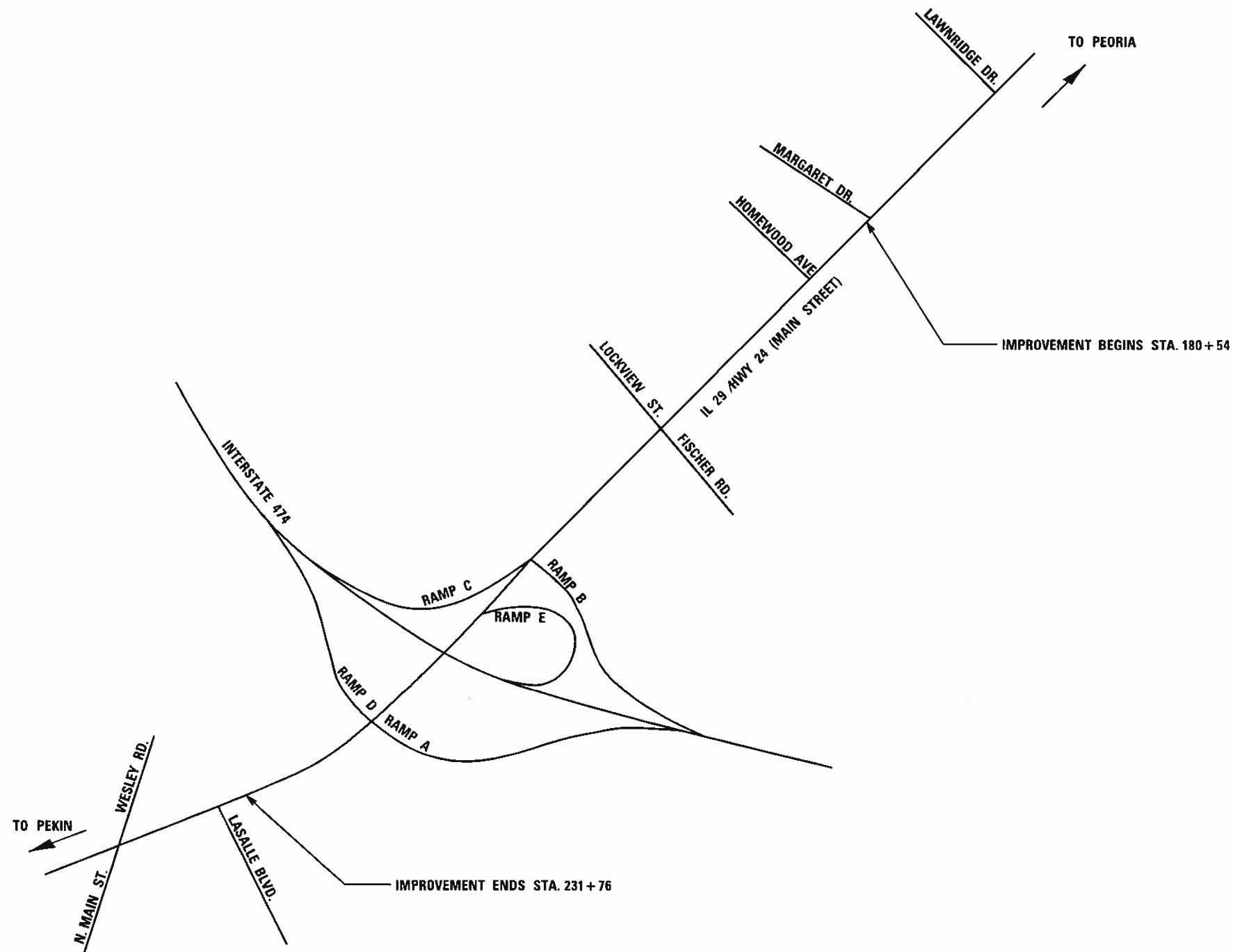

DRAWING NOT TO SCALE

FILE NAME :	USER NAME :	DESIGNED :	REVISED :
p:\dot\p-bentlay.com\FWIDOT\Documents\DOT Offices\District 4\Projects\04.68028-	lewsor	ORAWN	REVISED :
PLLOT SCALE :	CHECKED :	DATE :	REVISED :
100.0011" = 1"		11/9/2021	

**STATE OF ILLINOIS
DEPARTMENT OF TRANSPORTATION**

LINE DIAGRAM LOCATION 2 (IL 29)

SHEET OF SHEETS STA. TO STA.

F.A.P. RTE.		SECTION	COUNTY	TOTAL SHEETS	SHEET NO.
.		46 - 1, 111 CJS	.	9	6
CONTRACT NO. 68G28				ILLINOIS FED. AID PROJECT	

FAP 317,693,669 TAZEVELL & PEORIA

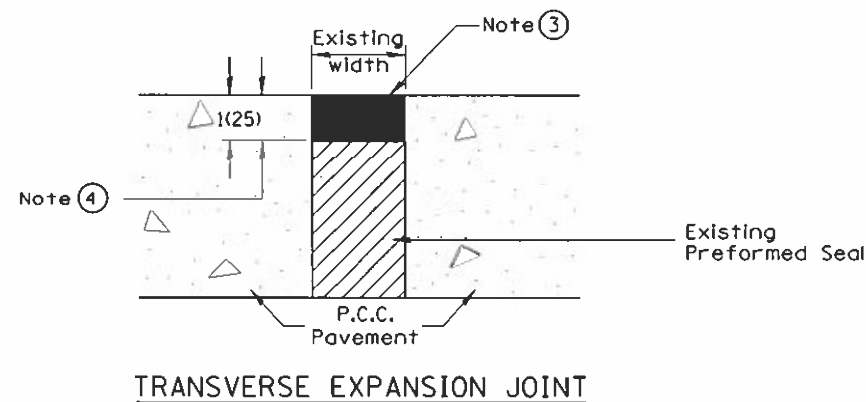
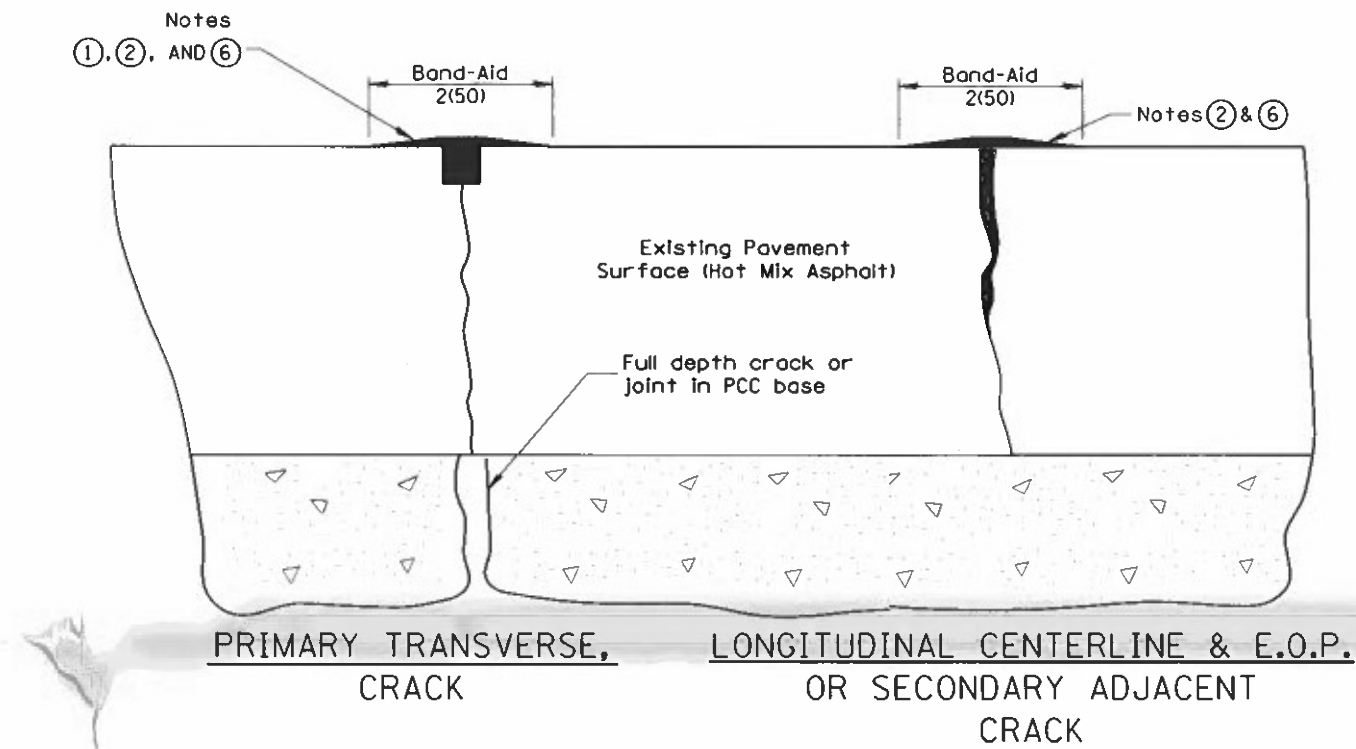

NOTES

- ① Route or saw to $\frac{3}{4}(20)$ wide by $\frac{3}{4}(20)$ deep; (1:1 ratio).
- ② Overfill with sealant; squeegee to provide 2 (50) wide flush "band-aid" effect; feather edges flush.
- ③ Seal flush without "band-aid" effect.
- ④ Route to 1(25) depth; clean and reface walls.
- ⑤ Crack and Joint Sealing shall conform to Section 451 and 452
- ⑥ The "Band Aid" width shall be reduced or eliminated in areas adjacent to existing pavement markings as directed by the Engineer.

All dimensions are in inches (millimeters) unless otherwise noted.

01-01-97	RENUM. C-36.01, NEW REVISE BOX	T.P.	01-05-21	REVISED	R.D.
05-01-97	REVISED	E.T.			
10-16-06	REVISED TO 2007 SPEC.	M.A.			
01-01-17	REVISED	R.D.			

STATE OF ILLINOIS
DEPARTMENT OF TRANSPORTATION

CRACK AND JOINT SEALING

NOT TO SCALE

CADD STD. 452001-D4

F.A. RTE.		SECTION	COUNTY	TOTAL SHEETS	SHEET NO.
VAR.		446 - L 111 CJS		9	7
				CONTRACT NO. 68628	
FED. ROAD DIST. NO.		ILLINOIS FED. AID PROJECT			

FAP 317,693,669

TAEWELL & PEORIA

DESIGNER NOTES:

1. Include State Standard 780001 (Typical Pavement Markings)

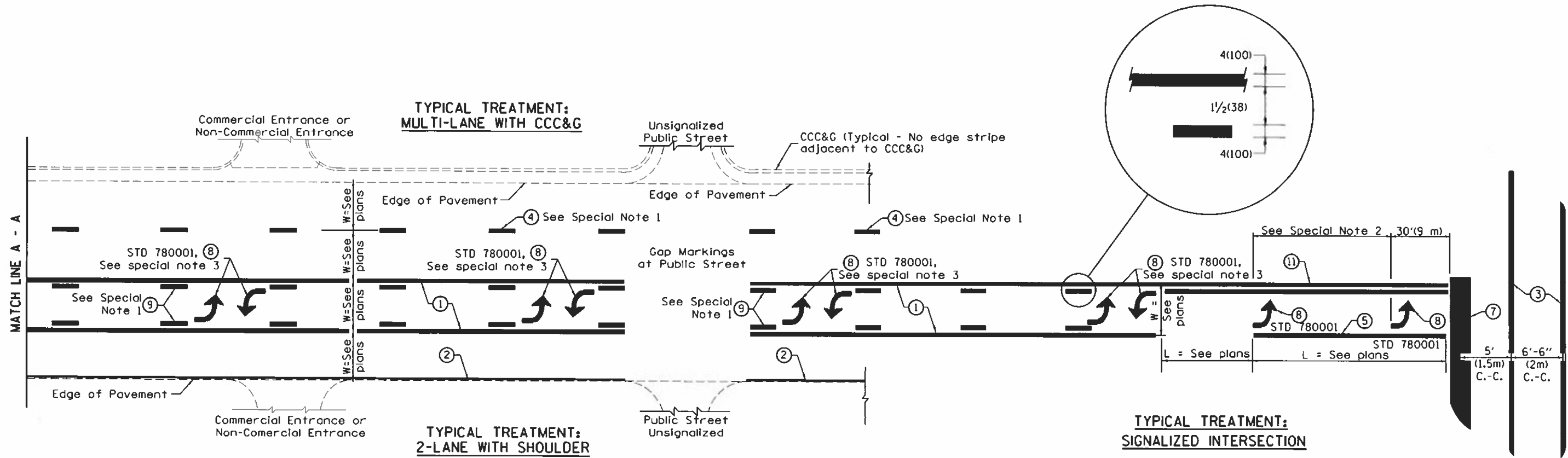

FLUSH PAVED MEDIAN: TWO-WAY LEFT TURN LANE WITH ONE-WAY LEFT TURN LANE AT SIGNALIZED INTERSECTION

TYPICAL PAVEMENT MARKING LEGEND

(Note: This is a District Standard Legend. Some elements may not apply to specific project.)

- ① 4(100) Solid (Yellow)
- ② 4(100) Solid (White)
- ③ 2-6(150) Crosswalk ■ 6'-6" (2m)min C.-C. (White)
2-8(200) Crosswalk ■ 6'-6" (2m)min C.-C. (White) (When traffic signals are present.)
- ④ 6(150) Skip-Dash (White) (See Special Note 1)
- ⑤ 8(200) Solid (White)
- ⑥ 12(300) Diagonal (White) (Item ⑥ is shown on Std. 780001)
- ⑦ 24(600) Stop Bar (White)
- ⑧ Letters & Arrows (See Std. 780001 and Special Notes 2 & 3)
- ⑨ 4(100) Skip-Dash (Yellow) (See Special Note 1)
- ⑩ 12(300) Diagonal (Yellow) (See Table A) 45°
- ⑪ 4(100) Double Solid (Yellow) 11(280) C.-C. See Table A

SPECIAL NOTES

1. Skip-Dash markings will be centered between both ends of city blocks and shall be placed in alignment transversely across the pavement.
2. The following shall apply to arrows located in one-way left turn lanes:
 - A. A minimum of two (2) arrows is required.
 - B. The maximum spacing between arrows is 80' (24 m).
 - C. Arrows shall be evenly spaced if three (3) or more are required.
3. The following shall apply to arrow pairs located in two-way left turn lanes:
 - A. A minimum of two (2) arrow pairs is required.
 - B. The maximum spacing between arrow pairs is 200' (61 m).
 - C. Arrow pairs shall be evenly spaced if three (3) or more are required.
 - D. The spacing between Bi Directional Left Turn Arrows is 33' (10 m).

GENERAL NOTES

1. Refer to State Standard 780001 for additional Pavement Markings including letters & arrows.
2. See Plans for Pavement Markings adjacent to curbed islands and medians, and through lane reductions.
3. Refer to Article 780.13 for letter, number and symbol areas (sq. ft.)
4. Areas are grooved 1" beyond each edge for the following symbols:
Through Arrow= 14.8 sq. ft.
Large Left or Right Arrow= 21.9 sq. ft.
2 Arrow Combination Left (or Right) and Through= 34.9 sq. ft.
Wrong Way Arrow= 29.5 sq. ft.
Railroad Crossing Symbol= 69.8 sq. ft.
(For further information, refer to BDE Special Provision: Grooving for Recessed Pavement Markings)

All dimensions are in inches (millimeters) unless otherwise noted.

01-01-97	RENUM. F-8.03, NEW REVISION BOX	T.P.	10-16-06	REVISED TO 2007 SPEC.	
02-07-97	ADD BI DIRECTIONAL DIMENSION	J.A.	2/29/16	ADDED GROOVING AREAS	R.D.
10-97	CORRECT BI DIRECTIONAL DIMENSION	J.A.	07-16-19	SPELLING CORRECTIONS	R.D.
08-02	ADD CROSSWALK DIMS. WITH T.S.	M.A.			

**STATE OF ILLINOIS
DEPARTMENT OF TRANSPORTATION**

TYPICAL PAVEMENT MARKINGS

NOT TO SCALE

SHT. 1 OF 2
CADD STD. 780001-D4

* FAP 317,693,669		* TAZEWELL & PEORIA	
F.A. RTE.	SECTION	COUNTY	TOTAL SHEETS
	146 - 1, 111 CJS		9
			SHEET NO. 8
			CONTRACT NO. 68G28
FED. ROAD DIST. NO. [ILLINOIS] FED. AID PROJECT			

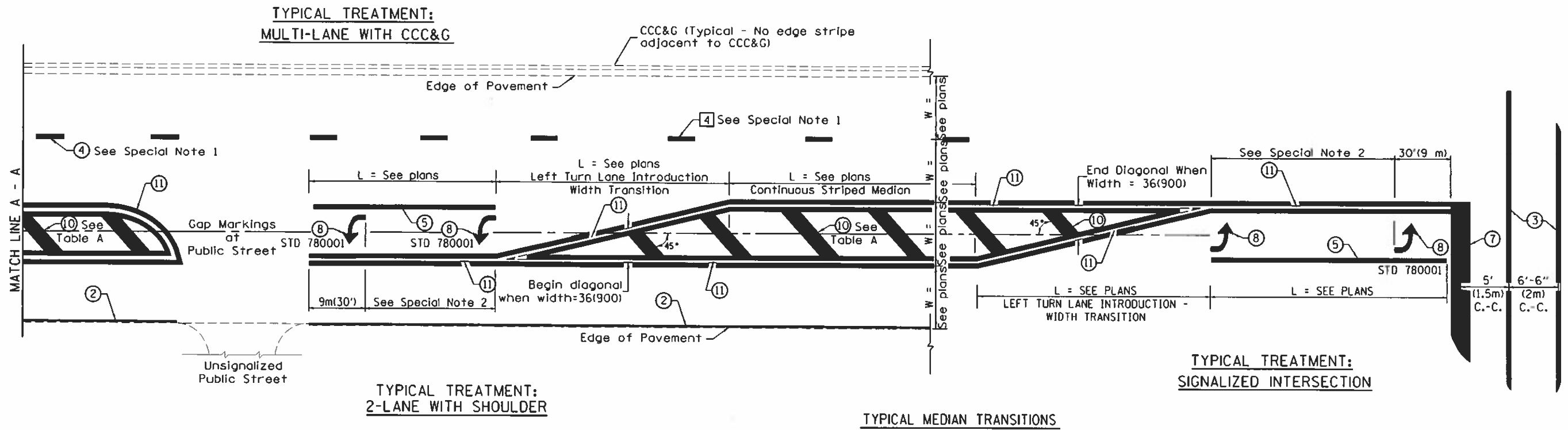

FLUSH PAVED MEDIAN: RESTRICTED LEFT TURN LANE

TABLE A
RECOMMENDED SPACING BETWEEN DIAGONAL LINES

SPEED LIMIT RANGE	INTERSECTION CHANNELIZATION (Includes Width Transitions for Median and Left Turn Lane Introductions)	
	CONTINUOUS	
Less Than 30 mph (50 km/h)	50' (15m)	15' (5m)
30 - 45 mph (50 - 70 km/h)	75' (23m)	20' (6m)
Over 45 mph (70 km/h)	150' (46m)	30' (9m)

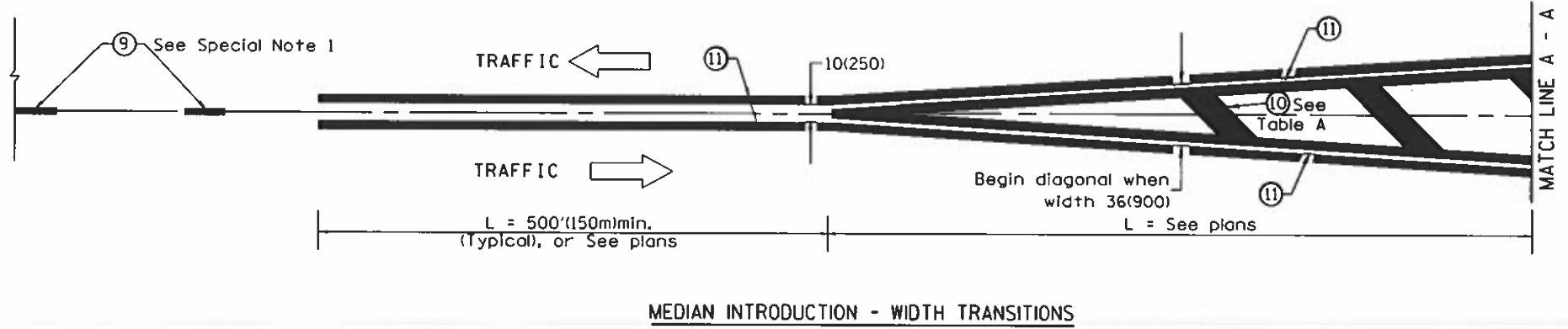

All dimensions are in inches (millimeters) unless otherwise noted.