

STATE OF ILLINOIS
DEPARTMENT OF TRANSPORTATION

F.A.P. RTE.	SECTION	COUNTY	TOTAL SHEETS	SHEET NO.
762	(1,2)RS-4	MOULTRIE	36*	1
		ILLINOIS	CONTRACT NO. 74964	

*36 + 1 = 37 TOTAL SHEETS

FOR INDEX OF SHEETS, SEE SHEET NO. 2

AADT (2022) = 3150

STATION EQUATION

STA. 340+96.00 BK = STA. 341+00.00 AH

PROPOSED HIGHWAY PLANS

FAP ROUTE 762 (IL 32)
SECTION (1,2)RS-4
PROJECT STP-M88M(400)
RESURFACING
MOULTRIE COUNTY

C-97-042-20



OMISSION STARTS
STA. 285 + 93

PROJECT BEGINS
STA. 267 + 60

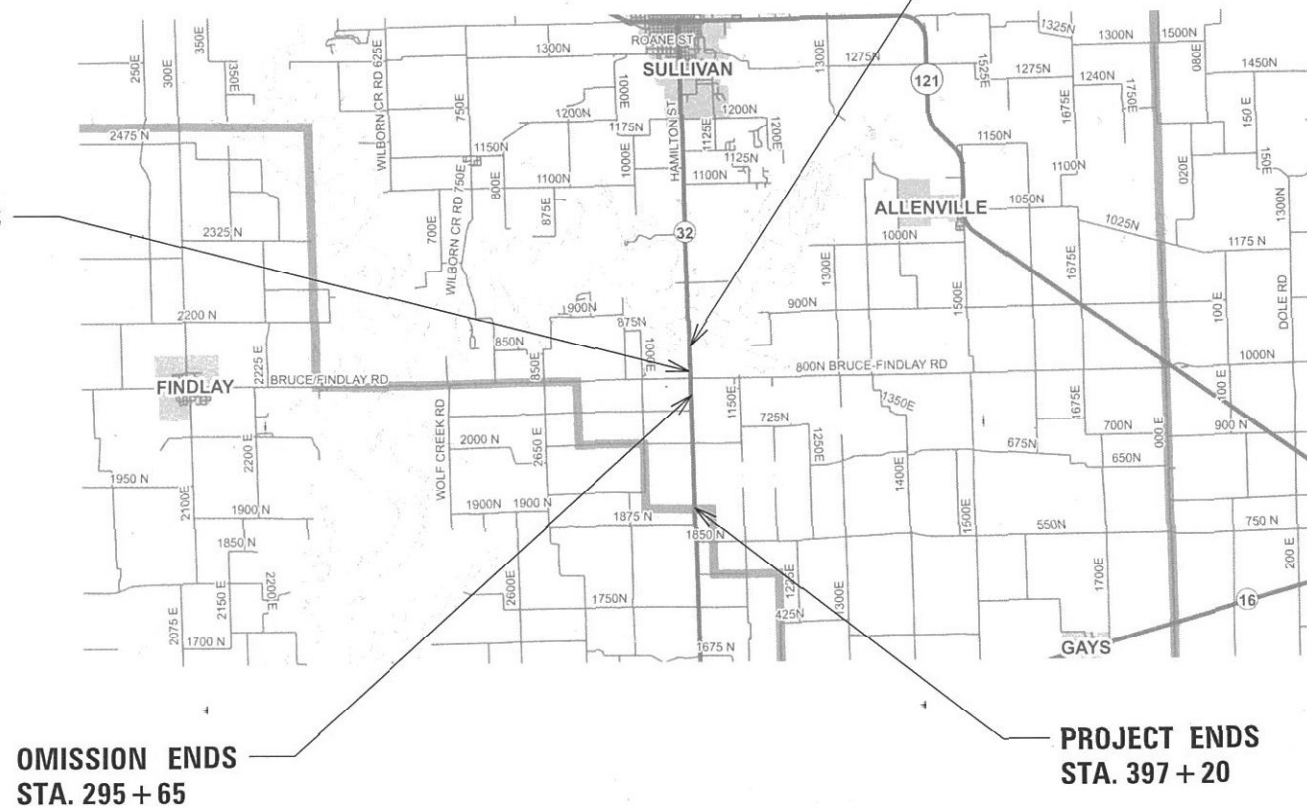

OMISSION ENDS
STA. 295 + 65

PROJECT ENDS
STA. 397 + 20

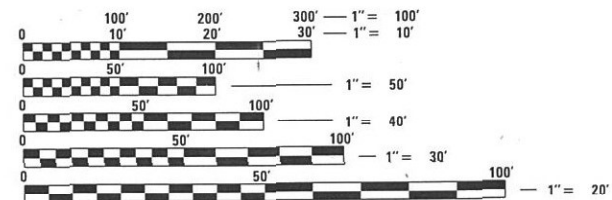

FULL SIZE PLANS HAVE BEEN PREPARED USING STANDARD ENGINEERING SCALES. REDUCED SIZED PLANS WILL NOT CONFORM TO STANDARD SCALES. IN MAKING MEASUREMENTS ON REDUCED PLANS, THE ABOVE SCALES MAY BE USED.

J.U.L.I.E.
JOINT UTILITY LOCATION INFORMATION FOR EXCAVATORS
1-800-892-0123
OR 811

PROJECT ENGINEER: DEBRA G. BARRETT
PROJECT MANAGER: DEBRA G. BARRETT

GROSS LENGTH = 11,984.00 FT. = 2.27 MILES
NET LENGTH = 11,984.00 FT. = 2.27 MILES

CONTRACT NO. 74964

STATE OF ILLINOIS
DEPARTMENT OF TRANSPORTATION

SUBMITTED November 29, 2021
Jeffrey P. Myrberg
REGIONAL ENGINEER

February 4, 2022
[Signature]
ENGINEER OF DESIGN AND ENVIRONMENT

February 4, 2022
Stephen M. Smith
DIRECTOR OF HIGHWAYS PROJECT IMPLEMENTATION

PRINTED BY THE AUTHORITY
OF THE STATE OF ILLINOIS

GENERAL NOTES

THE WORK IN THIS SECTION INCLUDES MILLING AND RESURFACING THE EXISTING PAVEMENT, AGGREGATE SHOULDERS, RUMBLE STRIPS, PAINT PAVEMENT MARKINGS, RAISED REFLECTIVE PAVEMENT MARKERS, AND ANY OTHER WORK NECESSARY TO COMPLETE THIS SECTION.

THE WORK INCLUDED IN THIS SECTION IS LOCATED ON IL 32, FROM 0.4 MILE NORTH TO 0.1 MILE NORTH OF BRUCE-FINDLAY ROAD, AND 0.1 MILE SOUTH OF BRUCE-FINDLAY ROAD TO THE SHELBY COUNTY LINE.

THE RESIDENT ENGINEER SHALL BE THE SOLE JUDGE CONCERNING THE CURING TIME FOR THE HMA SURFACE COURSE.

MILLED PAVEMENT SHALL BE RESURFACED WITH BINDER WITHIN 5 CALENDAR DAYS.

MATERIAL FOR AGGREGATE WEDGE SHOULDER, TYPE B SHALL BE CRUSHED STONE, CRUSHED CONCRETE OR RAP.

MATERIAL FOR AGGREGATE SURFACE COURSE, TYPE B SHALL BE CRUSHED STONE, OR CRUSHED CONCRETE.

WHEN APPLYING SHORT TERM PAVEMENT MARKINGS, TEMPORARY TAPE SHALL BE USED ON THE SURFACE AND PAINT SHALL BE USED ON THE MILLED AND BINDER SURFACES.

QUANTITY FOR THERMOPLASTIC PAVEMENT MARKING - LETTERS AND SYMBOLS CONSISTS OF 100 SQUARE FEET OF WHITE.

QUANTITY FOR PAINT PAVEMENT MARKING - LINE 4" CONSISTS OF 4,166 FEET OF YELLOW, AND 23,956 FEET OF WHITE.

THE FOLLOWING MIXTURE REQUIREMENTS ARE APPLICABLE TO THIS PROJECT:

APPLICATION	PG	DESIGN AIR VOIDS	MIXTURE COMPOSITION	FRICTION AGGREGATE	MIXTURE WEIGHT	QUALITY MGMT PROGRAM	SUBLOT SIZE	MATERIAL TRANSFER DEV
HMA SURFACE COURSE, MIX "C", N70 (1 1/2")	PG 64-22	4.0% @ N=70	IL - 9.5	MIXTURE C	112 LB/SQ YD/IN	QC/QA	N/A	NO
HMA BINDER COURSE, IL-9.5FG, N70 (1 1/4")	PG 64-22	4.0% @ N=70	IL - 9.5FG	N/A	112 LB/SQ YD/IN	QC/QA	N/A	NO
INCIDENTAL HMA SURFACE COURSE	PG 64-22	4.0% @ N=70	IL - 9.5	MIXTURE C	112 LB/SQ YD/IN	QC/QA	N/A	NO
CLASS D PATCHING	PG 64-22	4.0% @ N=70	IL - 19.0	N/A	112 LB/SQ YD/IN	QC/QA	N/A	NO

INDEX OF SHEETS

SHEET NO.	ITEM
1	COVER SHEET
2	GENERAL NOTES, INDEX OF SHEETS & LIST OF STANDARDS
3-4	SUMMARY OF QUANTITIES
5-6	TYPICAL CROSS SECTIONS
7-8	SCHEDULES OF QUANTITIES
9-30	PLAN SHEETS
31-36A	DETAILS

THE FOLLOWING STANDARDS ARE A PART OF THESE PLANS AND ARE INCLUDED FOLLOWING THE LAST NUMBERED SHEET OF THE PLANS.

STD. NO.	DESCRIPTION
000001-08	STANDARD SYMBOLS, ABBREVIATIONS, AND PATTERNS
001006	DECIMAL OF AN INCH AND OF A FOOT
442201-03	CLASS C AND D PATCHES
701001-02	OFF-ROAD OPERATIONS, 2L, 2W, MORE THAN 15' (4.5 M) AWAY
701006-05	OFF-ROAD OPERATIONS, 2L, 2W, 15' (4.5 M) TO 24" (600 MM) FROM PAVEMENT EDGE
701011-04	OFF-ROAD MOVING OPERATIONS, 2L, 2W, DAY ONLY
701201-05	LANE CLOSURE, 2L, 2W, DAY ONLY, FOR SPEEDS > 45 MPH
701301-04	LANE CLOSURE, 2L, 2W, SHORT TIME OPERATIONS
701306-04	LANE CLOSURE, 2L, 2W, SLOW MOVING OPERATIONS DAY ONLY, FOR SPEEDS > 45 MPH
701311-03	LANE CLOSURE, 2L, 2W, MOVING OPERATIONS - DAY ONLY
701901-08	TRAFFIC CONTROL DEVICES
780001-05	TYPICAL PAVEMENT MARKINGS
781001-04	TYPICAL APPLICATIONS RAISED RELECTIVE PAVEMENT MARKERS
667101-02	PERMANENT SURVEY MARKERS
668001-01	U.S. GEOLOGICAL SURVEY AND NATIONAL GEODETIC SURVEY BENCHMARKS, RESETTING METHOD

REV. - MS

MODEL NAME: MAMES
FILE NAME: 811E13

USER NAME = SUSERS	DESIGNED -	REVISED -	STATE OF ILLINOIS DEPARTMENT OF TRANSPORTATION	GENERAL NOTES, INDEX OF SHEETS & LIST OF STANDARDS			F.A.P. RTE.	SECTION	COUNTY	TOTAL SHEETS	SHEET NO.
DRAWN -	REVISIED -	762					(1,2)RS-4	MOULTRIE	36	2	
PLOT SCALE = SCALES	CHECKED -	REVISIED -		SCALE:			SHEET 1 OF 1 SHEETS		STA.	TO STA.	
PLOT DATE = SDATES	DATE -	REVISIED -							ILLINOIS	FED. AID PROJECT	

80% FED
20% STATE

80% FED
20% STATE

SUMMARY OF QUANTITIES			TOTAL QUANTITIES	CONSTRUCTION TYPE CODE		
CODE NO	ITEM	UNIT		0005		
40600290	BITUMINOUS MATERIALS (TACK COAT)	POUND	22435	22435		
40600370	LONGITUDINAL JOINT SEALANT	FOOT	12034	12034		
40600982	HOT-MIX ASPHALT SURFACE REMOVAL - BUTT JOINT	SO YD	136	136		
40600990	TEMPORARY RAMP	SO YD	235	235		
40602970	HOT-MIX ASPHALT BINDER COURSE, IL-9.5FG, N70	TON	2327	2327		
40604052	HOT-MIX ASPHALT SURFACE COURSE, IL-9.5, MIX "C", N70	TON	2792	2792		
40800029	BITUMINOUS MATERIALS (TACK COAT)	POUND	312	312		
40800050	INCIDENTAL HOT-MIX ASPHALT SURFACING	TON	58	58		
44000155	HOT-MIX ASPHALT SURFACE REMOVAL, 1 1/2"	SO YD	30209	30209		
44000160	HOT-MIX ASPHALT SURFACE REMOVAL, 2 3/4"	SO YD	2892	2892		
44201785	CLASS D PATCHES, TYPE I, 12 INCH	SO YD	4	4		
44201789	CLASS D PATCHES, TYPE II, 12 INCH	SO YD	184	184		
44201851	CLASS D PATCHES, TYPE II, 17 INCH	SO YD	918	918		

SUMMARY OF QUANTITIES			TOTAL QUANTITIES	CONSTRUCTION TYPE CODE		
CODE NO	ITEM	UNIT		0005		
44201855	CLASS D PATCHES, TYPE III, 17 INCH	SO YD	92	92		
44201857	CLASS D PATCHES, TYPE IV, 17 INCH	SO YD	33	33		
48102100	AGGREGATE WEDGE SHOULDER, TYPE B	TON	1066	1066		
66700205	PERMANENT SURVEY MARKERS, TYPE I	EACH	1	1		
67100100	MOBILIZATION	L SUM	1	1		
70100450	TRAFFIC CONTROL AND PROTECTION, STANDARD 701201	L SUM	1	1		
70100460	TRAFFIC CONTROL AND PROTECTION, STANDARD 701306	L SUM	1	1		
70107025	CHANGEABLE MESSAGE SIGN	CAL DA	28	28		
70300100	SHORT TERM PAVEMENT MARKING	FOOT	3282	3282		
70300150	SHORT TERM PAVEMENT MARKING REMOVAL	SO FT	365	365		
70300211	TEMPORARY PAVEMENT MARKING LETTERS AND SYMBOLS - PAINT	SO FT	100	100		
70300221	TEMPORARY PAVEMENT MARKING - LINE 4"- PAINT	FOOT	28122	28122		

REV. - MS

MODEL: Default
 FILE: M:\MSA\p\blidct-cw_bentley.com\FWIDOT\Documents\DOT_Offices\District_7\Projects\74964\CADD\Drawings\CAD\Sheets\DOT74964-sh-SC00.dgn

USER NAME = steffenmk	DESIGNED -	REVISED -
	DRAWN -	REVISED -
PLOT SCALE = 100.0000' / in.	CHECKED -	REVISED -
PLOT DATE = 11/29/2021	DATE -	REVISED -

**STATE OF ILLINOIS
DEPARTMENT OF TRANSPORTATION**

SUMMARY OF QUANTITIES

SCALE: SHEET 1 OF 2 SHEETS STA. TO STA.

F.A.P. RTE.	SECTION	COUNTY	TOTAL SHEETS	SHEET NO.
762	(1,2)RS-4	MOULTRIE	36	3
CONTRACT NO. 74964			ILLINOIS FED. AID PROJECT	

PROPOSED TYPICAL CROSS SECTIONS

STATION 267+60 TO STATION 271+00

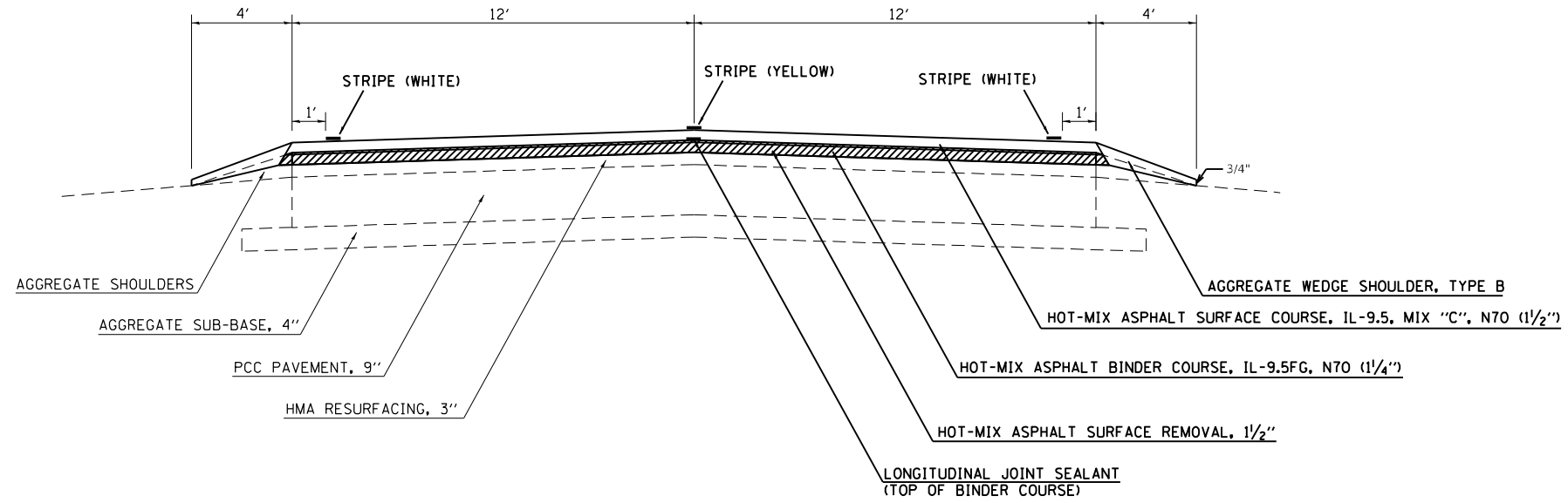

STATION 271+00 TO STATION 280+47
STATION 301+14 TO STATION 397+20

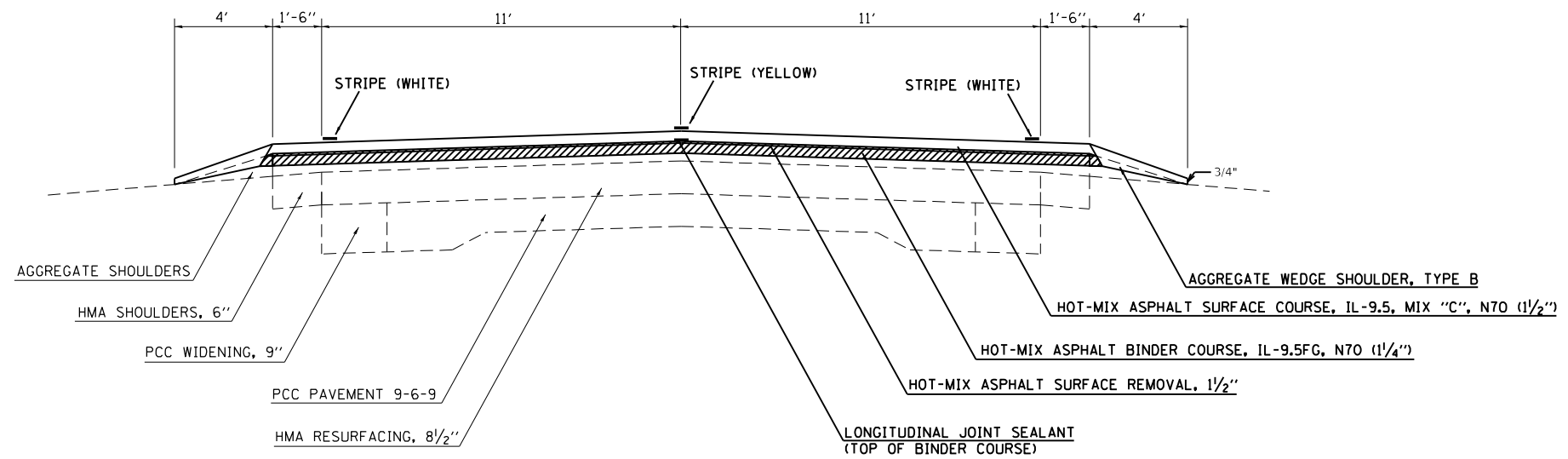

MODEL: Default
 FILE: \\mfe-pw-bentley.com\PW\DOT\Documents\DOT_offices\Dir\dir_7\Project\74964\CADD\Drawn\CAD\Sheets\0774964-1-11-21\typical.dgn

USER NAME = steffenmk	DESIGNED -	REVISED -
	DRAWN -	REVISED -
PLOT SCALE = 100,0000' / in.	CHECKED -	REVISED -
PLOT DATE = 11/29/2021	DATE -	REVISED -

**STATE OF ILLINOIS
DEPARTMENT OF TRANSPORTATION**

TYPICAL CROSS SECTIONS

SCALE: SHEET 1 OF 2 SHEETS STA. TO STA.

F.A.P. RTE.	SECTION	COUNTY	TOTAL SHEETS	SHEET NO.
762	(1,2)RS-4	MOULTRIE	36	5
CONTRACT NO. 74964				
ILLINOIS FED. AID PROJECT				

PROPOSED TYPICAL CROSS SECTIONS

STATION 280+47 TO STATION 285+93
STATION 295+65 TO STATION 301+14

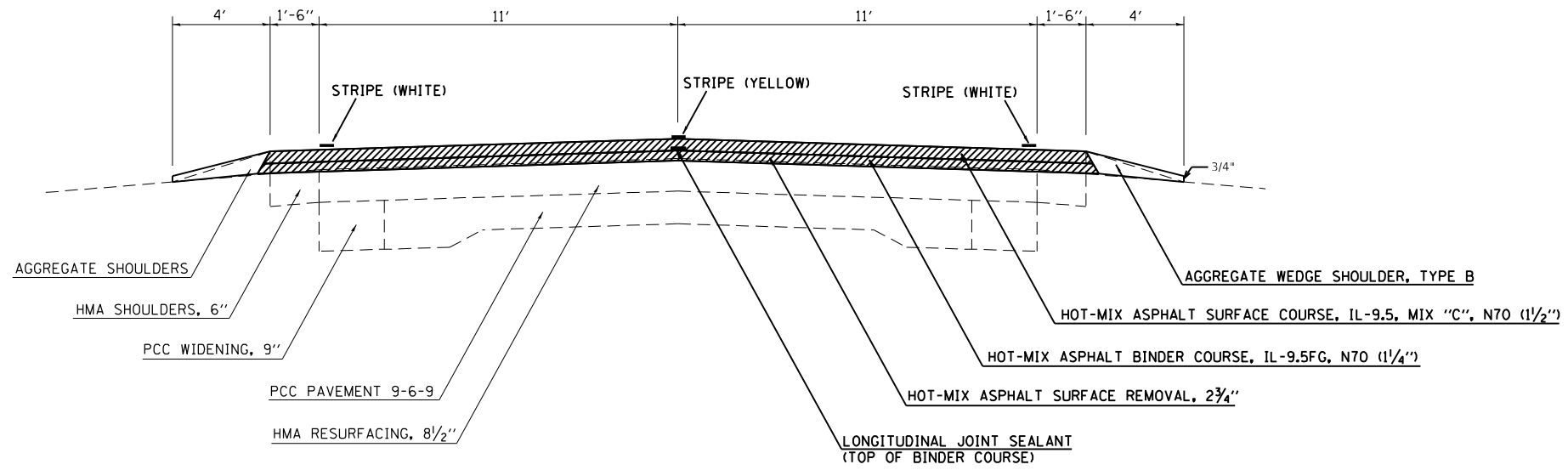

MODEL: Default
 FILE NAME: p:\project-aw-bead\paw.com\p\w\DOT\Documents\DOT Office\District 7\Project\74964\CADD\Drawings\CAD\Sheets\0774964-Left-Typical.dgn

USER NAME = steffenmk	DESIGNED -	REVISED -
	DRAWN -	REVISED -
PLOT SCALE = 100,0000' / in.	CHECKED -	REVISED -
PLOT DATE = 11/29/2021	DATE -	REVISED -

**STATE OF ILLINOIS
DEPARTMENT OF TRANSPORTATION**

TYPICAL CROSS SECTIONS

SCALE: SHEET 2 OF 2 SHEETS STA. TO STA.

F.A.P. RTE.	SECTION	COUNTY	TOTAL SHEETS	SHEET NO.
762	(1,2)RS-4	MOULTRIE	36	6
CONTRACT NO. 74964				
ILLINOIS FED. AID PROJECT				

PAVING SCHEDULE

STATION	TO	STATION	LENGTH (FEET)	PAVEMENT WIDTH (FEET)	PAVEMENT AREA (SQ YD)	SHOULDER WIDTH (FEET)	SHOULDER AREA (SQ YD)	HOT-MIX ASPHALT SURFACE REMOVAL - BUTT JOINT (SQ YD)	TEMPORARY RAMP (SQ YD)	BITUMINOUS MATERIALS (TACK COAT) (POUND)	HOT-MIX ASPHALT SURFACE REMOVAL, 1 1/2" (SQ YD)	HOT-MIX ASPHALT SURFACE REMOVAL, 2 3/4" (SQ YD)	HOT-MIX ASPHALT BINDER COURSE, IL-9.5FG, N70 (TON)	HOT-MIX ASPHALT SURFACE COURSE, IL-9.5, MIX "C", N70 (TON)	AGGREGATE WEDGE SHOULDER, TYPE B (TON)	LONGITUDINAL JOINT SEALANT (FOOT)
267+35.00	TO	267+60.00	25	24	67	4	11	67	24	45			5	6	2	25
267+60.00	TO	271+00.00	340	24	907	4	151			612	907		63	76	30	340
271+00.00	TO	280+47.00	947	25	2631	4	421			1776	2631		184	221	84	947
280+47.00	TO	280+72.00	25	25	69	4	11		13	47		69	5	6	2	25
280+72.00	TO	280+99.00	27	25	75	4	12		27	25		38	3	3	2	27
280+99.00	TO	285+66.00	467	25	1297	4	208		26	876	1297		91	109	41	467
285+66.00	TO	285+93.00	27	25	75	4	12		27	25		38	3	3	2	27
295+65.00	TO	295+92.00	27	25	75	4	12		27	25		38	3	3	2	27
295+92.00	TO	300+62.00	470	25	1306	4	209		26	881	1306		91	110	42	470
300+62.00	TO	300+89.00	27	25	75	4	12		27	25		38	3	3	2	27
300+89.00	TO	301+14.00	25	25	69	4	11		13	47		69	5	6	2	25
301+14.00	TO	340+96.00	3982	25	11061	4	1770			7466	11061		774	929	353	3982
340+96 (BK)	=	341+00 (AH)														
341+00.00	TO	397+20.00	5620	25	15611	4	2498			10538	15611		1093	1311	498	5620
397+20.00	TO	397+45.00	25	25	69	4	11	69	25	47			5	6	2	25
TOTALS =								136	235	22435	30209	2892	2327	2792	1066	12034

ENTRANCE SCHEDULE

LT/RT	STATION	TYPE	PAVEMENT AREA (SQ YD)	INCIDENTAL HOT-MIX ASPHALT SURFACING (TON)	BITUMINOUS MATERIALS (TACK COAT) (POUND)	SURFACE REMOVAL, VARIABLE DEPTH (SPECIAL) (SQ YD)	TEMPORARY RAMP, SPECIAL (SQ YD)
LT	272+00	FE	29	2.5	13	29	
RT	272+00	CE	78	6.5	35	78	
RT	277+75	FE	27	2.2	12	27	
LT	278+25	FE	22	1.9	10	22	
LT	282+50	FE	27	2.3	12	27	8
RT	298+19	PE/MBTO	62	5.2	28	62	20
RT	299+20	PE	32	2.7	14	32	8
LT	304+15	FE	17	1.4	8	17	
RT	317+24	PRA	64	5.4	29	64	9
LT	317+48	FE	18	1.5	8	18	
LT	321+08	FE	16	1.3	7	16	
LT	330+75	FE	16	1.3	7	16	
RT	330+75	FE	17	1.4	8	17	
LT	343+55	PRA	32	2.7	15	32	8
RT	343+74	PRA	44	3.7	20	44	8
LT	346+35	FE	46	3.8	21	46	
LT	348+91	FE	15	1.3	7	15	
LT	357+20	FE	17	1.4	8	17	
RT	370+48	FE	13	1.1	6	13	
LT	383+77	FE	14	1.2	6	14	
LT	395+74	FL/MBTO	44	3.7	20	44	
RT	395+74	PE	29	2.5	13	29	
RT	397+00	FE	17	1.4	8	17	
TOTALS =				58	312	694	61

PAVEMENT MARKING SCHEDULE

STATION	TO	STATION	LENGTH (FEET)	SHORT TERM PAVEMENT MARKING (FEET)	SHORT TERM PAVEMENT MARKING REMOVAL (SQ FT)	TEMPORARY PAVEMENT MARKING - LINE 4" - PAINT (WHITE - SOLID) (FEET)	TEMPORARY PAVEMENT MARKING - LINE 4" - PAINT (YELLOW - SOLID) (FEET)	TEMPORARY PAVEMENT MARKING - LINE 4" - PAINT (YELLOW - SKIP) (FEET)	PAINT PAVEMENT MARKING - LINE 4" (WHITE - SOLID) (FEET)	PAINT PAVEMENT MARKING, LINE 4" (YELLOW - SOLID) (FEET)	PAINT PAVEMENT MARKING, LINE 4" (YELLOW - SKIP) (FEET)	RAISED REFLECTIVE PAVEMENT MARKER (EACH)	RAISED REFLECTIVE PAVEMENT MARKER REMOVAL (EACH)
267+35.00	TO	285+93.00	1858	507	56	3716	512	465	3716	512	465	23	23
295+65.00	TO	340+96.00	4531	1236	137	9022	645	1133	9022	645	1133	57	57
340+96 (BK)	=	341+00 (AH)											
341+00.00	TO	397+45.00	5645	1540	171	11218		1411	11218		1411	71	71
TOTALS =						23956	4166	3009	23956	4166		151	151

SURVEY MARKERS SCHEDULE

POINT #	DESCRIPTION	STATION	NORTHING	EASTING	PERMANENT SURVEY MARKERS, TYPE I EACH	PROTECTING OR RESETTING SURVEY MARKERS EACH	SURVEY MARKER VAULT EACH
102	PT	295+95.26	1038991.639	906626.518	1	1	
103	PI	317+42.00	1036846.035	906648.175		1	1
TOTALS =					1	2	1

PAVEMENT MARKING SCHEDULE - LETTERS & SYMBOLS

STATION	DESC	AREA (SQ FT)	TEMPORARY PAVEMENT MARKING LETTERS AND SYMBOLS - PAINT (SQ FT)	THERMOPLASTIC PAVEMENT MARKING - LETTERS AND SYMBOLS (SQ FT)	GROOVING FOR RECESSED PAVEMENT MARKING, LETTERS AND SYMBOLS (SQ FT)
SB 282+47.00	"STOP"	20.8	20.8	20.8	42.7
SB 282+97.00	"AHEAD"	29.0	29.0	29.0	53.1
NB 298+64.00	"AHEAD"	29.0	29.0	29.0	53.1
NB 299+14.00	"STOP"	20.8	20.8	20.8	42.7
TOTALS =		100	100	100	192

STATE OF ILLINOIS
DEPARTMENT OF TRANSPORTATION

SCHEDULES OF QUANTITIES

SCALE: SHEET 1 OF 2 SHEETS STA. TO STA.

F.A.P. RTE.	SECTION	COUNTY	TOTAL SHEETS	SHEET NO.
762	(1,2)RS-4	MOULTRIE	36	7
CONTRACT NO. 74964				
ILLINOIS FED. AID PROJECT				

PATCHING SCHEDULE

PATCH NO.	LANE	STATION	LENGTH	WIDTH	CLASS D	CLASS D	CLASS D	CLASS D	CLASS D	CLASS D	CLASS D	
					PATCHES, TYPE I, 12"	PATCHES, TYPE II, 12"	PATCHES, TYPE III, 12"	PATCHES, TYPE IV, 12"	PATCHES, TYPE I, 17"	PATCHES, TYPE II, 17"	PATCHES, TYPE III, 17"	PATCHES, TYPE IV, 17"
			(FEET)	(FEET)	(SQ YD)	(SQ YD)	(SQ YD)	(SQ YD)	(SQ YD)	(SQ YD)	(SQ YD)	
1	SB	267+45	7.0	12.0		9.3						
2	SB	267+68	6.0	12.0		8.0						
3	SB	267+92	8.0	12.0		10.7						
4	SB	268+51	6.0	12.0		8.0						
5	SB	268+78	10.0	6.0		6.7						
6	SB	268+96	6.0	12.0		8.0						
7	SB	269+10	6.0	6.0	4.0							
8	SB	270+11	6.0	12.0		8.0						
9	SB	271+08	6.0	12.5					8.3			
10	SB	276+11	7.0	12.5					9.7			
11	SR	276+88	6.0	12.5					8.3			
12	SB	279+33	6.0	12.5					8.3			
13	SB	279+98	6.0	12.5					8.3			
14	SB	280+87	6.0	12.5					8.3			
15	SB	282+77	6.0	12.5					8.3			
16	SB	283+84	6.0	12.5					8.3			
17	SB	284+63	6.0	12.5					8.3			
18	SB	296+19	6.0	12.5					8.3			
19	SB	297+60	6.0	12.5					8.3			
20	SB	299+05	6.0	12.5					8.3			
21	SB	301+15	7.0	12.5					9.7			
22	SB	302+11	6.0	12.5					8.3			
23	SB	302+43	6.0	12.5					8.3			
24	SB	305+07	8.0	12.5					11.1			
25	SB	306+92	11.0	12.5						15.3		
26	SB	308+29	6.0	12.5					8.3			
27	SB	308+65	6.0	12.5					8.3			
28	SB	311+58	8.0	12.5					11.1			
29	SB	312+20	6.0	12.5					8.3			
30	SB	313+32	6.0	12.5					8.3			
31	SB	313+57	6.0	12.5					8.3			
32	SB	313+80	6.0	12.5					8.3			
33	SB	315+90	11.0	12.5						15.3		
34	SB	317+12	6.0	12.5					8.3			
35	SB	317+68	6.0	12.5					8.3			
36	SB	319+47	6.0	12.5					8.3			
37	SB	320+77	8.0	12.5					11.1			
38	SB	321+39	6.0	12.5					8.3			
39	SB	323+08	6.0	12.5					8.3			
40	SB	324+70	6.0	12.5					8.3			
41	SB	325+88	8.0	12.5					11.1			
42	SB	327+22	6.0	12.5					8.3			
43	SB	329+38	6.0	12.5					8.3			
44	SB	330+16	6.0	12.5					8.3			
45	SB	330+74	8.0	12.5					11.1			
46	SB	331+05	50.0	6.0						33.3		
47	SB	331+93	6.0	12.5					8.3			
48	SB	335+33	6.0	12.5					8.3			
49	SB	336+25	6.0	12.5					8.3			
50	SB	338+14	6.0	12.5					8.3			
51	SB	338+88	6.0	12.5					8.3			
52	SB	340+16	6.0	12.5					8.3			
53	SB	348+80	6.0	12.5					8.3			
54	SB	349+76	7.0	12.5					9.7			
55	SB	351+05	8.0	12.5					11.1			
56	SB	356+03	6.0	12.5					8.3			
57	SB	356+86	6.0	12.5					8.3			
58	SB	360+22	6.0	12.5					8.3			
59	SB	364+35	6.0	12.5					8.3			
60	SB	366+02	11.0	12.5						15.3		
61	SB	369+34	8.0	12.5					11.1			
62	SB	375+21	6.0	12.5					8.3			
63	SB	377+16	7.0	12.5					9.7			
64	SB	380+46	11.0	12.5						15.3		
65	SB	384+44	6.0	12.5					8.3			
66	SB	386+61	6.0	12.5					8.3			
67	SB	389+81	8.0	12.5					11.1			
68	SB	392+46	6.0	12.5					8.3			
SB TOTALS =					4	59	0	0	0	485	61	33

PATCHING SCHEDULE

PATCH NO.	LANE	STATION	LENGTH	WIDTH	CLASS D	CLASS D	CLASS D	CLASS D	CLASS D	CLASS D	CLASS D	
					PATCHES, TYPE I, 12"	PATCHES, TYPE II, 12"	PATCHES, TYPE III, 12"	PATCHES, TYPE IV, 12"	PATCHES, TYPE I, 17"	PATCHES, TYPE II, 17"	PATCHES, TYPE III, 17"	PATCHES, TYPE IV, 17"
			(FEET)	(FEET)	(SQ YD)	(SQ YD)	(SQ YD)	(SQ YD)	(SQ YD)	(SQ YD)	(SQ YD)	
69	NB	394+68	6.0	12.5							8.3	
70	NB	392+49	6.0	12.5							8.3	
71	NB	390+51	8.0	12.5							11.1	
72	NB	389+84	6.0	12.5							8.3	
73	NB	384+57	6.0	12.5							8.3	
74	NB	380+57	11.0	12.5							15.3	
75	NB	377+21	7.0	12.5							9.7	
76	NB	375+27	6.0	12.5							8.3	
77	NB	373+46	6.0	12.5							8.3	
78	NB	371+54	6.0	12.5							8.3	
79	NB	371+00	6.0	12.5							8.3	
80	NB	369+39	7.0	12.5							9.7	
81	NB	366+06	11.0	12.5							15.3	
82	NB	364+40	6.0	12.5							8.3	
83	NB	360+31	7.0	12.5							9.7	
84	NB	358+19	6.0	12.5							8.3	
85	NB	356+89	6.0	12.5							8.3	
86	NB	356+08	6.0	12.5							8.3	
87	NB	354+15	7.0	12.5							9.7	
88	NB	351+07	6.0	12.5							8.3	
89	NB	349+84	6.0	12.5							8.3	
90	NB	348+88	6.0	12.5							8.3	
91	NB	343+94	6.0	12.5							8.3	
92	NB	340+16	6.0	12.5							8.3	
93	NB	338+96	6.0	12.5							8.3	
94	NB	338+23	6.0	12.5							8.3	
95	NB	336+34	6.0	12.5							8.3	
96	NB	335+40	6.0	12.5							8.3	
97	NB	332+00	6.0	12.5							8.3	
98	NB	331+91	6.0	12.5							8.3	
99	NB	329+45	6.0	12.5							8.3	
100	NB	327+29	6.0	12.5							8.3	
101	NB	323+17	6.0	12.5							8.3	
102	NB	321+47	6.0	12.5							8.3	
103	NB	319+54	6.0	12.5							8.3	
104	NB	317+68	6.0	12.5							8.3	
105	NB	317+12	6.0	12.5							8.3	
106	NB	311+59	8.0	12.5							11.1	
107	NB	308+68	6.0	12.5							8.3	
108	NB	306+97	8.0	12.5							11.1	
109	NB	305+10	7.0	12.5							9.7	
110	NB	302+15	7.0	12.5							9.7	
111	NB	301+18	6.0	12.5							8.3	
112	NB	299+19	6.0	12.5							8.3	
113	NB	297+75	6.0	12.5							8.3	
114	NB	296+60	6.0	12.5							8.3	
115	NB	284+52	6.0	12.5							8.3	
116	NB	282+65	6.0	12.5							8.3	
117	NB	281+14	6.0	12.5							8.3	
118	NB	279+37	6.0	12.5							8.3	
119	NB	276+17	6.0	12.5							8.3	
120	NB	271+33	7.0	12.5							9.7	
121	NB	270+75	7.0	12.0						9.3		
122	NB	270+37	6.0	12.0						8.0		
123	NB	269+68	6.0	12.0						8.0		
124	NB	269+60	6.0	12.0						8.0		
125	NB	269+20	20.0	6.0						13.3		
126	NB	269+10	7.0	12.0						9.3		
127	NB	268+88	6.0	12.0						8.0		
128	NB	268+71	20.0	6.0						13.3		
129	NB	268+30	8.0	12.0						10.7		
130	NB	268+05	9.0	12.0						12.0		
131	NB	267+91	7.0	12.0						9.3		
132	NB	267+73	6.0	12.0						8.0		
133	NB	267+45	6.0	12.0						8.0		
NB TOTALS =					0	125	0	0	0	433	31	0
TOTALS =					4	184	0	0	0	918	92	33

MODEL: Default
 FILE: \\mfc-pw-beadley.com\FW\DOT\Documents\DOT_Offices\Director_T\Projects\74964\CADD\Drawings\CADD\Drawings\DOT\74964-Left-Schedule.dgn

USER NAME = stefenmk	DESIGNED -	REVISED -
	DRAWN -	REVISED -
PLOT SCALE = 40,0000 * / in.	CHECKED -	REVISED -
PLOT DATE = 11/29/2021	DATE -	REVISED -

**STATE OF ILLINOIS
DEPARTMENT OF TRANSPORTATION**

SCHEDULES OF QUANTITIES

SCALE: SHEET 2 OF 2 SHEETS STA. TO STA.

F.A.P. RTE.	SECTION	COUNTY	TOTAL SHEETS	SHEET NO.
762	(1,2)RS-4	MOULTRIE	36	8
CONTRACT NO. 74964				
ILLINOIS FED. AID PROJECT				

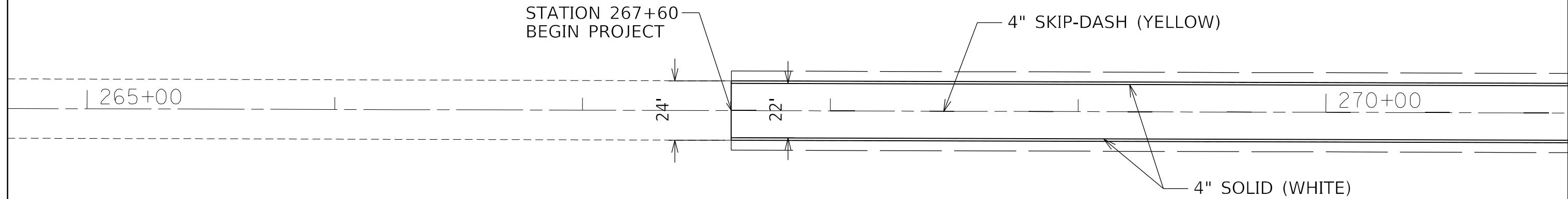
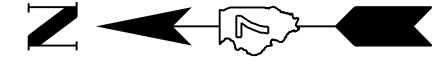

MODEL: Default
 FILE NAME: p:\ultra-cw-bead\p\com\PIV\DOT\Documents\DOT Office\Director_7\Project\74964\CADD\Drawings\CAD\Drawings\74964-Sub-dwg.dgn

USER NAME = steffenmk	DESIGNED -	REVISED -
	DRAWN -	REVISED -
PLOT SCALE = 40,0000 * / in.	CHECKED -	REVISED -
PLOT DATE = 11/29/2021	DATE -	REVISED -

**STATE OF ILLINOIS
DEPARTMENT OF TRANSPORTATION**

PLAN SHEETS

SCALE: SHEET OF SHEETS STA. TO STA.

F.A.P. RTE.	SECTION	COUNTY	TOTAL SHEETS	SHEET NO.
762	(1,2)RS-4	MOULTRIE	36	9
CONTRACT NO. 74964			ILLINOIS FED. AID PROJECT	



PAVT WIDTH = 25'
@ STA. 271+00

+00
FE

4" SKIP-DASH (YELLOW)

275+00

+00
CE

4" SOLID (WHITE)

MODEL: Default
 FILE NAME: p:\ultra-cw-bead\p\com\PIV\DOT\Documents\DOT Offices\District 7\Project\74964\CADD\Drawings\CAD\Sheets\74964-10.dwg

USER NAME = steffnmk	DESIGNED -	REVISED -
	DRAWN -	REVISED -
PLOT SCALE = 40,0000 * / in.	CHECKED -	REVISED -
PLOT DATE = 11/29/2021	DATE -	REVISED -

**STATE OF ILLINOIS
DEPARTMENT OF TRANSPORTATION**

PLAN SHEETS

SCALE: SHEET OF SHEETS STA. TO STA.

F.A.P. RTE.	SECTION	COUNTY	TOTAL SHEETS	SHEET NO.
762	(1,2)RS-4	MOULTRIE	36	10
ILLINOIS FED. AID PROJECT			CONTRACT NO. 74964	

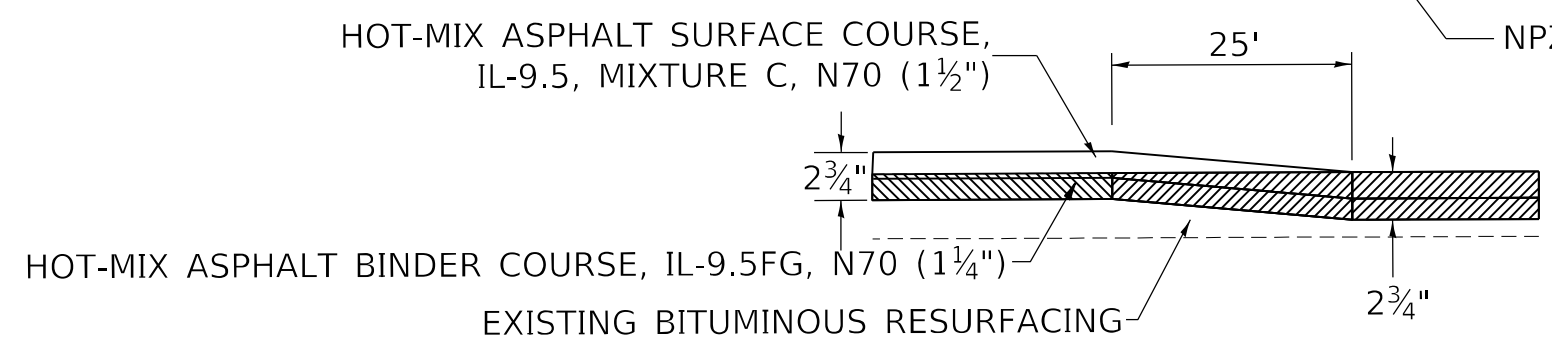
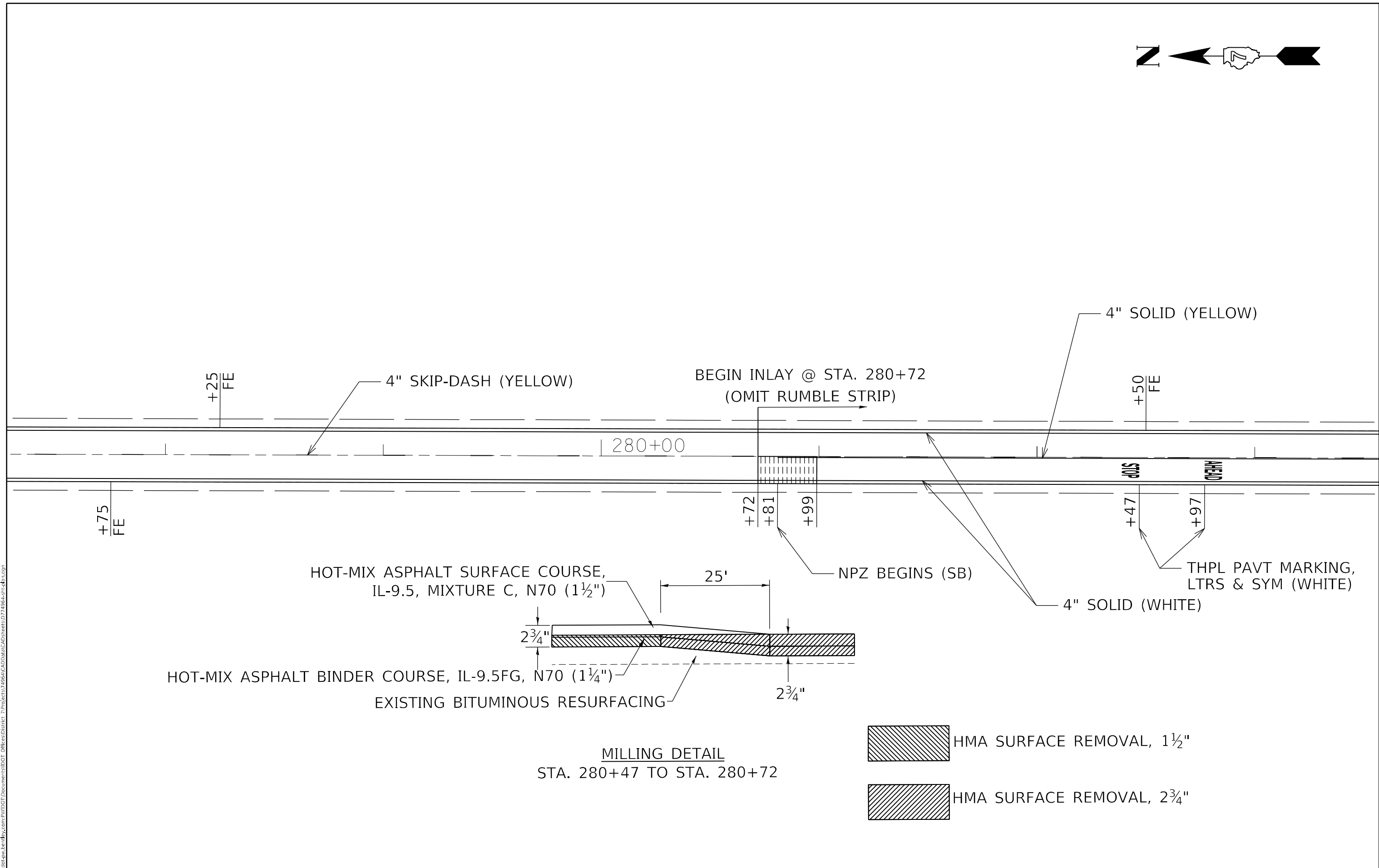

MILLING DETAIL
STA. 280+47 TO STA. 280+72

- HMA SURFACE REMOVAL, 1 1/2"
- HMA SURFACE REMOVAL, 2 3/4"

MODEL: Default
 FILE: \\mdepc-pw-bentley.com\P\DOT\Documents\DOT Office\Director_7\Projects\74964\CADD\Drawings\Drawings\74964-11.dwg
 PLOT DATE = 11/29/2021

USER NAME = steffenmk	DESIGNED -	REVISED -
	DRAWN -	REVISED -
PLOT SCALE = 40,0000 * / in.	CHECKED -	REVISED -
PLOT DATE = 11/29/2021	DATE -	REVISED -

**STATE OF ILLINOIS
DEPARTMENT OF TRANSPORTATION**

PLAN SHEETS			
SCALE:	SHEET	OF SHEETS	STA. TO STA.

F.A.P. RTE.	SECTION	COUNTY	TOTAL SHEETS	SHEET NO.
762	(1,2)RS-4	MOULTRIE	36	11
CONTRACT NO. 74964			ILLINOIS FED. AID PROJECT	

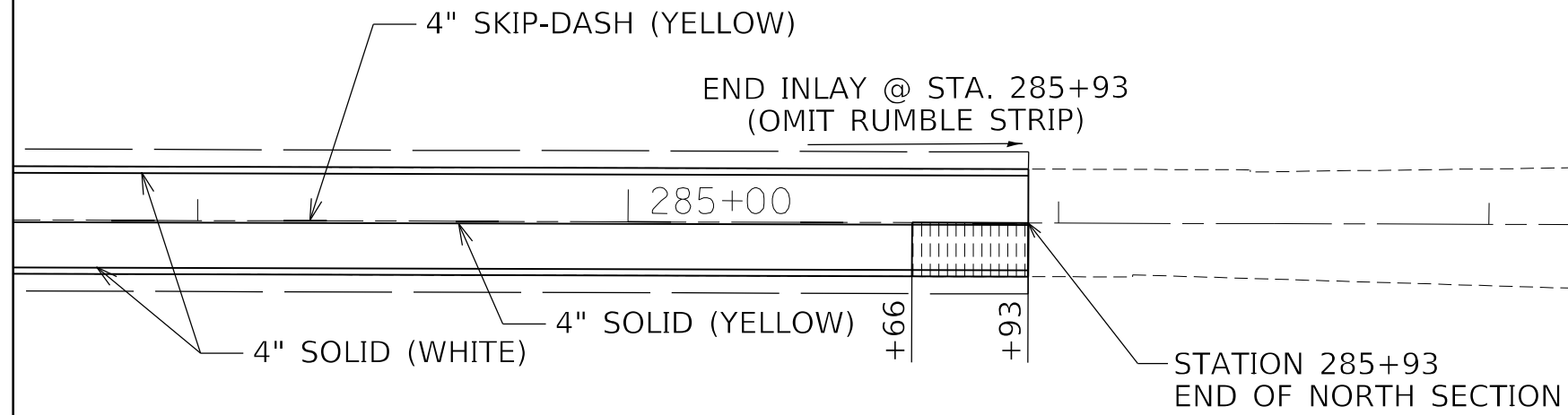

MODEL: Default
 FILE: \\mupc-pw-bentley.com\PW\DOT\Documents\DOT Offices\District 7\Projects\74964\CADD\Drawings\CAD\Drawings\74964-Left.dwg

USER NAME = steffenmk	DESIGNED -	REVISED -
	DRAWN -	REVISED -
PLOT SCALE = 40,0000 * / in.	CHECKED -	REVISED -
PLOT DATE = 11/29/2021	DATE -	REVISED -

STATE OF ILLINOIS
DEPARTMENT OF TRANSPORTATION

PLAN SHEETS

SCALE: SHEET OF SHEETS STA. TO STA.

F.A.P. RTE.	SECTION	COUNTY	TOTAL SHEETS	SHEET NO.
762	(1,2)RS-4	MOULTRIE	36	12
ILLINOIS FED. AID PROJECT			CONTRACT NO. 74964	

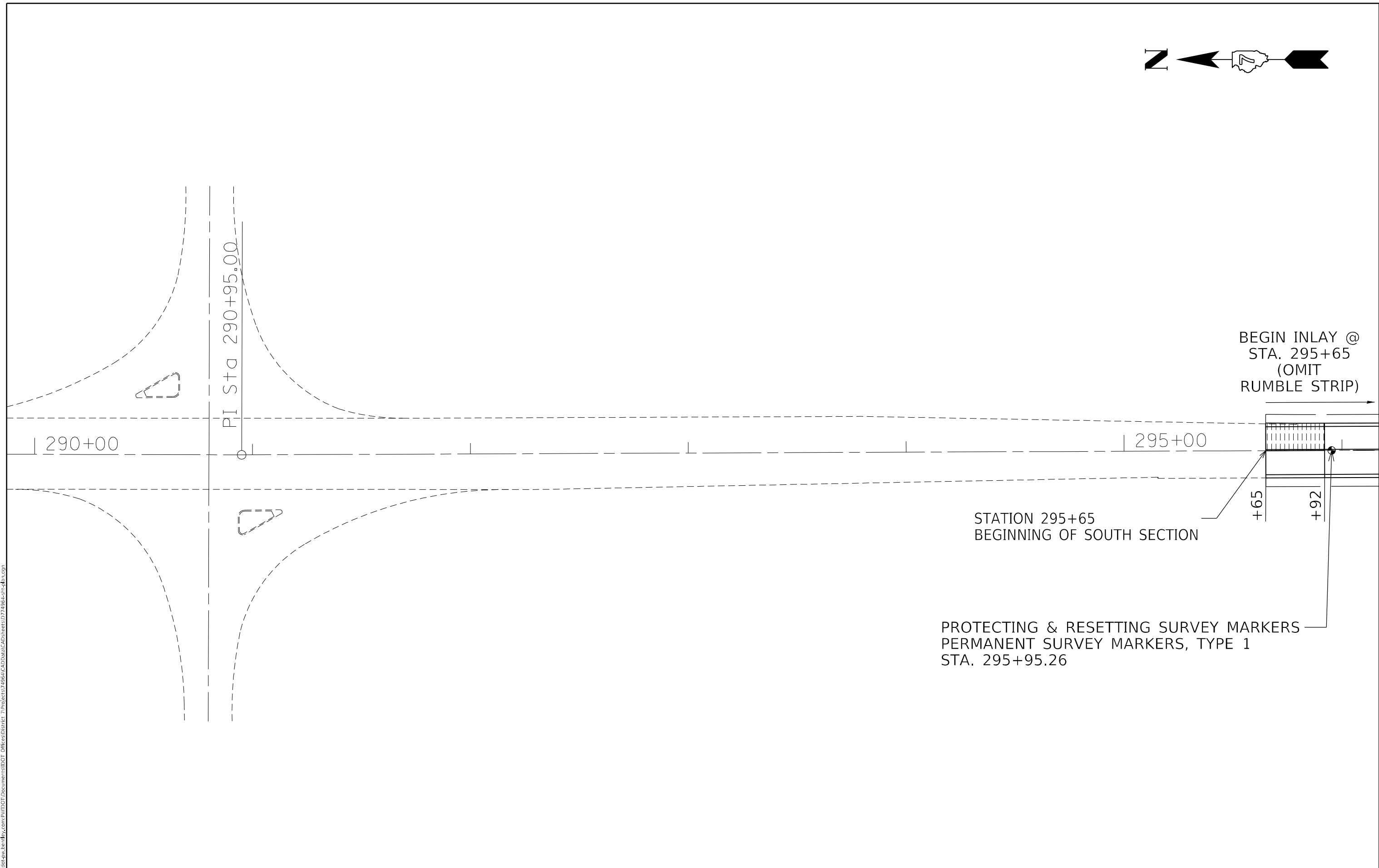

MODEL: Default
 FILE NAME: p:\project-aw-beadley.com\PI\DOT\Documents\DOT Office\Director_7\Project\74964\CADD\Drawings\CAD\sheet\0774964-13.dwg

USER NAME = stefenmk	DESIGNED -	REVISED -
	DRAWN -	REVISED -
PLOT SCALE = 40,0000 * / in.	CHECKED -	REVISED -
PLOT DATE = 11/29/2021	DATE -	REVISED -

STATE OF ILLINOIS
DEPARTMENT OF TRANSPORTATION

PLAN SHEETS			
SCALE:	SHEET	OF	SHEETS
	STA.	TO	STA.

F.A.P. RTE.	SECTION	COUNTY	TOTAL SHEETS	SHEET NO.
762	(1,2)RS-4	MOULTRIE	36	13
ILLINOIS FED. AID PROJECT			CONTRACT NO. 74964	

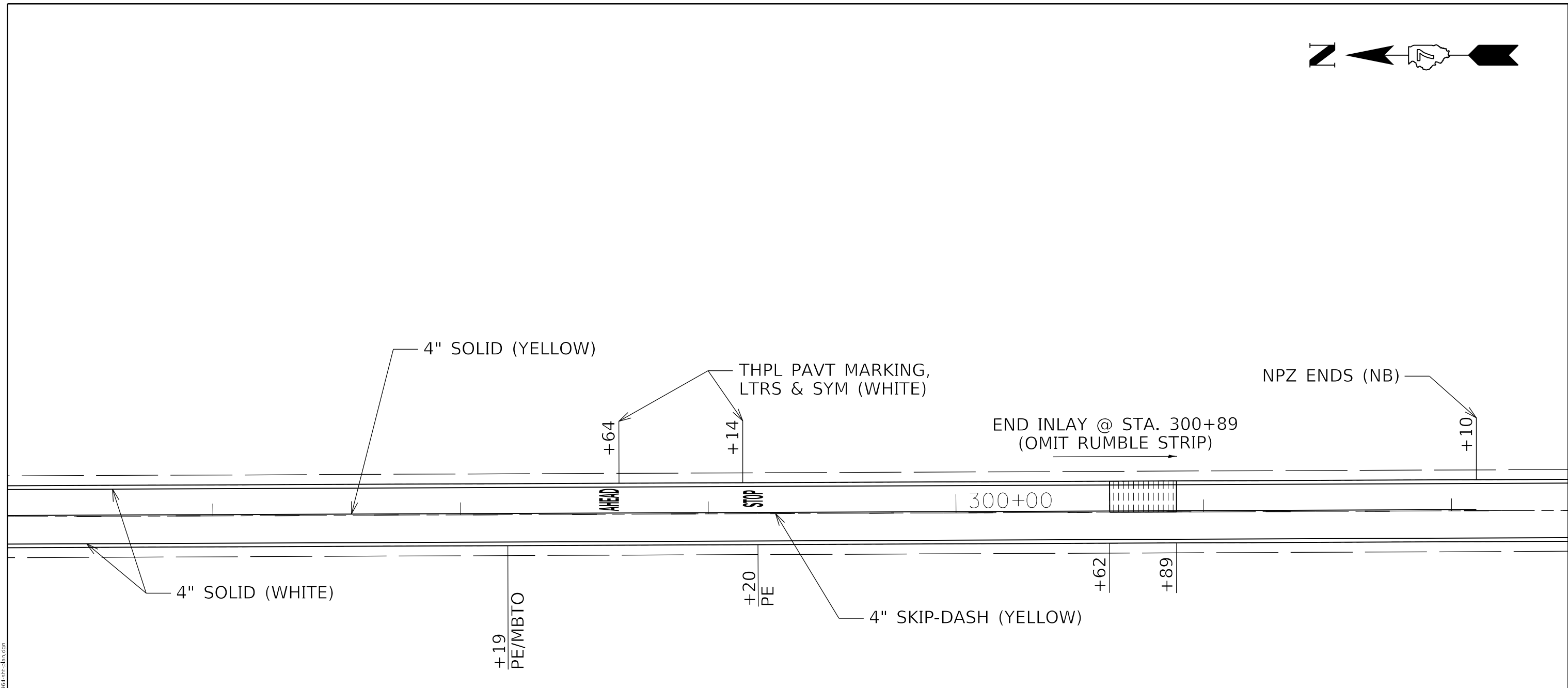

HMA SURFACE REMOVAL, 1 1/2"



HMA SURFACE REMOVAL, 2 3/4"

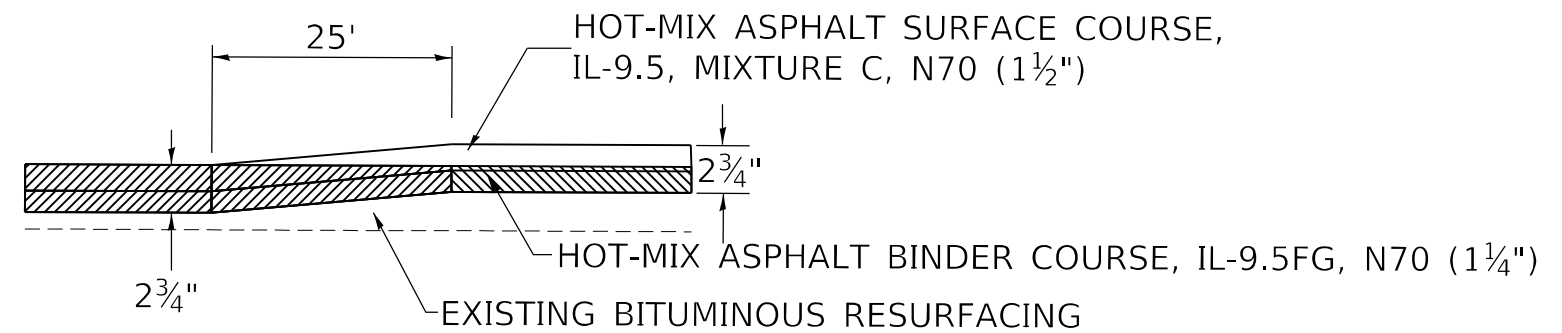

MILLING DETAIL
STA. 300+89 TO STA. 301+14

MODEL: Default
 FILE: 74964.ctb
 PROJECT: 74964\DOT Documents\DOT Office\Drawings\74964\CADD\Drawings\74964-14.dwg
 PLOT DATE: 11/29/2021

USER NAME = steffnmk	DESIGNED -	REVISED -
PLOT SCALE = 40,0000 * / in.	DRAWN -	REVISED -
PLOT DATE = 11/29/2021	CHECKED -	REVISED -
	DATE -	REVISED -

STATE OF ILLINOIS
DEPARTMENT OF TRANSPORTATION

PLAN SHEETS

SCALE: SHEET OF SHEETS STA. TO STA.

F.A.P. RTE.	SECTION	COUNTY	TOTAL SHEETS	SHEET NO.
762	(1,2)RS-4	MOULTRIE	36	14
ILLINOIS FED. AID PROJECT			CONTRACT NO. 74964	



+15
FE

305+00

4" SOLID (WHITE)

4" SKIP-DASH (YELLOW)

MODEL: Default
 FILE NAME: p:\ultra-cw-bead\p\com\PIV\DOT\Documents\DOT Offices\District 7\Projects\74964\CADD\Drawings\CADDsheets\0774964-15.dwg

USER NAME = steffenmk	DESIGNED -	REVISED -
	DRAWN -	REVISED -
PLOT SCALE = 40,0000 * / in.	CHECKED -	REVISED -
PLOT DATE = 11/29/2021	DATE -	REVISED -

STATE OF ILLINOIS
DEPARTMENT OF TRANSPORTATION

PLAN SHEETS			
SCALE:	SHEET	OF	SHEETS
	STA.	TO	STA.

F.A.P. RTE.	SECTION	COUNTY	TOTAL SHEETS	SHEET NO.
762	(1,2)RS-4	MOULTRIE	36	15
ILLINOIS FED. AID PROJECT			CONTRACT NO. 74964	

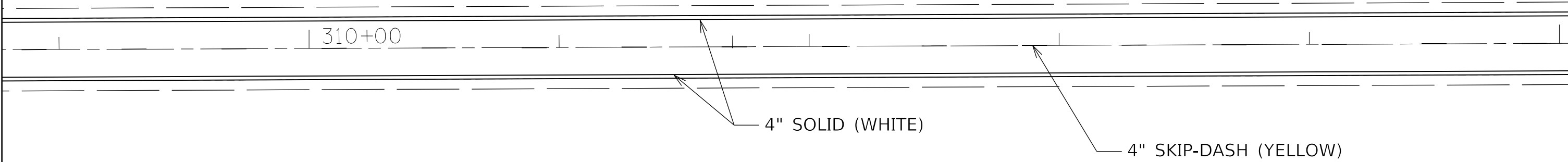

MODEL: Default
 FILE NAME: p:\ultra-cw-bead\p\com\PIV\DOT\Documents\DOT Office\Dir\dir_7\Project\74964\CADD\Drawn\CAD\sheet\0774964-1.dwg

USER NAME = steffenmk	DESIGNED -	REVISED -
	DRAWN -	REVISED -
PLOT SCALE = 40,0000 * / in.	CHECKED -	REVISED -
PLOT DATE = 11/29/2021	DATE -	REVISED -

STATE OF ILLINOIS
DEPARTMENT OF TRANSPORTATION

PLAN SHEETS

SCALE: SHEET OF SHEETS STA. TO STA.

F.A.P. RTE.	SECTION	COUNTY	TOTAL SHEETS	SHEET NO.
762	(1,2)RS-4	MOULTRIE	36	16
ILLINOIS FED. AID PROJECT			CONTRACT NO. 74964	

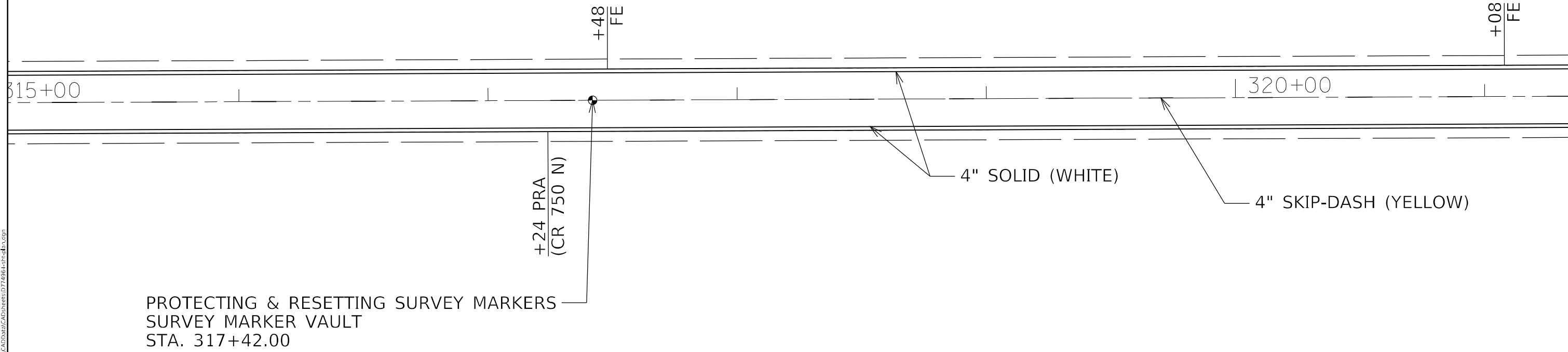

PROTECTING & RESETTING SURVEY MARKERS
 SURVEY MARKER VAULT
 STA. 317+42.00

MODEL: Default
 FILE NAME: p:\project-aw-beadley.com\PIV\DOT\Documents\DOT Office\Director_7\Project\74964\CADD\Drawings\Drawings\74964-17.dwg

USER NAME = steffenmk	DESIGNED -	REVISED -
	DRAWN -	REVISED -
PLOT SCALE = 40,0000 * / in.	CHECKED -	REVISED -
PLOT DATE = 11/29/2021	DATE -	REVISED -

**STATE OF ILLINOIS
 DEPARTMENT OF TRANSPORTATION**

PLAN SHEETS			
SCALE:	SHEET	OF	SHEETS
	STA.	TO	STA.

F.A.P. RTE.	SECTION	COUNTY	TOTAL SHEETS	SHEET NO.
762	(1,2)RS-4	MOULTRIE	36	17
			CONTRACT NO. 74964	
ILLINOIS FED. AID PROJECT				

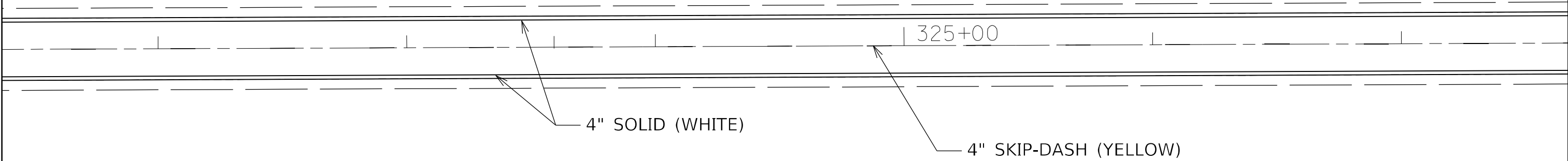
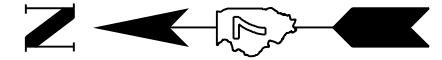

MODEL: Default
 FILE NAME: p:\ultra-cw-bead\p\com\PIV\DOT\Documents\DOT_offices\Dir\dir_7\Project\74964\CADD\Drawn\CAD\sheet\0774964-18.dwg

USER NAME = steffenmk	DESIGNED -	REVISED -
	DRAWN -	REVISED -
PLOT SCALE = 40,0000 * / in.	CHECKED -	REVISED -
PLOT DATE = 11/29/2021	DATE -	REVISED -

STATE OF ILLINOIS
DEPARTMENT OF TRANSPORTATION

PLAN SHEETS			
SCALE:	SHEET	OF	SHEETS
	STA.	TO	STA.

F.A.P. RTE.	SECTION	COUNTY	TOTAL SHEETS	SHEET NO.
762	(1,2)RS-4	MOULTRIE	36	18
			CONTRACT NO. 74964	
		ILLINOIS FED. AID PROJECT		

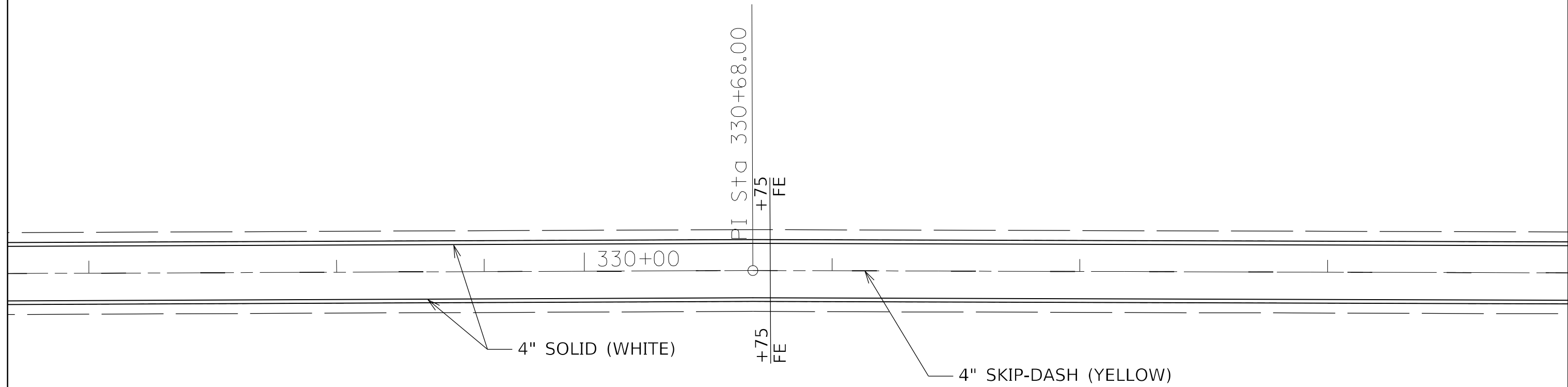
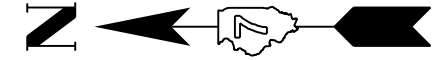

MODEL: Default
 FILE NAME: p:\ultra-cw-bead\p\com\PI\DOT\Documents\DOT Office\District 7\Project\74964\CADD\Drawn\CAD\Sheets\0774964-1-1.dwg

USER NAME = steffenmk	DESIGNED -	REVISED -
	DRAWN -	REVISED -
PLOT SCALE = 40,0000 * / in.	CHECKED -	REVISED -
PLOT DATE = 11/29/2021	DATE -	REVISED -

STATE OF ILLINOIS
DEPARTMENT OF TRANSPORTATION

PLAN SHEETS

SCALE: SHEET OF SHEETS STA. TO STA.

F.A.P. RTE.	SECTION	COUNTY	TOTAL SHEETS	SHEET NO.
762	(1,2)RS-4	MOULTRIE	36	19
ILLINOIS FED. AID PROJECT			CONTRACT NO. 74964	

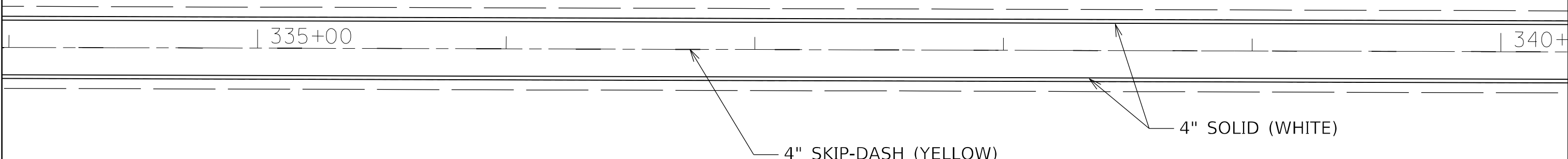

MODEL: Default
 FILE NAME: p:\ultra-cw-bead\p\com\PIV\DOT\Documents\DOT Office\District 7\Project\74964\CADD\Drawn\CAD\Sheets\0774964-Sub.dwg

USER NAME = steffenmk	DESIGNED -	REVISED -
	DRAWN -	REVISED -
PLOT SCALE = 40,0000 * / in.	CHECKED -	REVISED -
PLOT DATE = 11/29/2021	DATE -	REVISED -

**STATE OF ILLINOIS
 DEPARTMENT OF TRANSPORTATION**

PLAN SHEETS

SCALE: SHEET OF SHEETS STA. TO STA.

F.A.P. RTE.	SECTION	COUNTY	TOTAL SHEETS	SHEET NO.
762	(1,2)RS-4	MOULTRIE	36	20
CONTRACT NO. 74964			ILLINOIS FED. AID PROJECT	



EQUATION:
 Sta 340+96.00 BK =
 Sta 341+00.00 AH

+55 PRA
 (CR 700 N)

+35
 FE

00

345+00

4" SOLID (WHITE)

+74 PRA
 (CR 700 N)

4" SKIP-DASH (YELLOW)

MODEL: Default
 FILE NAME: p:\ultra-cw-bead\p\com\PIV\DOT\Documents\DOT Offices\District 7\Project\74964\CADD\Drawings\CAD\Sheets\0774964-1-1.dwg

USER NAME = stefenmk	DESIGNED -	REVISED -
	DRAWN -	REVISED -
PLOT SCALE = 40,0000 * / in.	CHECKED -	REVISED -
PLOT DATE = 11/29/2021	DATE -	REVISED -

**STATE OF ILLINOIS
 DEPARTMENT OF TRANSPORTATION**

PLAN SHEETS

SCALE: SHEET OF SHEETS STA. TO STA.

F.A.P. RTE.	SECTION	COUNTY	TOTAL SHEETS	SHEET NO.
762	(1,2)RS-4	MOULTRIE	36	21
ILLINOIS FED. AID PROJECT			CONTRACT NO. 74964	



+91
FE

350+00

4" SKIP-DASH (YELLOW)

4" SOLID (WHITE)

MODEL: Default
FILE NAME: p:\ultra-cw-bead\p\com\PIV\DOT\Documents\DOT Offices\District 7\Project\74964\CADD\Drawn\CAD\Sheets\0774964-Sub-dwg.dgn

USER NAME = stefenmk	DESIGNED -	REVISED -
	DRAWN -	REVISED -
PLOT SCALE = 40,0000 * / in.	CHECKED -	REVISED -
PLOT DATE = 11/29/2021	DATE -	REVISED -

**STATE OF ILLINOIS
DEPARTMENT OF TRANSPORTATION**

PLAN SHEETS

SCALE: SHEET OF SHEETS STA. TO STA.

F.A.P. RTE.	SECTION	COUNTY	TOTAL SHEETS	SHEET NO.
762	(1,2)RS-4	MOULTRIE	36	22
ILLINOIS FED. AID PROJECT			CONTRACT NO. 74964	

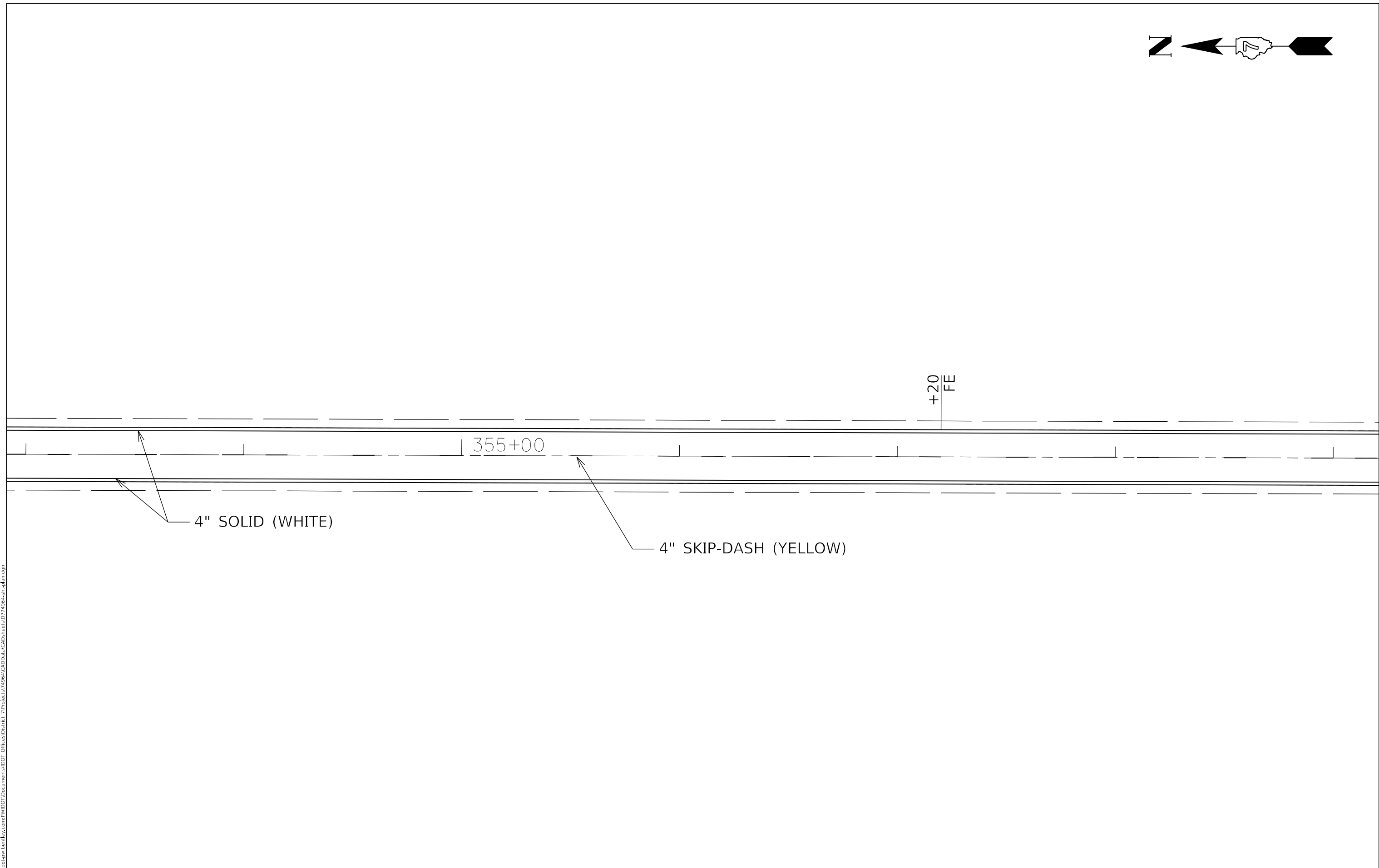
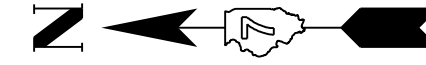

MODEL: Default
 FILE NAME: p:\ultra-cw-bead\ey.com\PIV\DOT\Documents\DOT Offices\District 7\Projects\74964\CADD\Drawn\CAD\Sheets\0774964-4-1.dwg

USER NAME = steffenmk	DESIGNED -	REVISED -
	DRAWN -	REVISED -
PLOT SCALE = 40,0000 * / in.	CHECKED -	REVISED -
PLOT DATE = 11/29/2021	DATE -	REVISED -

STATE OF ILLINOIS
DEPARTMENT OF TRANSPORTATION

PLAN SHEETS			
SCALE:	SHEET	OF	SHEETS
	STA.	TO	STA.

F.A.P. RTE.	SECTION	COUNTY	TOTAL SHEETS	SHEET NO.
762	(1,2)RS-4	MOULTRIE	36	23
			CONTRACT NO. 74964	
ILLINOIS FED. AID PROJECT				

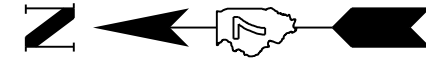

360+00

365+00

4" SKIP-DASH (YELLOW)

4" SOLID (WHITE)

MODEL: Default
FILE NAME: p:\ultra-cw-bead\p\com\PIV\DOT\Documents\DOT Offices\District 7\Projects\74964\CADD\Drawings\CAD\Sheets\74964-Sub-dwg.dwg

USER NAME = steffenmk	DESIGNED -	REVISED -
	DRAWN -	REVISED -
PLOT SCALE = 40,0000 * / in.	CHECKED -	REVISED -
PLOT DATE = 11/29/2021	DATE -	REVISED -

**STATE OF ILLINOIS
DEPARTMENT OF TRANSPORTATION**

PLAN SHEETS	
SCALE:	SHEET OF SHEETS STA. TO STA.

F.A.P. RTE.	SECTION	COUNTY	TOTAL SHEETS	SHEET NO.
762	(1,2)RS-4	MOULTRIE	36	24
ILLINOIS FED. AID PROJECT			CONTRACT NO. 74964	

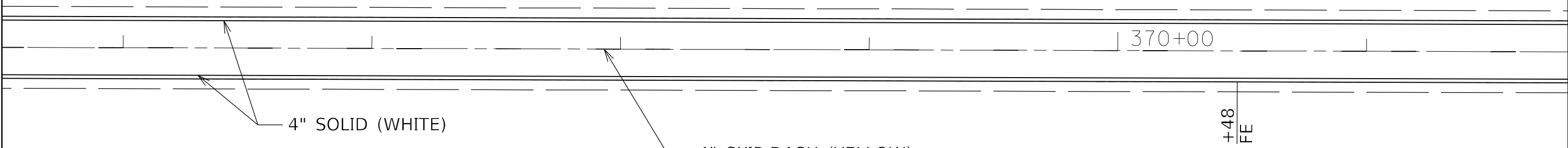

MODEL: Default
 FILE NAME: p:\ultra-cw-bead\ey.com\PIV\DOT\Documents\DOT Office\District 7\Project\74964\CADD\Drawn\CAD\Sheets\0774964-1-1.dwg

USER NAME = steffenmk	DESIGNED -	REVISED -
	DRAWN -	REVISED -
PLOT SCALE = 40,0000 * / in.	CHECKED -	REVISED -
PLOT DATE = 11/29/2021	DATE -	REVISED -

STATE OF ILLINOIS
DEPARTMENT OF TRANSPORTATION

PLAN SHEETS			
SCALE:	SHEET	OF	SHEETS
	STA.	TO	STA.

F.A.P. RTE.	SECTION	COUNTY	TOTAL SHEETS	SHEET NO.
762	(1,2)RS-4	MOULTRIE	36	25
CONTRACT NO. 74964			ILLINOIS FED. AID PROJECT	

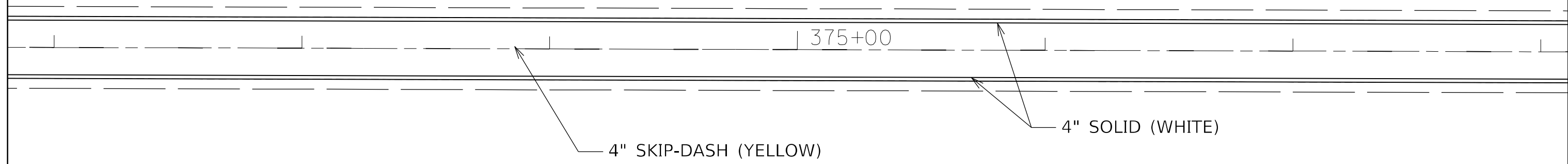

4" SKIP-DASH (YELLOW)

4" SOLID (WHITE)

MODEL: Default
 FILE NAME: p:\ultra-cw-beadley.com\PIV\DOT\Documents\DOT Offices\District 7\Projects\74964\CADD\Drawings\CADD\Drawings\74964-Sub-dwg.dgn

USER NAME = stefenmk	DESIGNED -	REVISED -
	DRAWN -	REVISED -
PLOT SCALE = 40,0000 * / in.	CHECKED -	REVISED -
PLOT DATE = 11/29/2021	DATE -	REVISED -

STATE OF ILLINOIS
DEPARTMENT OF TRANSPORTATION

PLAN SHEETS

SCALE: SHEET OF SHEETS STA. TO STA.

F.A.P. RTE.	SECTION	COUNTY	TOTAL SHEETS	SHEET NO.
762	(1,2)RS-4	MOULTRIE	36	26
ILLINOIS FED. AID PROJECT			CONTRACT NO. 74964	

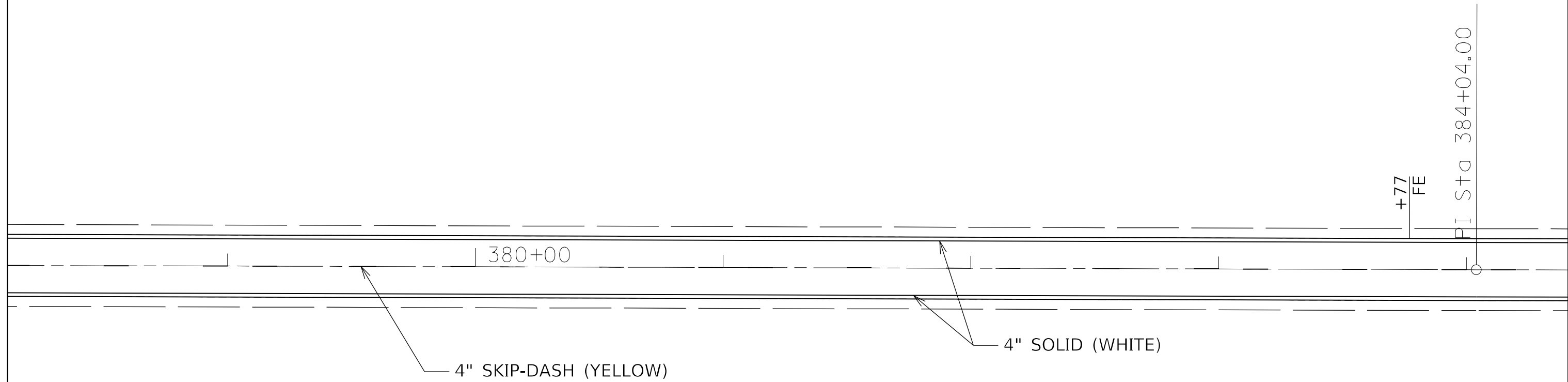
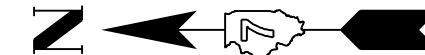

MODEL: Default
 FILE NAME: p:\ultra-cw-bead\p\com\PI\DOT\Documents\DOT Office\District 7\Project\74964\CADD\Drawings\CAD\Sheets\0774964-4-1.dwg

USER NAME = steffenmk	DESIGNED -	REVISED -
	DRAWN -	REVISED -
PLOT SCALE = 40,0000 * / in.	CHECKED -	REVISED -
PLOT DATE = 11/29/2021	DATE -	REVISED -

STATE OF ILLINOIS
DEPARTMENT OF TRANSPORTATION

PLAN SHEETS			
SCALE:	SHEET	OF	SHEETS
	STA.	TO	STA.

F.A.P. RTE.	SECTION	COUNTY	TOTAL SHEETS	SHEET NO.
762	(1,2)RS-4	MOULTRIE	36	27
ILLINOIS FED. AID PROJECT			CONTRACT NO. 74964	



385+00

390+00

4" SOLID (WHITE)

4" SKIP-DASH (YELLOW)

MODEL: Default
FILE NAME: p:\ultra-cw-bead\ey.com\PIV\DOT\Documents\DOT Office\District 7\Project\74964\CADD\Drawn\CAD\Sheets\0774964-Left.dwg

USER NAME = steffenmk	DESIGNED -	REVISED -
	DRAWN -	REVISED -
PLOT SCALE = 40,0000 * / in.	CHECKED -	REVISED -
PLOT DATE = 11/29/2021	DATE -	REVISED -

**STATE OF ILLINOIS
DEPARTMENT OF TRANSPORTATION**

PLAN SHEETS

SCALE: SHEET OF SHEETS STA. TO STA.

F.A.P. RTE.	SECTION	COUNTY	TOTAL SHEETS	SHEET NO.
762	(1,2)RS-4	MOULTRIE	36	28
ILLINOIS FED. AID PROJECT			CONTRACT NO. 74964	

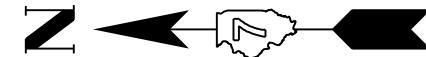

+74
FE/MBTO

395+00

4" SKIP-DASH (YELLOW)

4" SOLID (WHITE) +74
PE

+00 FE

MODEL: Default
FILE: \\MAILSrv\public\paw.bentley.com\PIV\DOT\Documents\DOT Offices\District 7\Projects\74964\CADD\Drawn\CAD\Sheets\0774964-Sub-dwg.dgn

USER NAME = steffenmk	DESIGNED -	REVISED -
	DRAWN -	REVISED -
PLOT SCALE = 40,0000 * / in.	CHECKED -	REVISED -
PLOT DATE = 11/29/2021	DATE -	REVISED -

**STATE OF ILLINOIS
DEPARTMENT OF TRANSPORTATION**

PLAN SHEETS

SCALE: SHEET OF SHEETS STA. TO STA.

F.A.P. RTE.	SECTION	COUNTY	TOTAL SHEETS	SHEET NO.
762	(1,2)RS-4	MOULTRIE	36	29
ILLINOIS FED. AID PROJECT			CONTRACT NO. 74964	

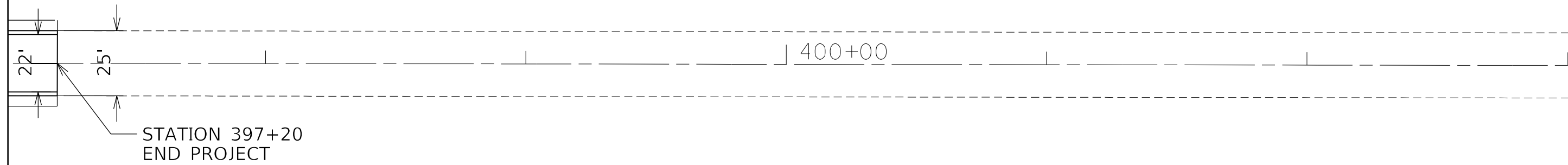

MODEL: Default
 FILE NAME: p:\project-aw-beadby.com\PIV\DOT\Documents\DOT Office\District 7\Project\74964\CADD\Drawings\CAD\Sheets\0774964-Sub-dwg.dwg

STATION 397+20
END PROJECT

400+00

USER NAME = steffnmk	DESIGNED -	REVISED -
	DRAWN -	REVISED -
PLOT SCALE = 40,0000 * / in.	CHECKED -	REVISED -
PLOT DATE = 11/29/2021	DATE -	REVISED -

**STATE OF ILLINOIS
DEPARTMENT OF TRANSPORTATION**

PLAN SHEETS

SCALE: SHEET OF SHEETS STA. TO STA.

F.A.P. RTE.	SECTION	COUNTY	TOTAL SHEETS	SHEET NO.
762	(1,2)RS-4	MOULTRIE	36	30
ILLINOIS FED. AID PROJECT			CONTRACT NO. 74964	

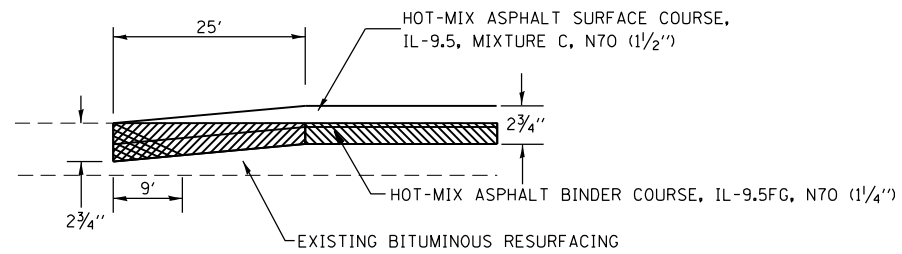

PAVING DETAIL

STA. 267+35 TO STA. 267+60

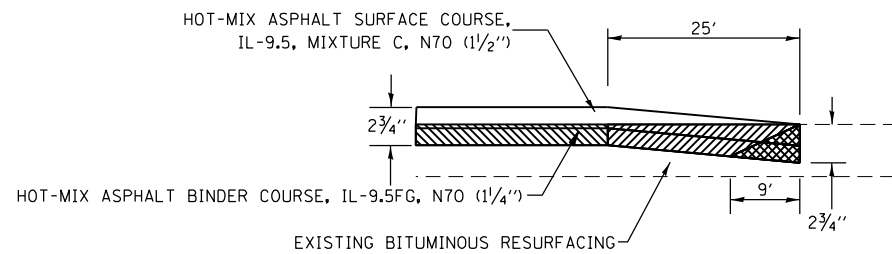

PAVING DETAIL

STA. 397+20 TO STA. 397+45

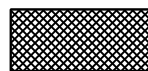

TEMPORARY RAMP



HMA SURFACE REMOVAL, 1 1/2"



HMA SURFACE REMOVAL - BUTT JOINT

MODEL: Default
 FILE: hma15.pia
 SUBJECT: pw_bentley.com/PLM/IDOT/Document/1/IDOT_Offices/Dir/rdt_7/Project/74964/CADD/Draw/CAD/Sheets/0774964-1-1-1.dwg

USER NAME = stefenmk	DESIGNED -	REVISED -
	DRAWN -	REVISED -
PLOT SCALE = 100,0000' / in.	CHECKED -	REVISED -
PLOT DATE = 11/29/2021	DATE -	REVISED -

**STATE OF ILLINOIS
DEPARTMENT OF TRANSPORTATION**

MILLING/PAVING DETAILS

SCALE: SHEET 1 OF 1 SHEETS STA. TO STA.

F.A.P. RTE.	SECTION	COUNTY	TOTAL SHEETS	SHEET NO.
762	(1,2)RS-4	MOULTRIE	36	31
ILLINOIS FED. AID PROJECT			CONTRACT NO. 74964	

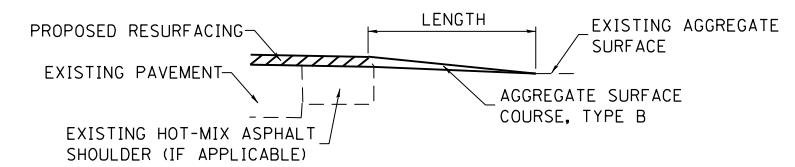
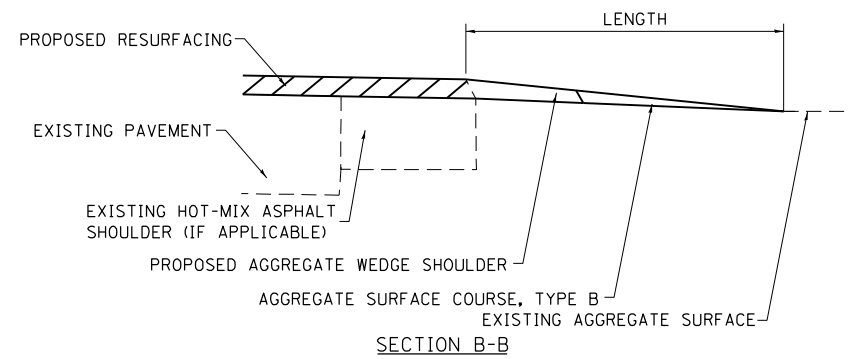
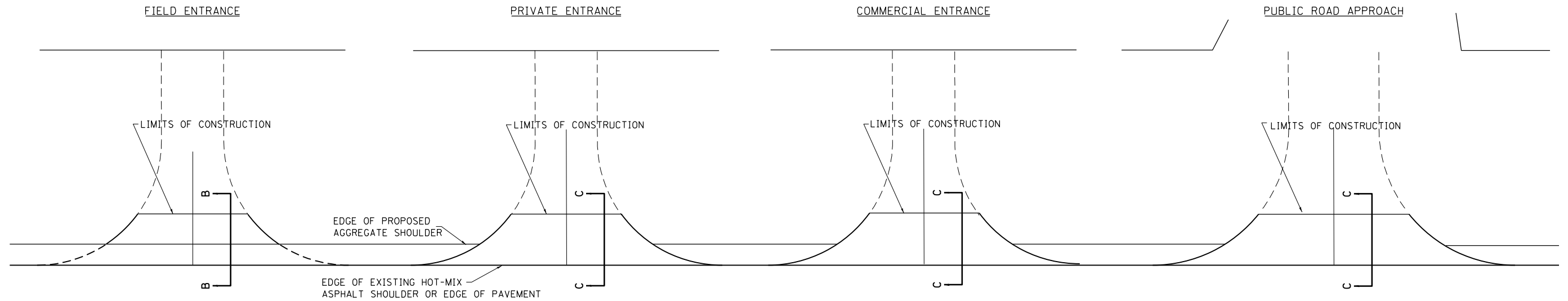

SECTION C-C

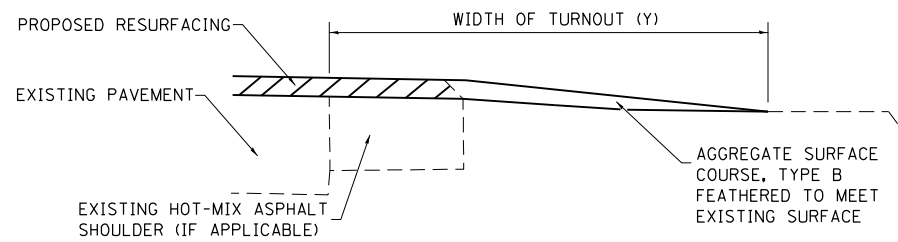

TYPICAL SECTION AT MAILBOX TURNOUT

NOTE: SEE STANDARD 406201 FOR MAILBOX TURNOUT DETAILS

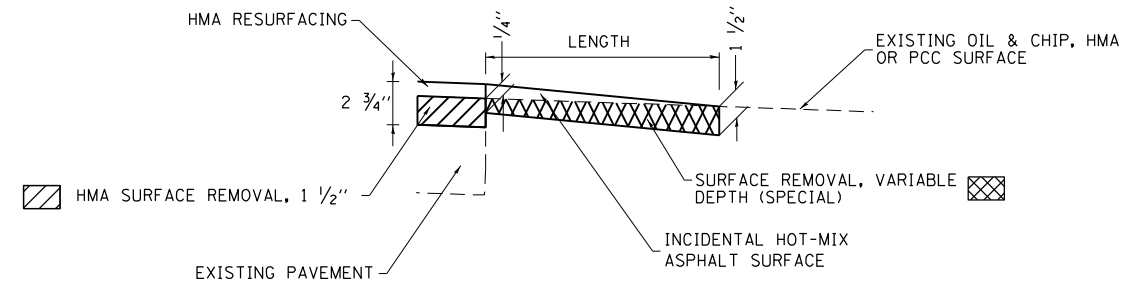

SECTION C-C

NOTES

LENGTH = 10' UNLESS OTHERWISE NOTED ON PLANS

IF THERE IS NOT EXISTING HOT-MIX ASPHALT SHOULDER THEN THE ENTRANCE TAPER STARTS AT THE EDGE OF EXISTING PAVEMENT.

MODEL: Default
 FILE: Mailbox Turnout.dwg
 PROJECT: 174964 (CAD) Data/CAD Sheets/174964-Entrance.dwg
 PROJECT: 174964 (CAD) Data/CAD Sheets/174964-Entrance.dwg

USER NAME = steffnmk	DESIGNED -	REVISED -
	DRAWN -	REVISED -
PLOT SCALE = 100,0000' / in.	CHECKED -	REVISED -
PLOT DATE = 11/29/2021	DATE -	REVISED -

STATE OF ILLINOIS
DEPARTMENT OF TRANSPORTATION

RURAL ENTRANCE AND MAILBOX TURNOUT DETAILS
WITH SHOULDERS

SCALE: SHEET 1 OF 1 SHEETS STA. TO STA.

F.A.P. RTE. 762	SECTION (1,2)RS-4	COUNTY MOULTRIE	TOTAL SHEETS 36	SHEET NO. 32
CONTRACT NO. 74964			ILLINOIS FED. AID PROJECT	

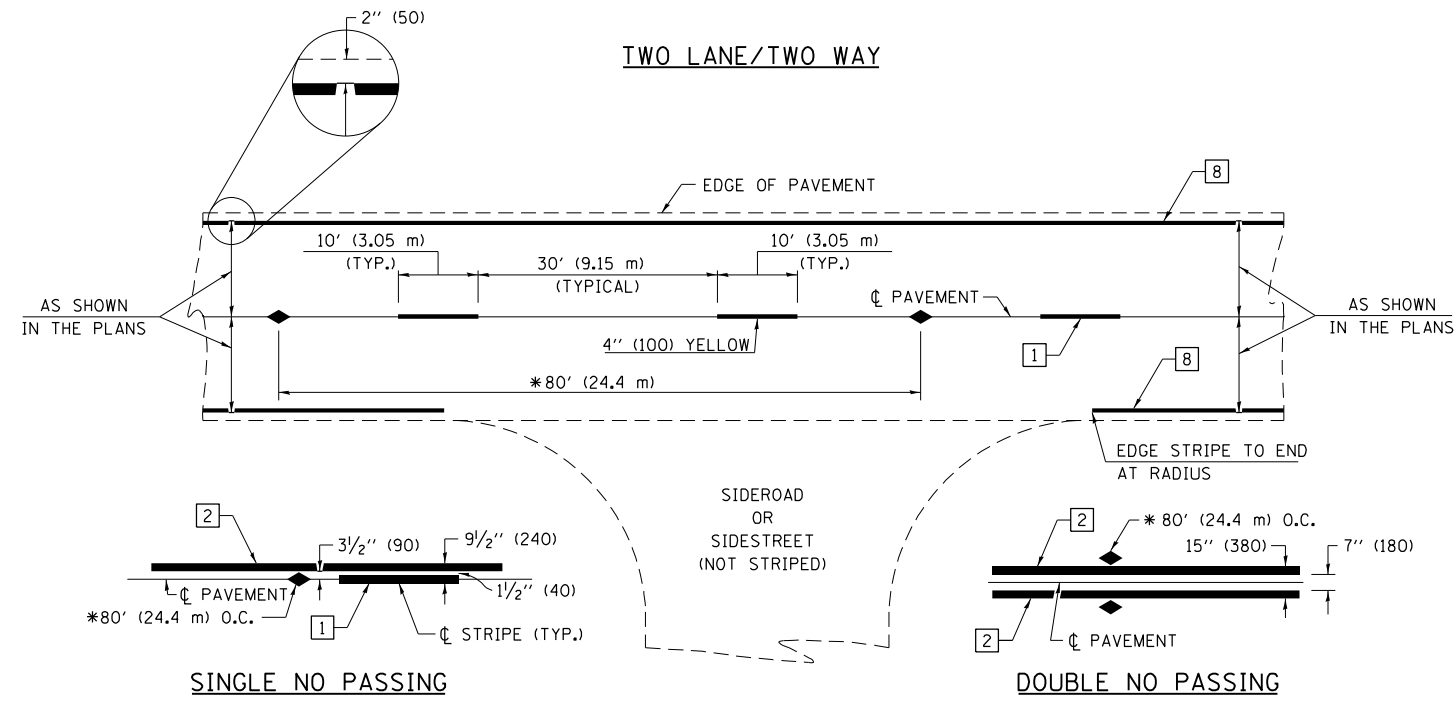

* REDUCE TO 40' (12.2 m) O.C. ON CURVES WITH POSTED OR ADVISORY SPEEDS OF 45 mph (70 km/h) OR LESS.

PAVEMENT MARKING LEGEND

- 1 4" (100) SKIP-DASH (YELLOW)
- 2 4" (100) SOLID (YELLOW)
- 3 12" (300) DIAGONAL (YELLOW)
- 4 4" (100) DOUBLE YELLOW (NARROW)
- 5 12" (300) SOLID WHITE
- 6 RESERVED
- 7 6" (150) SKIP-DASH (WHITE)
- 8 4" (100) SOLID (WHITE)
- 9 12" (300) DIAGONAL (WHITE)
- 10 6" (150) SOLID (WHITE)
- 11 24" (600) STOP BAR (WHITE)
- 12 8" (200) SOLID (WHITE)
- 13 4" (100) PARKING WHITE

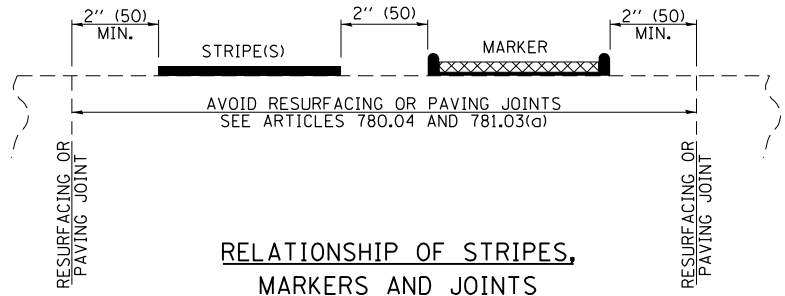

RELATIONSHIP OF STRIPES, MARKERS AND JOINTS

TYPICAL PAVEMENT MARKERS LEGEND

- ◆ TWO-WAY AMBER MARKER
- ▶ ONE-WAY AMBER MARKER
- ▷ ONE-WAY CRYSTAL MARKER

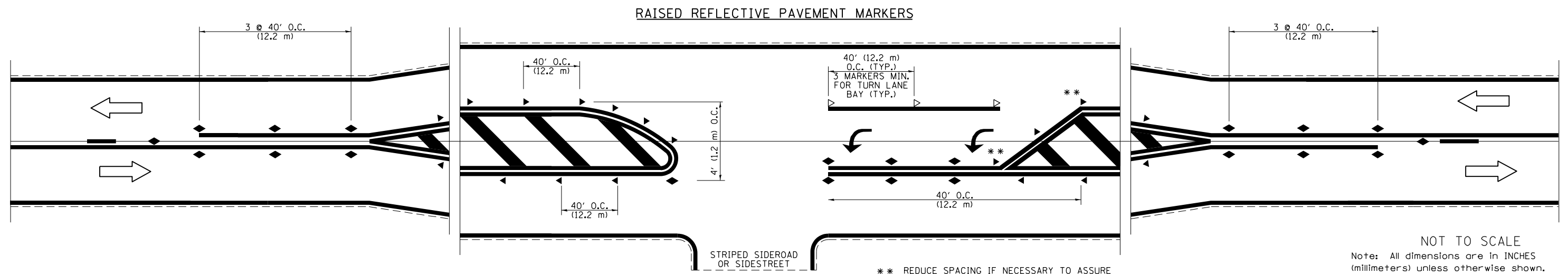

** REDUCE SPACING IF NECESSARY TO ASSURE MARKERS AT CORNER POINTS.

NOT TO SCALE
Note: All dimensions are in INCHES (millimeters) unless otherwise shown.

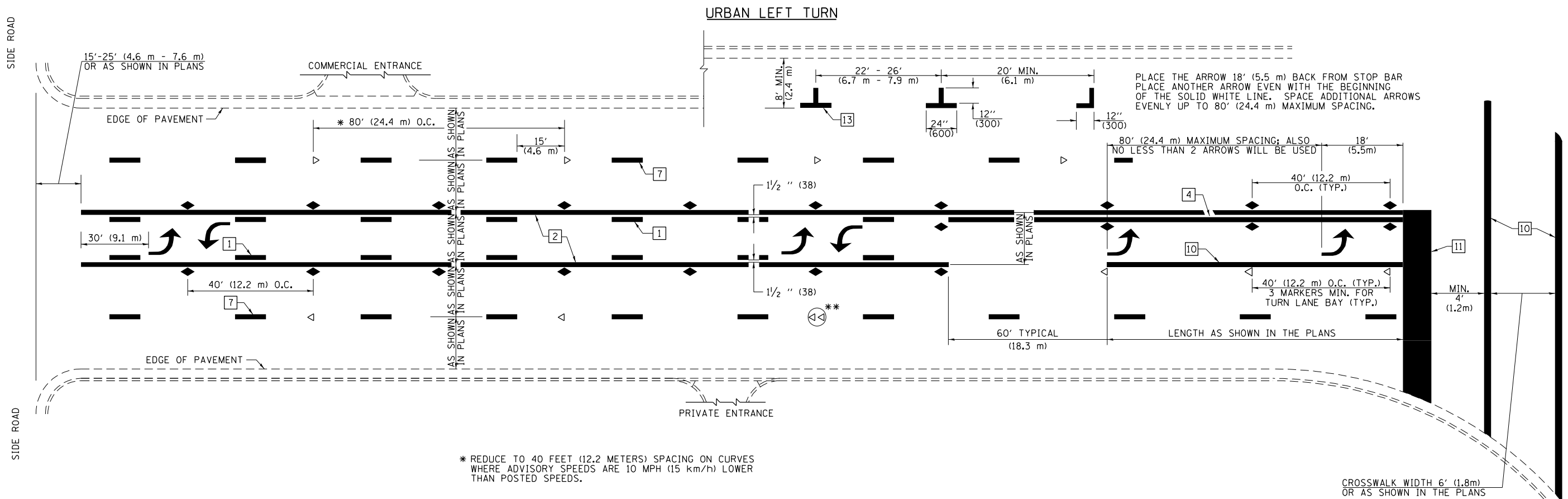

PLACE THE ARROW 18' (5.5 m) BACK FROM STOP BAR
 PLACE ANOTHER ARROW EVEN WITH THE BEGINNING
 OF THE SOLID WHITE LINE. SPACE ADDITIONAL ARROWS
 EVENLY UP TO 80' (24.4 m) MAXIMUM SPACING.

* REDUCE TO 40 FEET (12.2 METERS) SPACING ON CURVES
 WHERE ADVISORY SPEEDS ARE 10 MPH (15 km/h) LOWER
 THAN POSTED SPEEDS.

** DOUBLE LANE LINE MARKERS SHALL BE SPECIFIED
 AND SPACED AS SHOWN IN HIGHWAY STANDARD
 781001 FOR MULTI-LANE DIVIDED AND UNDIVIDED
 HIGHWAYS.

PAVEMENT MARKING LEGEND

- 1 4" (100) SKIP-DASH (YELLOW)
- 2 4" (100) SOLID (YELLOW)
- 3 12" (300) DIAGONAL (YELLOW)
- 4 4" (100) DOUBLE YELLOW (NARROW)
- 5 12" (300) SOLID WHITE
- 6 RESERVED
- 7 6" (150) SKIP-DASH (WHITE)
- 8 4" (100) SOLID (WHITE)
- 9 12" (300) DIAGONAL (WHITE)
- 10 6" (150) SOLID (WHITE)
- 11 24" (600) STOP BAR (WHITE)
- 12 8" (200) SOLID (WHITE)
- 13 4" (100) PARKING WHITE

GENERAL NOTES

1. TURN ARROW PAIRS SHALL BE PLACED AT 250' (75 m) INTERVALS AND SHALL BE EVENLY SPACED BETWEEN BOTH ENDS OF THE BIDIRECTIONAL LEFT TURN LANE. USE A MINIMUM OF TWO PAIRS PER BLOCK.
2. THE SOLID YELLOW PAVEMENT MARKINGS [2] SHOULD GENERALLY START OR END NEAR THE RADIUS POINT OF EACH STREET RETURN EXCEPT WHERE ONE OR BOTH ENDS WOULD INCLUDE STOP BARS.
3. THE SKIP-DASH PAVEMENT MARKINGS [1] OR [7] SHOULD BE CENTERED BETWEEN BOTH ENDS OF EACH CITY BLOCK AND SHALL BE PLACED SO THEY LINE UP ACROSS FROM EACH OTHER.
4. USE LARGE ARROW SIZE FOR BOTH RURAL AND URBAN LOCATIONS. (SEE LAST PAGE OF SECTION 780x FOR SYMBOLS TABLE)
5. LANE LINE EXTENSIONS SHALL BE THE SAME COLOR AND WIDTH AS THE LANE LINE BEING EXTENDED.
6. ALL WHITE SKIP-DASH LINES SHALL BE 6" IN WIDTH.

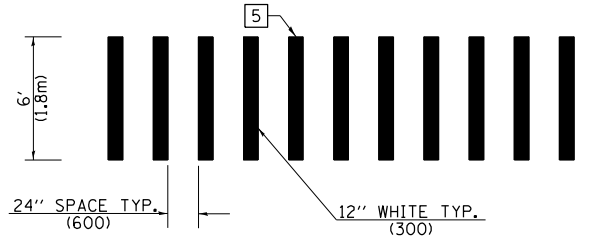

**CROSSWALK DETAIL
 (DECATUR CITY LIMITS ONLY)**

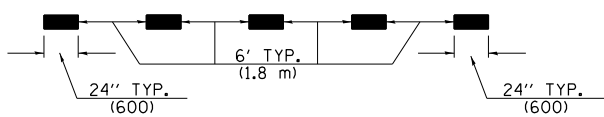

LANE LINE EXTENSIONS

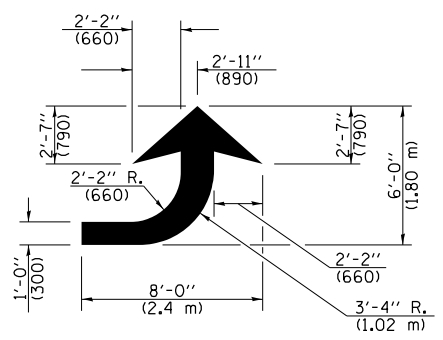

LEFT ARROW

REVERSE FOR RIGHT ARROW
 AREA = 15.6 SQ. FT. (1.47 m²)
 (WHITE)

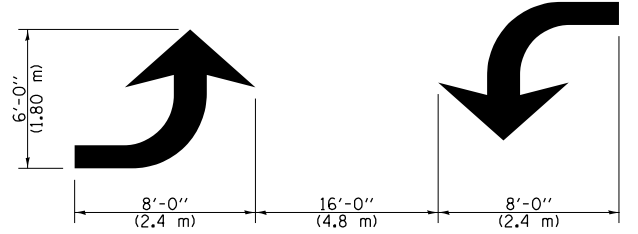

**TYPICAL DOUBLE
 TURN ARROWS (WHITE)**

NOT TO SCALE

Note: All dimensions are in INCHES (millimeters) unless otherwise shown.

DISTRICT 7 DETAIL NO. 7800001

FILE NAME =	USER NAME = steffenk	DESIGNED -	REVISED -	STATE OF ILLINOIS DEPARTMENT OF TRANSPORTATION	PAVEMENT MARKING AND RAISED REFLECTIVE PAVEMENT MARKERS (RURAL & URBAN APPLICATIONS)			F.A.P. RTE.	SECTION	COUNTY	TOTAL SHEETS	SHEET NO.
pw:\idot-pw\bentley.com\PWIDOT\Documents\IDOT Offices\District 7\Projects\74964\CADD\Drawings\74964-sht-details.dgn	PLT SCALE = 100.0000' / in.	CHECKED -	REVISED -					T62	(1,2)RS-4	MOULTRIE	36	34
PLT DATE = 11/29/2021	DATE -	REVISOR -	REVISOR -		SCALE: SHEET NO. 2 OF 4 SHEETS STA. TO STA.			CONTRACT NO. 74964				
ILLINOIS FED. AID PROJECT												

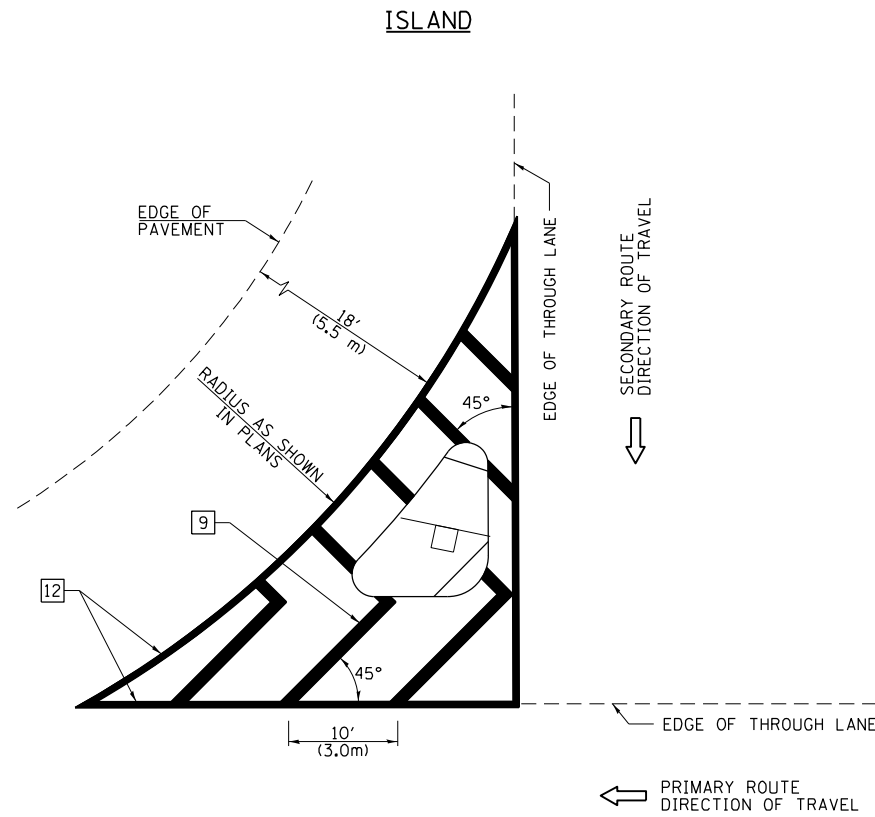

GENERAL NOTES

1. RAISED AND CORRUGATED MEDIANS SHALL BE OUTLINED WITH [2] IF PRESENT.
2. SOME OF THE INFORMATION INCLUDED WITH THIS DETAIL MAY NOT BE APPLICABLE TO THIS IMPROVEMENT.
3. PAVEMENT MARKINGS ARE TO BE EXTENDED THROUGH OMISSIONS WHEN APPLICABLE.
4. FINAL PAVEMENT MARKINGS SHALL BE IN PLACE PRIOR TO PLACING ANY RAISED REFLECTIVE PAVEMENT MARKERS.
5. THE FOLLOWING CRITERIA SHALL BE USED FOR SELECTING THE DIAGONAL PAVEMENT MARKING SPACING:

< 30 MPH (< 50 km/h)	15' (4.5 m)
30-45 MPH (50-75 km/h)	20' (6.0 m)
> 45 MPH (> 75 km/h)	30' (9.0 m)

PAVEMENT MARKING LEGEND

- [1] 4" (100) SKIP-DASH (YELLOW)
 - [2] 4" (100) SOLID (YELLOW)
 - [3] 12" (300) DIAGONAL (YELLOW)
 - [4] 4" (100) DOUBLE YELLOW (NARROW)
 - [5] 12" (300) SOLID WHITE
 - [6] RESERVED
 - [7] 6" (150) SKIP-DASH (WHITE)
 - [8] 4" (100) SOLID (WHITE)
 - [9] 12" (300) DIAGONAL (WHITE)
 - [10] 6" (150) SOLID (WHITE)
 - [11] 24" (600) STOP BAR (WHITE)
 - [12] 8" (200) SOLID (WHITE)
 - [13] 4" (100) PARKING WHITE
-

RURAL LEFT TURN STRIPING

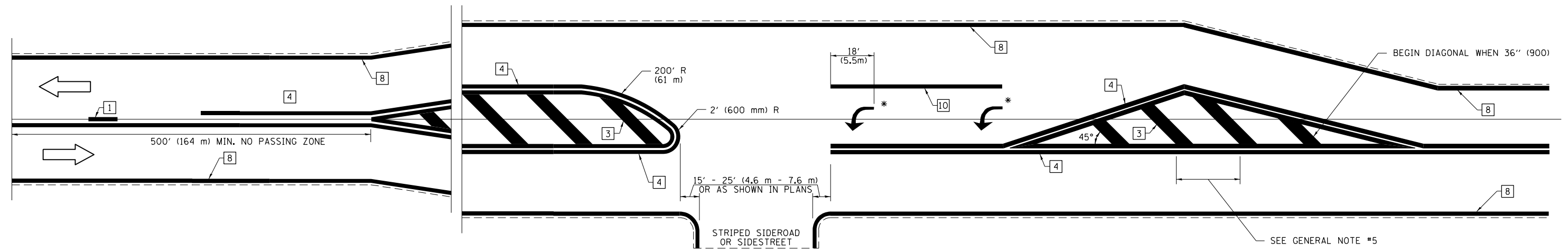

* PLACE AN ARROW 18' (5.5 m) BACK FROM STOP BAR. PLACE ANOTHER ARROW EVEN WITH THE BEGINNING OF THE SOLID WHITE LINE. SPACE ADDITIONAL ARROWS EVENLY UP TO 80' (24.4 m) MAXIMUM SPACING. USE MINIMUM OF 2 ARROWS.

NOT TO SCALE
 Note: All dimensions are in INCHES (millimeters) unless otherwise shown.

DISTRICT 7 DETAIL NO. 78000001

FILE NAME =	USER NAME = steffenmk	DESIGNED -	REVISED -
p:\dot-pw.bentley.com\PWIDOT\Documents\IDOT Offices\District 7\Projects\74964\CADD\Drawings\Drawings\74964-shd-details.dgn		CHECKED -	REVISED -
		DATE -	REVISED -

**STATE OF ILLINOIS
 DEPARTMENT OF TRANSPORTATION**

**PAVEMENT MARKING AND RAISED REFLECTIVE PAVEMENT MARKERS
 (RURAL & URBAN APPLICATIONS)**

SCALE: SHEET NO. 3 OF 4 SHEETS STA. TO STA.

F.A.P. RTE.	SECTION	COUNTY	TOTAL SHEETS	SHEET NO.
762	(1,2)RS-4	MOULTRIE	36	35
CONTRACT NO. 74964				
ILLINOIS FED. AID PROJECT				

PAVEMENT MARKINGS AT RAILROAD-HIGHWAY GRADE CROSSING

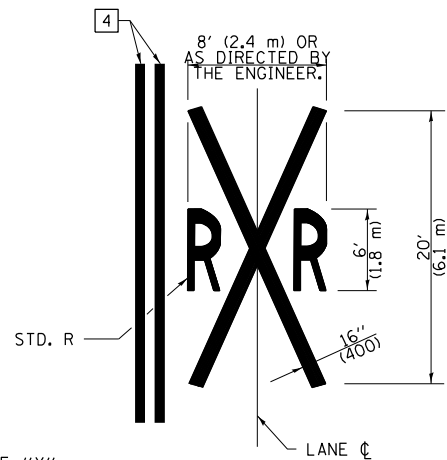
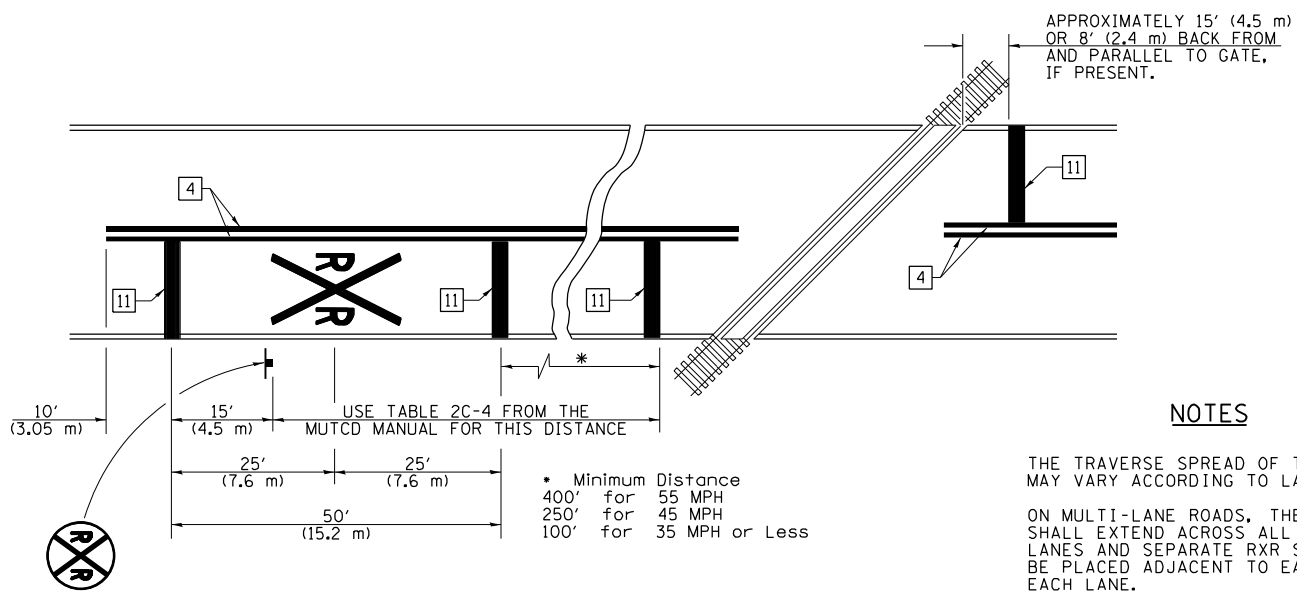

NOTES

THE TRAVERSE SPREAD OF THE "X" MAY VARY ACCORDING TO LANE WIDTH.

ON MULTI-LANE ROADS, THE STOP LINES SHALL EXTEND ACROSS ALL APPROACH LANES AND SEPARATE RXR SYMBOLS SHALL BE PLACED ADJACENT TO EACH OTHER IN EACH LANE.

WHEN THE PAVEMENT MARKING SYMBOL IS USED, A PORTION OF THE SYMBOL SHOULD BE LOCATED DIRECTLY ADJACENT TO THE ADVANCE WARNING SIGN (W10-1) AS PLACED BY TABLE II-1, CONDITION B OF THE MUTCD.

PAVEMENT MARKING LEGEND

- 1 4" (100) SKIP-DASH (YELLOW)
 - 2 4" (100) SOLID (YELLOW)
 - 3 12" (300) DIAGONAL (YELLOW)
 - 4 4" (100) DOUBLE YELLOW (NARROW)
 - 5 12" (300) SOLID WHITE
 - 6 RESERVED
 - 7 6" (150) SKIP-DASH (WHITE)
 - 8 4" (100) SOLID (WHITE)
 - 9 12" (300) DIAGONAL (WHITE)
 - 10 6" (150) SOLID (WHITE)
 - 11 24" (600) STOP BAR (WHITE)
 - 12 8" (200) SOLID (WHITE)
 - 13 4" (100) PARKING WHITE
-

RAILROAD CROSSING WITH INTERCONNECT ONLY

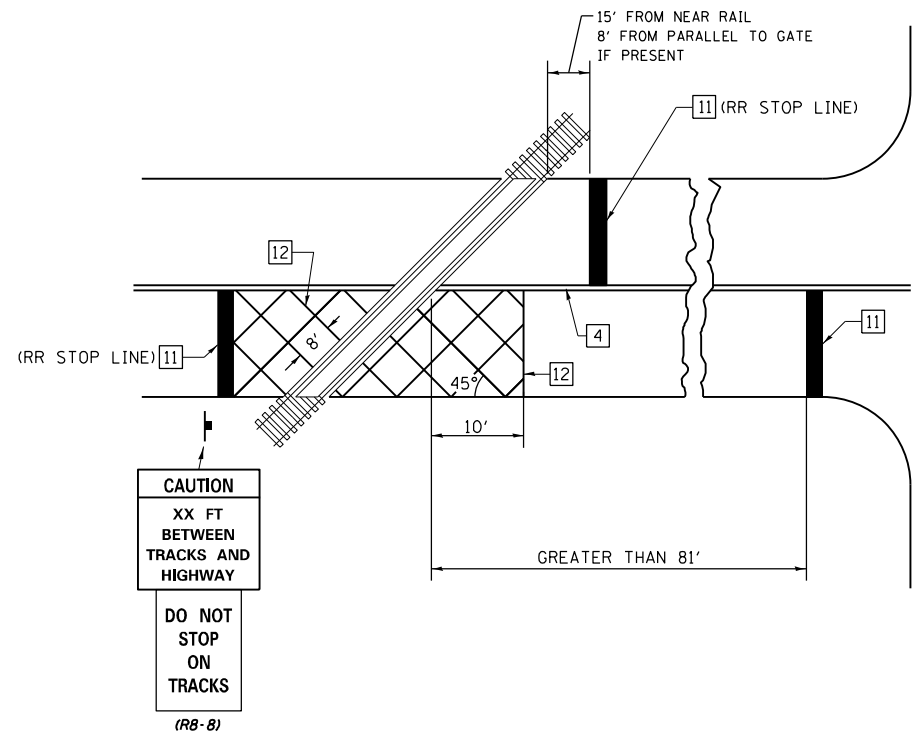

RAILROAD CROSSING WITH INTERCONNECT AND PRE-SIGNALS

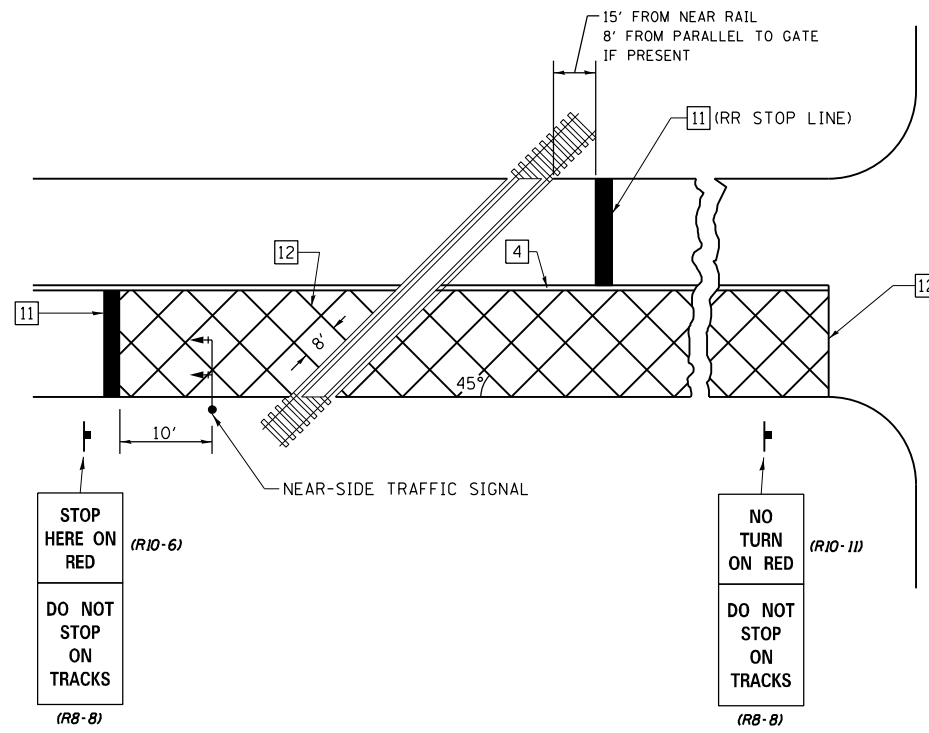

GENERAL NOTES

- SUPPLEMENTAL PAVEMENT MARKINGS TO BE INSTALLED ONLY ON APPROACHES TO INTERSECTIONS CONTROLLED BY TRAFFIC SIGNALS WHICH ARE INTERCONNECTED WITH THE RAILROAD WARNING SIGNALS.
- EXTEND PAVEMENT MARKINGS TO THE INTERSECTION ONLY WHERE NEAR-SIDE TRAFFIC SIGNALS ARE USED.

SUPPLEMENTAL PAVEMENT MARKING TREATMENT FOR RAILROAD-HIGHWAY GRADE CROSSING

NOT TO SCALE

Note: All dimensions are in INCHES (millimeters) unless otherwise shown.

DISTRICT 7 DETAIL NO. 7800001

FILE NAME =	USER NAME = steffenk	DESIGNED -	REVISED -	STATE OF ILLINOIS DEPARTMENT OF TRANSPORTATION	PAVEMENT MARKING AND RAISED REFLECTIVE PAVEMENT MARKERS (RURAL & URBAN APPLICATIONS)	F.A.P. R.T.E.	SECTION	COUNTY	TOTAL SHEETS	SHEET NO.
pw:\idot-pw\bentley.com\PIWIDOT\Documents\IDOT Offices\District 7\Projects\74964\CADD\Drawings\Sheets\774964-sht-details.dgn	PROJECT = 74964	CHECKED -	REVISED -			762	(1,2)RS-4	MOULTRIE	36	36
PLOT SCALE = 100.0000' / in.	DATE = 11/29/2021	DATE -	REVISED -			CONTRACT NO. 74964				
						ILLINOIS FED. AID PROJECT				

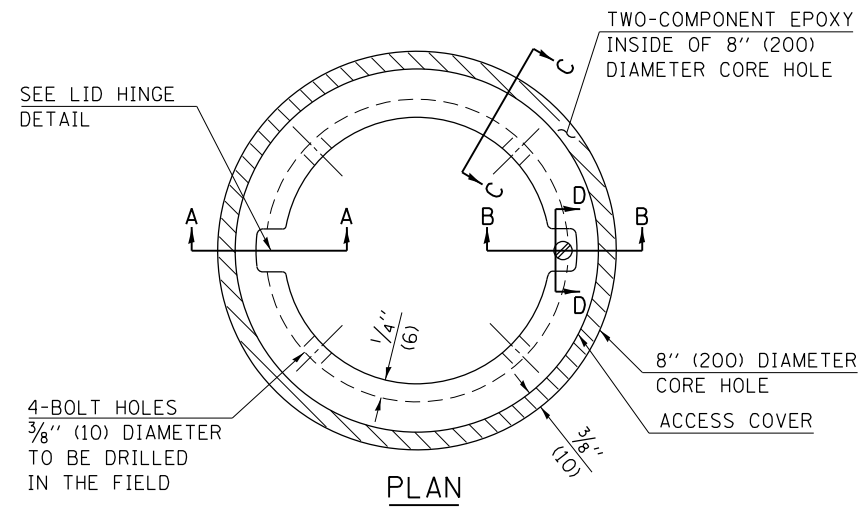

- LEGEND**
- ALUMINUM CASTING
 - 5" (125) OR 6" (150) P.V.C. PIPE
 - TWO-COMPONENT EPOXY
- T = THICKNESS OF PAVEMENT STRUCTURE
- H = THE THICKNESS OF THE SUB-BASE GRANULAR + 1" (25)

BILL OF MATERIAL

ALUMINUM CASTING OF THE DIMENSIONS AND SPECIFICATIONS SHOWN OR OTHER SUBJECT TO ENGINEER'S APPROVAL OF SHOP DRAWINGS, 4 EACH - $\frac{5}{16}$ " X 2" (M8 X 50) BOLTS WITH NUTS, EPOXY, 5" OR 6" (125 mm OR 150 mm) DIAMETER P.V.C. PIPE, SCHEDULE 40 (WHEN REQUIRED).

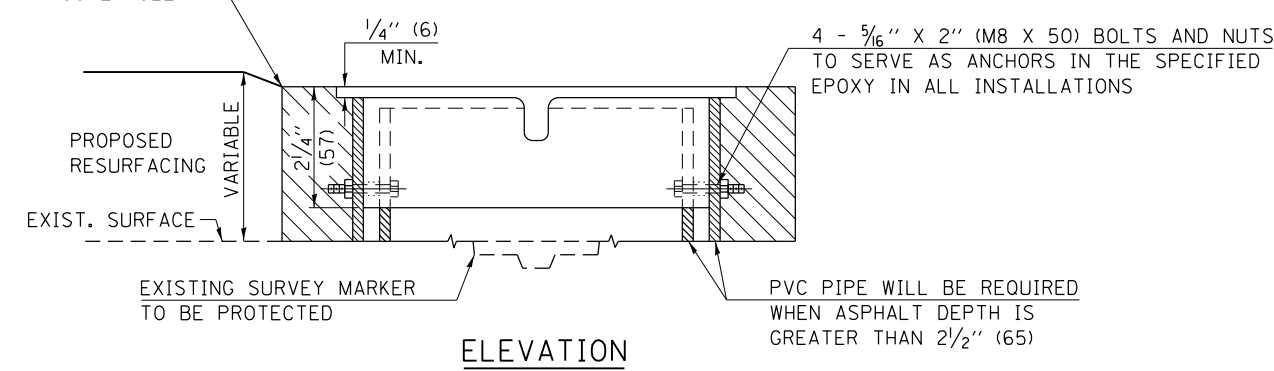
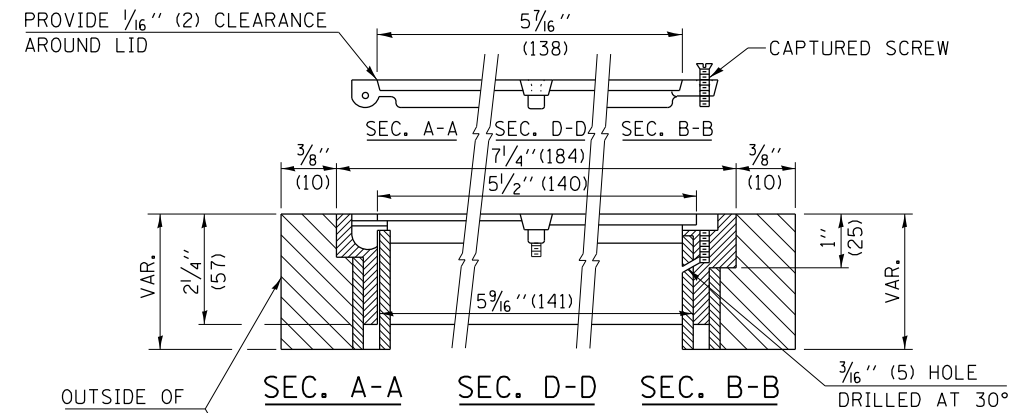
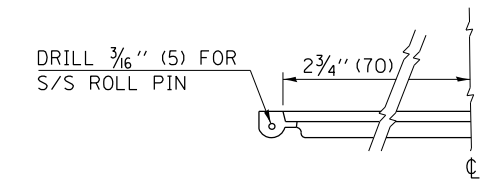
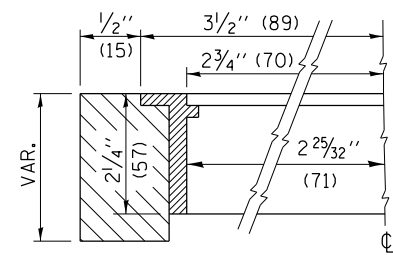

EXISTING SURVEY MARKER

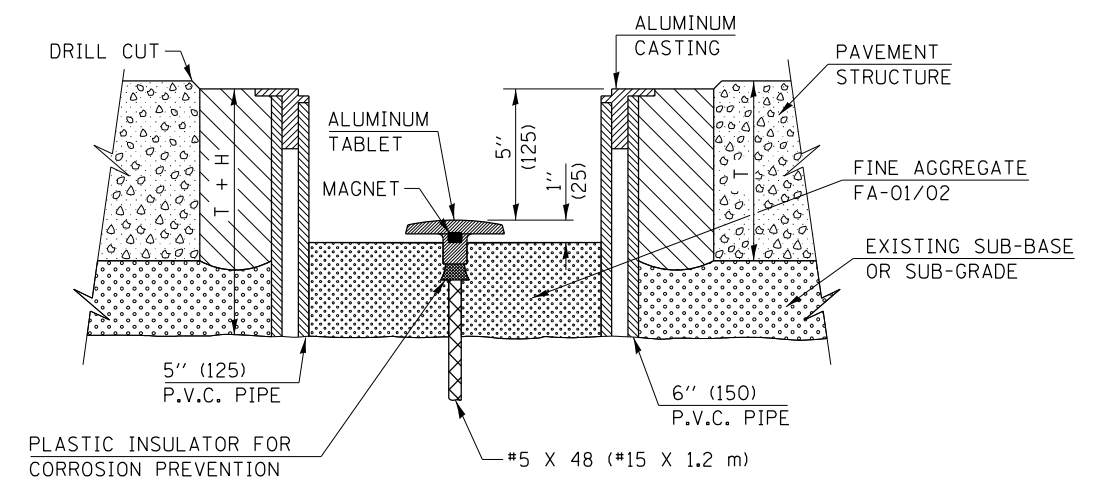

PROPOSED SURVEY MARKER

NOT TO SCALE

Note: All dimensions are in INCHES (millimeters) unless otherwise shown.

FILE NAME =	USER NAME = #USER*	DESIGNED -	REVISED - MAD 6-11
#FILE#		DRAWN -	REVISED -
	PLOT SCALE = #SCALE*	CHECKED -	REVISED -
	PLOT DATE = #DATE*	DATE -	REVISED -

STATE OF ILLINOIS
DEPARTMENT OF TRANSPORTATION

SURVEY MARKER VAULT	
SCALE:	TO STA.
SHEET NO. 1 OF 1 SHEETS	

DISTRICT 7 DETAIL NO. Z0070202				
F.A.P. RTE.	SECTION	COUNTY	TOTAL SHEETS	SHEET NO.
762	(1,2)RS-4	MOULTRIE	36	36A
CONTRACT NO. 74964				
FED. ROAD DIST. NO. ILLINOIS FED. AID PROJECT				