

ELEVATION

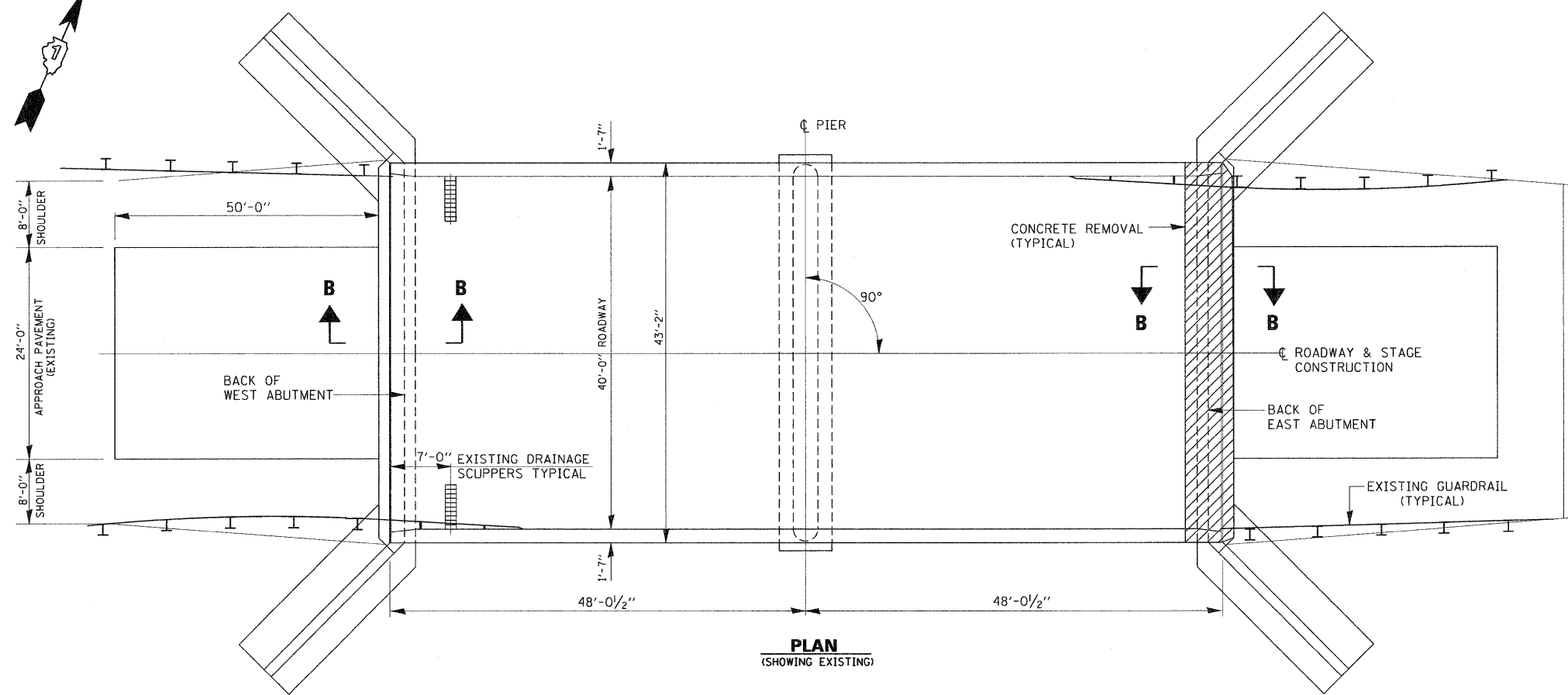

PLAN
(SHOWING EXISTING)

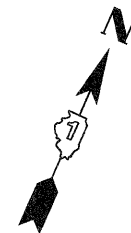
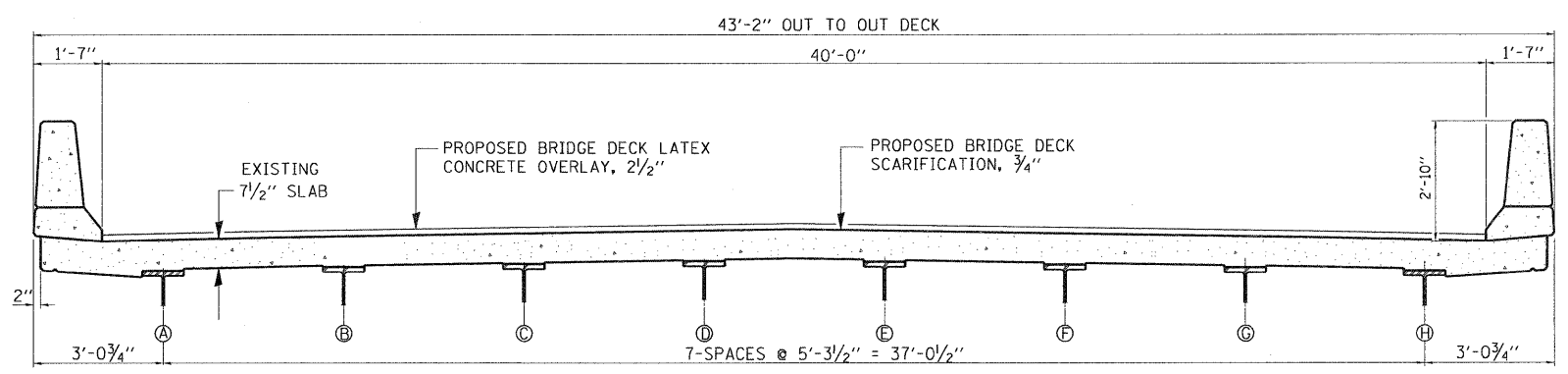

CROSS SECTION
(LOOKING WEST)

GENERAL NOTES:

PLAN DIMENSIONS AND DETAILS RELATIVE TO EXISTING PLANS ARE SUBJECT TO NOMINAL CONSTRUCTION VARIATIONS. THE CONTRACTOR SHALL FIELD VERIFY EXISTING DIMENSIONS AND DETAILS AFFECTING NEW CONSTRUCTION AND MAKE NECESSARY APPROVED ADJUSTMENT PRIOR TO CONSTRUCTION OR ORDERING OF MATERIALS. SUCH VARIATIONS SHALL NOT BE CAUSE FOR ADDITIONAL COMPENSATION FOR A CHANGE IN SCOPE OF THE WORK, HOWEVER, THE CONTRACTOR WILL BE PAID FOR THE QUANTITY ACTUALLY FURNISHED BASED AT THE UNIT PRICE BID FOR THE WORK.

ALL STRUCTURAL STEEL SHALL CONFORM TO AASHTO CLASSIFICATION M-270 GR. 36, UNLESS OTHERWISE NOTED.

REINFORCEMENT BARS DESIGNATED (E) SHALL BE EPOXY COATED.

EXISTING REINFORCEMENT BARS EXTENDING INTO THE REMOVAL AREA SHALL BE CLEANED, STRAIGHTENED AND INCORPORATED INTO THE NEW CONSTRUCTION. ANY REINFORCEMENT BARS THAT ARE DAMAGED DURING CONCRETE REMOVAL SHALL BE REPLACED WITH AN APPROVED BAR SPLICER OR ANCHORAGE SYSTEM. COST INCLUDED WITH CONCRETE REMOVAL.

AREA OF DECK REPAIRS SHOWN ARE ESTIMATED. THE ENGINEER SHALL SHOW ACTUAL LOCATIONS OF DECK REPAIRS ON AS-BUILT PLANS.

REINFORCEMENT BARS SHALL CONFORM TO THE REQUIREMENTS OF ASTM A 706 Gr 60.. SEE SPECIAL PROVISIONS.

PRIOR TO POURING THE NEW CONCRETE DECK, ALL HEAVY OR LOOSE RUST, LOOSE MILL SCALE, AND OTHER LOOSE OR POTENTIALLY DETRIMENTAL FOREIGN MATERIAL SHALL BE REMOVED FROM THE SURFACES IN CONTACT WITH CONCRETE. TIGHTLY ADHERED PAINT MAY REMAIN UNLESS OTHERWISE NOTED. REMOVAL SHALL BE ACCOMPLISHED BY METHODS THAT WILL NOT DAMAGE THE STEEL AND THE COST WILL BE INCLUDED IN THE PAY ITEM COVERING REMOVAL OF THE EXISTING CONCRETE.

NO IN-STREAM WORK ALLOWED.

FIELD CUTS OF PROPOSED REINFORCEMENT BARS TO FIT FIELD CONDITIONS SHALL BE INCLUDED IN THE COST OF REINFORCEMENT BARS EPOXY COATED.

TOTAL BILL OF MATERIALS

ITEM	UNIT	QUANTITY
REINFORCEMENT BARS (EPOXY COATED)	POUND	3680
CONCRETE SUPERSTRUCTURE	CU. YD.	21.8
CONCRETE REMOVAL	CU. YD.	9.8
BRIDGE DECK LATEX CONCRETE OVERLAY, 2 1/2"	SQ. YD.	410
BRIDGE DECK SCARIFICATION, 3/4"	SQ. YD.	410
STRUCTURAL REPAIR OF CONCRETE (DEPTH < 5")	SQ. FT.	62
BRIDGE DECK GROOVING	SQ. YD.	413
DECK SLAB REPAIR (FULL DEPTH TYPE II)	SQ. YD.	1
BAR SPLICERS	EACH	112
ADJUSTING DRAINAGE SCUPPER, TYPE A	EACH	2
PROTECTIVE COAT	SQ. YD.	94



David Carl Puzev 3/16/11
Expires 11/30/2012