

Existing Structure: S.N. 016-1054 built in 1935 as Section 048-0202 by the Cook County Department of Highways as a continuous three-span multi-beam bridge with a reinforced concrete deck on pile supported concrete abutments and piers. In 2000 as FAP 378 Section 0202-D-R-1, the superstructure was replaced and widened with a three-span multi-beam superstructure with a reinforced concrete deck measured 217'-11³/₄" back-to-back of abutments and 80'-8¹/₂" out-to-out deck. The abutment caps, wingwalls and pier caps were retrofitted to accommodate the new superstructure.

Plan dimensions and details relative to existing plans are subject to nominal construction variations. The Contractor shall field verify existing dimensions and details affecting new construction and make necessary approved adjustments prior to construction or ordering of materials. Such variations shall not be cause for additional compensation for a change in scope of the work, however, the Contractor will be paid for the quantity actually furnished at the unit price bid for the work.

SCOPE OF WORK

1. Remove and replace Type L Rail at northeast corner of bridge.
2. Repair end of concrete parapet at northeast corner of bridge.

DESIGN SPECIFICATIONS

2002 AASHTO Standard Specifications for Highway Bridges, 17th Edition

DESIGN STRESSES

FIELD UNITS

$f'_c = 3,500$ psi
 $f_y = 60,000$ psi (reinforcement)

INDEX OF SHEETS

- S1. General Plan & Elevation
- S2. Aluminum Railing, Type L

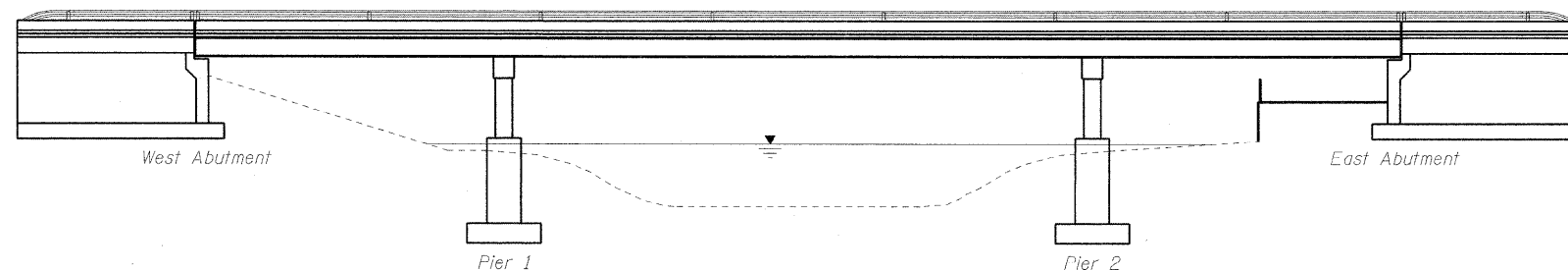

TOTAL BILL OF MATERIAL

ITEM	UNIT	TOTAL
Aluminum Railing, Type L	Foot	25.5
Structural Repair of Concrete (Depth equal to or less than 5 inches)	Sq. Ft.	2

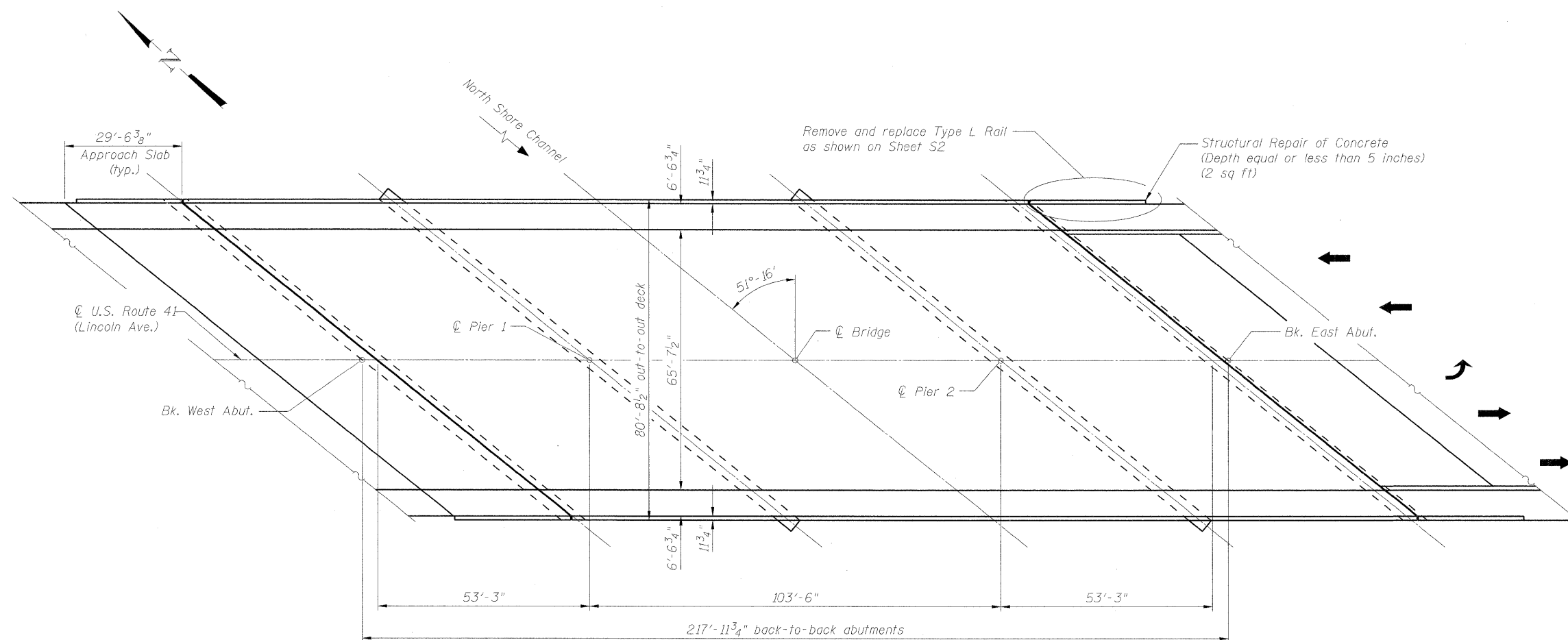

Brad H. Sayers
 BRAD H. SAYERS, S.E.
 IL. LIC. NO. 081-006267
 EXP 11/30/12
 DATE 3/7/11

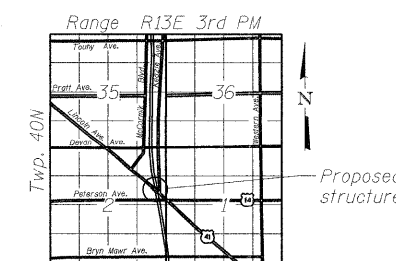

FILE NAME = g:\project\2102155_005b\lead\structure\0161054_60L55_007_General Plan.dgn